

LowSpaceCrane

Most Light, Most Compact, Most Smooth



공장높이: 13 m
 메인구조물규격:
 H600×300×12/20
 메인구조물중량:
 176 ton

공장높이: 12 m
 메인구조물규격:
 H482×300×11/13
 메인구조물중량:
 133 ton

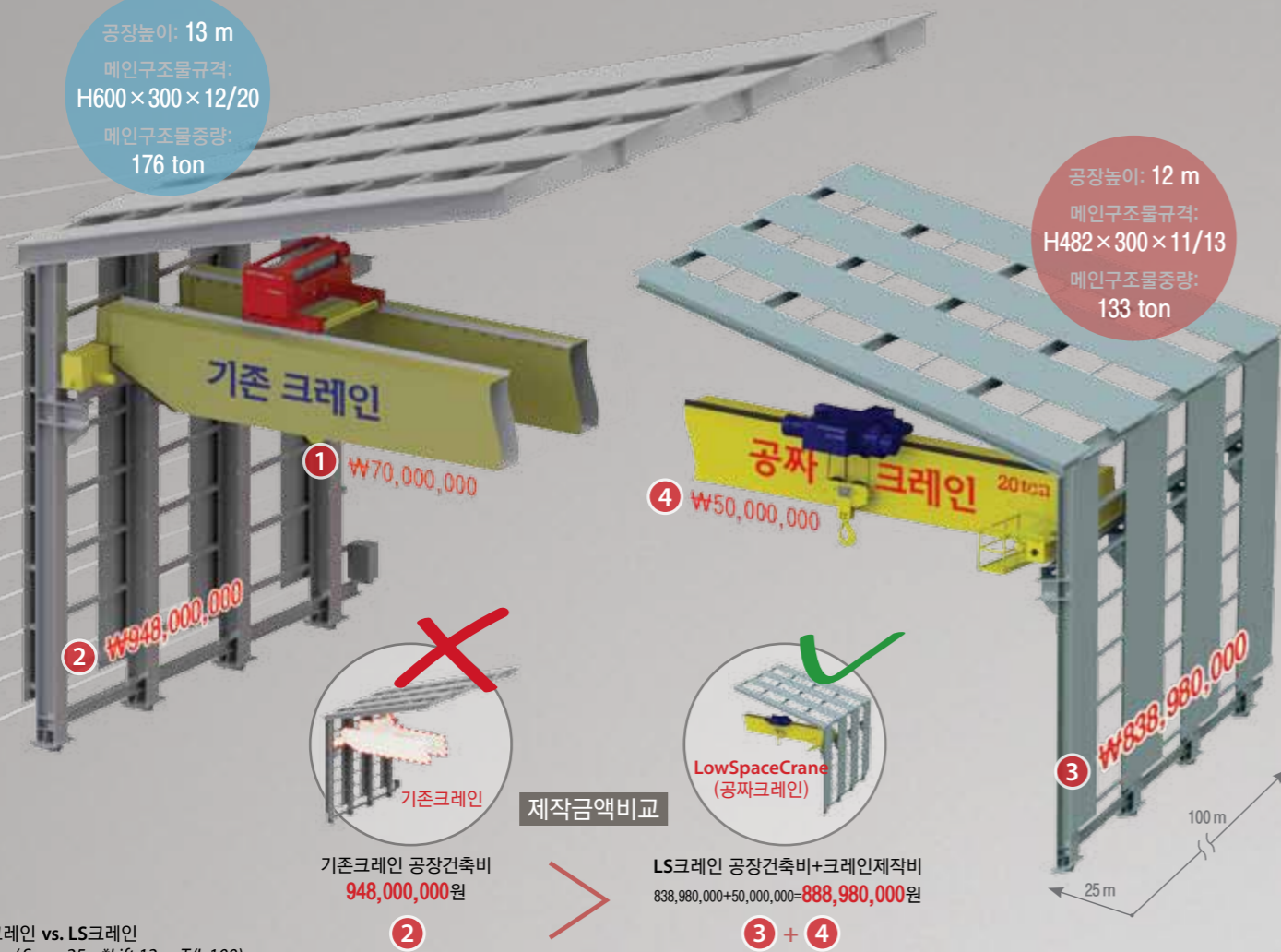

기존크레인 vs. LS크레인
 (20 ton / Span 25m*Height 12m T/L 100)



Low Space Crane (20ton)
 Doosan Infracore in Gunsan
 (Span 28.5m*Height 12m)
 Max Capacity : 40 tons

KG CRANES PRODUCT

- Goliath Crane for shipyard
- Level Luffing Crane for shipyard
- RMQC & Gantry Yard Crane
- Overhead Crane for Steel Mill
- Overhead Crane with Coil Lifter
- Training Log Crane for DAM
- Launching Girder for Construction
- Doublerrail Gantry Crane
- Doublerrail Hoist Crane
- Monorail Gantry Crane
- Mono Girder Hoist Crane
- Suspension Hoist Crane
- Clean Room Crane
- Low Space Crane
- Jib Crane & Gorbelt Crane
- Cargo Unloading Plant Conveyor Crane (Woodchip)



Mono Girder Gantry Crane (65ton)
 CCL KOREA in Uijeongbu
 (Span 28m*Height 14m)
 Max Capacity : 300 tons



Goliath Crane for shipyard (600ton)
 TKS Shipyard in Yeonggwang
 (Span 100m*Height 80m)
 Max Capacity : 1500 tons



Level Luffing Crane for shipyard (40/5ton)
 TKS Shipyard in Yeonggwang
 Max Capacity : 100 tons



Jib Crane & Gorbelt Crane
 Bakun dam in Malaysia
 10ton Arm 7m Jib Crane
 Max Capacity : 10 tons



Double Girder Hoist Crane (100ton)
 Doosan Infracore in Gunsan
 (Span 24m*Height 12m)
 Max Capacity : 400 tons



Cargo Unloading Plant Conveyor Crane (Woodchip)
 Harbor unloading System No. 7 South Entry in New Ulsan Port
 Capacity : 800 tons / Hr

Low Space Crane은 창조와 혁신의 Crane입니다.

- 건축비를 낮추는 크레인
- 파격적인 크레인 Girder Size
- 혁신적인 Hook 높이
- VVVF Control (인버터) **OPTION**
- 회생전력 Unit (KGP) **OPTION**
- Walk way & Hand rail **OPTION**



회생전력 Unit (KGP)

기존의 제동 저항으로 소비하던 에너지를 전력회생 방식을 이용하여 20% 에너지 절감

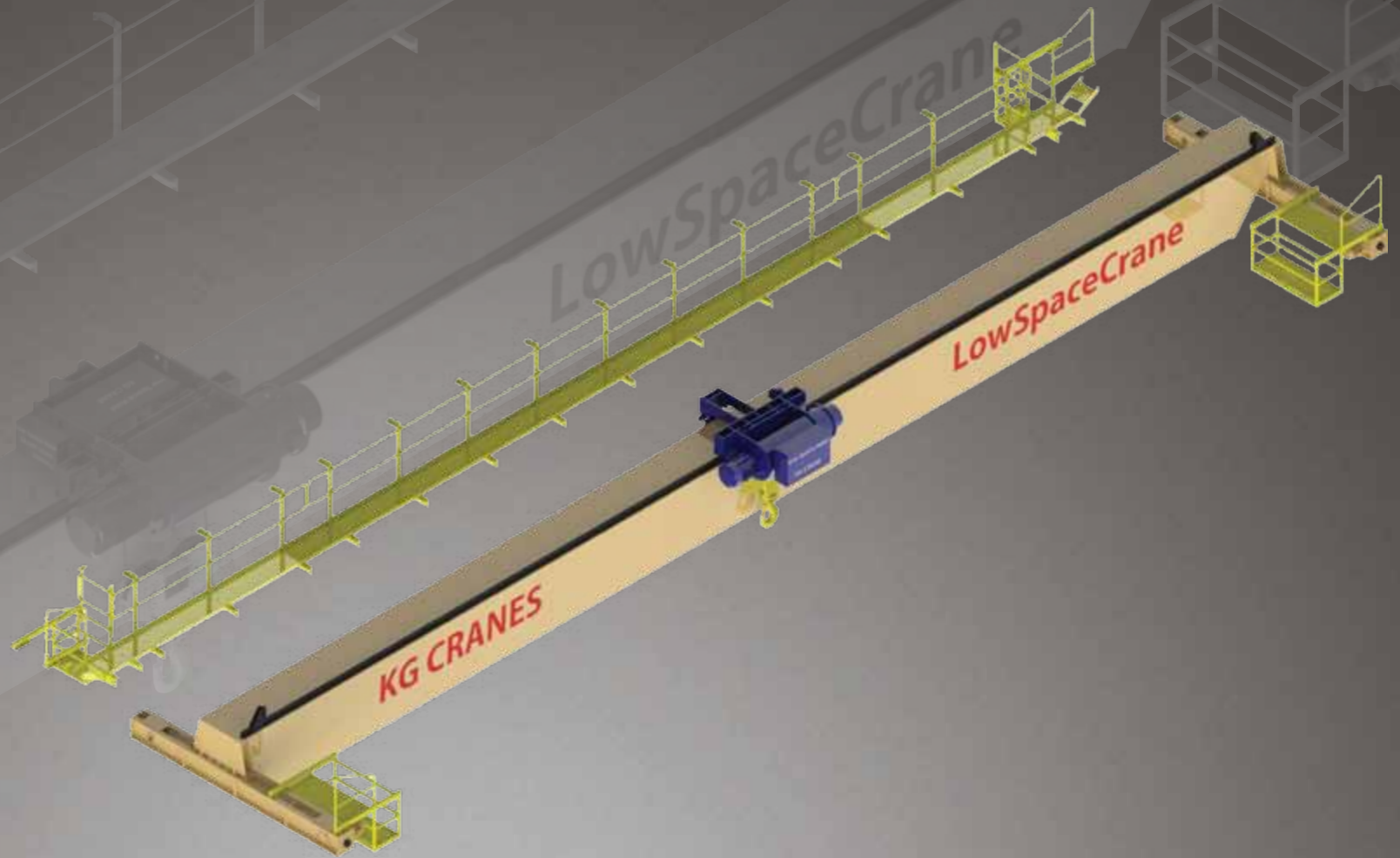

Low Space Crane



DHO 20 tons Span 20m

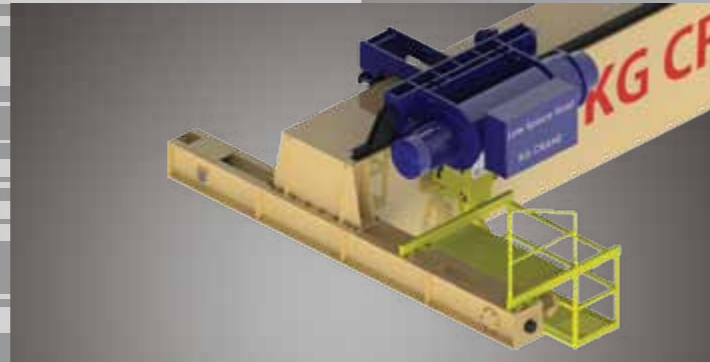

유지보수 용이
양쪽 Saddle에 설치된 점검대에서 쉽게 유지보수가 가능합니다.



혁신적인 Hook 높이
Mono girder에서는 상상도 할 수 없는 높이를 만족시키며, Double girder crane의 높이 혹은 그 이상을 만족시킵니다.

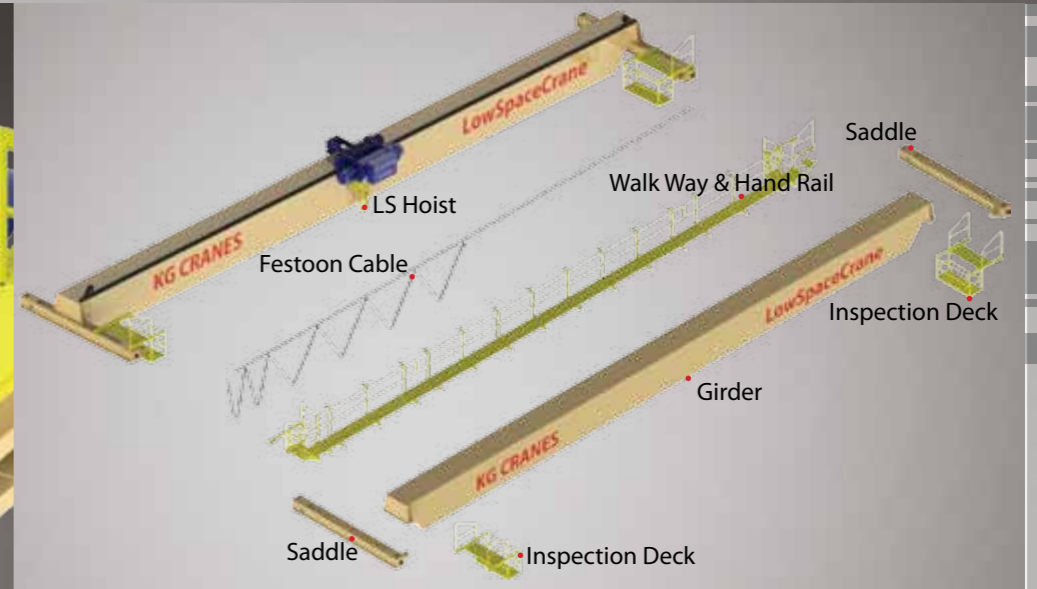

Disassembly Drawing

파격적인 Crane Girder Size

Double girder의 후크 높이를 충족시키면서 Single girder의 사이즈를 가지고 있습니다. 이는 동급 더블거더 크레인에 비해 자중이 44% 감소하였음을 의미합니다.



Low Space Crane

국내 최초 자동화 라인 구축 - 대량 생산 체제



1. LS 크레인은 기존 크레인 대비 체적 및 자중을 감소시켜 제품가격을 절감하였습니다.
2. CRANE의 자중 감소 및 공장 높이를 낮출 수 있어 공장의 건축비 또한 절감할 수 있습니다.
3. 자동화 라인을 통한 생산으로 제작 기간을 단축시키고 Block 구조로 설치비용을 줄였습니다.

■ 동일한 공장 높이 「크레인 양정 비교」



Low Space Crane vs. Mono Girder

■ 동일한 Ton수 「크레인 중량 · 체적 비교」



Double Girder vs. Low Space Crane

Low Space Crane (40ton)
Doosan Infracore in Gunsan
(Span 29m*Height 6m)



Double Girder Hoist Crane (100ton)
Doosan Infracore in Gunsan
(Span 24m*Height 12m)
Max Capacity : 400 tons

Low Space Crane (20ton)
Doosan Infracore in Gunsan
(Span 29m*Height 12m)
Max Capacity : 40 tons

Mono Girder Hoist Crane (15ton)
Hyundai Motors in India
(Span 18m*Height 10m)
Max Capacity : 80 tons

건축비 절감 Modeling

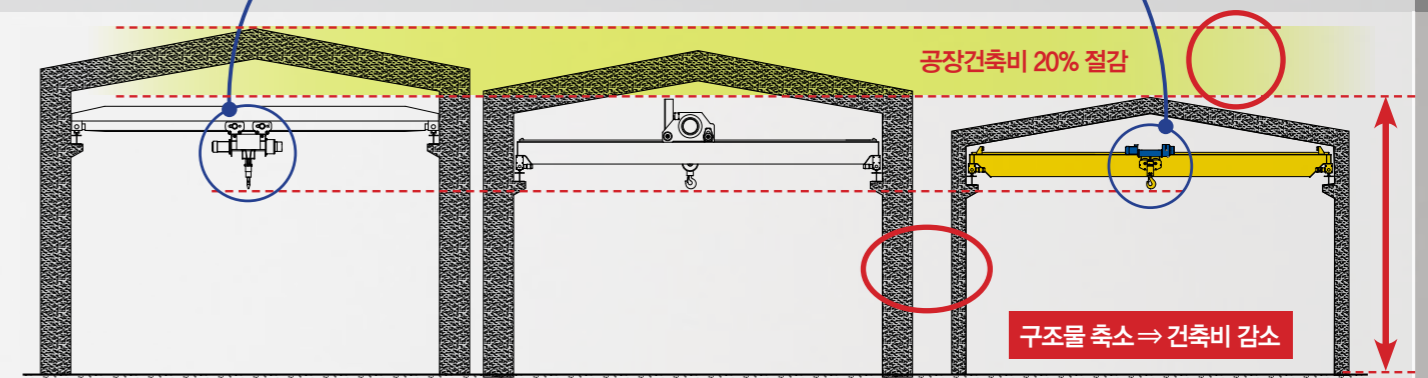

Mono Girder

Double Girder

Low Space Crane

1

2

3

Low Space Crane (15ton)
Doosan Infracore in Gunsan
(Span 26m*Height 9.4m)





Low Space Crane (20ton)
Doosan Infracore in Gunsan
(Span 29m*Height 12m)

Low Space Hoist

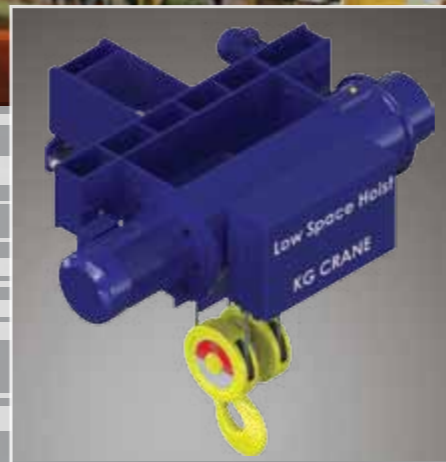

Low Space Hoist (1~5 ton)



Low Space Hoist (7.5~20 ton)



Low Space Hoist (30~40 ton)

Localization



Certification



우수제품 인증서
한국 조달청으로부터
2009년에 지정



NEP 인증서
한국 지식경제부로부터
2010년에 지정



우수성과 100선
국가연구개발 투자사업
20,000여개 참여업체 중
국가연구개발 "우수성과
100선"으로 선정

Overseas Patent



America



China



Germany



Vietnam



Low Space Crane 1ton

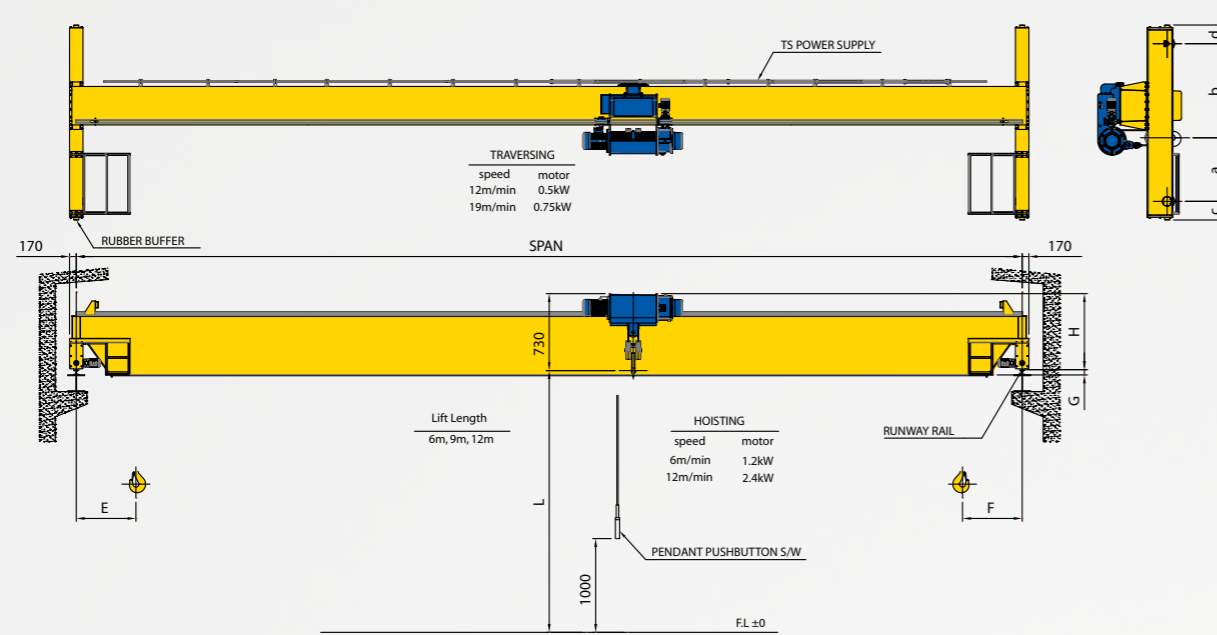

1ton

Type	Span	H (mm)	G (mm)	E (mm)	F (mm)	a (mm)	b (mm)	c (mm)	d (mm)	Rail min size (kg/m)	Wheel max load (kg)	Total Weight (kg)		
LS 109	9	730	200	Lift 6m 650	Lift 6m 610	800	1200	360	210	15	1240	2900		
LS 110	10	730	200			800	1200	360	210	15	1300	3100		
LS 111	11	730	200			800	1200	360	210	15	1360	3300		
LS 112	12	730	200			800	1200	360	210	15	1410	3500		
LS 113	13	730	200			800	1200	360	210	15	1480	3800		
LS 114	14	730	200			800	1200	360	210	15	1570	4100		
LS 115	15	730	200			1000	1500	360	210	15	1630	4400		
LS 116	16	780	200			1000	1500	360	210	15	1710	4600		
LS 117	17	780	200			1000	1500	360	210	15	1780	4900		
LS 118	18	830	200			1000	1500	360	210	15	1830	5100		
LS 119	19	830	200			1200	1800	360	210	15	1930	5500		
LS 120	20	830	200			1200	1800	360	210	15	2010	5800		
LS 121	21	830	200			Lift 9m 720	Lift 9m 690	1200	1800	360	210	15	2090	6200
LS 122	22	830	220					1500	2000	360	210	15	2190	6600
LS 123	23	830	250					1500	2000	360	210	15	2250	6800
LS 124	24	830	280			Lift 12m 800	Lift 12m 770	1500	2000	360	210	15	2340	7100
LS 125	25	830	310					1500	2000	360	210	15	2440	7500
LS 126	26	930	340					1700	2300	360	210	15	2600	8200
LS 127	27	930	340					1700	2300	360	210	15	2700	8600
LS 128	28	930	370	1700	2300			360	210	15	2800	9000		
LS 129	29	930	400	1900	2600			360	210	15	2980	9700		
LS 130	30	930	430	1900	2600			360	210	15	3080	10100		
LS 131	31	980	460	1900	2600	390	280	15	3200	10500				
LS 132	32	1030	490	1900	2600	390	280	15	3330	11100				
LS 133	33	1030	520	2100	2900	390	280	15	3540	11900				
LS 134	34	1030	520	2100	2900	390	280	15	3670	12400				
LS 135	35	1030	550	2100	2900	390	280	15	3790	12900				
LS 136	36	1030	580	2350	3150	410	310	15	4060	14000				
LS 137	37	1180	640	2350	3150	410	310	15	4190	14500				
LS 138	38	1180	640	2350	3150	410	310	15	4460	15600				
LS 139	39	1180	670	2350	3150	410	310	15	4600	16100				

Low Space Crane 2ton

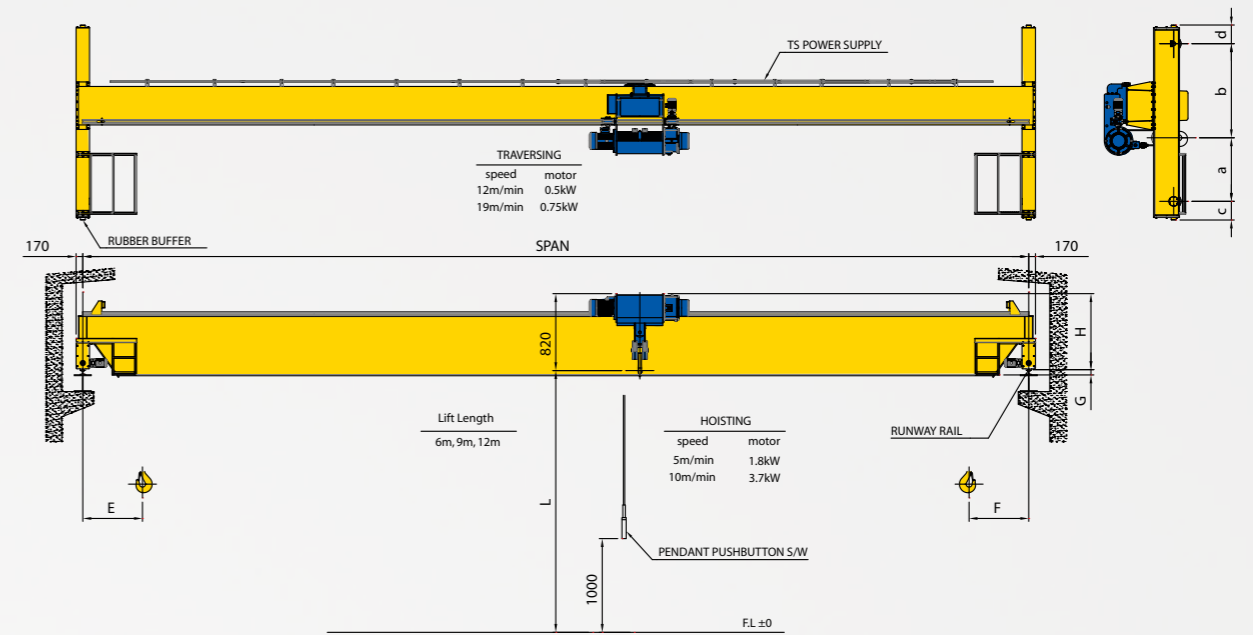

2ton

Type	Span	H (mm)	G (mm)	E (mm)	F (mm)	a (mm)	b (mm)	c (mm)	d (mm)	Rail min size (kg/m)	Wheel max load (kg)	Total Weight (kg)		
LS 209	9	730	200	Lift 6m 660	Lift 6m 690	800	1200	360	210	15	1780	3200		
LS 210	10	730	200			800	1200	360	210	15	1850	3400		
LS 211	11	730	200			800	1200	360	210	15	1910	3600		
LS 212	12	730	200			800	1200	360	210	15	2000	3900		
LS 213	13	730	200			800	1200	360	210	15	2070	4200		
LS 214	14	730	200			800	1200	360	210	15	2130	4400		
LS 215	15	730	200			1000	1500	360	210	15	2220	4700		
LS 216	16	830	200			1000	1500	360	210	15	2300	5000		
LS 217	17	830	200			1000	1500	360	210	15	2380	5300		
LS 218	18	830	200			1000	1500	360	210	15	2440	5500		
LS 219	19	830	200			1200	1800	360	210	15	2540	5900		
LS 220	20	830	200			1200	1800	360	210	15	2620	6200		
LS 221	21	830	220			Lift 9m 740	Lift 9m 770	1200	1800	360	210	15	2710	6600
LS 222	22	830	270					1500	2000	360	210	15	2870	7200
LS 223	23	830	320					1500	2000	360	210	15	2960	7500
LS 224	24	830	370			Lift 12m 810	Lift 12m 840	1500	2000	360	210	15	3060	7900
LS 225	25	830	420					1500	2000	360	210	15	3160	8300
LS 226	26	930	320					1700	2300	360	210	15	3290	8800
LS 227	27	930	370					1700	2300	390	280	15	3390	9200
LS 228	28	930	420	1700	2300			390	280	15	3500	9600		
LS 229	29	930	470	1900	2600			390	280	15	3650	10200		
LS 230	30	930	520	1900	2600			390	280	15	3760	10700		
LS 231	31	980	470	1900	2600	390	280	15	3940	11400				
LS 232	32	1030	520	1900	2600	390	280	15	4070	11900				
LS 233	33	1030	570	2100	2900	410	310	15	4320	12900				
LS 234	34	1030	620	2100	2900	410	310	15	4450	13400				
LS 235	35	1030	620	2100	2900	410	310	15	4570	13900				
LS 236	36	1030	670	2350	3150	410	310	15	4860	15100				
LS 237	37	1180	620	2350	3150	410	310	15	5000	15600				
LS 238	38	1180	670	2350	3150	600	450	15	5470	17500				
LS 239	39	1180	720	2350	3150	600	450	15	5630	18100				

Low Space Crane **3ton**

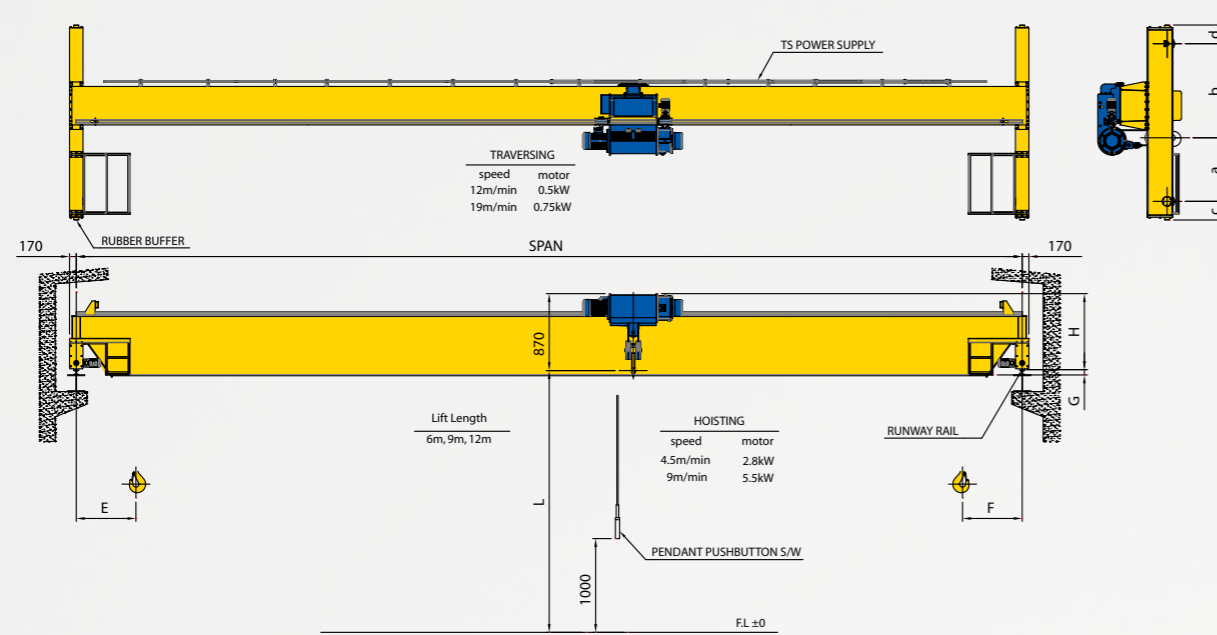

3ton

Type	Span	H (mm)	G (mm)	E (mm)	F (mm)	a (mm)	b (mm)	c (mm)	d (mm)	Rail min size (kg/m)	Wheel max load (kg)	Total Weight (kg)
LS 309	9	730	200	Lift 6m 650	Lift 6m 720	800	1200	360	210	15	2310	3400
LS 310	10	730	200			800	1200	360	210	15	2380	3600
LS 311	11	730	200			800	1200	360	210	15	2490	4000
LS 312	12	730	200			800	1200	360	210	15	2570	4300
LS 313	13	730	200			800	1200	360	210	15	2640	4500
LS 314	14	730	200			800	1200	360	210	15	2720	4800
LS 315	15	830	200			1000	1500	360	210	15	2820	5100
LS 316	16	830	200			1000	1500	360	210	15	2910	5400
LS 317	17	830	200			1000	1500	360	210	15	2990	5800
LS 318	18	830	200			1000	1500	360	210	15	3080	6100
LS 319	19	830	220			1200	1800	360	210	15	3210	6600
LS 320	20	830	270			1200	1800	360	210	15	3300	6900
LS 321	21	830	320			1500	2000	390	280	15	3510	7700
LS 322	22	830	370			1500	2000	390	280	15	3610	8100
LS 323	23	830	370			1500	2000	390	280	15	3720	8500
LS 324	24	830	420			1500	2000	390	280	15	3840	9000
LS 325	25	930	370			1700	2300	390	280	15	3990	9600
LS 326	26	930	420			1700	2300	390	280	15	4100	10000
LS 327	27	930	470			1700	2300	390	280	15	4210	10500
LS 328	28	980	470	1900	2600	410	310	15	4450	11400		
LS 329	29	980	470	1900	2600	410	310	15	4660	12200		
LS 330	30	1030	470	1900	2600	410	310	15	4780	12700		
LS 331	31	1030	520	1900	2600	410	310	15	4910	13200		
LS 332	32	1030	570	2100	2900	410	310	15	5070	13800		
LS 333	33	1030	620	2100	2900	410	310	15	5350	14900		
LS 334	34	1080	620	2100	2900	410	310	15	5480	15500		
LS 335	35	1180	570	2350	3150	600	450	15	5660	16200		
LS 336	36	1180	620	2350	3150	600	450	15	6210	18400		
LS 337	37	1180	670	2350	3150	600	450	15	6370	19000		
LS 338	38	1180	720	2350	3150	600	450	15	6650	21000		
LS 339	39	1180	770	2350	3150	600	450	15				

Low Space Crane **5ton**

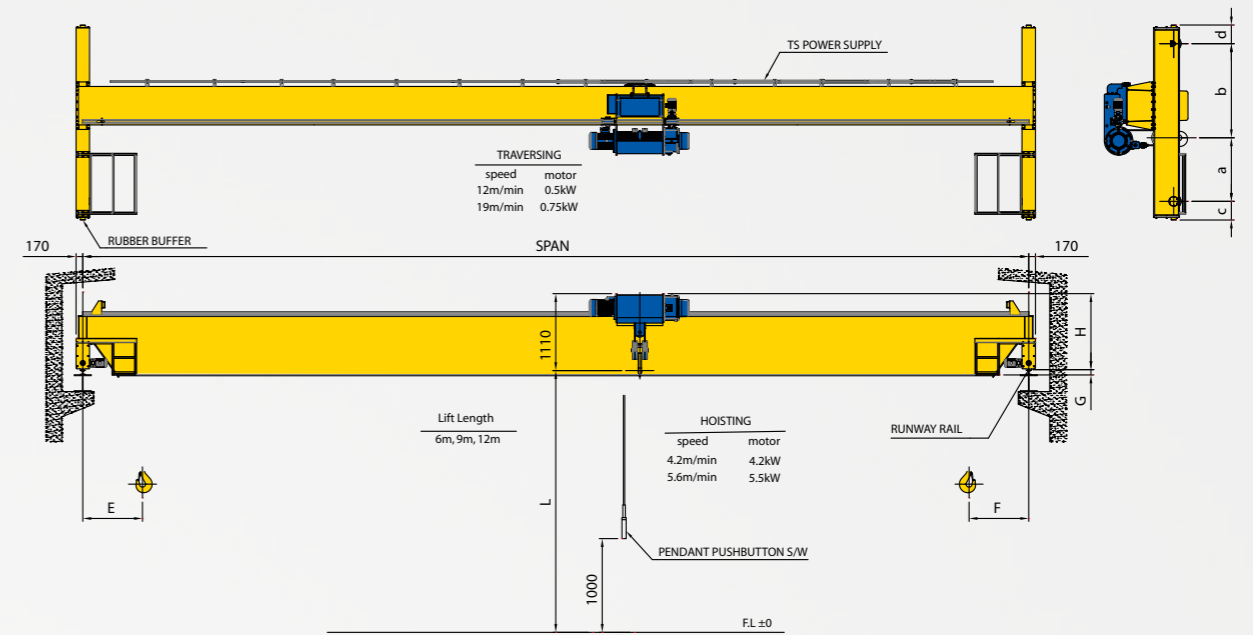

5ton

Type	Span	H (mm)	G (mm)	E (mm)	F (mm)	a (mm)	b (mm)	c (mm)	d (mm)	Rail min size (kg/m)	Wheel max load (kg)	Total Weight (kg)
LS 509	9	830	200	Lift 6m 690	Lift 6m 810	850	1150	360	210	22	3400	4100
LS 510	10	830	200			850	1150	360	210	22	3500	4300
LS 511	11	830	200			850	1150	360	210	22	3610	4600
LS 512	12	830	200			850	1150	360	210	22	3710	4900
LS 513	13	930	200			850	1150	360	210	22	3810	5200
LS 514	14	930	200			850	1150	360	210	22	3910	5500
LS 515	15	930	200			1050	1450	360	210	22	4060	6100
LS 516	16	930	200			1050	1450	360	210	22	4160	6400
LS 517	17	930	220			1050	1450	360	210	22	4260	6800
LS 518	18	930	270			1050	1450	360	210	22	4360	7100
LS 519	19	930	320			1300	1700	360	210	22	4490	7600
LS 520	20	930	370			1300	1700	390	280	22	4590	8000
LS 521	21	930	420			1500	2000	390	280	22	4720	8400
LS 522	22	1030	270			1500	2000	390	280	22	4820	8800
LS 523	23	1030	320			1500	2000	390	280	22	4990	9400
LS 524	24	1030	370			1500	2000	390	280	22	5100	9900
LS 525	25	1030	420			1500	2000	390	280	22	5300	10600
LS 526	26	1080	420			1700	2300	390	280	22	5450	11200
LS 527	27	1080	470			1700	2300	410	310	22	5670	12100
LS 528	28	1080	520	1700	2300	410	310	22	5800	12600		
LS 529	29	1080	570	1900	2600	410	310	22	5960	13200		
LS 530	30	1080	620	1900	2600	410	310	22	6090	13700		
LS 531	31	1080	670	1900	2600	410	310	22	6230	14200		
LS 532	32	1130	670	1900	2600	410	310	22	6480	15200		
LS 533	33	1080	770	2150	2850	410	310	22	6730	16200		
LS 534	34	1180	720	2150	2850	410	310	22	6880	16800		
LS 535	35	1180	770	2150	2850	600	450	22	7330	18600		
LS 536	36	1180	870	2350	3150	600	450	22	7530	19400		
LS 537	37	1230	870	2350	3150	600	450	22	7840	20600		
LS 538	38	1230	920	2350	3150	600	450	22	8020	21300		
LS 539	39	1180	970	2350	3150	600	450	22	8200	22000		

Low Space Crane 7.5ton

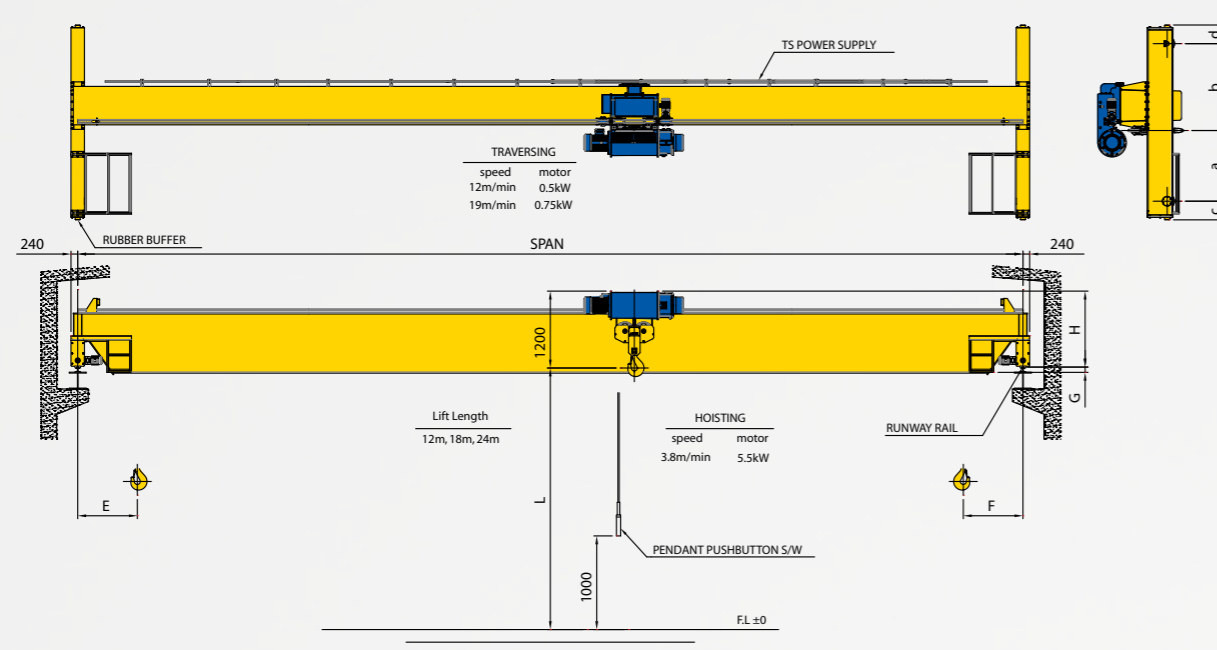

7.5ton

Type	Span	H (mm)	G (mm)	E (mm)	F (mm)	a (mm)	b (mm)	c (mm)	d (mm)	Rail min size (kg/m)	Wheel max load (kg)	Total Weight (kg)
LS 809	9	930	200	Lift 12m 900	Lift 12m 1030	900	1100	360	210	22	4620	4500
LS 810	10	1030	200			900	1100	390	280	22	4750	4800
LS 811	11	1030	200			900	1100	390	280	22	4870	5100
LS 812	12	1030	200			900	1100	390	280	22	5000	5400
LS 813	13	1030	200			900	1100	390	280	22	5110	5700
LS 814	14	1030	200			900	1100	390	280	22	5220	6000
LS 815	15	1030	200			1100	1400	390	280	22	5350	6500
LS 816	16	1030	220			1100	1400	390	280	22	5470	6800
LS 817	17	1030	270			1100	1400	390	280	22	5590	7200
LS 818	18	1030	320			1100	1400	390	280	22	5710	7600
LS 819	19	1030	320			1300	1700	390	280	22	5840	8100
LS 820	20	1130	270			1300	1700	410	310	22	6050	8900
LS 821	21	1180	270			1300	1700	410	310	22	6170	9300
LS 822	22	1180	320			1500	2000	410	310	22	6320	9900
LS 823	23	1180	370			1500	2000	410	310	22	6440	10300
LS 824	24	1180	420			1500	2000	410	310	22	6560	10700
LS 825	25	1230	370			1500	2000	410	310	22	6780	11600
LS 826	26	1230	420			1700	2300	410	310	22	6940	12200
LS 827	27	1230	470			1700	2300	410	310	22	7070	12700
LS 828	28	1230	520	1700	2300	410	310	22	7210	13200		
LS 829	29	1230	570	1950	2550	600	450	22	7600	14700		
LS 830	30	1330	520	1950	2550	600	450	22	7740	15300		
LS 831	31	1380	520	1950	2550	600	450	22	7890	15800		
LS 832	32	1380	570	1950	2550	600	450	22	8260	17300		
LS 833	33	1380	620	2200	2800	600	450	22	8470	18100		
LS 834	34	1380	670	2200	2800	600	450	22	8640	18800		
LS 835	35	1380	720	2200	2800	600	450	22	8940	20000		
LS 836	36	1380	770	2400	3100	600	450	22	9230	21100		
LS 837	37	1380	820	2400	3100	600	450	22	9480	22100		
LS 838	38	1380	870	2400	3100	600	450	22	9970	24100		
LS 839	39	1430	920	2400	3100	600	450	22	10210	24900		

Low Space Crane 10ton

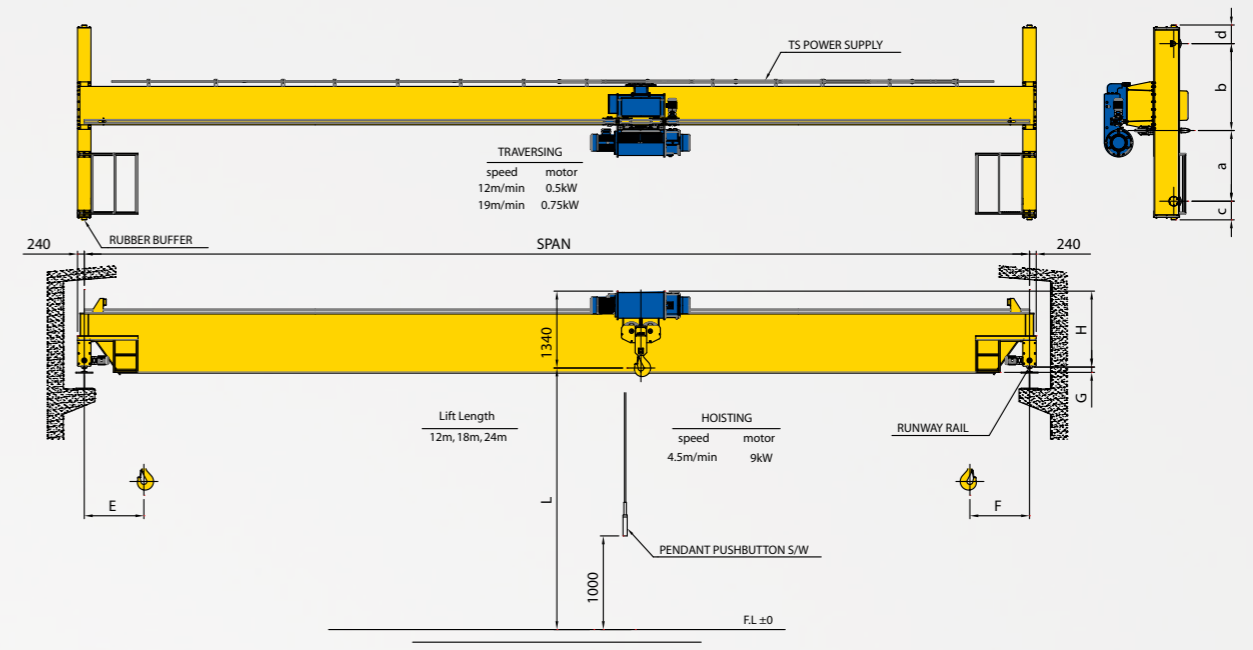

10ton

Type	Span	H (mm)	G (mm)	E (mm)	F (mm)	a (mm)	b (mm)	c (mm)	d (mm)	Rail min size (kg/m)	Wheel max load (kg)	Total Weight (kg)
LS 1009	9	1030	200	Lift 12m 900	Lift 12m 1100	900	1100	390	280	22	5840	4900
LS 1010	10	1030	200			900	1100	390	280	22	6010	5200
LS 1011	11	1030	200			900	1100	410	310	22	6150	5600
LS 1012	12	1030	200			900	1100	410	310	22	6290	5900
LS 1013	13	1030	200			900	1100	410	310	22	6430	6200
LS 1014	14	1080	200			900	1100	410	310	22	6580	6700
LS 1015	15	1080	220			1100	1400	410	310	22	6740	7200
LS 1016	16	1080	270			1100	1400	410	310	22	6870	7600
LS 1017	17	1080	200			1100	1400	410	310	22	7020	8100
LS 1018	18	1080	220			1100	1400	410	310	22	7210	8700
LS 1019	19	1080	270			1350	1650	410	310	22	7370	9300
LS 1020	20	1230	200			1350	1650	410	310	22	7500	9700
LS 1021	21	1230	220			1350	1650	410	310	22	7630	10200
LS 1022	22	1230	270			1500	2000	600	450	22	7880	11100
LS 1023	23	1230	320			1500	2000	600	450	22	8000	11500
LS 1024	24	1230	370			1500	2000	600	450	22	8120	11900
LS 1025	25	1230	420			1500	2000	600	450	22	8260	12400
LS 1026	26	1230	470			1750	2250	600	450	22	8490	13300
LS 1027	27	1280	520			1750	2250	600	450	22	8630	13900
LS 1028	28	1280	520	1750	2250	600	450	22	8890	14900		
LS 1029	29	1380	470	1950	2550	600	450	22	9120	15700		
LS 1030	30	1380	520	1950	2550	600	450	22	9490	17200		
LS 1031	31	1380	570	1950	2550	600	450	22	9660	17800		
LS 1032	32	1380	620	1950	2550	600	450	22	9830	18500		
LS 1033	33	1380	670	2200	2800	600	450	22	10250	20100		
LS 1034	34	1380	770	2200	2800	600	450	22	10430	20800		
LS 1035	35	1530	670	2200	2800	600	450	22	10620	21600		
LS 1036	36	1530	720	2400	3100	600	450	22	10850	22500		
LS 1037	37	1530	770	2400	3100	600	450	22	11520	25100		
LS 1038	38	1530	870	2400	3100	600	450	22	11890	26600		
LS 1039	39	1530	920	2400	3100	650	500	22	12110	27400		

Low Space Crane 15ton

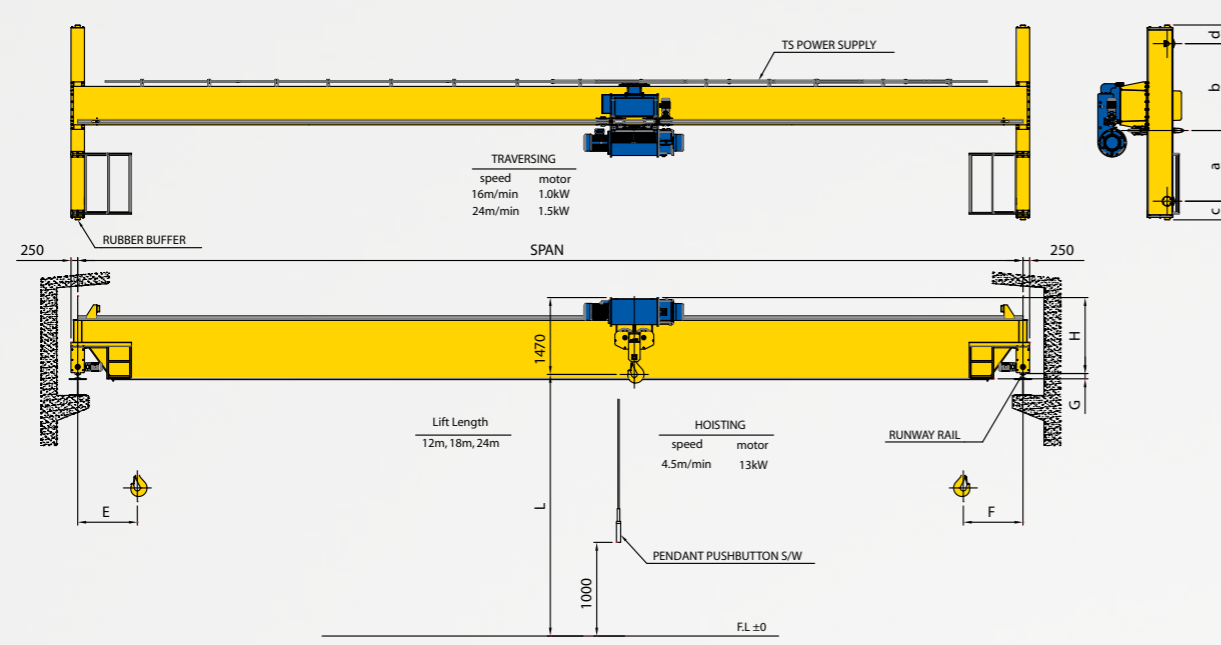

15ton

Type	Span	H (mm)	G (mm)	E (mm)	F (mm)	a (mm)	b (mm)	c (mm)	d (mm)	Rail min size (kg/m)	Wheel max load (kg)	Total Weight (kg)		
LS 1509	9	1130	200	Lift 12m 920	Lift 12m 1180	900	1100	600	450	22	8330	6000		
LS 1510	10	1130	200			900	1100	600	450	22	8550	6300		
LS 1511	11	1130	200			900	1100	600	450	22	8760	6700		
LS 1512	12	1130	200			900	1100	600	450	22	9000	7300		
LS 1513	13	1130	220			900	1100	600	450	22	9200	7800		
LS 1514	14	1130	270			900	1100	600	450	22	9370	8200		
LS 1515	15	1230	220			1150	1350	600	450	22	9560	8800		
LS 1516	16	1230	320			1150	1350	600	450	22	9720	9200		
LS 1517	17	1230	370			1150	1350	600	450	22	9940	9900		
LS 1518	18	1230	370			1150	1350	600	450	22	10100	10400		
LS 1519	19	1280	370			1300	1700	600	450	22	10330	11200		
LS 1520	20	1280	420			1300	1700	600	450	22	10480	11600		
LS 1521	21	1280	470	Lift 18m 1150	Lift 18m 1410	1300	1700	600	450	22	10750	12600		
LS 1522	22	1280	570			1500	2000	600	450	22	10920	13200		
LS 1523	23	1280	620			1500	2000	600	450	22	11080	13700		
LS 1524	24	1280	670			1500	2000	600	450	22	11240	14300		
LS 1525	25	1380	570			1500	2000	600	450	22	11570	15500		
LS 1526	26	1380	620			Lift 24m 1420	Lift 24m 1680	1700	2300	600	450	22	11740	16100
LS 1527	27	1380	670					1700	2300	600	450	22	11970	17000
LS 1528	28	1430	670					1700	2300	600	450	22	12150	17600
LS 1529	29	1430	720					1850	2650	600	450	22	12490	18900
LS 1530	30	1430	820					1850	2650	600	450	22	12680	19600
LS 1531	31	1430	820					1850	2650	650	500	22	12870	20300
LS 1532	32	1530	670					1850	2650	650	500	22	13060	21000
LS 1533	33	1530	720	2050	2950			650	500	22	13660	23400		
LS 1534	34	1580	670	2050	2950			650	500	22	13870	24200		
LS 1535	35	1580	720	2050	2950			650	500	22	14230	25600		
LS 1536	36	1580	770	2250	3250			650	500	22	14710	27500		
LS 1537	37	1630	820	2250	3250			650	500	22	14930	28300		
LS 1538	38	1630	920	2250	3250	650	500	22	15160	29200				
LS 1539	39	1630	970	2250	3250	650	500	22	15760	31600				

Low Space Crane 20ton

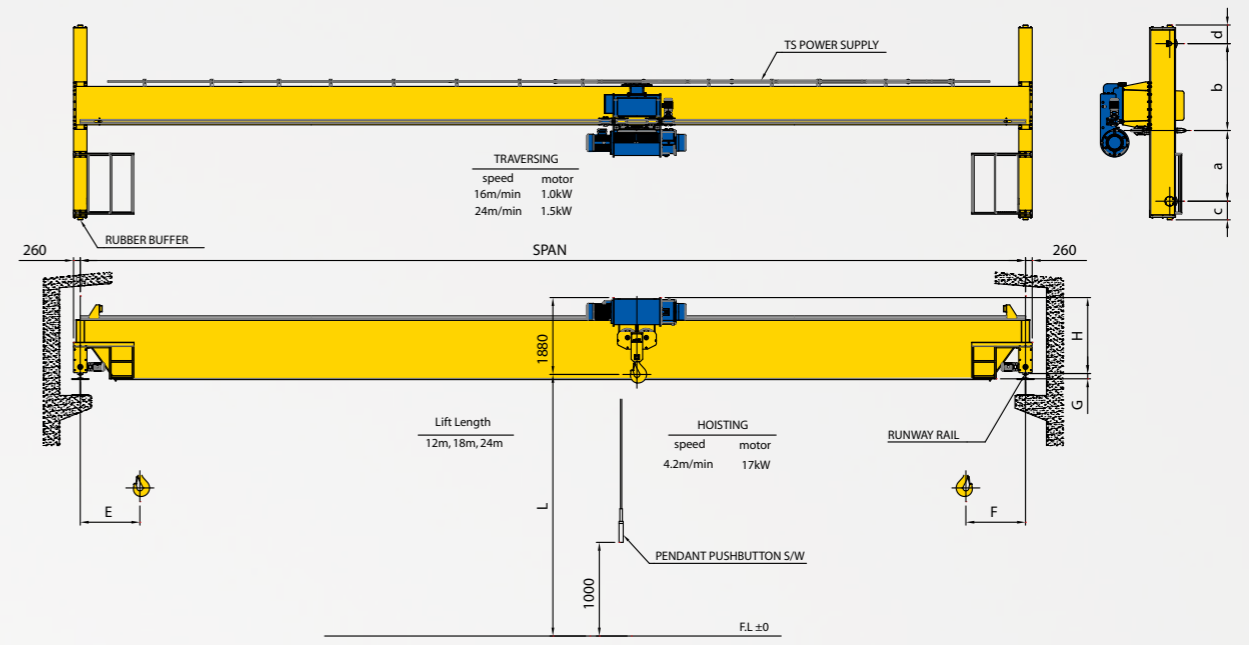

20ton

Type	Span	H (mm)	G (mm)	E (mm)	F (mm)	a (mm)	b (mm)	c (mm)	d (mm)	Rail min size (kg/m)	Wheel max load (kg)	Total Weight (kg)		
LS 2009	9	1230	200	Lift 12m 960	Lift 12m 1270	950	1050	600	450	22	10610	6400		
LS 2010	10	1230	200			950	1050	600	450	22	10910	6900		
LS 2011	11	1230	200			950	1050	600	450	22	11160	7300		
LS 2012	12	1230	220			950	1050	600	450	22	11380	7700		
LS 2013	13	1330	220			950	1050	600	450	22	11650	8300		
LS 2014	14	1330	270			950	1050	600	450	22	11830	8700		
LS 2015	15	1330	200			1150	1350	600	450	22	12040	9200		
LS 2016	16	1330	220			1150	1350	600	450	22	12300	9900		
LS 2017	17	1330	270			1150	1350	600	450	22	12560	10700		
LS 2018	18	1330	370			1150	1350	600	450	22	12710	11100		
LS 2019	19	1380	370			1300	1700	600	450	22	12920	11800		
LS 2020	20	1380	420			1300	1700	600	450	22	13260	12900		
LS 2021	21	1380	520	Lift 18m 1210	Lift 18m 1520	1300	1700	650	500	22	13400	13400		
LS 2022	22	1380	570			1500	2000	650	500	22	13680	14300		
LS 2023	23	1480	420			1500	2000	650	500	22	13860	14900		
LS 2024	24	1480	470			1500	2000	650	500	22	14120	15900		
LS 2025	25	1480	570			1500	2000	650	500	22	14400	16800		
LS 2026	26	1480	620			Lift 24m 1410	Lift 24m 1720	1700	2300	650	500	22	14630	17600
LS 2027	27	1480	670					1700	2300	650	500	22	14810	18300
LS 2028	28	1480	770					1700	2300	650	500	22	15280	20100
LS 2029	29	1530	620					1900	2600	650	500	22	15560	21100
LS 2030	30	1530	670					1900	2600	650	500	22	15760	21900
LS 2031	31	1530	720					1900	2600	650	500	22	16140	23300
LS 2032	32	1680	620					1900	2600	650	500	22	16360	24100
LS 2033	33	1680	670	2050	2950			650	500	22	16570	24900		
LS 2034	34	1680	670	2050	2950			650	500	22	16850	26000		
LS 2035	35	1680	720	2050	2950			650	500	22	17080	26800		
LS 2036	36	1680	820	2300	3200			650	500	22	17840	29800		
LS 2037	37	1780	770	2300	3200			650	500	22	18150	31000		
LS 2038	38	1780	820	2300	3200	650	500	22	18410	32000				
LS 2039	39	1780	870	2300	3200	650	500	22	18670	33000				

Low Space Crane 30ton

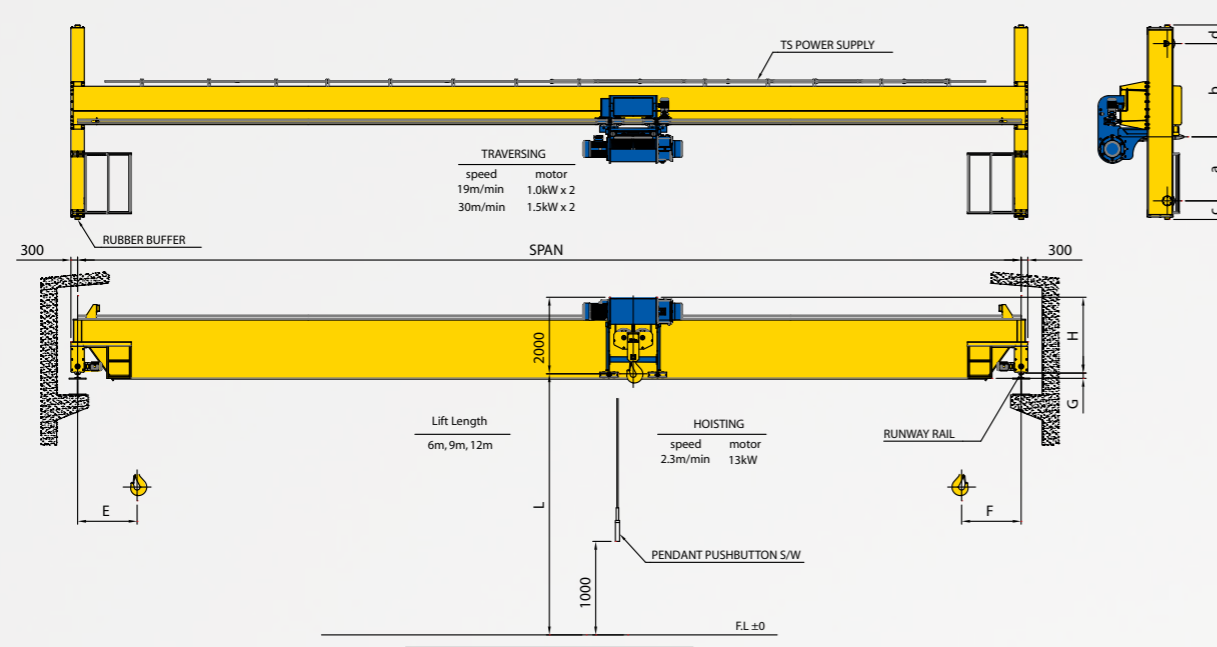

30ton

Type	Span	H (mm)	G (mm)	E (mm)	F (mm)	a (mm)	b (mm)	c (mm)	d (mm)	Rail min size (kg/m)	Wheel max load (kg)	Total Weight (kg)		
LS 3009	9	1430	200	Lift 6m 920	Lift 6m 1180	1150	1350	600	450	30	15210	8100		
LS 3010	10	1430	200			1150	1350	600	450	30	15570	8500		
LS 3011	11	1530	200			1150	1350	600	450	30	15910	9030		
LS 3012	12	1580	200			1150	1350	600	450	30	16280	9820		
LS 3013	13	1580	200			1100	1400	600	450	30	16580	10410		
LS 3014	14	1580	220			1100	1400	600	450	30	16830	10920		
LS 3015	15	1580	320			1100	1400	600	450	30	17110	11600		
LS 3016	16	1580	370			1300	1700	600	450	30	17430	12470		
LS 3017	17	1580	320			1300	1700	600	450	30	17710	13270		
LS 3018	18	1680	320			1300	1700	600	450	30	17980	14050		
LS 3019	19	1730	370			1500	2000	600	450	30	18330	15180		
LS 3020	20	1730	470			1500	2000	600	450	30	18430	15340		
LS 3021	21	1730	520	Lift 9m 1150	Lift 9m 1410	1500	2000	600	450	30	18650	15990		
LS 3022	22	1730	270			1700	2300	600	450	30	19470	19070		
LS 3023	23	1730	370			1700	2300	600	450	30	19850	21240		
LS 3024	24	1830	370			1700	2300	650	500	30	20100	22840		
LS 3025	25	1830	420			1900	2600	650	500	30	20540	23880		
LS 3026	26	1830	470			1900	2600	650	500	30	20830	24840		
LS 3027	27	1830	520			1900	2600	650	500	30	21110	27240		
LS 3028	28	1830	470			Lift 12m 1420	Lift 12m 1680	2000	2900	650	500	30	21740	28270
LS 3029	29	1830	520					2000	2900	650	500	30	22020	29680
LS 3030	30	1830	620					2050	2950	650	500	30	22400	30670
LS 3031	31	1930	570					2300	3200	650	500	30	22680	31090
LS 3032	32	1930	620					2300	3200	650	500	30	22970	31740
LS 3033	33	1930	670	2300	3200			650	500	30	23260	32830		
LS 3034	34	1930	720	2500	3500			650	500	30	23710	34550		
LS 3035	35	1980	720	2500	3500			650	500	30	24010	35680		
LS 3036	36	1980	670	2450	3550			650	500	30	24430	37260		
LS 3037	37	1980	770	2700	3800			650	500	30	25170	40180		
LS 3038	38	1980	820	2700	3800			650	500	30	25520	41510		
LS 3039	39	1980	870	2700	3800			650	500	30	25850	42770		

Low Space Crane 40ton

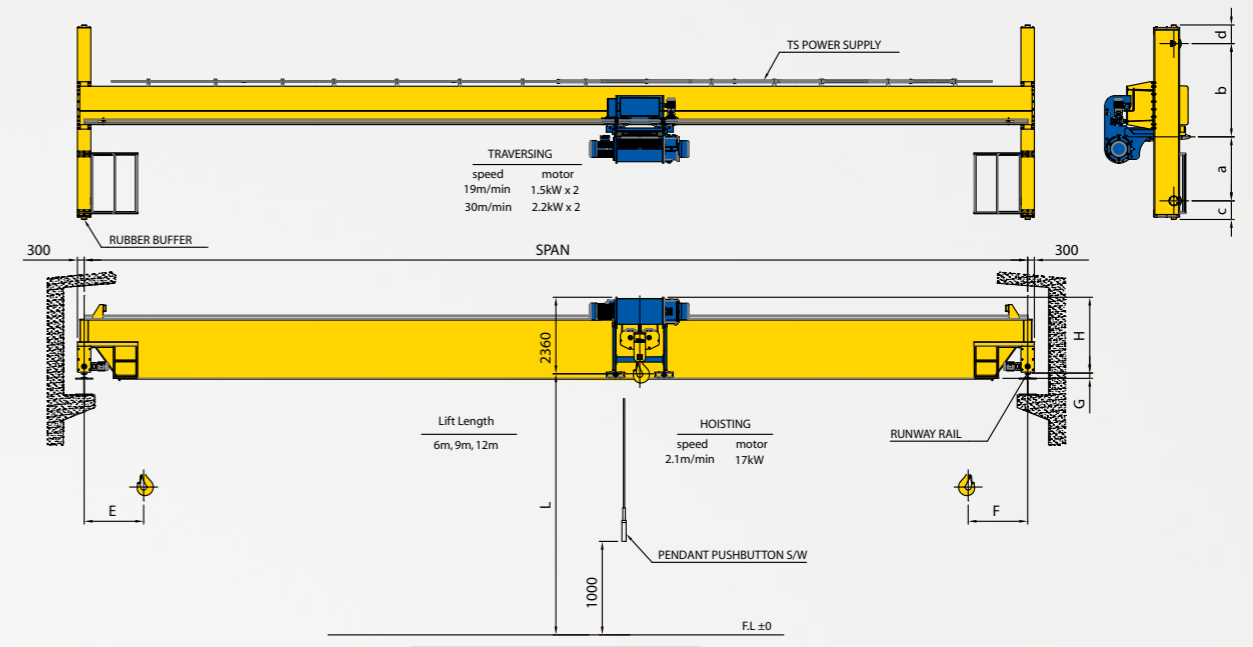

40ton

Type	Span	H (mm)	G (mm)	E (mm)	F (mm)	a (mm)	b (mm)	c (mm)	d (mm)	Rail min size (kg/m)	Wheel max load (kg)	Total Weight (kg)		
LS 4009	9	1530	200	Lift 6m 960	Lift 6m 1270	1150	1350	600	450	37	19640	10220		
LS 4010	10	1680	200			1150	1350	600	450	37	20200	10860		
LS 4011	11	1680	200			1150	1350	600	450	37	20700	11580		
LS 4012	12	1680	200			1150	1350	600	450	37	21160	12350		
LS 4013	13	1780	200			1100	1400	650	500	37	21670	13500		
LS 4014	14	1780	200			1100	1400	650	500	37	22040	14190		
LS 4015	15	1780	200			1100	1400	650	500	37	22430	15110		
LS 4016	16	1880	200			1300	1700	650	500	37	22810	16040		
LS 4017	17	1880	200			1300	1700	650	500	37	23250	17360		
LS 4018	18	1880	200			1300	1700	650	500	37	23630	18330		
LS 4019	19	1880	270			1500	2000	650	500	37	24120	19860		
LS 4020	20	1880	320			1500	2000	650	500	37	24200	19830		
LS 4021	21	1880	420	Lift 9m 1210	Lift 9m 1520	1500	2000	650	500	37	24570	20950		
LS 4022	22	1880	270			1700	2300	650	500	37	24970	22250		
LS 4023	23	1880	370			1700	2300	650	500	37	25330	23450		
LS 4024	24	1880	470			1700	2300	650	500	37	25710	24690		
LS 4025	25	1880	520			1900	2600	650	500	37	26140	26160		
LS 4026	26	2030	470			1900	2600	650	500	37	26600	27800		
LS 4027	27	2030	570			1900	2600	650	500	37	26990	29180		
LS 4028	28	2030	670			Lift 12m 1410	Lift 12m 1720	2000	2900	650	500	37	27610	31460
LS 4029	29	2030	570					2000	2900	650	500	37	27670	31510
LS 4030	30	2030	670					2000	2900	650	500	37	28080	32990
LS 4031	31	2030	670					2300	3200	650	500	37	28550	34740
LS 4032	32	2030	770					2300	3200	650	500	37	28970	36260
LS 4033	33	2130	720	2300	3200			650	500	37	29220	37130		
LS 4034	34	2130	470	2500	3500			650	500	37	30820	43410		
LS 4035	35	2130	520	2500	3500			650	500	37	31210	44850		
LS 4036	36	2130	570	2450	3550			650	500	37	31610	46330		
LS 4037	37	2280	670	2700	3800			650	500	37	32400	49390		
LS 4038	38	2280	670	2700	3800			650	500	37	32980	51610		
LS 4039	39	2280	770	2700	3800			650	500	37	33550	53800		

LS HOIST only for Low Space Crane

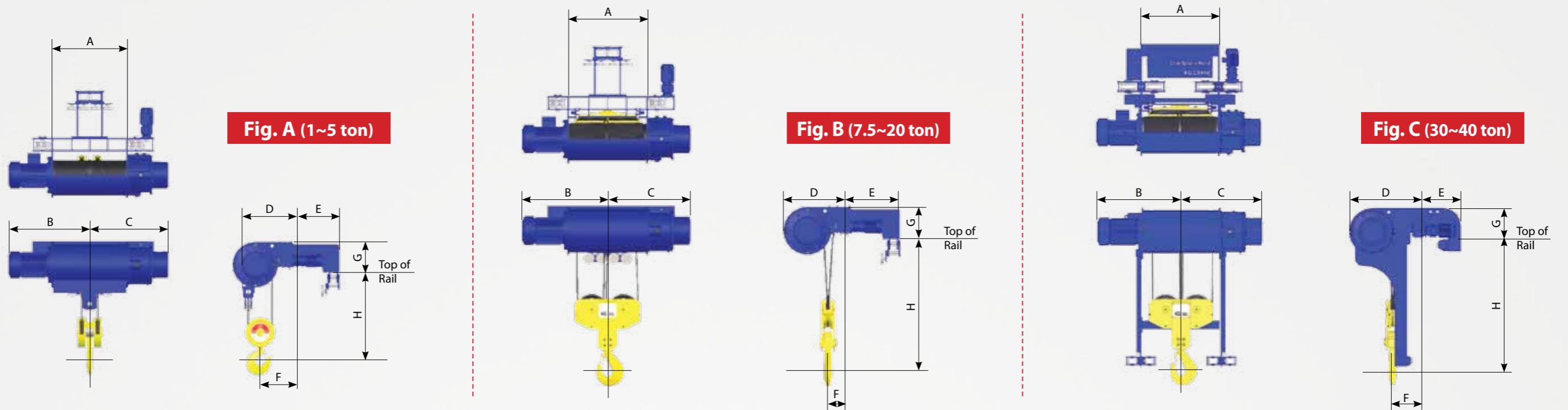

Model	Fig. (A)												Fig. (B)												Fig. (C)							
	LS 100			LS 200			LS 300			LS 500			LS 750			LS 1000			LS 1500			LS 2000			LS 3000			LS 4000				
Capacity(ton)	1			2			3			5			7.5			10			15			20			30			40				
Hoist	lift(m)	6	9	12	6	9	12	6	9	12	6	9	12	12	18	24	12	18	24	12	18	24	12	18	24	6	9	12	6	9	12	
	Speed (m/min)	6		12	5		10	4.5		9	4.2		5.6	3.8			4.5			4.5			4.2			2.3			2.1			
	Motor (kW x P)	1.2 x 8P		2.4 x 4P	1.8 x 8P		3.7 x 4P	2.8 x 8P		5.5 x 4P	4.2 x 8P		5.5 x 6P	5.5 x 6P			9 x 8P			13 x 8P			17 x 8P			13 x 8P			17 x 8P			
	Wire Rope (Dia(Ø)x No.of Ropes)	6 x 4			8 x 4			9 x 4			11.2 x 4			14 x 4			16 x 4			20 x 4			22.4 x 4			20 x 8			22.4 x 8			
Traversing	Speed(m/min)	12	19	12	19	12	19	12	19	12	19	12	19	12	19	12	19	16	24	16	24	16	24	19	30	16	24					
	Motor (kW x P)	0.5 x 6P		0.75 x 4P	0.5 x 6P		0.75 x 4P	0.5 x 6P		0.75 x 4P	0.5 x 6P		0.75 x 4P	0.5 x 6P		0.75 x 4P	0.5 x 6P		0.75 x 4P	1.0 x 6P		1.5 x 4P	1.0 x 6P		1.5 x 4P	1.0 x 6P (2Units)		1.5 x 4P (2Units)	1.5 x 6P (2Units)		2.2 x 4P (2Units)	
	Wheel(Ø)	160			160			160			160			160			160			200			200			250			315			
	Rail(kg/m)	15			15			15			15			15			15			22			22			30			37			
Dimension (mm)	Fig. (A)												Fig. (B)												Fig. (C)							
	A	485	640	795	520	665	810	500	660	820	575	735	895	990	1385	1780	990	1490	1840	1035	1485	2035	1115	1615	2015	1035	1485	2035	1115	1615	2015	
	B	480	560	640	510	585	660	540	620	700	585	665	745	840	1090	1265	955	1205	1380	1010	1235	1510	1220	1470	1670	1010	1235	1510	1220	1470	1670	
	C	505	585	665	590	665	740	620	700	780	705	785	845	930	1120	1355	1000	1250	1425	1080	1305	1580	1165	1415	1615	1080	1305	1580	1165	1415	1615	
	D	370			450			450			545			720			735			810			845			1150			1250			
	E	350			350			355			390			755			755			650			660			950			950			
	F	210			230			230			230			230			230			280			280			400			450			
	G	230			270			260			280			300			325			390			430			520			660			
H	500			550			610			825			900			1015			1080			1450			1480			1700				
Weight (kg)	250	330	410	350	400	450	480	540	600	780	850	900	1000	1280	1400	1365	1550	1690	2070	2400	2570	2600	2895	3070	3500	4000	4500	5500	6000	6500		

KG CRANES PRODUCT SELECTION

CRANE

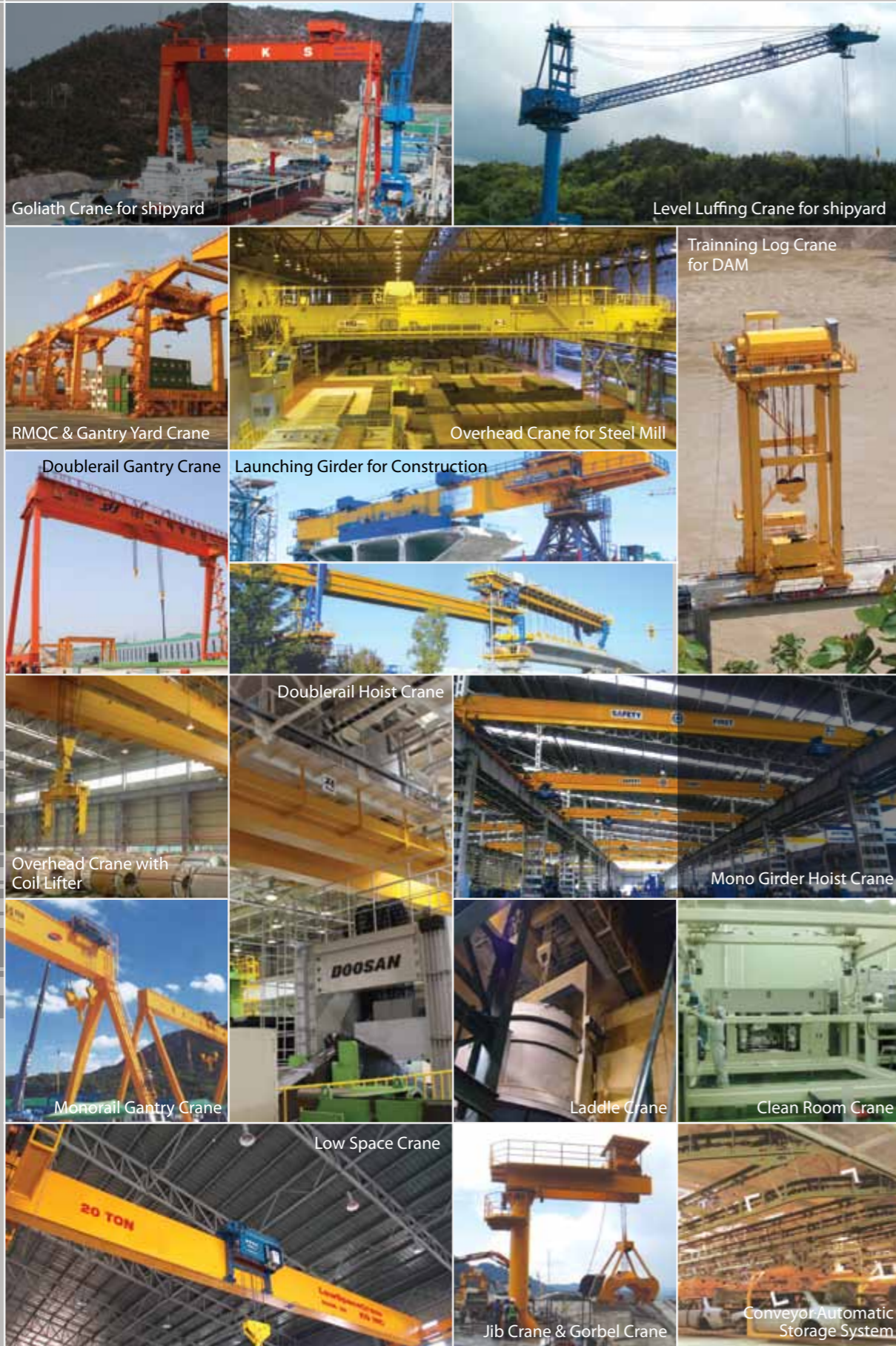

HOIST





We will lift the World

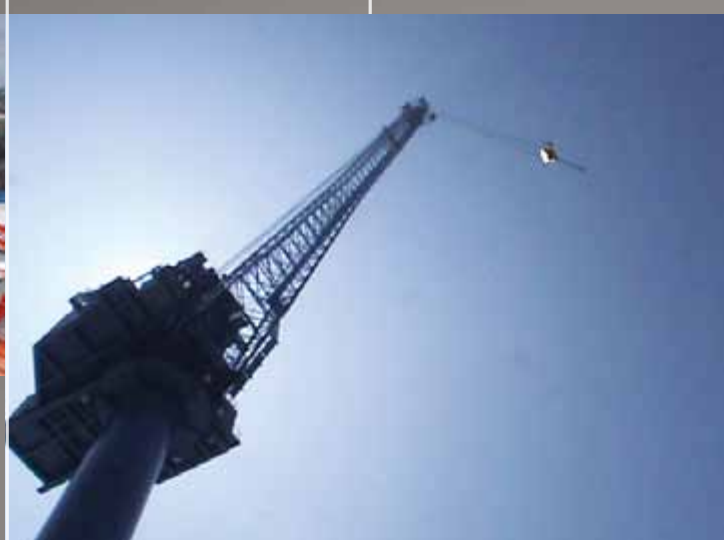

인천광역시 서구 가좌동 482-1
 Tel : 070-7455-0020
 H.P : 010-4601-8717
 Fax : 032-583-6676
 Home : www.kgcrane.com
 E-mail : cutiemon@kgcrane.com
 dirkjm@kgcrane.com



The specification of catalogue could be changed without any previous notice.

Ver.#:LSCKR201203001