



Our Company produces the marine pumps

www.kypump.co.kr

Since 1997



Since 1997

Greetings

Since our initiation of business in 1997

KYEONG YANG ENG. are doing our best to attain the best quality of products in the industry with you customers' ceaseless encourage and supports.

Our company produces the marine pumps with spare parts. Our company is doing its best to be responsible for the industry's best quality level, and to fully satisfy all of customers' demands such as quality, delivery date and prime cost, at the nearest position to the customers, always based on reliance.

This company is totally making perfection more perfect for customer's satisfaction with the acquisition of ISO9001 certificate in August of 2001 to seek the production of more systematic and revolutionary products of the best quality resolutely beyond some stereotypes.

This company will continue to make more endeavor to attain highest level of customer satisfaction with the quality principle of 'quality in high grade' and the attitude of always humbleness. We hope to always get you customers' encourage and supports without change.

President HO KYUNG YU



Contents

04	GENERAL INFORMATION
06	KVD Vertical in-line centrifugal pump, single stage & double suction
08	KVS Vertical in-line centrifugal pump, single stage & single suction
10	KVP Vertical in-line centrifugal pump, single stage & single suction
12	VS2 Vertical centrifugal pump, two stage & single suction
14	VSL Vertical centrifugal pump, single stage & single suction
16	VSH Vertical centrifugal pump, single stage & single suction
18	VCB Vertical centrifugal pump, two stage & single suction
20	HCH Horizontal centrifugal pump, two stage & single suction
22	HCC Horizontal centrifugal pump, single stage & single suction
24	HCS Horizontal centrifugal pump, single stage & single suction - self priming
26	HCD Horizontal centrifugal pump, single stage & single suction
28	HSD Horizontal centrifugal pump, single stage & single suction - self priming
30	HS Horizontal centrifugal pump, single stage & single suction
32	HU Horizontal or vertical centrifugal pump, single stage & single suction
34	HF Horizontal centrifugal pump, two stage & single suction
36	HC Horizontal centrifugal pump, single stage & single suction
38	DSF Horizontal one-rotor screw pump
40	GH Horizontal in-line gear pump
44	KHM Horizontal, multi-stage, turbine pumps
46	GV Vertical in-line gear pumps
49	V Vertical centrifugal screw pump
50	ACQUISITION OF ISO9001 APPROVED BY EQAICC
52	MECHANICAL SEAL
54	OTHER PUMP

Our Company Produces The Marine Pumps

K Y P U M P

General Information

Priming unit

When self priming system is required, vacuum pump unit driven by pump motor through clutch is provided.

During the pump operating, vacuum pump is stopped automatically by taking off clutch reflected by the pressure of handling water.



Factory Products



Standard accessories and spare parts for pumps

1) Standard accessories

- Discharge pressure gauge----- 1EA
- Suction compound gauge-----1EA
- Gauge board-----1EA
- Gauge root valve----- 2EA

2) Standard spare parts

The stuffing box is fitted with gland packing, but mechanical seal can be fitted if the customer requires it for the purpose of eliminating the adjustment of the gland.

Fitted with gland packing

Sealing water is led to stuffing box passing through throttle bush some of water is drained to bilge after sealing gland packing.

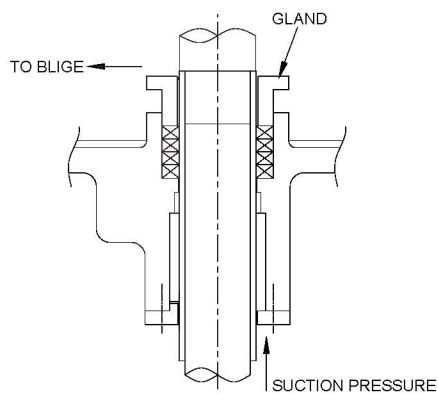

Fitted with mechanical seal

Flushing water is led to stuffing box from discharge side after removing foreign matter and returned to suction side through throttle bush after flushing mechanical seal.

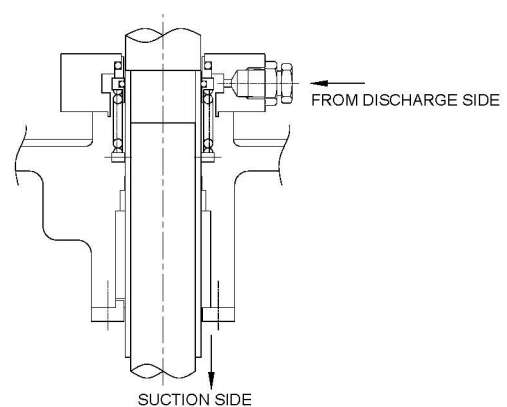

KVD Vertical in-line centrifugal pump, single stage & double suction



Construction

This pump is of the vertical single stage & double suction centrifugal type. Its rotating element is connected to an electric motor shaft through a rigid coupling.

Application

- Ballast pump
- Cooling S.W. pump (MAIN/AUX.)
- Cooling F.W. pump (MAIN/AUX.)
- General Industrial
- Other

Principal Particulars

ITEM \ MODEL		KVD-200	KVD-250	KVD-300	KVD-350	KVD-400
Rotation		Clockwise when viewed from driver end				
Suction bore (mm)		200	250	300	350	400
Discharge bore (mm)		200	250	300	350	400
Stuffing box seal		Gland packing or Mechanical seal				
Pump Weight (kg)	Cast iron	362	465	580	738	886
	Bronze	385	495	617	785	943

※If you have inquiry in excess of above range of pumps, please contact to us.

Selection Chart - Performance curve of 50Hz or from the website, please refer

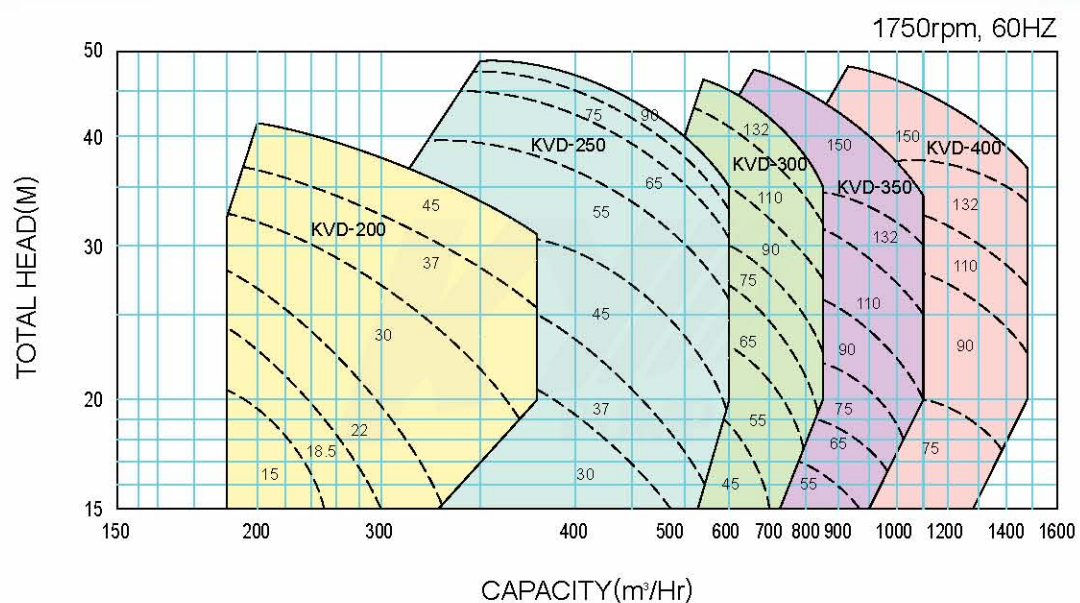

Outline Dimension

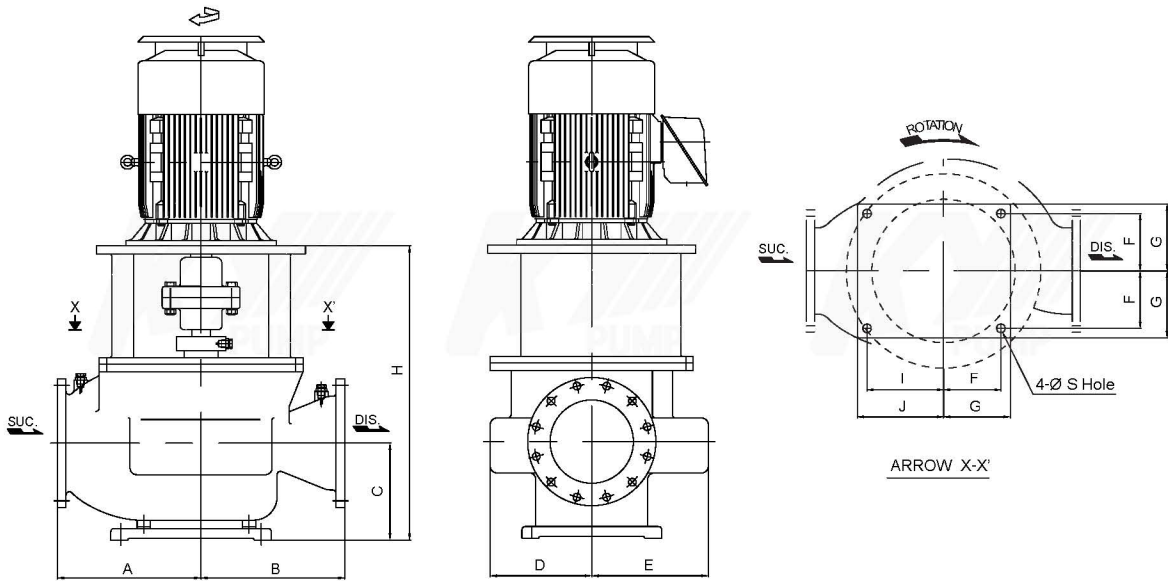

MODEL	BORE		DIMENSIONS(mm)											MOTOR POWER (KW)	PUMP WEIGHT (KG)
	SUC.	DIS.	A	B	C	D	E	F	G	H	I	J	S		
KVD-200	200	200	400	400	255	305	315	145	170	810	205	230	27	15~45	362
KVD-250	250	250	430	430	290	305	350	180	210	880	240	270	27	30~90	465
KVD-300	300	300	470	470	325	310	390	200	230	940	275	305	33	45~132	580
KVD-350	350	350	480	480	355	365	380	235	265	1030	300	330	33	55~150	738
KVD-400	400	400	600	580	410	430	495	275	305	1170	355	385	33	75~150	886

* Outline dimensions are subject to change without notice. Please ask the company for the latest drawings.

Standard sectional drawing

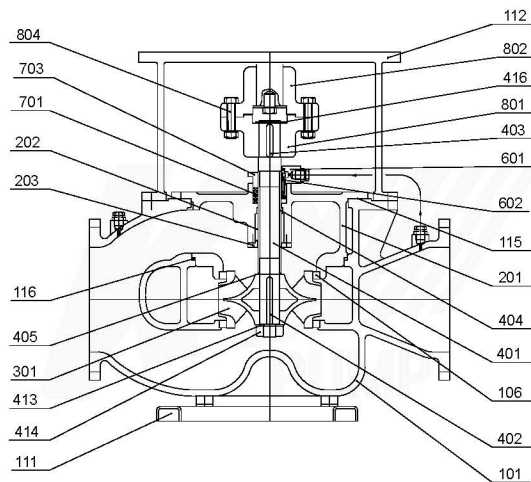

PART NO.	NAME OF PART	MATERIAL			REQ.NO FOR 1PUMP
		STANDARD		OPTION	
		NAME	KS	KS	
101	CASING	CAST IRON	GC200	BC6, SSC13	1
106	CASING RING	BRONZE	BC6		2
111	PUMP BED	CAST IRON	GC200		1
112	MOTOR FRAME	CAST IRON	GC200		1
115	GASKET	NON-ASBESTOS			1
116	O-RING	RUBBER			1
201	CASING COVER	CAST IRON	GC200	BC6, SSC13	1
202	LINE BEARING	CARBON			1
203	LINE BEARING COVER	BRONZE	BC6		1
301	IMPELLER	BRONZE	BC6	SSC13, SSC14	1
401	SHAFT	STAINLESS STEEL	STS304		1
402	IMPELLER KEY	STAINLESS STEEL	STS304		1
403	COUPLING KEY	CARBON STEEL	SM45C		1
404	SLEEVE	STAINLESS STEEL	STS304		1
405	O-RING	RUBBER			1
413	IMPELLER WASHER	STAINLESS STEEL	STS304		1
414	IMPELLER NUT	STAINLESS STEEL	STS304		1
416	SNAP RING	CARBON TOOL STEEL	SK5		1
601	MECHANICAL SEAL COVER	BRONZE	BC6	SSC13	1
602	MECHANICAL SEAL				1 set
701	GLAND PACKING	SEMI METALLIC			1 set
703	GLAND	BRONZE	BC6	SSC13	1
801	PUMP COUPLING	DUOTILE CAST IRON	GCD450		1
802	MOTOR COUPLING	DUOTILE CAST IRON	GCD450		1
804	COUPLING BOLT & NUT	MILD STEEL	SS400		1set

KVS Vertical in-line centrifugal pump, single stage & single suction

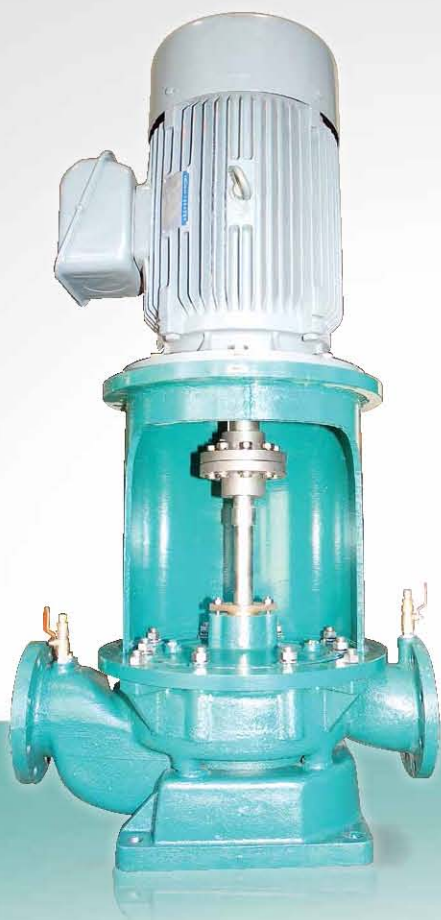

Construction

This pump is of the vertical single stage & single suction centrifugal type. Its rotating element is connected to an electric motor shaft through a rigid coupling.

Application

- Cooling S.W. pump (MAIN/AUX.)
- Cooling F.W. pump (MAIN/AUX.)
- General Industrial
- Other

Principal Particulars

ITEM \ MODEL		KVS-100	KVS-125	KVS-150
Rotation		Clockwise when viewed from driver end		
Suction bore (mm)		100	125	150
Discharge bore (mm)		100	125	150
Stuffing box seal		Gland packing or Mechanical seal		
Pump Weight (kg)	Cast iron	180	198	228
	Bronze	192	211	243

※If you have inquiry in excess of above range of pumps, please contact to us.

Selection Chart - Performance curve of 50Hz or from the website, please refer

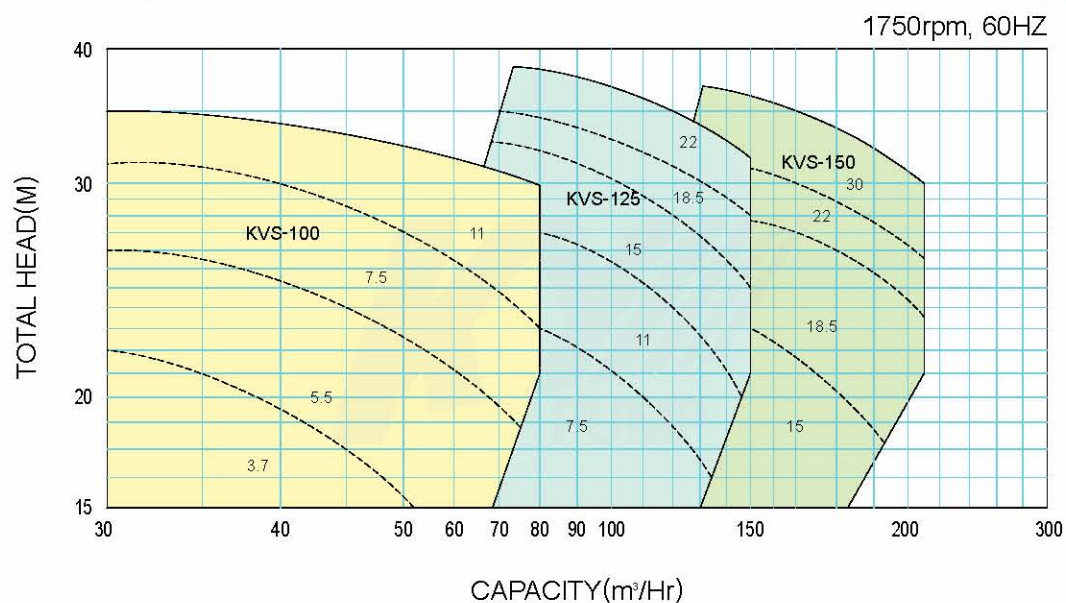

Outline Dimension

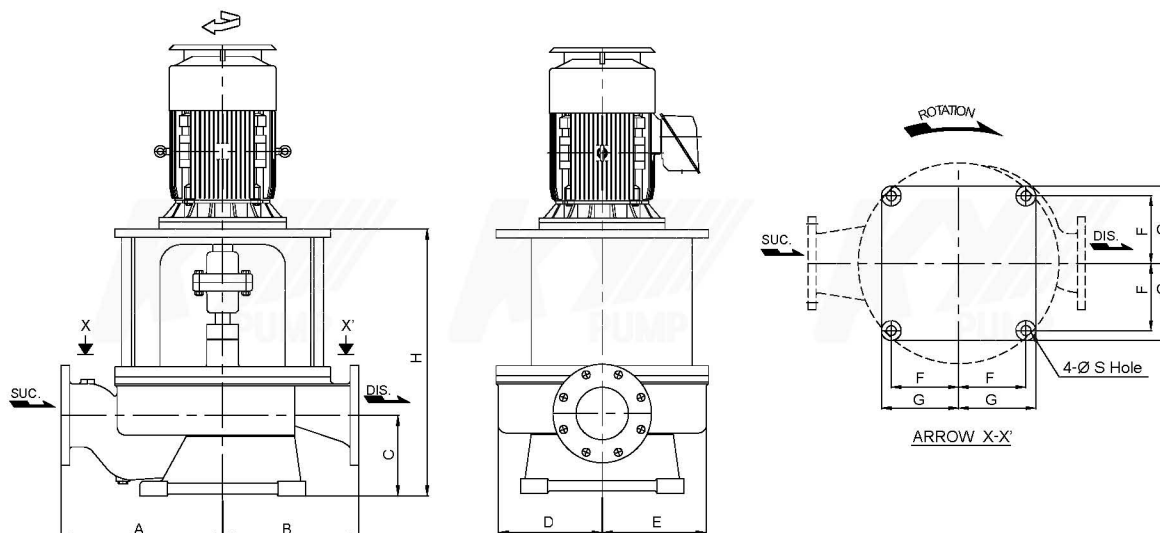

MODEL	BORE		DIMENSIONS(mm)									MOTOR POWER (KW)	PUMP WEIGHT (KG)
	SUC.	DIS.	A	B	C	D	E	F	G	H	S		
KVS-100	100	100	340	300	180	255	255	170	195	610	25	3.7~11	180
KVS-125	125	125	380	320	190	255	255	170	195	630	25	7.5~22	198
KVS-150	150	150	420	360	215	255	270	210	240	700	27	15~30	228

* Outline dimensions are subject to change without notice. Please ask the company for the latest drawings.

Standard sectional drawing

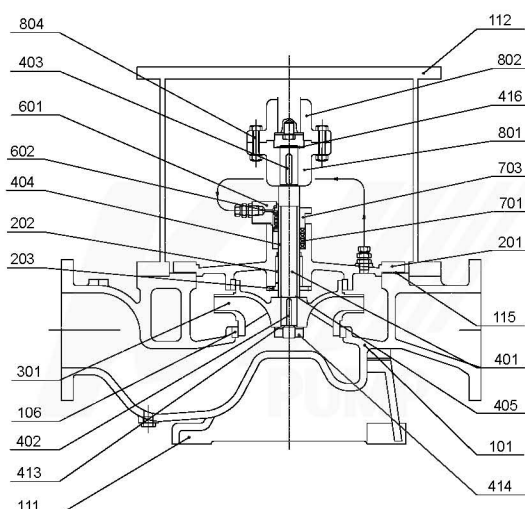

PART NO.	NAME OF PART	MATERIAL			REQ.NO FOR 1PUMP
		STANDARD		OPTION	
		NAME	KS	KS	
101	CASING	CAST IRON	GC200	BC6, SSC13	1
106	CASING RING	BRONZE	BC6		1
111	PUMP BED	CAST IRON	GC200		1
112	MOTOR FRAME	CAST IRON	GC200		1
115	GASKET	NON-ASBESTOS			1
201	CASING COVER	CAST IRON	GC200	BC6, SSC13	1
202	LINE BEARING	CARBON			1
203	LINE BEARING COVER	BRONZE	BC6		1
301	IMPELLER	BRONZE	BC6	SSC13, SSC14	1
401	SHAFT	STAINLESS STEEL	STS304		1
402	IMPELLER KEY	STAINLESS STEEL	STS304		1
403	COUPLING KEY	CARBON STEEL	SM45C		1
404	SLEEVE	STAINLESS STEEL	STS304		1
405	O-RING	RUBBER			1
413	IMPELLER WASHER	STAINLESS STEEL	STS304		1
414	IMPELLER NUT	STAINLESS STEEL	STS304		1
416	SNAP RING	CARBON TOOL STEEL	SK5		1
601	MECHANICAL SEAL COVER	BRONZE	BC6	SSC13	1
602	MECHANICAL SEAL				1 set
701	GLAND PACKING	SEMI METALLIC			1 set
703	GLAND	BRONZE	BC6	SSC13	1
801	PUMP COUPLING	DUOTILE CAST IRON	GCD450		1
802	MOTOR COUPLING	DUOTILE CAST IRON	GCD450		1
804	COUPLING BOLT & NUT	MILD STEEL	SS400		1set

KVP Vertical in-line centrifugal pump, single stage & single suction



Construction

This pump is of the vertical single stage & single suction centrifugal type. Its rotating element is connected to an electric motor shaft through a coupling space.

Application

- Air con. cooling S.W. pump
- F.W. GEN. Ejector pump
- Cooling S.W. pump
- Cooling F.W. pump
- General Industrial
- Other

Principal Particulars

MODEL		KVP-100A	KVP-100B	KVP-100D	KVP-125A	KVP-125B	KVP-125D
ITEM							
Rotation		Clockwise when viewed from driver end					
Suction bore (mm)		100	100	100	125	125	125
Discharge bore (mm)		100	100	100	125	125	125
Stuffing box seal		Gland packing or Mechanical seal					
Pump Weight (kg)	Cast iron	97	237	255	105	240	265
	Bronze	104	253	273	113	258	283

※If you have inquiry in excess of above range of pumps, please contact to us.

Selection Chart - Performance curve of 50Hz or from the website, please refer

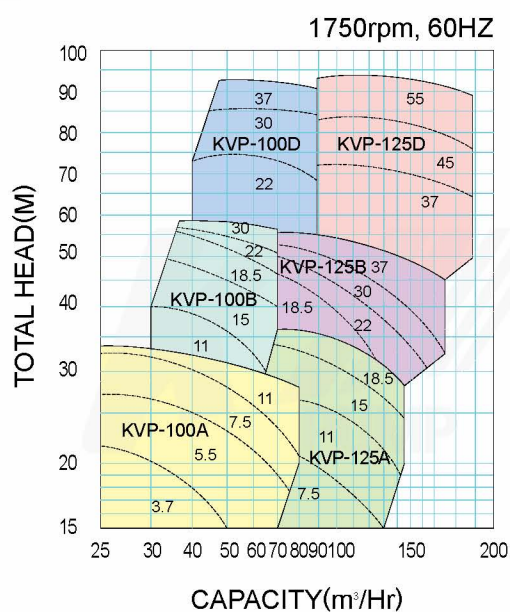

Outline Dimension

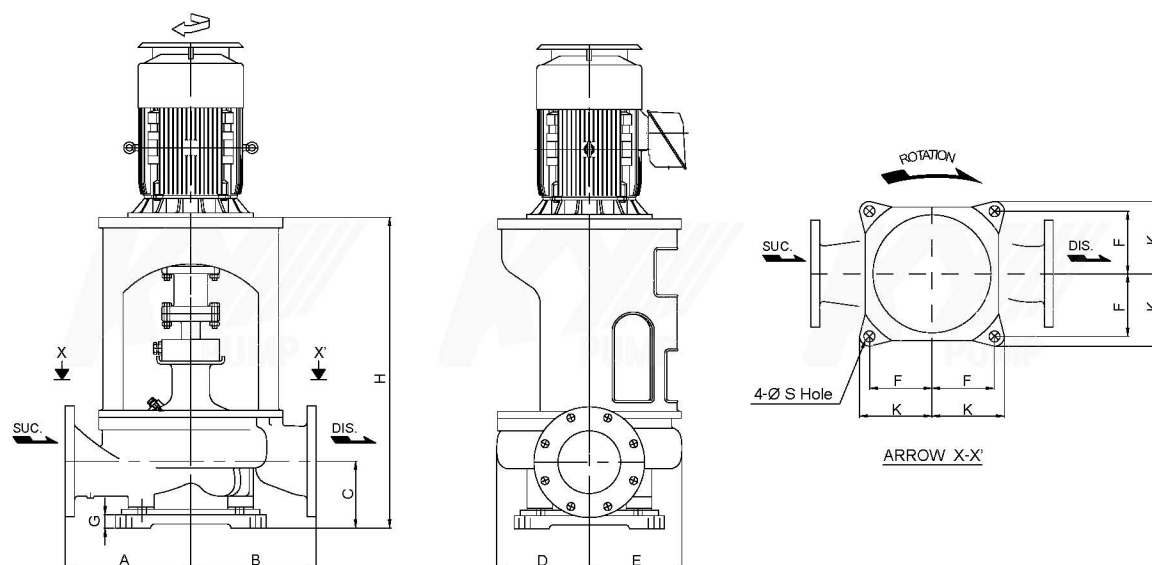

MODEL	BORE		DIMENSIONS(mm)									MOTOR POWER (kW)	PUMP WEIGHT (KG)
	SUC.	DIS.	A	C	D	E	F	G	H	K	S		
KVP-100A	100	100	250	120	190	215	155	30	720	180	27	3.7~11	97
KVP-100B	100	100	330	120	260	290	220	30	785	250	27	11~30	237
KVP-100D	100	100	330	120	260	290	220	30	672	250	27	22~37	255
KVP-125A	125	125	260	125	195	225	155	30	730	180	27	7.5~18.5	105
KVP-125B	125	125	350	130	260	290	220	30	800	250	27	18.5~37	240
KVP-125D	125	125	350	130	260	290	220	30	682	250	27	37~55	265

* Outline dimensions are subject to change without notice. Please ask the company for the latest drawings.

Standard sectional drawing

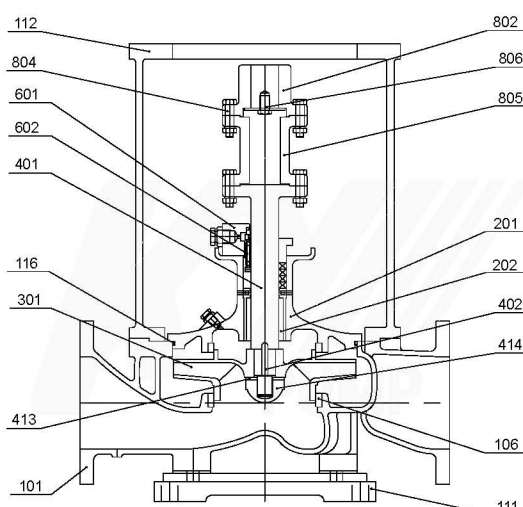

PART NO.	NAME OF PART	MATERIAL			REQ.NO FOR 1PUMP
		STANDARD NAME	KS	OPTION KS	
101	CASING	CAST IRON	GC200	BC6, SSC13	1
106	CASING RING	BRONZE	BC6		2
111	PUMP BED	CAST IRON	GC200		1
112	MOTOR FRAME	CAST IRON	GC200		1
116	O-RING	RUBBER			1
201	CASING COVER	CAST IRON	GC200	BC6, SSC13	1
202	LINE BEARING	CARBON			1
301	IMPELLER	BRONZE	BC6	SSC13, SSC14	1
401	SHAFT	STAINLESS STEEL	STS304		1
402	IMPELLER KEY	STAINLESS STEEL	STS304		1
413	IMPELLER WASHER	STAINLESS STEEL	STS304		1
414	IMPELLER NUT	STAINLESS STEEL	STS304		1
416	SNAP RING	CARBON TOOL STEEL	SK5		1
601	MECHANICAL SEAL COVER	BRONZE	BC6	SSC13	1
602	MECHANICAL SEAL				1 set
802	MOTOR COUPLING	DUCTILE CAST IRON	GCD450		1
804	COUPLING BOLT & NUT	MILD STEEL	SS400		2set
805	SPACE COUPLING	DUCTILE CAST IRON	GCD450		1
806	SHAFT BOLT & WASHER	MILD STEEL	SS400		1 set

VS2 Vertical centrifugal pump, two stage & single suction



Construction

This pump is of the vertical two stage & single suction centrifugal type. Its rotating element is connected to an electric motor shaft through a flexible coupling. The casing of this series is vertically split type.

Application

- Fire, Bilge & G/S pump
- Emergency fire pump
- General Industrial
- Other

Principal Particulars

ITEM \ MODEL		VS2-125	VS2-150	VS2-200	VS2-250
Rotation		Clockwise when viewed from driver end			
Suction bore (mm)		125	150	200	250
Discharge bore (mm)		125	150	200	250
Ball bearing		7310DB	7310DB	7312DB	7312DB
Stuffing box seal		Gland packing or Mechanical seal			
Pump Weight (kg)	Cast iron	400	420	628	685
	Bronze	426	447	668	729

※If you have inquiry in excess of above range of pumps, please contact to us.

Selection Chart

- Performance curve of 50Hz or from the website, please refer

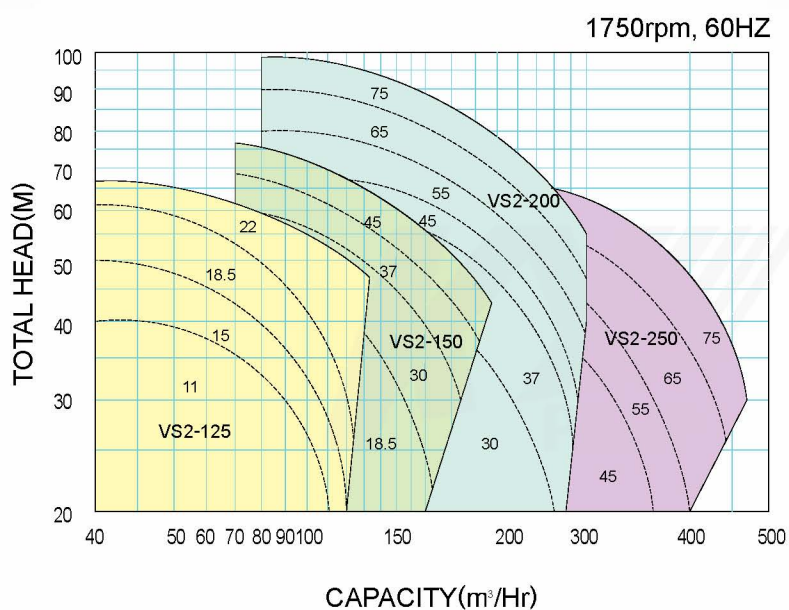

Outline Dimension

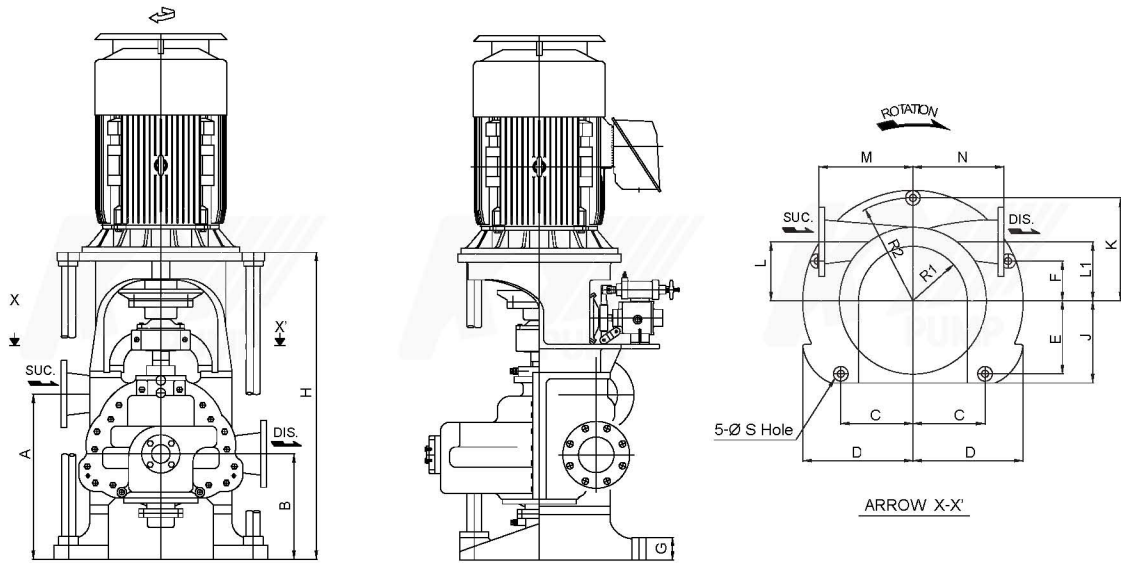

MODEL	BORE		DIMENSIONS(mm)																	MOTOR POWER (KW)	PUMP WEIGHT (KG)
	SUC.	DIS.	A	B	C	D	E	F	G	H	J	K	L	L1	M	N	R1	R2	S		
VS2-125	125	125	538	368	245	375	249	133	80	1015	280	350	200	200	320	310	190	375	24	11~22	400
VS2-150	150	150	550	368	245	375	249	133	80	1015	280	350	200	240	310	310	190	375	24	18.5~45	420
VS2-200	200	200	540	290	295	500	300	159	100	1062	350	420	220	220	360	360	235	450	28	30	628
										1140										37~75	
VS2-250	250	250	666	360	295	500	300	159	100	1270	350	420	240	240	430	430	265	450	28	45~75	685

* Outline dimensions are subject to change without notice. Please ask the company for the latest drawings.

Standard sectional drawing

PART NO.	NAME OF PART	MATERIAL			REQ.NO FOR 1PUMP
		STANDARD		OPTION	
		NAME	KS	KS	
101	CASING	CAST IRON	GC200	BC6, SSC13	1
105	END COVER	CAST IRON	GC200	BC6, SSC13	1
107	MOUTH RING	BRONZE	BC6		2
108	STAGE BUSH	BRONZE	BC6		1
109	BLIND COVER	CAST IRON	GC200		1
111	PUMP BED	CAST IRON	GC200		1
112	MOTOR FRAME	CAST IRON	GC200		1
113	STAY	SEAL GAS PIPE	SGP		2
114	NECH BUSH	BRONZE	BC6		1
201	CASING COVER	CAST IRON	GC200	BC6, SSC13	1
202	LINE BEARING	CARBON			1
301A	NO.1 IMPELLER	BRONZE	BC6	SSC13, SSC14	1
301B	NO2 IMPELLER	BRONZE	BC6	SSC13, SSC14	1
401	SHAFT	STAINLESS STEEL	STS304		1
402	IMPELLER KEY	STAINLESS STEEL	STS304		1
403	COUPLING KEY	CARBON STEEL	SM45C		1
404	NO.1 SLEEVE	STAINLESS STEEL	STS304		1
406	NO.2 SLEEVE	STAINLESS STEEL	STS304		1
408	BEARING NUT	MILD STEEL	SS400		1
409	BEARING WASHER	MILD STEEL	SS400		1
411	BALL BEARING	BEARING STEEL			2
413	IMPELLER WASHER	STAINLESS STEEL	STS304		1
414	IMPELLER NUT	STAINLESS STEEL	STS304		2
501	BEARING CASE	CAST IRON	GC200		1
502	BEARING COVER	CAST IRON	GC200		1
504A	FELT RING	FELT			1
504B	FELT RING	FELT			1
601	MECHANICAL SEAL COVER	BRONZE	BC6	SSC13	1
602	MECHANICAL SEAL				1 set
701	GLAND PACKING	SEMI METALLIC			1 set
702	LANTERN RING	BRONZE	BC6		1
703	GLAND	BRONZE	BC6	SSC13	1
801	PUMP COUPLING	CAST IRON	GC200		1
802	MOTOR COUPLING	CAST IRON	GC200		1
803	COUPLING RING	RUBBER			1
806	COUPLING BOLT,NUT & WASHER	MIND STEEL	SS400		1set

VSL Vertical centrifugal pump, single stage & single suction



Construction

This pump is of the vertical single stage & single suction centrifugal type. Its rotating element is connected to an electric motor shaft through a flexible coupling. The casing of this series is vertically split type.

Application

- Cooling S.W. pump (MAIN/AUX.)
- Cooling F.W. pump (MAIN/AUX.)
- Jacket C.F.W. pump
- General Industrial
- Other

Principal Particulars

ITEM \ MODEL		VSL-100	VSL-125	VSL-150
Rotation		Clockwise when viewed from driver end		
Suction bore (mm)		100	125	150
Discharge bore (mm)		100	125	150
Ball bearing		6308	6308	6308
Stuffing box seal		Gland packing or Mechanical seal		
Pump Weight (kg)	Cast iron	205	230	260
	Bronze	220	245	277

※If you have inquiry in excess of above range of pumps, please contact to us.

Selection Chart - Performance curve of 50Hz or from the website, please refer

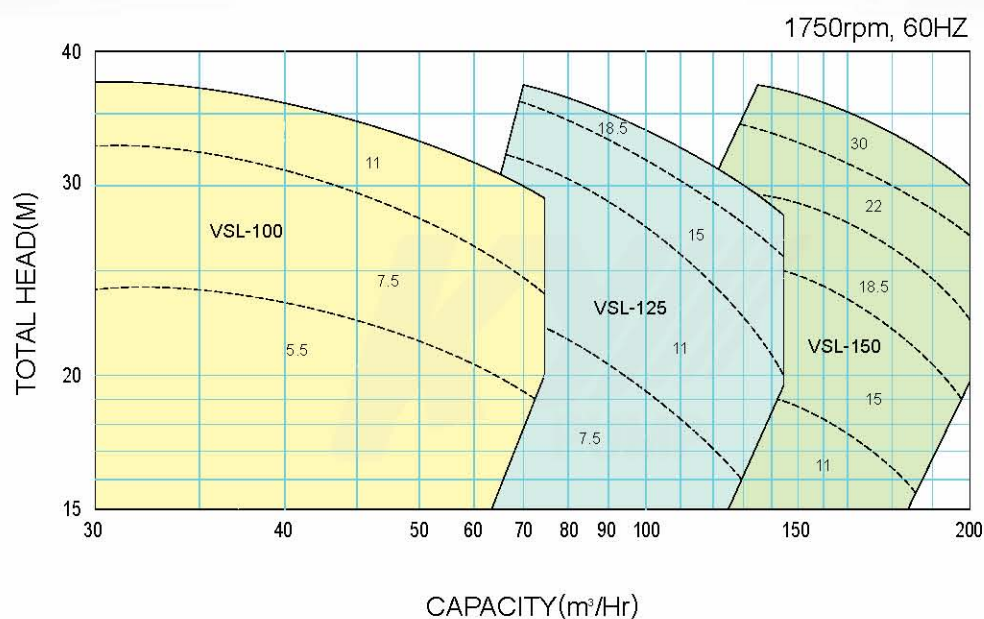

Outline Dimension

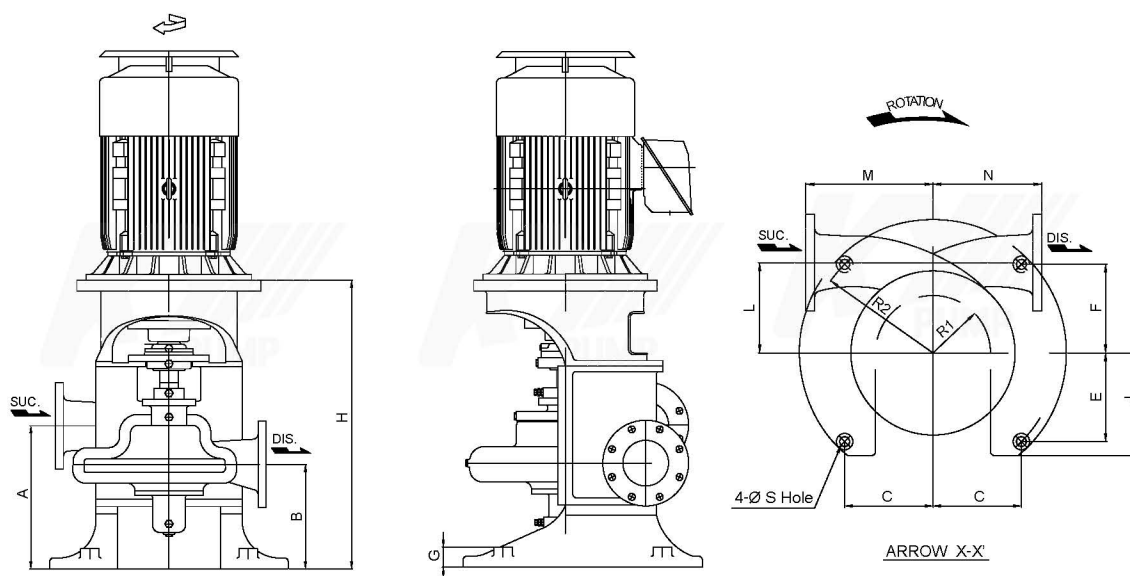

MODEL	BORE		DIMENSIONS(mm)														MOTOR POWER (KW)	PUMP WEIGHT (KG)
	SUC.	DIS.	A	B	C	E	F	G	H	J	L	M	N	R1	R2	S		
VSL-100	100	100	280	205	216	216	216	55	665	250	175	280	260	145	325	24	5.5-11	205
VSL-125	125	125	390	285	216	216	216	55	800	250	195	300	280	145	325	24	7.5-18.5	230
VSL-150	150	150	417	295	216	216	216	55	810	250	200	320	300	145	325	24	11-30	260

* Outline dimensions are subject to change without notice. Please ask the company for the latest drawings.

Standard sectional drawing

PART NO.	NAME OF PART	MATERIAL			REQ.NO FOR 1PUMP
		STANDARD		OPTION	
		NAME	KS	KS	
101	CASING	CAST IRON	GC200	BC6, SSC13	1
105	END COVER	CAST IRON	GC200	BC6, SSC13	1
107	MOUTH RING	BRONZE	BC6		2
111	PUMP BED	CAST IRON	GC200		1
112	MOTOR FRAME	CAST IRON	GC200		1
114	NECH BUSH	BRONZE	BC6		1
201	CASING COVER	CAST IRON	GC200	BC6, SSC13	1
202	LINE BEARING	CARBON			1
301	IMPELLER	BRONZE	BC6	SSC13, SSC14	1
401	SHAFT	STAINLESS STEEL	STS304		1
402	IMPELLER KEY	STAINLESS STEEL	STS304		1
403	COUPLING KEY	CARBON STEEL	SM45C		1
404	NO.1 SLEEVE	STAINLESS STEEL	STS304		1
406	NO.2 SLEEVE	STAINLESS STEEL	STS304		1
408	BEARING NUT	MILD STEEL	SS400		1
409	BEARING WASHER	MILD STEEL	SS400		1
411	BALL BEARING	BEARING STEEL			1 set
414	IMPELLER NUT	STAINLESS STEEL	STS304		1
501	BEARING CASE	CAST IRON	GC200		1
502	BEARING COVER	CAST IRON	GC200		1
504A	FELT RING	FELT			1
504B	FELT RING	FELT			1
601	MECHANICAL SEAL COVER	BRONZE	BC6	SSC13	1
602	MECHANICAL SEAL				1 set
701	GLAND PACKING	SEMI METALLIC			1 set
702	LANTERN RING	BRONZE	BC6		1
703	GLAND	BRONZE	BC6	SSC13	1
801	PUMP COUPLING	CAST IRON	GC200		1
802	MOTOR COUPLING	CAST IRON	GC200		1
803	COUPLING RING	RUBBER			1set
806	COUPLINGBOLT,NUT & WASHER	MILD STEEL	SS400		1set

VSH Vertical centrifugal pump, single stage & single suction



Construction

This pump is of the vertical single stage & single suction centrifugal type. This pump is used to high pressure with Condensate pump or Fire & G/S pump.

Application

- Condensate pump
- Fire & G/S pump
- Jacket C.F.W. pump
- General Industrial
- Other

Principal Particulars

ITEM \ MODEL		VSH-100	VSH-125	VSH-150
Rotation		Clockwise when viewed from driver end		
Suction bore (mm)		100	125	150
Discharge bore (mm)		100	125	150
Ball bearing		7308DB	7308DB	7308DB
Stuffing box seal		Gland packing or Mechanical seal		
Pump Weight (kg)	Cast iron	265	318	390
	Bronze	283	339	415

※If you have inquiry in excess of above range of pumps, please contact to us.

Selection Chart - Performance curve of 50Hz or from the website, please refer

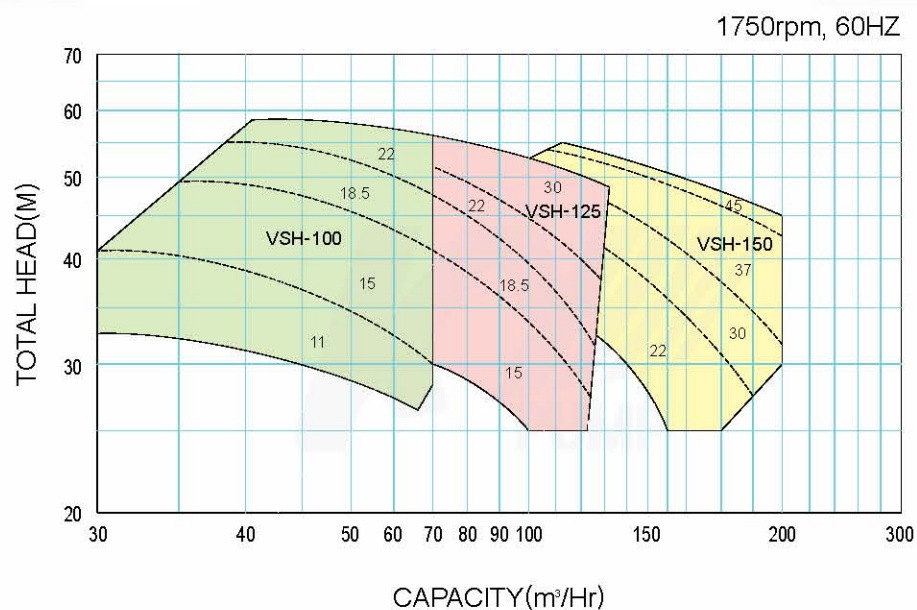

Outline Dimension

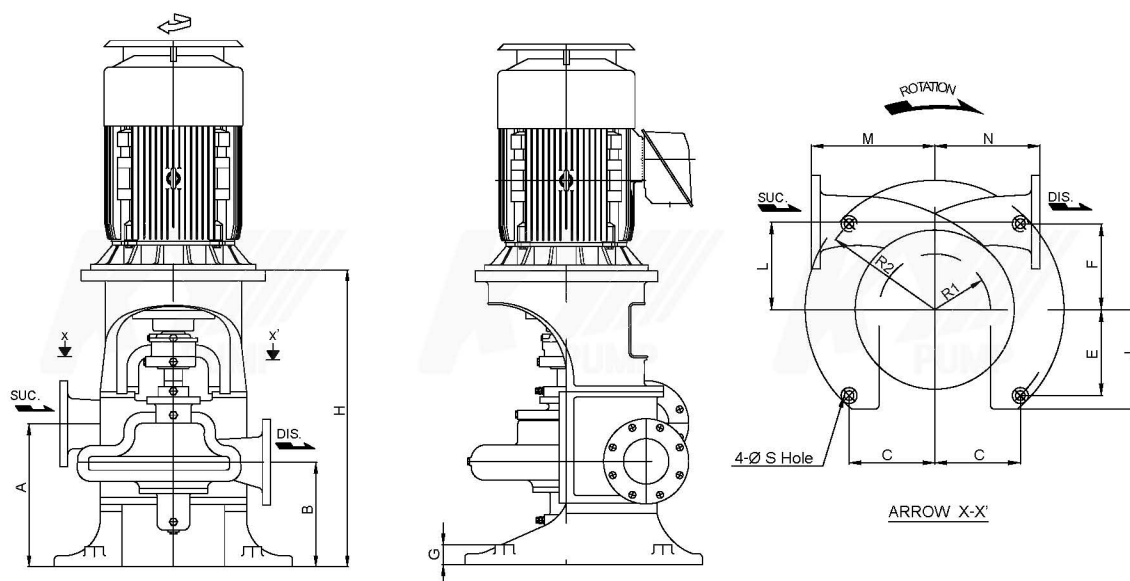

MODEL	BORE		DIMENSIONS(mm)														MOTOR POWER (KW)	PUMP WEIGHT (KG)
	SUC.	DIS.	A	B	C	E	F	G	H	J	L	M	N	R1	R2	S		
VSH-100	100	100	380	285	216	216	216	55	805	250	220	310	285	145	325	24	11~22	265
VSH-125	125	125	390	285	216	216	216	55	805	250	220	310	285	145	325	24	15~30	318
VSH-150	150	150	410	290	216	216	216	55	845	250	230	310	285	145	325	24	22~45	390

* Outline dimensions are subject to change without notice. Please ask the company for the latest drawings.

Standard sectional drawing

PART NO.	NAME OF PART	MATERIAL			REQ.NO FOR 1PUMP
		STANDARD		OPTION	
		NAME	KS	KS	
101	CASING	CAST IRON	GC200	BC6, SSC13	1
105	END COVER	CAST IRON	GC200	BC6, SSC13	1
107	MOUTH RING	BRONZE	BC6		2
111	PUMP BED	CAST IRON	GC200		1
112	MOTOR FRAME	CAST IRON	GC200		1
114	NECH BUSH	BRONZE	BC6		1
201	CASING COVER	CAST IRON	GC200	BC6, SSC13	1
202	LINE BEARING	CARBON			1
301	IMPELLER	BRONZE	BC6	SSC13, SSC14	1
401	SHAFT	STAINLESS STEEL	STS304		1
402	IMPELLER KEY	STAINLESS STEEL	STS304		1
403	COUPLING KEY	CARBON STEEL	SM45C		1
404	NO.1 SLEEVE	STAINLESS STEEL	STS304		1
406	NO.2 SLEEVE	STAINLESS STEEL	STS304		1
408	BEARING NUT	MILD STEEL	SS400		1
409	BEARING WASHER	MILD STEEL	SS400		1
411	BALL BEARING	BEARING STEEL			1 set
414	IMPELLER NUT	STAINLESS STEEL	STS304		1
501	BEARING CASE	CAST IRON	GC200		1
502	BEARING COVER	CAST IRON	GC200		1
504A	FELT RING	FELT			1
504B	FELT RING	FELT			1
601	MECHANICAL SEAL COVER	BRONZE	BC6	SSC13	1
602	MECHANICAL SEAL				1 set
701	GLAND PACKING	SEMI METALLIC			1 set
702	LANTERN RING	BRONZE	BC6		1
703	GLAND	BRONZE	BC6	SSC13	1
801	PUMP COUPLING	CAST IRON	GC200		1
802	MOTOR COUPLING	CAST IRON	GC200		1
803	COUPLING RING	RUBBER			1set
806	COUPLINGBOLT,NUT&WASHER	MILD STEEL	SS400		1set

VCB Vertical centrifugal pump, two stage & single suction



Construction

This pump is of the vertical two stage & single suction centrifugal type. Its rotating element is connected to an electric motor shaft through a flexible coupling. The casing of this series is vertically split type.

Application

- Fire, Bilge & G/S pump
- Emergency fire pump
- General Industrial
- Other

Principal Particulars

ITEM	MODEL	VCB-200
Rotation		Clockwise when viewed from driver end
Suction bore (mm)		200
Discharge bore (mm)		200
Ball bearing		6310
Stuffing box seal		Gland packing or Mechanical seal
Pump Weight (kg)	Cast iron	558
	Bronze	595

※ If you have inquiry in excess of above range of pumps, please contact to us.

Selection Chart

- Performance curve of 50Hz or from the website, please refer

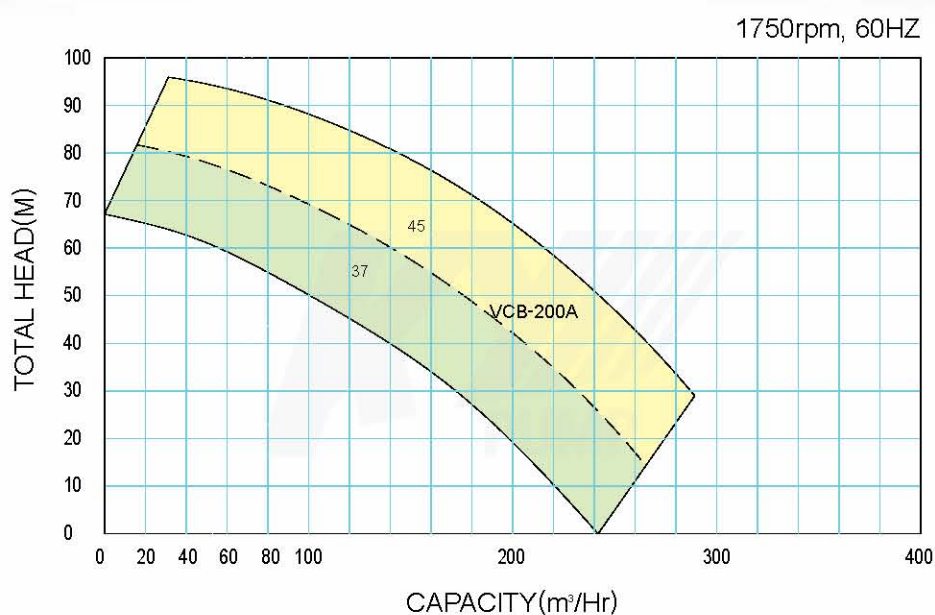

Outline Dimension

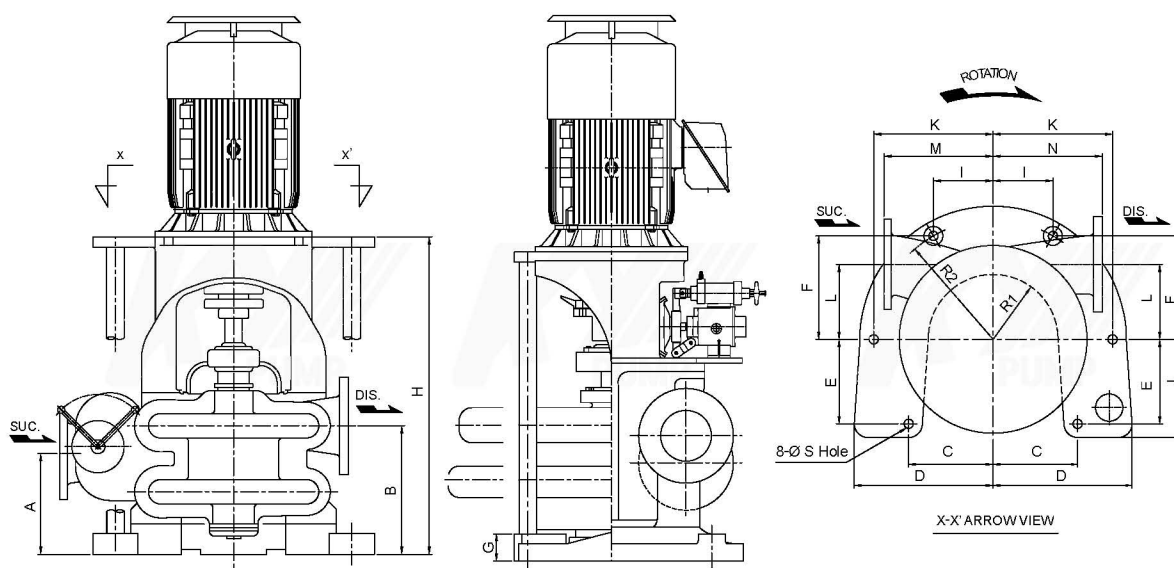

MODEL	BORE		DIMENSIONS(mm)																	MOTOR POWER (KW)	PUMP WEIGHT (KG)
	SUC.	DIS.	A	B	C	D	E	F	G	H	I	J	K	L	M	N	R1	R2	S		
VCB-200A	200	200	385	510	229	385	250	277	80	1085	155	280	317	250	540	350	165	340	22	37-45	595

* Outline dimensions are subject to change without notice. Please ask the company for the latest drawings.

Standard sectional drawing

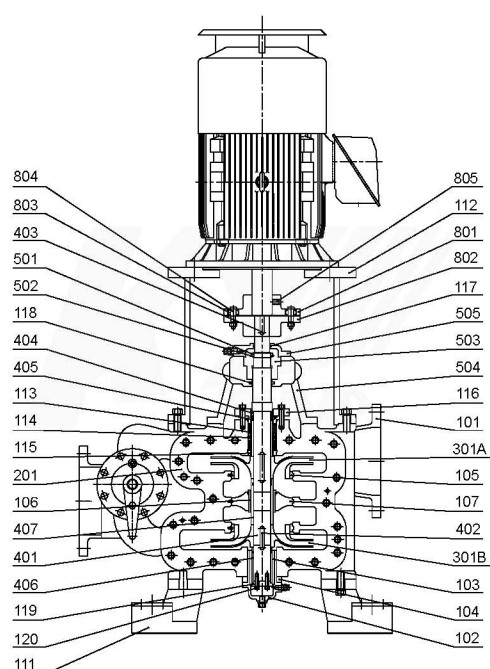

PART NO.	NAME OF PART	MATERIAL			REQ.NO FOR 1PUMP
		STANDARD		OPTION	
		NAME	KS	KS	
101	CASING	CAST IRON	GC200	BC6, SSC13	1
102	END COVER	CAST IRON	GC200	BC6, SSC13	1
103	LINE BEARING	BRONZE	BC6		1
104	END COVER PLATE	CAST IRON	GC200	BC6, SSC13	1
105	CASING RING	BRONZE	BC6		2
106	STAGE BUSH	BRONZE	BC6		1
107	STAGE RING	BRONZE	BC6		1
111	PUMP BED	CAST IRON	GC200		1
112	MOTOR FRAME	CAST IRON	GC200		1
113	GLAND PACKING	SEMI METALLIC			1SET
114	LANTERN RING	BRONZE	BC6		1
115	NECH BUSH	BRONZE	BC6		1
116	GLAND COVER	BRONZE	BC6	SSC13	1
117	FELT RING	FELT			1
118	FELT RING	FELT			1
119	IMPELLER WASHER	STAINLESS STEEL	STS304		1
120	IMPELLER BOLT	STAINLESS STEEL	STS304		1
121	VALVE ASSY				1SET
201	CASING COVER	CAST IRON	GC200	BC6, SSC13	1
301A	No.1 IMPELLER	BRONZE	BC6	SSC13, SSC14	1
301B	No.2 IMPELLER	BRONZE	BC6	SSC13, SSC14	1
401	SHAFT	STAINLESS STEEL	STS304		1
402	IMPELLER KEY	STAINLESS STEEL	STS304		1
403	COUPLING KEY	CARBON STEEL	SM45C		1
404	NO.1 SLEEVE	STAINLESS STEEL	STS304		1
405	O-RING	RUBBER			1
406	NO.2 SLEEVE	STAINLESS STEEL	STS304		1
407	STAGE SLEEVE	STAINLESS STEEL	STS304		1
501	BEARING NUT	MILD STEEL	SS400		1
502	BEARING WASHER	MILD STEEL	SS400		1
503	BALL BEARING	BEARING STEEL			2
504	BEARING CASE	CAST IRON	GC200		1
505	BEARING COVER	CAST IRON	GC200		1
801	MOTOR COUPLING	CAST IRON	GC200		1
802	PUMP COUPLING	CAST IRON	GC200		1
803	COUPLING RING	RUBBER			1SET
804	COUPLINGBOLT,NUT & WASHER	MILD STEEL	SS400		1SET
805	SET SCREW	STAINLESS STEEL	STS304		1

HCH Horizontal centrifugal pump, two stage & single suction



Construction

This pump is of the horizontal two stage & single suction centrifugal type. Its rotating element is connected to an electric motor shaft through a flexible coupling.

Application

- Boiler feed pump
- Tank cleaning pump
- General Industrial
- Other

Principal Particulars

ITEM	MODEL	HCH-50D	HCH-70D	HCH-100D	HCH-125D	HCH-150D
Rotation		Clockwise when viewed from driver end				
Suction bore (mm)		50	65	100	125	150
Discharge bore (mm)		50	65	100	125	150
Ball bearing		6309, NU309	6309, NU309	6309, NU309	6309, NU309	6309, NU309
Stuffing box seal		Gland packing				
Pump Weight (kg)	Cast iron	165	240	360	590	595
	Bronze	187	267	395	630	635

※ If you have inquiry in excess of above range of pumps, please contact to us.

Selection Chart - Performance curve of 50Hz or from the website, please refer

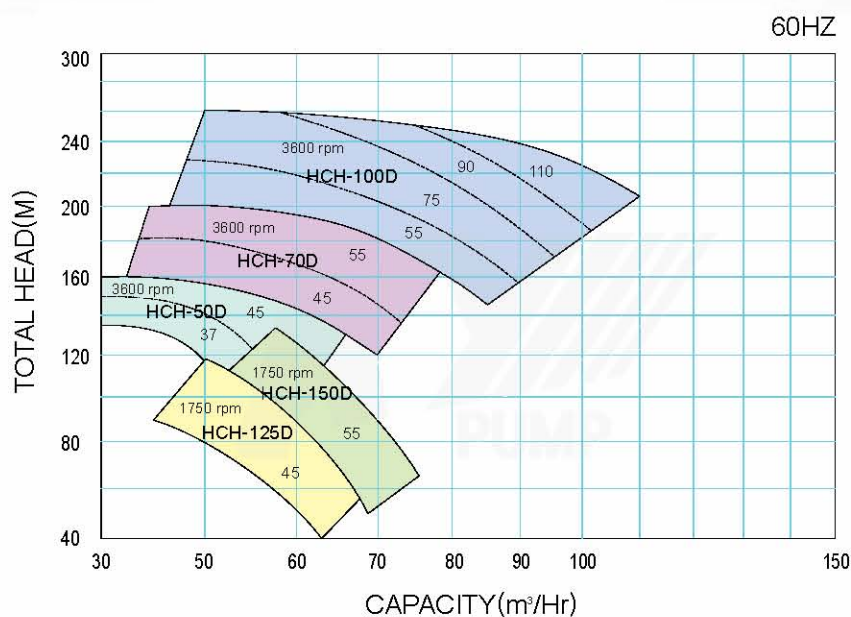

Outline Dimension

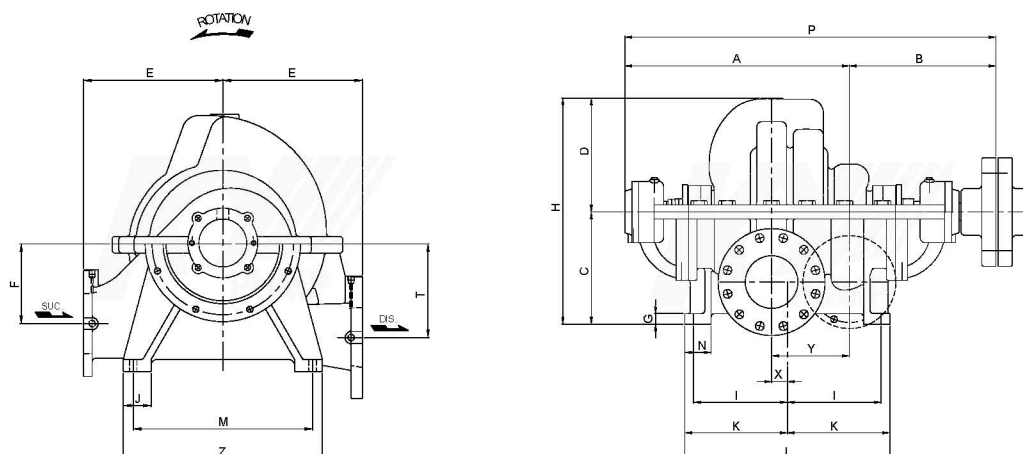

MODEL	BORE		DIMENSIONS(mm)																			MOTOR POWER (KW)	PUMP WEIGHT (KG)
	SUC.	DIS.	A	B	C	D	E	F	G	H	I	J	K	L	M	N	P	T	X	Y	Z		
HCH-50D	50	50	380	190	200	200	190	105	22	400	160	50	180	360	320	50	570	120	35	140	350	37-45	165
HCH-70D	65	65	450	240	235	220	220	115	22	455	175	55	190	380	360	60	690	135	40	165	380	45-55	240
HCH-100D	100	100	563	245	310	310	250	135	30	620	235	60	260	420	410	65	818	160	45	180	360	55-110	360
HCH-125D	125	125	635	410	320	320	350	200	30	640	255	70	280	560	430	75	1045	200	45	200	480	45	590
HCH-150D	150	150	641	418	320	325	350	200	30	645	267	70	292	585	450	75	1059	235	45	222	500	55	595

* Outline dimensions are subject to change without notice. Please ask the company for the latest drawings.

Standard sectional drawing

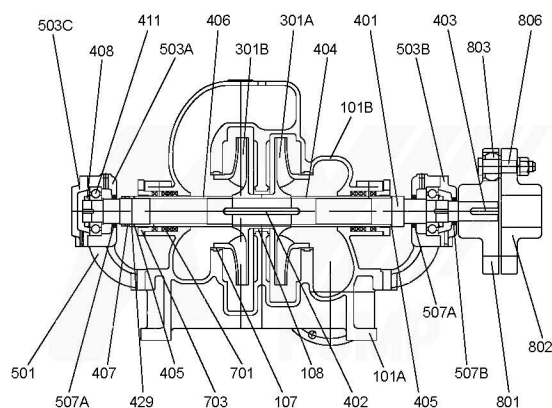

PART NO.	NAME OF PART	MATERIAL			REQ.NO FOR 1PUMP
		STANDARD		OPTION	
		NAME	KS	KS	
101A	LOWER HALF CASING	CAST IRON	GC200	BC6, SSC13	1
101B	UPPER HALF CASING	CAST IRON	GC200	BC6, SSC13	1
107	MOUTH RING	CARBON STEEL	SM45C		2
108	STAGE BUSH	BRONZE	BC6		1
301A	NO.1 IMPELLER	PHOSPHOR BRONZE	PBC2	SSC13, SSC14	1
301B	NO.2 IMPELLER	PHOSPHOR BRONZE	PBC2	SSC13, SSC14	1
401	PUMP SHAFT (WITH KEY)	STAINLESS STEEL	STS304		1
402	IMPELLER KEY	STAINLESS STEEL	STS304		1
403	COUPLING KEY	CARBON STEEL	SM45C		1
404	NO.1 SLEEVE	STAINLESS STEEL	STS304		1
405	O-RING	RUBBER			2
406	NO.2 SLEEVE	STAINLESS STEEL	STS304		1
407	SLEEVE NUT	STAINLESS STEEL	STS304		2
408	BEARING NUT (WITH WASHER)	CARBON STEEL	SM45C		2 set
411	BALL BEARING	BEARING STEEL			2
429	SPACE RING	STAINLESS STEEL	STS304		1
501	BEARING CASE	CAST IRON	GC200		2
503A	BEARING COVER	CAST IRON	GC200		2
503B	BEARING COVER	CAST IRON	GC200		1
503C	BEARING COVER	CAST IRON	GC200		1
507A	OIL SEAL	CAST IRON	GC200		2
507B	OIL SEAL	RUBBER			1
701	GLAND PACKING	SEMI METALLIC			2 set
703	GLAND	BRONZE	BC6	SSC13	2
801	PUMP COUPLING	MILD STEEL	SS400		1
802	MOTOR COUPLING	STAINLESS STEEL	STS304		1
803	COUPLING RING	STAINLESS STEEL	STS304		1set
806	COUPLING BOLT, NUT & WASHER	STAINLESS STEEL	STS304		1set

HCC Horizontal centrifugal pump, single stage & single suction



Construction

This pump is of the horizontal single stage & single suction centrifugal type. Its rotating element is connected to an electric motor shaft through a flexible coupling.

Application

- Hot water CIRC. pump
- M/E Jacket C.F.W. pump
- Cooling S.W. pump (MAIN/AUX.)
- Cooling F.W. pump (MAIN/AUX.)
- General Industrial
- Other

Principal Particulars

MODEL		HCC-40A	HCC-40B	HCC-50A	HCC-50B	HCC-65A	HCC-65B	HCC-80A	HCC-80B
ITEM									
Rotation		Clockwise when viewed from driver end							
Suction bore (mm)		40	40	50	50	65	65	80	80
Discharge bore (mm)		32 (40)	32 (40)	40 (50)	40 (50)	50 (65)	50 (65)	65 (80)	65 (80)
Ball bearing	Radial	6304	6305	6304	6305	6305	6305	6305	6307
	Thrust	6305	6306	6305	6306	6306	6306	6306	6307
Stuffing box seal		Gland packing or Mechanical seal							
Pump Weight (kg)	Cast iron	24	32	37	60	43	60	49	67
	Bronze	27	36	43	66	49	66	55	73

※ If you have inquiry in excess of above range of pumps, please contact to us.

Selection Chart - Performance curve of 50Hz or from the website, please refer

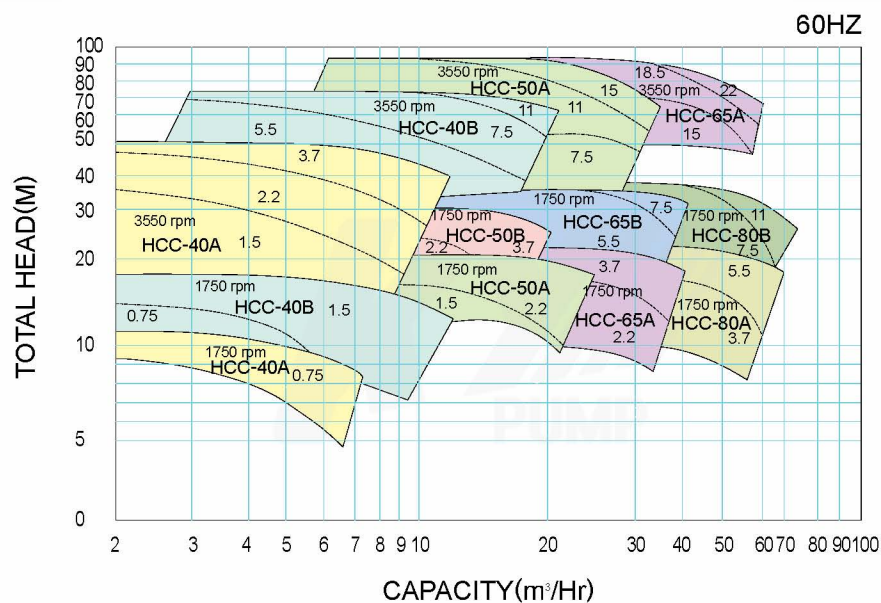

Outline Dimension

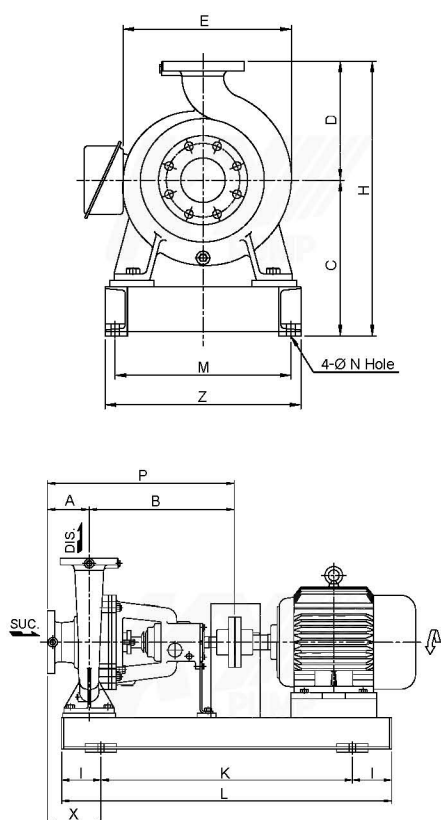

MODEL	BORE		DIMENSIONS(mm)															MOTOR POWER (KW)	PUMP WEIGHT (KG)						
	SUC.	DIS.	A	B	C	D	E	H	I	K	L	M	N	P	X	Z									
HCC-40A	40	32 [40]	80	360	227	160	207	387	130	450	710	255	15	440	125	0.75	67								
															145	1.5	77								
															290	2.2	85								
															155	3.7	92								
HCC-40B	40	32 [40]	80	360	255	180	260	435	155	500	810	280	15	440	170	315	0.75	76							
																	1.5	86							
					280	460	180	600	960	290	195	335	5.5	123											
													7.5	138											
HCC-50A	50	40 [50]	100	360	255	180	268	430	155	500	810	280	15	460	190	315	1.5	90							
																	175	2.2	98						
					280	180	460	180	600	960	290	19	215	335	7.5	143									
															11	178									
HCC-50B	50	40 [50]	100	360	275	225	340	500	130	500	760	315	15	460	152	350	15	206							
																	2.2	122							
					HCC-65A	65	50 [65]	100	360	255	180	285	480	180	600	960	290	15	460	215	335	2.2	105		
																						300	500	205	1010
130	155	500	760	810						315	15	460	152	350	15	220									
															180	400	1150	365	19	570	185	410	22	245	
HCC-65B	65	50 [65]	100	360	275	225	340	500	130	500	760	810	315	15	460	152	350	18.5	245						
																		182	7.5	130					
					HCC-80A	80	65 [80]	100	360	275	225	326	500	130	155	500	760	810	315	15	460	152	350	5.5	137
																								182	3.7
HCC-80B	80	65 [80]	100	470	320	250	364	570	180	600	960	365	19	570	185	410	135	5.5	137						
																		130	400	1150	365	19	570	185	410

* Outline dimensions are subject to change without notice.
Please ask the company for the latest drawings.

Standard sectional drawing

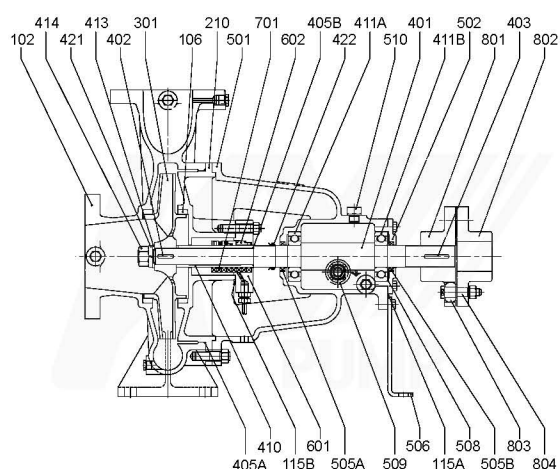

PART NO.	NAME OF PART	MATERIAL			REQ.NO FOR 1PUMP
		STANDARD		OPTION	
		NAME	KS	KS	
102	VOLUTE CASING	CAST IRON	GC200	BC6, SSC13	1
106	CASING RING	BRONZE	BC6		2
115A	GASKET	OIL PAPER			1
115A	GASKET	NON-ASBESTOS			1
210	CASING COVER	CAST IRON	GV200	BC6, SSC13	1
310	IMPELLER	BRONZE	BC6	SSC13, SSC14	1
401	SHAFT	STAINLESS STEEL	STS304		1
402	IMPELLER KEY	STAINLESS STEEL	STS304		1
403	COUPLING KEY	CARBON STEEL	SM45C		1
405A	O-RING	RUBBER			1
405B	O-RING	RUBBER			1
410	SLEEVE	STAINLESS STEEL	STS304		1
411A	BALL BEARING	BEARING STEEL			1
411A	BALL BEARING	BEARING STEEL			1
413	IMPELLER WASHER	STAINLESS STEEL	STS304		1
414	IMPELLER NUT	STAINLESS STEEL	STS304		1
421	SPRING LOCK WASHER	STAINLESS STEEL	STS304		1
422	THROWER	RUBBER			1
501	BEARING CASE	CAST IRON	GC200		1
502	BEARING COVER	CAST IRON	GC200		1
505A	OIL SEAL	RUBBER			1
505B	OIL SEAL	RUBBER			1
506	SUPPORT	MILD STEEL	SS400		1
508	WAVE SPRING	SPRING STEEL	SPS6		1
509	OIL SIGHT GAUGE	PLASTIC			1
510	AIR RELEASE FILTER	PLASTIC			1
601	SEAL COVER	BRONZE	BC6	SSC13	1
602	MECHANICAL SEAL				1SET
701	GLAND PACKING	SEMI METALLIC			1SET
801	PUMP COUPLING	GAST IRON	GC200		1
802	MOTOR COUPLING	CAST IRON	GC200		1
803	COUPLING RING	RUBBER			1SET
804	COUPLINGBOLT,NUT & WASHER	MILD STEEL	SS400		1SET

HCS Horizontal centrifugal pump, single stage & single suction-self priming

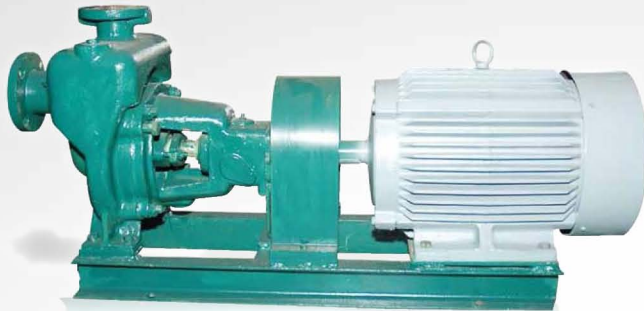

Construction

This pump is of the horizontal single stage & single suction centrifugal type.

Its rotating element is connected to an electric motor shaft through a flexible coupling.

Application

- Ballast pump
- Fine, Bilge & G. S. pump
- M/E Cooler CHEM
- CLEAN pump
- General Industrial
- Other

Principal Particulars

ITEM \ MODEL		HCS-40	HCS-50	HCS-65A	HCS-65B	HCS-80A	HCS-80B	HCS-100
Rotation		Clockwise when viewed from driver end						
Suction bore (mm)		40	50	65	65	80	80	100
Discharge bore (mm)		32 (40)	40 (50)	50 (65)	50 (65)	65 (80)	65 (80)	80 (100)
Ball bearing	Radial	6304	6305	6305	6305	6305	6307	6307
	Thrust	6305	6306	6306	6306	6306	6307	6307
Stuffing box seal		Gland packing or Mechanical seal						
Pump Weight (kg)	Cast iron	29	47	48	63	68	93	96
	Bronze	32	50	51	66	71	96	99

※ If you have inquiry in excess of above range of pumps, please contact to us.

Selection Chart - Performance curve of 50Hz or from the website, please refer

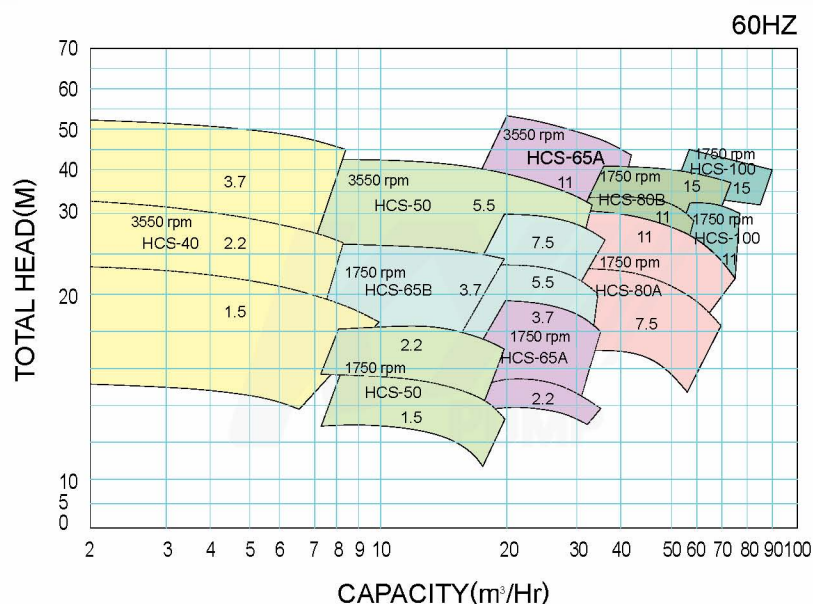

Outline Dimension

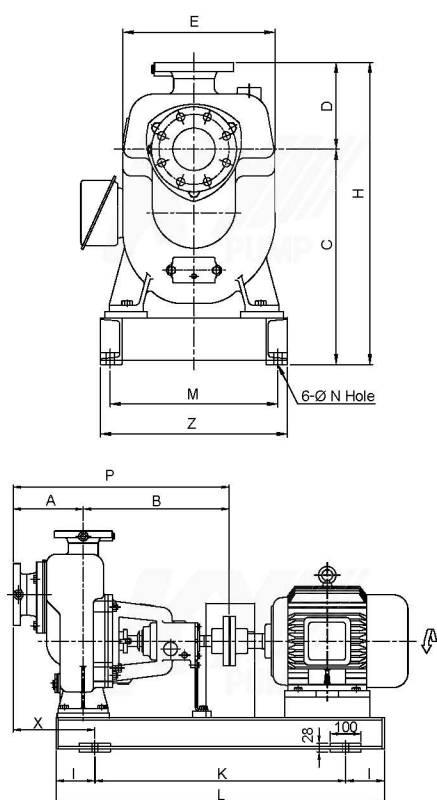

MODEL	BORE		DIMENSIONS(mm)														MOTOR POWER (KW)	PUMP WEIGHT (KG)
	SUC.	DIS.	A	B	C	D	E	H	I	K	L	M	N	P	X	Z		
HCS-40	40	32 (40)	150	355	327	100	207	427	130	450	710	255	15	505	215	290	1.5	81
																	2.2	90
																	3.7	97
HCS-50	50	40 (50)	178	355	345	158	265	523	130	450	710	280	15	533	248	315	1.5	100
																	2.2	108
																	5.5	138
HCS-65A	65	50 (65)	168	355	168	262	523	130	450	710	280	15	523	258	315	315	2.2	108
																	3.7	115
																	11	197
HCS-65B	65	50 (65)	188	355	415	155	313	570	130	500	760	810	315	15	543	243	3.7	135
																	5.5	142
																	7.5	150
HCS-80A	80	65 (80)	205	470	470	200	337	670	180	600	960	355	19	675	295	410	7.5	140
																	11	147
HCS-80B	80	65 (80)	215	470	520	200	384	720	130	400	1060	395	19	685	255	440	11	205
																	15	250
																	15	250
HCS-100	100	80 (100)	225	470	495	205	358	700	130	400	1060	395	19	695	265	440	11	252
																	15	280

* Outline dimensions are subject to change without notice.
Please ask the company for the latest drawings.

Standard sectional drawing

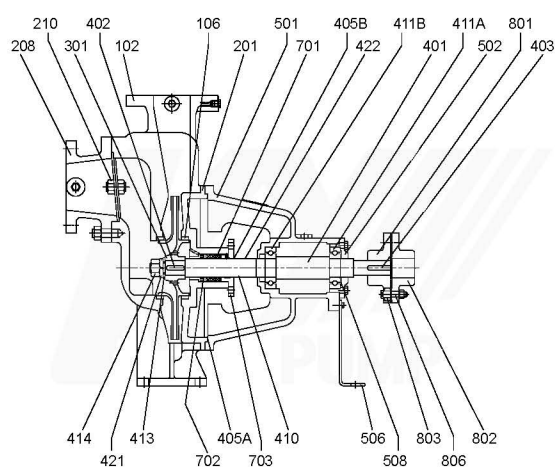

PART NO.	NAME OF PART	MATERIAL			REQ.NO FOR 1PUMP
		STANDARD		OPTION	
		NAME	KS	KS	
101	VOLUTE CASING	CAST IRON	GC200	BC6, SSC13	1
106	CASING RING	BRONZE	BC6		2
201	CASING COVER	CAST IRON	GC200	BC6, SSC13	1
208	SUCTION BRANCH	CAST IRON	GC200	BC6, SSC13	1
210	NON RETURN VALVE	CAST IRON	GC200	BC6	1
301	IMPELLER	BRONZE	BC6	SSC13, SSC14	1
401	SHAFT	STAINLESS STEEL	STS304		1
402	IMPELLER KEY	STAINLESS STEEL	STS304		1
403	COUPLING KEY	CARBON STEEL	SM45C		1
405A	O-RING	RUBBER			1
405B	O-RING	RUBBER			1
410	SLEEVE	STAINLESS STEEL	STS304		1
411A	BALL BEARING	BEARING STEEL			1
411B	BALL BEARING	BEARING STEEL			1
413	IMPELLER WASHER	STAINLESS STEEL	STS304		1
414	IMPELLER NUT	STAINLESS STEEL	STS304		1
421	SPRING LOCK WASHER	STAINLESS STEEL	STS304		1
422	THROWER	RUBBER			1
501	BEARING CASE	CAST IRON	GC200		1
502	BEARING COVER	CAST IRON	GC200		1
506	SUPPORT	MILD STEEL	SS400		1
508	WAVE SPRING	SPRING STEEL	SPS6		1
701	GLAND PACKING	SEMI METALLIC			1 set
702	LANTERN RING	BRONZE	BC6		1
703	GLAND	BRONZE	BC6	SSC13	1
801	PUMP COUPLING	CAST IRON	GC200		1
802	MOTOR COUPLING	CAST IRON	GC200		1
803	COUPLING RING	RUBBER			1 set
806	COUPLING BOLT, NUT & WASHER	MILD STEEL	SS400		1 set

HCD Horizontal centrifugal pump, single stage & single suction

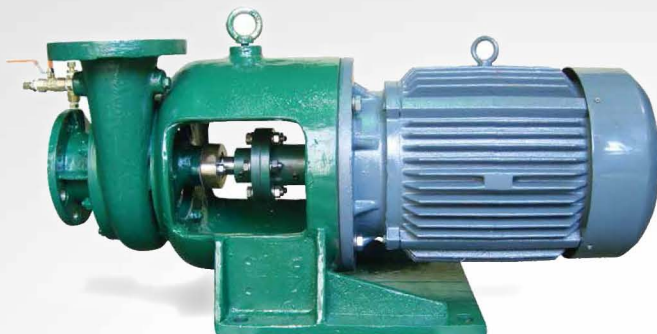

Construction

This pump is of the horizontal single stage & single suction centrifugal type. Its rotating element is connected to an electric motor shaft through a rigid coupling and no bearing is provided in the pump.

Application

- S. water service pump
- Cooling S.W. pump (MAIN/AUX.)
- Cooling F.W. pump (MAIN/AUX.)
- General Industrial
- Other

Principal Particulars

ITEM \ MODEL		HCD-50	HCD-65A	HCD-65B	HCD-80A	HCD-80B	HCD-100
Rotation		Clockwise when viewed from driver end					
Suction bore (mm)		50	65	65	80	80	100
Discharge bore (mm)		50	65	65	80	80	100
Ball bearing	Radial	6304	6305	6305	6305	6307	6307
	Thrust	6305	6306	6306	6306	6307	6307
Stuffing box seal		Gland packing or Mechanical seal					
Pump Weight (kg)	Cast iron	23	32	37	43	49	68
	Bronze	26	36	41	46	53	73

※ If you have inquiry in excess of above range of pumps, please contact to us.

Selection Chart - Performance curve of 50Hz or from the website, please refer

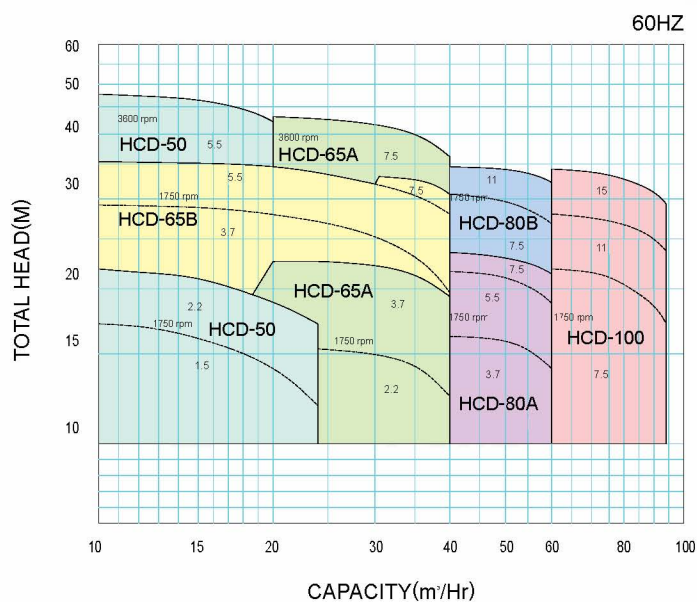

Outline Dimension

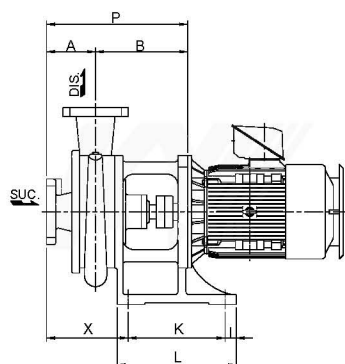
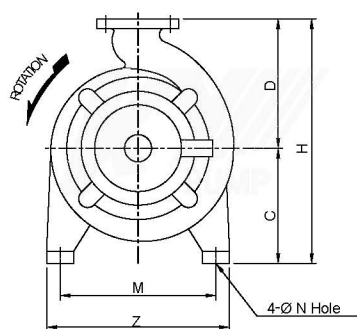

MODEL	BORE		DIMENSIONS(mm)													MOTOR POWER (KW)	PUMP WEIGHT (KG)
	SUC.	DIS.	A	B	C	D	H	I	K	L	M	N	P	X	Z		
HCD-50	50	50	100	215	190	180	370	50	150	250	220	315	280	1.5	58		
				225	210	200	390		180	280	270	325		250	2.2	58	
				245	210	200	390		200	300	270	345		330	5.5	107	
HCD-65A	65	65	100	227	190	200	390	50	180	280	220	327	280	2.2	67		
				247	210	200	410		200	300	270	347		330	3.7	86	
				247	210	200	410		200	300	270	347		330	7.5	120	
HCD-65B	65	65	100	227	190	225	415	50	180	280	220	327	280	3.7	92		
				247	210	435	200		300	270	347	330		5.5	122		
				247	210	435	200		300	270	347	330		7.5	125		
HCD-80A	80	80	100	232	190	225	415	50	180	280	220	332	280	3.7	97		
				252	210	225	435		200	300	270	352		330	5.5	127	
				252	210	225	435		200	300	270	352		330	7.5	132	
HCD-80B	80	80	100	252	250	250	500	50	200	300	270	352	212	350	7.5	138	
				282	250	250	500		200	300	270	382			350	11	189
HCD-100	100	100	125	253	250	280	530	50	200	300	270	378	238	350	7.5	156	
				283	250	280	530		200	300	270	408			350	11	208
				283	250	280	530		200	300	270	408			350	15	215

* Outline dimensions are subject to change without notice.
Please ask the company for the latest drawings.

Standard sectional drawing

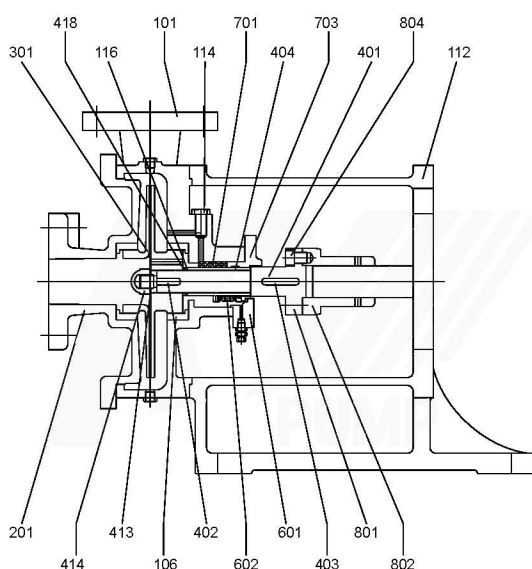

PART NO.	NAME OF PART	MATERIAL			REQ.NO FOR 1PUMP
		STANDARD		OPTION	
		NAME	KS	KS	
101	CASING	CAST IRON	GC200	BC6, SSC13	1
106	CASING RING	BRONZE	BC6		2
112	FRAME	CAST IRON	GC200		1
114	NECK BUSH	BRONZE	BC6		1
116	O-RING	RUBBER			1
201	CASING COVER	CAST IRON	GC200	BC6, SSC13	1
301	IMPELLER	BRONZE	BC6	SSC13,SSC14	1
401	SHAFT	STAINLESS STEEL	STS304		
402	IMPELLER KEY	STAINLESS STEEL	STS304		1
403	COUPLING KEY	CARBON STEEL	SM45C		1
404	SLEEVE	STAINLESS STEEL	STS304		1
413	IMPELLER WASHER	STAINLESS STEEL	STS304		1
414	IMPELLER NUT	STAINLESS STEEL	STS304		1
601	MECHANICAL SEAL COVER	BRONZE	BC6	SSC13,SSC14	1
602	MECHANICAL SEAL				1 set
701	GLAND PACKING	SEMI METALLIC			1 set
703	GLAND	BRONZE	BC6	SSC13	1
801	PUMP COUPLING	CAST IRON	GC200		1
802	MOTOR COUPLING	CAST IRON	GC200		1
804	COUPLING BOLT, NUT & WASHER	MILD STEEL	SS400		1 set

HSD Horizontal centrifugal pump, single stage & single suction-self priming

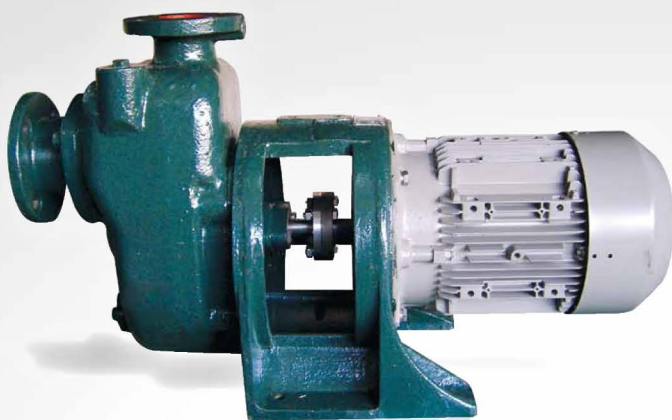

Construction

This pump is of the horizontal single stage & single suction centrifugal type. Its rotating element is connected to an electric motor shaft through a rigid coupling and no bearing is provided in the pump.

Application

- Bilge & Ballast pump
- Fire & G.S. pump
- Cooling S.W. pump (MAIN/AUX.)
- Cooling F.W. pump (MAIN/AUX.)
- General Industrial
- Other

Principal Particulars

ITEM \ MODEL		HSD-50	HSD-65A	HSD-65B	HSD-80A	HSD-80B	HSD-100
Rotation		Clockwise when viewed from driver end					
Suction bore (mm)		50	65	65	80	80	100
Discharge bore (mm)		50	65	65	80	80	100
Ball bearing	Radial	6305	6305	6305	6305	6307	6307
	Thrust	6306	6306	6306	6306	6307	6307
Stuffing box seal		Gland packing or Mechanical seal					
Pump Weight (kg)	Cast iron	52	53	70	76	104	107
	Bronze	56	57	74	80	108	111

※ If you have inquiry in excess of above range of pumps, please contact to us.

Selection Chart - Performance curve of 50Hz or from the website, please refer

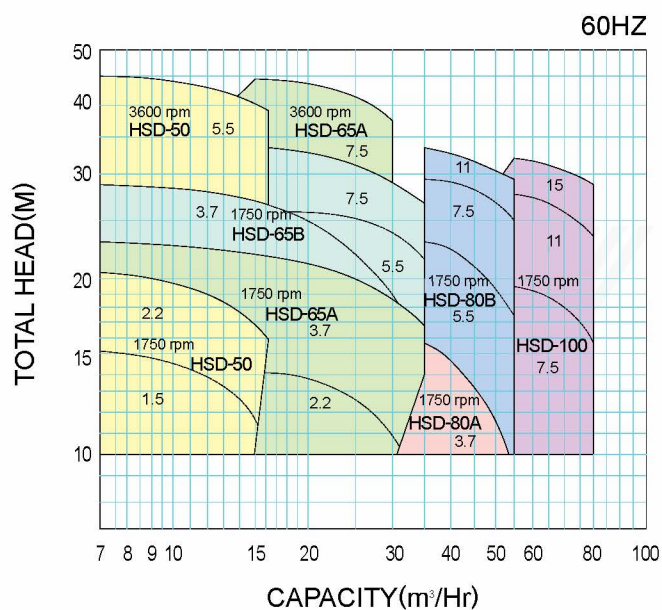

Outline Dimension

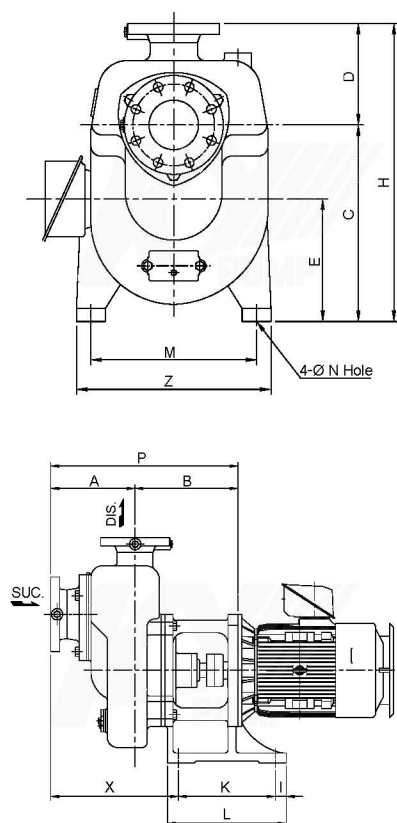

MODEL	BORE		DIMENSIONS(mm)														MOTOR POWER (KW)	PUMP WEIGHT (KG)								
	SUC.	DIS.	A	B	C	D	E	H	I	K	L	M	N	P	X	Z										
HSD-50	50	50	240		315	140	190	455	50	150		250	220		390		280	1.5	87							
			270							300			420		330			2.2	87							
			270							335			210		475		200		270		420		330		5.5	136
HSD-65A	65	65	150	260	315	140	190	455	50	180	280	220	15	410	290	280	2.2	88								
				280			335			210		475		200			300		270		430		330		3.7	107
				280			335			210		475		200		300		270		430		330		7.5	141	
HSD-65B	65	65	150	260		330	190	480	50	180		280	220		410		280	3.7	124							
				280						350			500		200			300	270	430		330		5.5	154	
				280						350			500		200		300			270	430		330		7.5	158
HSD-80A	80	80	165	270	315	165	190	480	50	180	280	220	15	435	315	280		3.7	130							
HSD-80B	80	80	165	290		400	200	250	600	50	200	300	270	19	455		315	350	5.5	188						
				320											485				315		350		7.5	192		
				320											485		315		350		11	244				
HSD-100	100	100	185	290	400	200	250	600	50	200	300	270	19	475	335	350	7.5	196								
				320										505			11	247								
				320										505			15	254								

* Outline dimensions are subject to change without notice.
Please ask the company for the latest drawings.

Standard sectional drawing

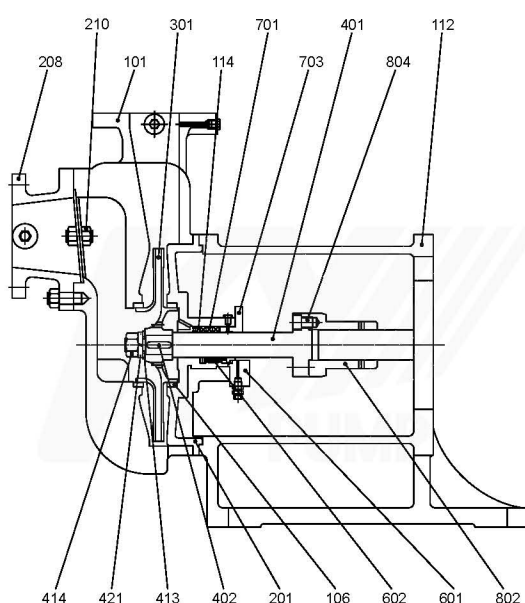

PART NO.	NAME OF PART	MATERIAL			REQ.NO FOR 1PUMP
		STANDARD		OPTION	
		NAME	KS	KS	
101	CASING	CAST IRON	GC200	BC6, SSC13	1
106	CASING RING	BRONZE	BC6		2
112	FRAME	CAST IRON	GC200		1
114	NECK BUSH	BRONZE	BC6		1
201	CASING COVER	CAST IRON	GC200	BC6, SSC13	1
208	SUCTION BRANCH	CAST IRON	GC200		
210	NON RETURN VALVE	CAST IRON	GC200	BC6	
301	IMPELLER	BRONZE	BC6	SSC13,SSC14	1
401	SHAFT	STAINLESS STEEL	STS304		1
402	IMPELLER KEY	STAINLESS STEEL	STS304		1
413	IMPELLER WASHER	STAINLESS STEEL	STS304		1
414	IMPELLER NUT	STAINLESS STEEL	STS304		1
421	SPRING LOCK WASHER	STAINLESS STEEL	STS304		
601	MECHANICAL SEAL COVER	BRONZE	BC6	SSC13	1
602	MECHANICAL SEAL				1 set
701	GLAND PACKING	SEMI METALLIC			1 set
703	GLAND	BRONZE	BC6	SSC13	1
802	MOTOR COUPLING	CAST IRON	GC200		1
804	COUPLING BOLT, NUT & WASHER	MILD STEEL	SS400		1 set

HS Horizontal centrifugal pump, single stage & single suction

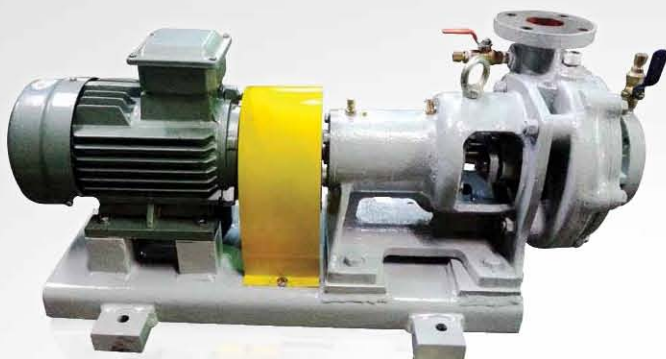

Construction

This pump is of the horizontal single stage & single suction centrifugal type. Its rotating element is connected to an electric motor shaft through a flexible coupling.

Application

- F.W. pump
- S.W. pump
- Sanitary pump
- Cooling F.W. pump
- Hot water Circ. pump
- General Industrial
- Other

Principal Particulars

ITEM	MODEL	HS-32	HS-40	HS-50	HS-65	HS-100A	HS-100B	HS-125	HS-150	HS-200	HS-250
Rotation		Clockwise when viewed from driver end									
Suction bore (mm)		32	40	50	65	100	100	125	150	200	250
Discharge bore (mm)		32	40	50	65	100	100	125	150	200	250
Ball bearing		6305	6306	6306	6306	6307	6307	6308	6308	6309	6309
Stuffing box seal		Gland packing or Mechanical seal									
Pump Weight (kg)	Cast iron	21	25	32	34	44	52	48	58	64	72
	Bronze	23	28	35	37	48	55	51	61	67	75

※If you have inquiry in excess of above range of pumps, please contact to us.

Selection Chart - Performance curve of 50Hz or from the website, please refer

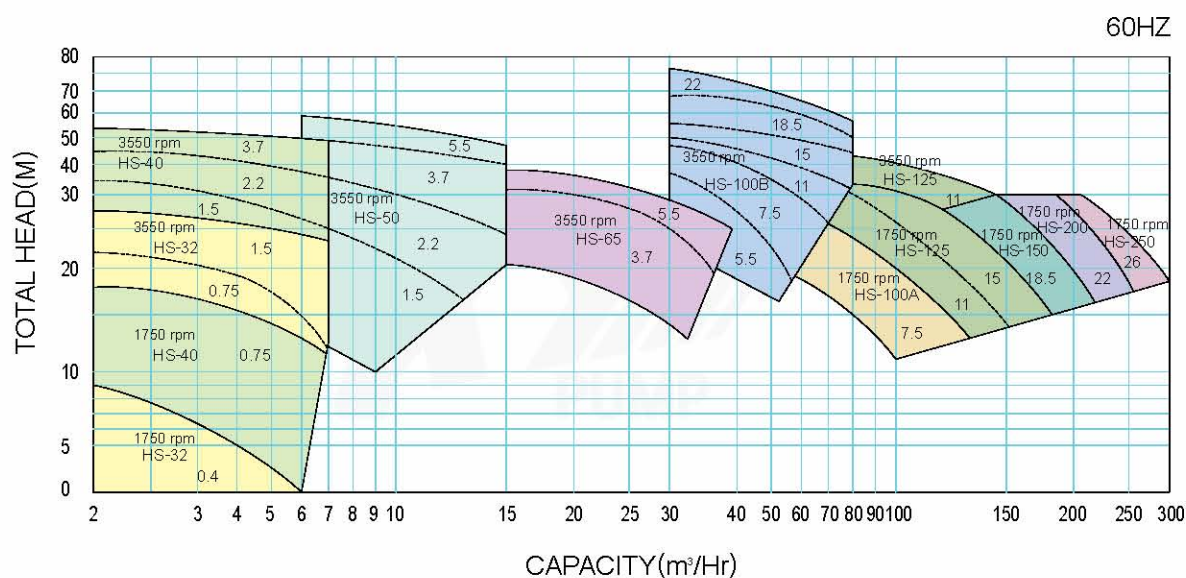

Outline Dimension

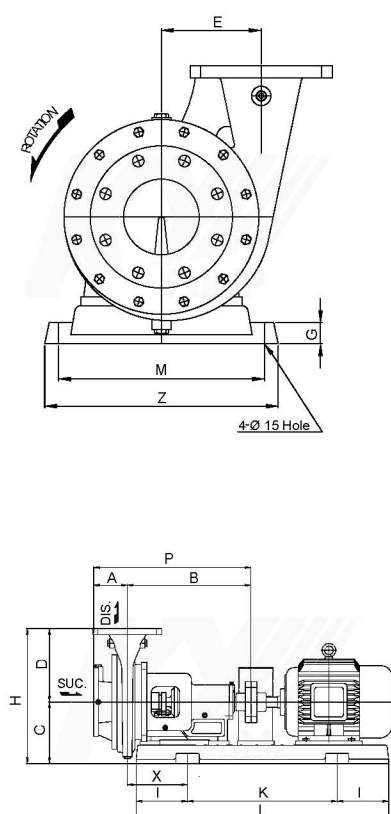

MODEL	BORE		DIMENSIONS(mm)													MOTOR POWER (kW)	PUMP WEIGHT (KG)																																																																																																																																																																																																																																																																																																																																																																																																																																																																																																																																																																																																																																																																																																																			
	SUC.	DIS.	A	B	C	D	E	H	I	K	L	M	P	X	Z																																																																																																																																																																																																																																																																																																																																																																																																																																																																																																																																																																																																																																																																																																																					
HS-32	32	32	80	305 315	185	125	90	310	75	405	555	270	385 395	75	310	0.4-0.75	51																																																																																																																																																																																																																																																																																																																																																																																																																																																																																																																																																																																																																																																																																																																			
HS-40	40	40	85	350	205	150	110	355	75	405	555	270	435	90	310	0.75	65																																																																																																																																																																																																																																																																																																																																																																																																																																																																																																																																																																																																																																																																																																																			
									110	400	620	295		128	335	1.5-2.2	70																																																																																																																																																																																																																																																																																																																																																																																																																																																																																																																																																																																																																																																																																																																			
									136									3.7	70																																																																																																																																																																																																																																																																																																																																																																																																																																																																																																																																																																																																																																																																																																																	
HS-50	50	50	92	348	205 210	150	110	355 360					110 150	400	620			297	440	136 146	335	1.5-2.2	73																																																																																																																																																																																																																																																																																																																																																																																																																																																																																																																																																																																																																																																																																																													
																																																																																																																																																																																																																																																																																																																																																																																																																																																																																																																																																																																																																																																																																																																																				</

* Outline dimensions are subject to change without notice.
Please ask the company for the latest drawings.

Standard sectional drawing

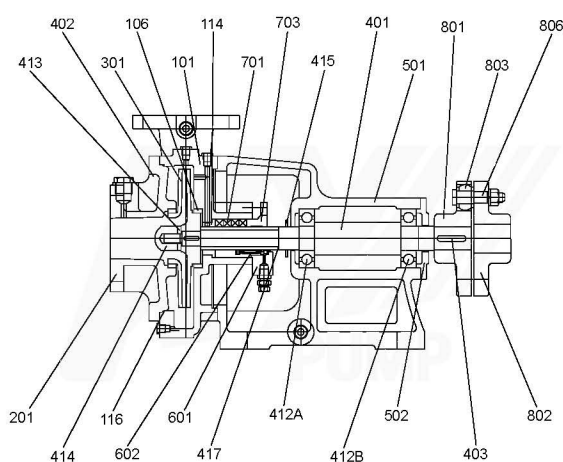

PART NO.	NAME OF PART	MATERIAL			REQ.NO FOR 1PUMP
		STANDARD		OPTION	
		NAME	KS	KS	
101	CASING	CAST IRON	GC200	BC6, SSC13	1
106	CASING RING	BRONZE	BC6		2
114	NECK BUSH	BRONZE	BC6		1
116	O-RING	RUBBER			1
201	CASING COVER	CAST IRON	GC200	BC6, SSC13	1
301	IMPELLER	BRONZE	BC6	SSC13, SSC14	1
401	SHAFT	STAINLESS STEEL	STS304		1
402	IMPELLER KEY	STAINLESS STEEL	STS304		1
403	COUPLING KEY	CARBON STEEL	SM45C		1
404	SLEEVE	STAINLESS STEEL	STS304		1
412A	BALL BEARING	BEARING STEEL			1
412B	BALL BEARING	BEARING STEEL			1
413	IMPELLER WASHER	STAINLESS STEEL	STS304		1
414	IMPELLER NUT	STAINLESS STEEL	STS304		1
415	FLINGER	RUBBER			1
417	SLEEVE GASKET	FIBER			1
501	BEARING CASE	CAST IRON	GC200		1
502	BEARING COVER	CAST IRON	GC200		1
601	MECHANICAL SEAL COVER	STAINLESS STEEL	STS304	SSC13	1
602	MECHANICAL SEAL				1 set
701	GLAND PACKING	SEMI METALLIC			1 set
703	GLAND	BRONZE	BC6	SSC13	1
801	PUMP COUPLING	CAST IRON	GC200		1
802	MOTOR COUPLING	CAST IRON	GC200		1
803	COUPLING RING	RUBBER			1 set
806	COUPLING BOLT, NUT & WASHER	MILD STEEL	SS400		1 set

HU Horizontal or Vertical centrifugal pump, single stage & single suction



Construction

This pump is of the single stage & single suction centrifugal type. Its rotating element is connected to an electric motor shaft through a rigid coupling and no bearing is provided in the pump.

Application

- HYD. Unit F.W. pump
- HYD. Unit S.W. pump
- HYD. Unit Drinking W. pump
- General Industrial
- Other

Principal Particulars

ITEM		MODEL	HU-40	HU-50
Rotation			Clockwise when viewed from driver end	
Suction bore (mm)			40	50
Discharge bore (mm)			40	50
Stuffing box seal			Gland packing or Mechanical seal	
Pump Weight (kg)	Cast iron		40	80
	Bronze		45	85

※If you have inquiry in excess of above range of pumps, please contact to us.

Selection Chart - Performance curve of 50Hz or from the website, please refer

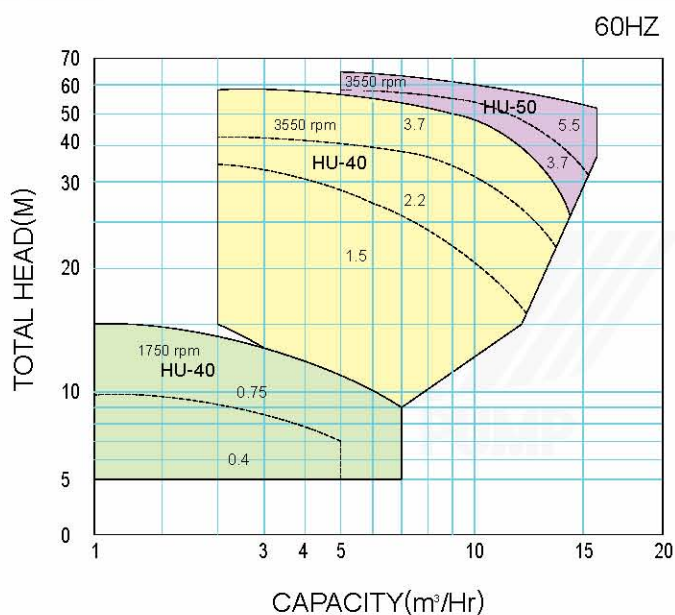

Outline Dimension

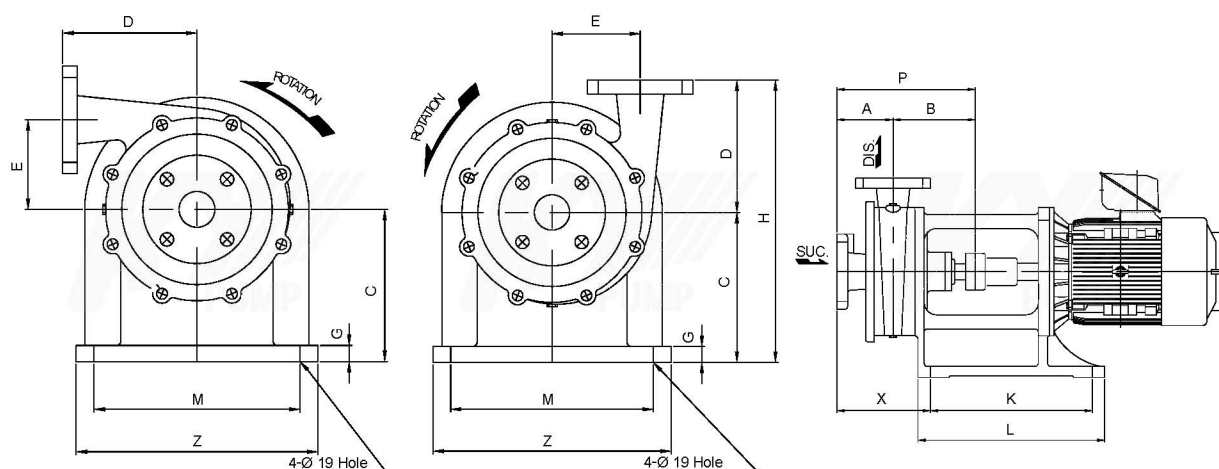

MODEL	BORE		DIMENSIONS(mm)													MOTOR POWER (KW)	PUMP WEIGHT (KG)
	SUC.	DIS.	A	B	C	D	E	G	H	K	L	M	P	X	Z		
HU-40	40	40	90	132	170	150	100	18	320	260	300	230	222	150	270	0.4~3.7	40
HU-50	50	50	100	170	170	170	115	18	340	260	300	230	270	100	270	3.7~5.5	80

* Outline dimensions are subject to change without notice. Please ask the company for the latest drawings.

Standard sectional drawing

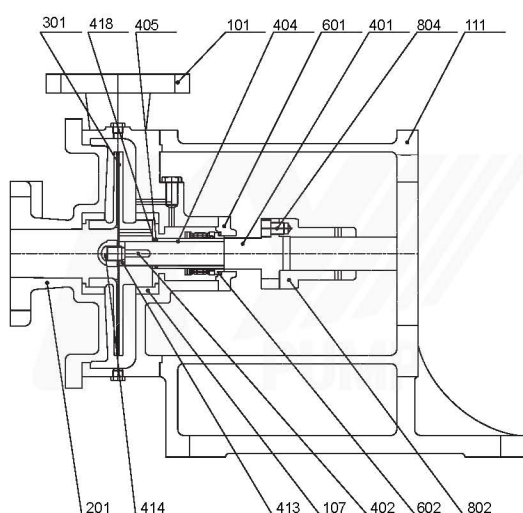

PART NO.	NAME OF PART	MATERIAL			REQ.NO FOR 1PUMP
		STANDARD		OPTION	
		NAME	KS	KS	
101	CASING	CAST IRON	GC200	BC6, SSC13	1
107	MOUTH RING	BRONZE	BC6		2
111	PUMP BED	CAST IRON	GC200		1
201	CASING COVER	CAST IRON	GC200	BC6, SSC13	1
301	IMPELLER	BRONZE	BC6	SSC13,SSC14	1
401	SHAFT	STAINLESS STEEL	STS304		1
402	IMPELLER KEY	STAINLESS STEEL	STS304		1
404	SLEEVE	STAINLESS STEEL	STS304		1
405	O-RING	RUBBER			1
413	IMPELLER WASHER	STAINLESS STEEL	STS304		1
414	IMPELLER NUT	STAINLESS STEEL	STS304		1
418	SLEEVE WASHER	STAINLESS STEEL	STS304		1
601	MECHANICAL SEAL COVER	BRONZE	BC6	SSC13	1
602	MECHANICAL SEAL				1 set
802	MOTOR COUPLING	DUCTILE CAST IRON	GCD450		1
804	COUPLING BOLT, NUT & WASHER	MILD STEEL	SS400		1 set

HF Horizontal centrifugal pump, two stage & single suction

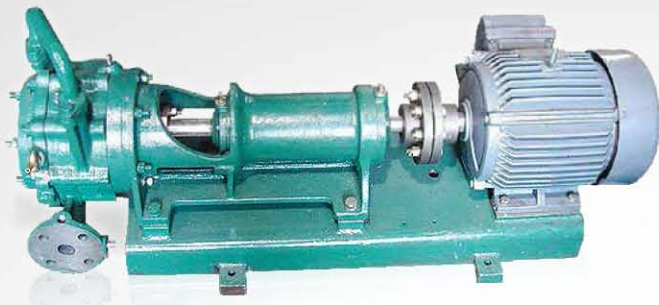

Construction

This pump is of the horizontal two stage & single suction centrifugal type.

Its rotating element is connected to an electric motor shaft through a flexible coupling.

Application

- Boiler Feed W. pump
- General Industrial
- Other

Principal Particulars

ITEM		MODEL	HF-32
Rotation			Clockwise when viewed from driver end
Suction bore (mm)			32
Discharge bore (mm)			32
Ball Bearing			6208, 6407
Stuffing box seal			Gland packing or Mechanical seal
Pump Weight (kg)	Cast iron		130
	Bronze		140

※If you have inquiry in excess of above range of pumps, please contact to us.

Selection Chart - Performance curve of 50Hz or from the website, please refer

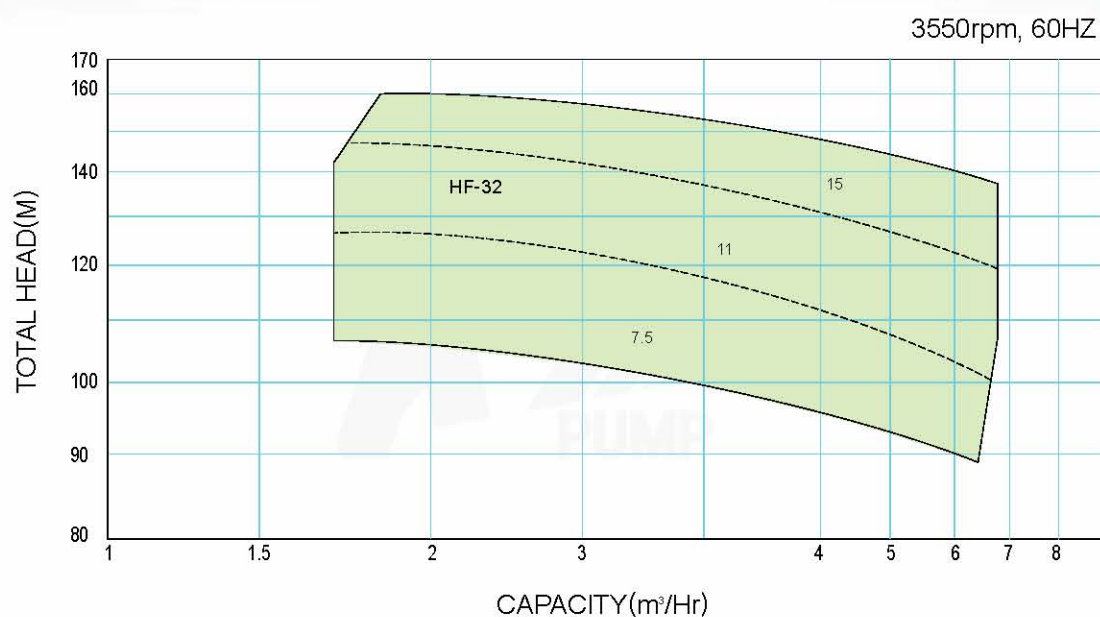

Outline Dimension

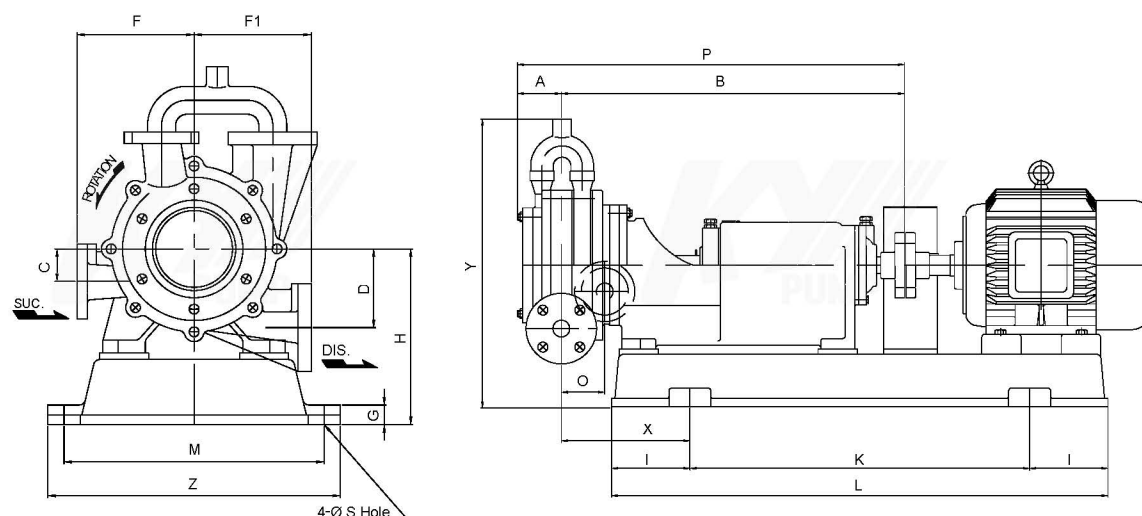

MODEL	BORE		DIMENSIONS(mm)																	MOTOR POWER (KW)	PUMP WEIGHT (KG)
	SUC.	DIS.	A	B	C	D	F	F1	G	H	I	K	L	M	O	P	X	Y	Z		
HF-32	32	32	85	655	50	121	160	190	25	235	200	500	900	370	83	740	291	495	416	7.5~15	130

* Outline dimensions are subject to change without notice. Please ask the company for the latest drawings.

Standard sectional drawing

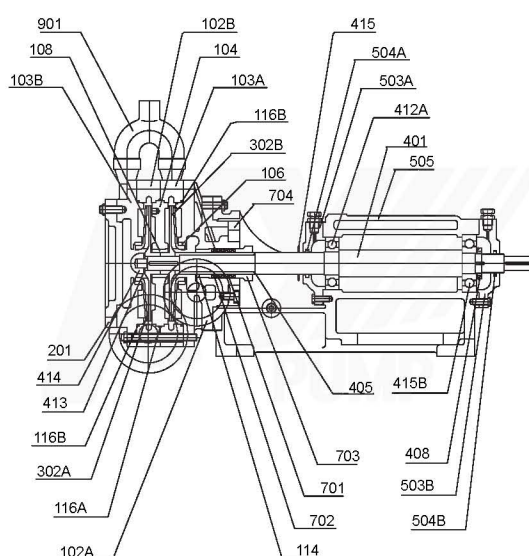

PART NO.	NAME OF PART	MATERIAL			REQ.NO FOR 1PUMP
		STANDARD		OPTION	
		NAME	KS	KS	
102A	SUCTION CASING	CAST IRON	GC200	BC6, SSC13	1
102B	DELIVERY CASING	CAST IRON	GC200	BC6, SSC13	1
103A	NO.1 CASING	CAST IRON	GC200	BC6, SSC13	1
103B	NO.2 CASING	CAST IRON	GC200	BC6, SSC13	1
104	STAGE CASING	CAST IRON	GC200	BC6, SSC13	1
106	CASING RING	BRONZE	BC6		2
108	STAGE BUSH	BRONZE	BC6		1
114	NECK BUSH	BRONZE	BC6		1
116A	O-RING	RUBBER			1
116B	O-RING	RUBBER			2
201	CASING SIDE COVER	CAST IRON	GC200	BC6, SSC13	1
302A	NO.1 IMPELLER	BRONZE	BC6	SSC13, SSC14	1
302B	NO.2 IMPELLER	BRONZE	BC6	SSC13, SSC14	1
401	SHAFT	STAINLESS STEEL	STS304		1
405	O-RING	RUBBER			1
408	BEARING WASHER & NUT	CARBON STEEL	SM45C		1 set
412A	BALL BEARING	BEARING STEEL			1
412B	BALL BEARING	BEARING STEEL			1
413	IMPELLER WASHER	STAINLESS STEEL	STS304		1
414	IMPELLER NUT	STAINLESS STEEL	STS304		1
415	FLINGER	BRASS			1
503A	BEARING COVER	CAST IRON	GC200		1
503B	BEARING COVER	CAST IRON	GC200		1
504A	FELT RING	FELT			1
504B	FELT RING	FELT			1
505	BEARING CASE	CAST IRON	GC200		1
701	GLAND PACKING	SEMI METALLIC			1 set
702	LANTERN RING	BRONZE	BC6		1
703	GLAND	BRONZE	BC6	SSC13	1
704	GLAND COVER	BRONZE	BC6	SSC13	1
901	BEND PIPE	BRONZE	BC6		1

HC Horizontal centrifugal pump, single stage & single suction

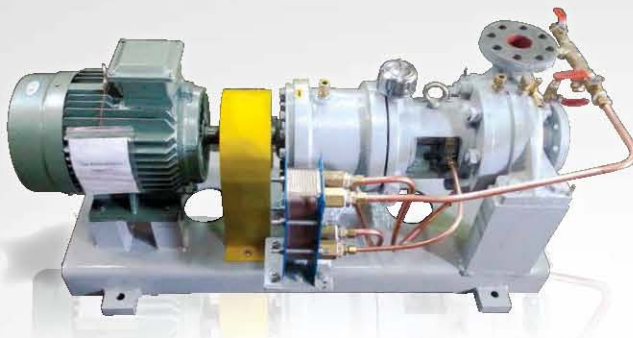

Construction

This pump is of the horizontal single stage & single suction centrifugal type.

Its rotating element is connected to an electric motor shaft through a flexible coupling.

Application

- Boiler W. Circ. pump
- General Industrial
- Other

Principal Particulars

ITEM	MODEL	HC-32	HC-50
Rotation		Clockwise when viewed from driver end	
Suction bore (mm)		32	50
Discharge bore (mm)		32	50
Ball bearing		6305, 6306	6207, 6307
Stuffing box seal		Gland packing	
Pump Weight (kg)	Cast iron	165	175
	Bronze	170	180

※If you have inquiry in excess of above range of pumps, please contact to us.

Selection Chart - Performance curve of 50Hz or from the website, please refer

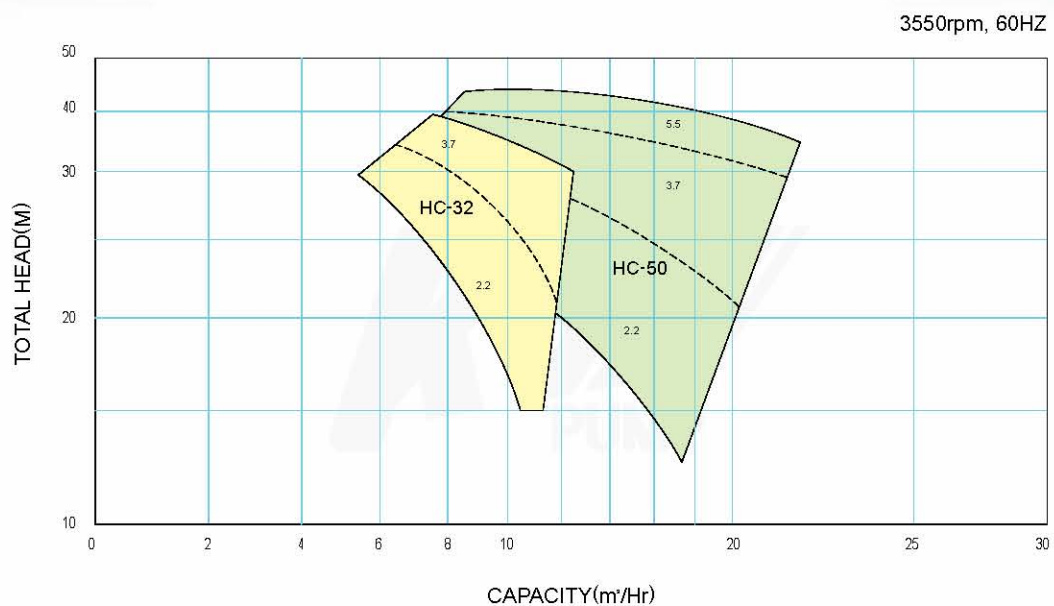

Outline Dimension

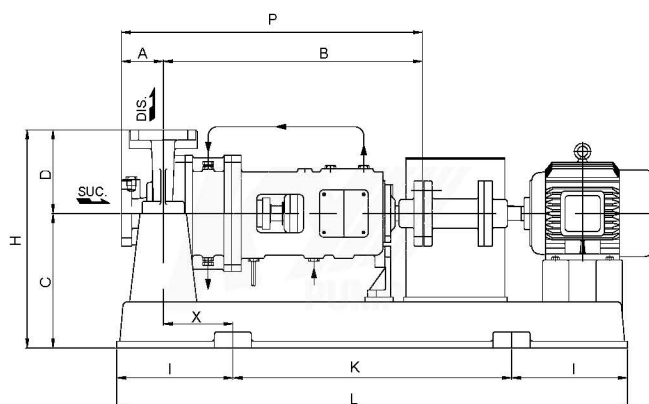
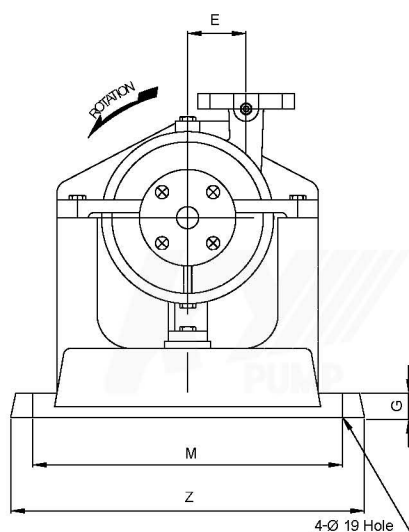

MODEL	BORE		DIMENSIONS(mm)														MOTOR POWER (kW)	PUMP WEIGHT (KG)
	SUC.	DIS.	A	B	C	D	E	G	H	I	K	L	M	P	X	Z		
HC-32	32	32	90	560	290	180	85	35	470	250	600	1100	450	650	150	515	2.2~3.7	165
HC-50	50	50	100	560	290	180	90	35	470	250	600	1100	450	660	150	515	2.2~5.5	175

* Outline dimensions are subject to change without notice. Please ask the company for the latest drawings.

Standard sectional drawing

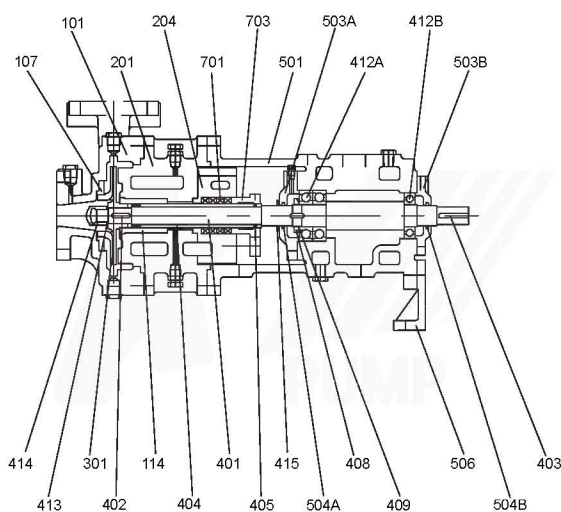

PART NO.	NAME OF PART	MATERIAL			REQ.NO FOR 1PUMP
		STANDARD		OPTION	
		NAME	KS	KS	
101	CASING	CAST IRON	GC200	BC6, SSC13	1
107	MOUTH RING	BRONZE	BC6		1
114	NECK BUSH	BRONZE	BC3		1
201	CASING COVER	CAST IRON	GC200	BC6, SSC13	1
204	PACKING BOX	CAST IRON	GC200		1
301	IMPELLER	BRONZE	BC6	SSC13,SSC14	1
401	SHAFT	STAINLESS STEEL	STS304		1
402	IMPELLER KEY	STAINLESS STEEL	STS304		1
403	COUPLING KEY	CARBON STEEL	SM45C		1
404	SLEEVE	STAINLESS STEEL	STS304		1
405	O-RING	RUBBER			1
408	BEARING NUT	MILD STEEL	SS400		1
409	BEARING WASHER	MILD STEEL	SS400		1
412A	BALL BEARING	BEARING STEEL			1
412B	BALL BEARING	BEARING STEEL			1
413	IMPELLER WASHER	STAINLESS STEEL	STS304		1
414	IMPELLER NUT	STAINLESS STEEL	STS304		1
415	FLINGER	BRASS			1
501	BEARING CASE	CAST IRON	GC200		1
503A	BEARING COVER	CAST IRON	GC200		1
503B	BEARING COVER	CAST IRON	GC200		1
504A	FELT RING	FELT			1
504B	FELT RING	FELT			1
506	SUPPORT	MILD STEEL	SS400		1
701	GLAND PACKING	SEMI METALLIC			1 set
703	GLAND	BRONZE	BC3	SSC13,SSC14	1

DSF Horizontal ONE-ROTOR screw pumps



Construction

This pump is of the horizontal one-rotor screw type. These types of pumps, which are the combination of rotors and rubber stator, deliver the highest performance in the transfer of many types of liquids.

Application

- Bilge & Sludge pump
- General Industrial
- Other

Principal Particulars

ITEM	MODEL	DSF-25	DSF-30	DSF-40	DSF-60
Rotation		Clockwise when viewed from driver end			
Suction bore (mm)		50	50	65	100
Discharge bore (mm)		50	50	65	100
Stuffing box seal		Gland packing or Mechanical seal			
Pump Weight (kg)		165	175	190	540

※If you have inquiry in excess of above range of pumps, please contact to us.

Selection Chart

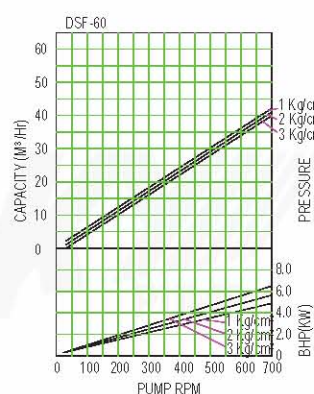
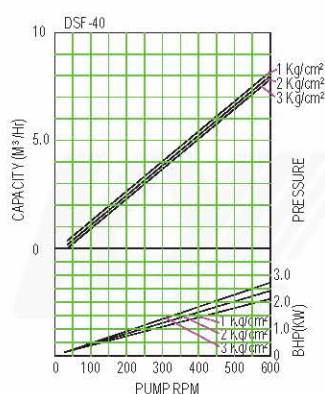
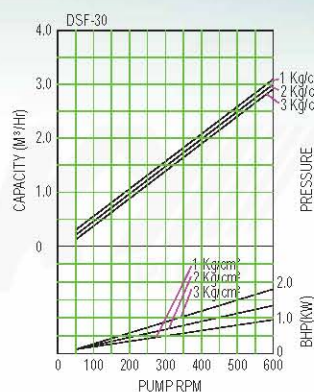
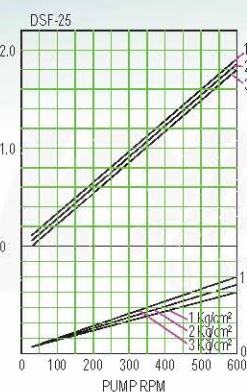

Outline Dimension

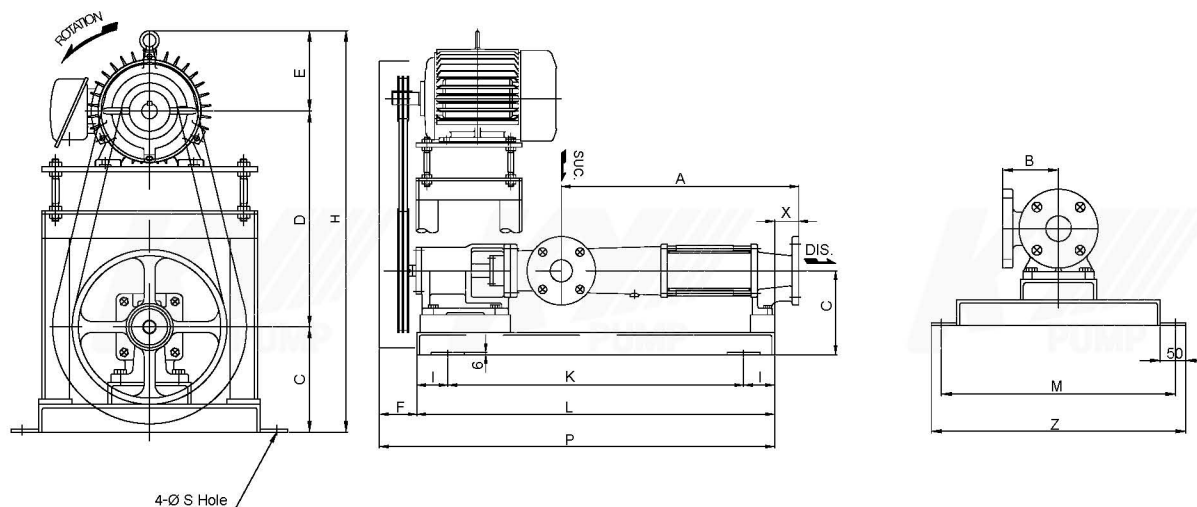

MODEL	BORE		DIMENSIONS(mm)															MOTOR POWER (kW)	PUMP WEIGHT (KG)
	SUC.	DIS.	A	B	C	D	E	F	H	I	K	L	M	P	S	X	Z		
DSF-25	50	50	470	110	225	335	145	85	705	70	670	810	460	895	19	-13	500	0.4~0.75	165
DSF-30	50	50	538	110	190	390	145	85	725	70	670	810	460	895	19	55	500	0.75~1.5	175
DSF-40	65	65	501	125	243	339	170	100	752	70	720	860	460	960	19	9	500	0.75~2.2	190
DSF-60	100	100	831	165	250	457	190	150	897	100	1100	1300	560	1450	22	58	600	2.2~5.5	540

* Outline dimensions are subject to change without notice. Please ask the company for the latest drawings.

Standard sectional drawing

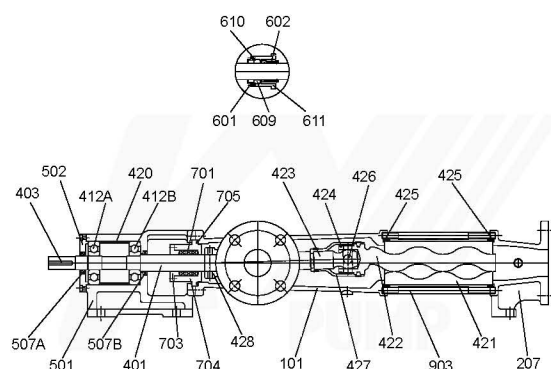

PART NO.	NAME OF PART	MATERIAL STANDARD		REQ.NO FOR 1PUMP
		NAME	KS	
101	CASING	CAST IRON	GC200	1
207	END PIECE	CAST IRON	GC200	1
401	SHAFT	STAINLESS STEEL	STS304	1
403	COUPLING KEY	CARBON STEEL	SM45C	1
412A	BALL BEARING	BEARING STEEL		1
412B	BALL BEARING	BEARING STEEL		1
420	BEARING BUSH	STAINLESS STEEL	STS304	1
421	STATOR	NBR+SS41		1
422	ROTOR	STAINLESS STEEL+HICR		1
423	CONNECTOR ROD	STAINLESS STEEL	STS304	1
424	O-RING	RUBBER		1
425	O-RING	RUBBER		2
426	PIN	STAINLESS STEEL	STS304	1
427	SHEATH	RUBBER		1
428	CONNECTOR BUSH	STAINLESS STEEL	STS304	1
501	BEARING CASE	CAST IRON	GC200	1
502	BEARING COVER	CAST IRON	GC200	1
507A	OIL SEAL	RUBBER		1
507B	OIL SEAL	RUBBER		1
601	MECHANICAL SEAL COVER	STAINLESS STEEL		1
602	MECHANICAL SEAL			1 set
609	FIXING SEAT	STAINLESS STEEL	STS304	1
610	O-RING	RUBBER		2
611	SEAL CASE	CAST IRON	GC200	1
701	GLAND PACKING	SEMI METALLIC		1 set
703	GLAND	CAST IRON	GC200	1
704	GLAND CASE	CAST IRON	GC200	1
705	O-RING	RUBBER		1
903	TIE BOLT	MILD STEEL	SS400	4

GH Horizontal in-line gear pumps



Construction

This Gear Pump is constructed of one set of gears, a shaft supported by the metal bearing, casing, side cover, etc.

Metal bearings are inside of the casing and are lubricated by the pumping liquid.

A safety valve is fitted on the pump casing to protect the pump, motor, and piping line from an abnormal increase in the discharge pressure.

Application

- H.F.O./ F.O. Trans. pump
- H.F.O./F.O. Circ. pump
- G/E D.O. Trans. pump
- L.O./D.O. trans. pump
- F.O./ L.O. Supply pump
- General Industrial
- Other

Principal Particulars

ITEM \ MODEL	GH-0.5	GH-1	GH-1.5	GH-2	GH-2.5	GH-3	GH-4	GH-5	GH-6	GH-10	GH-30	GH-40
Rotation	Clockwise when viewed from driver end											
Suction bore (mm)	25	32	40	40	50	50	65	65	65	80	125	150
Discharge bore (mm)	20	25	32	32	40	40	50	50	50	65	100	125
Stuffing box seal	Gland packing or Mechanical seal											
Pump Weight (kg)	32	48	52	52	56	56	62	75	78	98	195	225

※If you have inquiry in excess of above range of pumps, please contact to us.

Standard accessories

- Discharge pressure gauge ----- 1EA
- Suction compound gauge ----- 1EA
- Gauge board ----- 1EA
- Gauge root valve ----- 2EA

Standard spare parts

1 pump set of the following spare parts is supplied for 1 SHIP.

- Gland packing or mechanical seal
- Coupling bolt, nut & washer
- Metal bearing
- Complete set of rotating element (if required)

Selection Chart (GH-0.5~3) ; 60HZ

- Performance curve of 50Hz or from the website, please refer

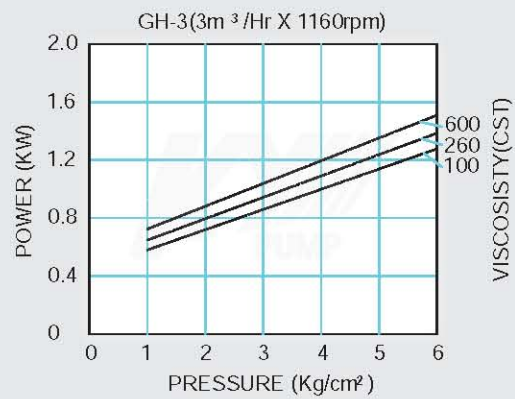
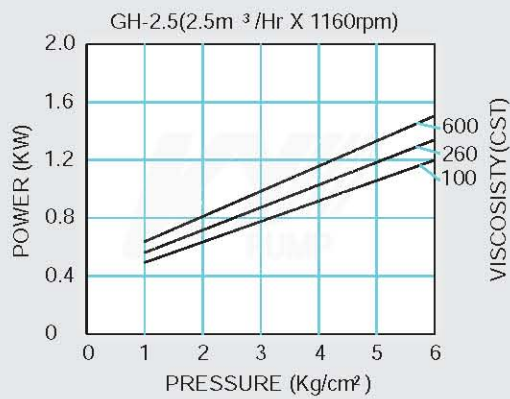
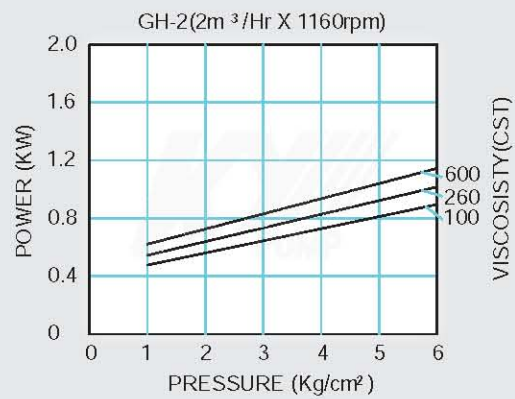
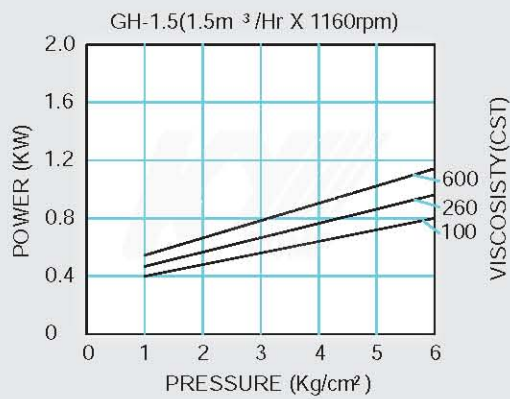
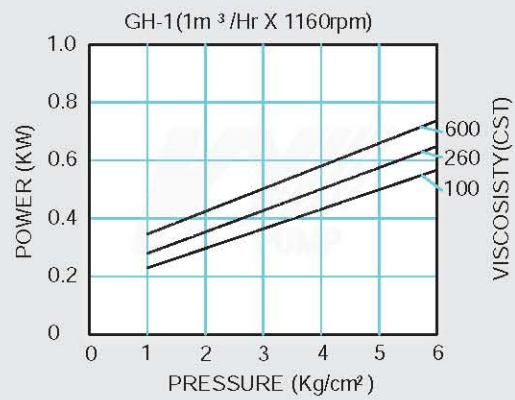
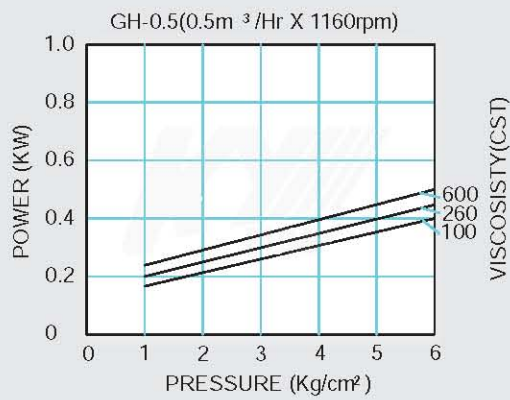

Selection Chart (GH-4~40) ; 60HZ - Performance curve of 50Hz or from the website, please refer

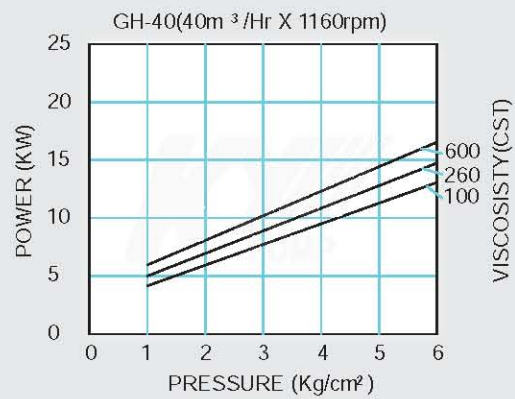
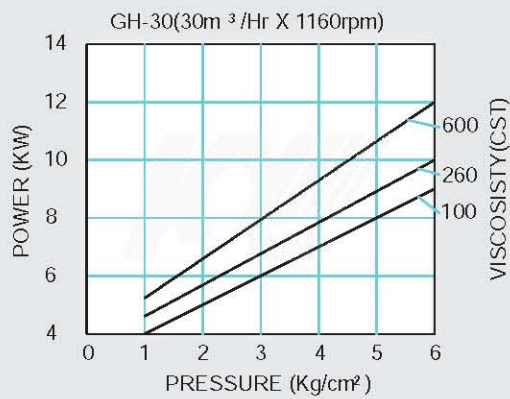
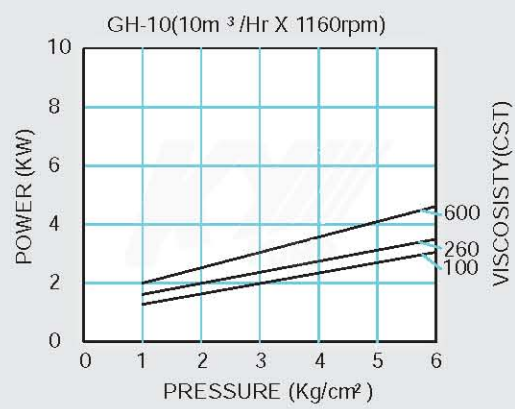
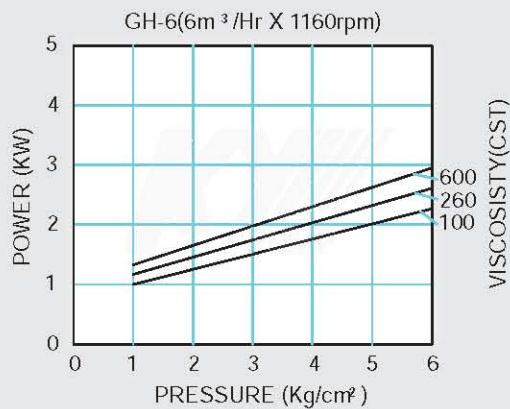
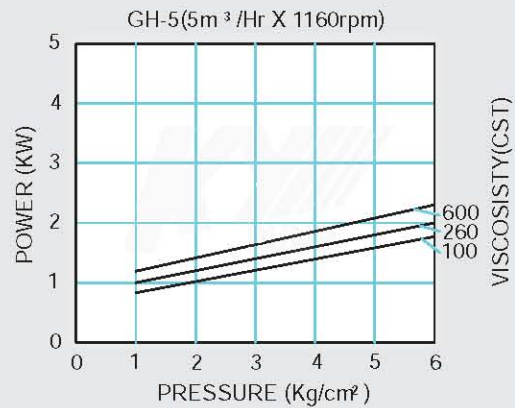
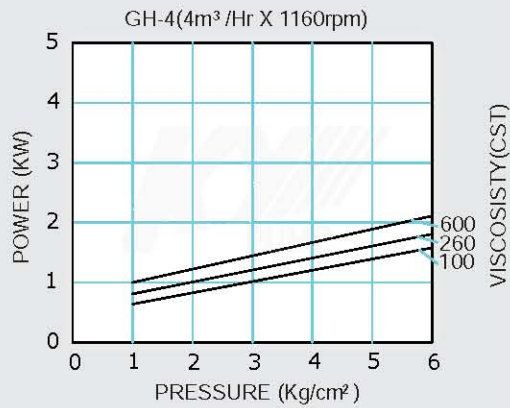

Outline Dimension

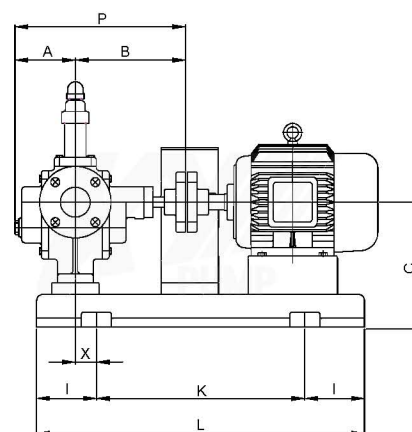
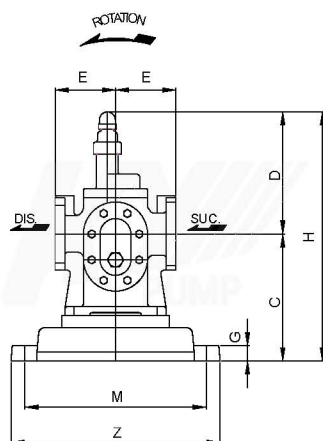

MODEL	BORE		DIMENSIONS(mm)														MOTOR POWER (KW)	PUMP WEIGHT (KG)
	SUC.	DIS.	A	B	P	C	D	H	M	Z	G	X	I	K	L	E		
GH-0.5	25	20	55	122	177	155	115	270	220	256	20	26	60	255	375	110	0.4	32
GH-1	32	25	89	175	264	195	185	380	300	346	25	60	100	300	500	95	0.75	48
GH-1.5	40	32	96	175	271	195	190	385	300	346	25	60	100	300	500	95	0.75	52
GH-2																	0.75	52
GH-2.5	50	40	98	185	283	210	202	412	300	346	25	35	100	350	550	100	1.5	56
GH-3																	1.5	56
GH-4	65	50	90	220	310	207	432	639	320	366	25	35	100	400	600	240	2.2	62
GH-5			111	200	311	225	245	470	320	366	25	20	100	400	600	105	2.2	75
GH-6	80	65	130	220	450	225	245	470	350	400	25	45	110	420	640	105	3.7	78
GH-10			140	245	385	230	300	530	350	400	25	30	125	450	700	140	3.7	98
GH-30	125	100	210	357	567	335	353	688	420	470	30	80	200	600	1000	175	7.5	195
GH-40	150	125	240	387	627	345	420	765	460	510	35	57	200	700	1100	190	15	225

* Outline dimensions are subject to change without notice. Please ask the company for the latest drawings.

Standard sectional drawing

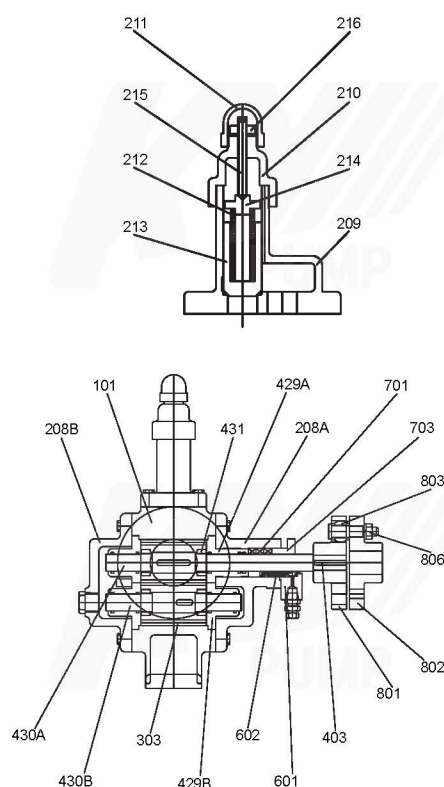

PART NO.	NAME OF PART	MATERIAL STANDARD		REQ.NO FOR 1PUMP
		NAME	KS	
101	CASING	CAST IRON	GC200	1
208A	SIDE COVER(INNER)	CAST IRON	GC200	1
208B	SIDE COVER(OUTER)	CAST IRON	GC200	1
209	SAFETY VALVE BODY	CAST IRON	GC200	1
210	SAFETY VALVE COVER	CAST IRON	GC200	1
211	SAFETY VALVE CAP	CAST IRON	GC200	1
212	SPRING	SPRING STEEL	SUP4	1
213	VALVE	CARBON STEEL		1
214	VALVE GUIDE	NON-ASBESTOS	S45C	1
215	ADJUST BOLT	MILD STEEL	SS400	1
216	ADJUST NUT	MILD STEEL	SS400	1
303	GEAR	CARBON STEEL	S45C	1 set
403	COUPLING KEY	CARBON STEEL	S45C	1
429A	METAL BEARING	LEADED TIN BRONZE	LBC4	1
429B	METAL BEARING	LEADED TIN BRONZE	LBC4	3
430A	DRIVE SHAFT & KEY	CARBON STEEL	S45C	1 set
430B	DRIVEN SHAFT & KEY	CARBON STEEL	S45C	1 set
431	SHAFT NUT	CARBON STEEL	S45C	1 set
601	SEAL COVER	BRONZE	BC6	1
602	MECHANICAL SEAL			1 set
701	GLAND PACKING	SEMI METALLIC		1 set
703	GLAND	BRONZE	BC6	1
801	PUMP COUPLING	CAST IRON	GC200	1
802	MOTOR COUPLING	CAST IRON	GC200	1
803	COUPLING RING	RUBBER		1 set
806	COUPLING BOLT, NUT & WASHER	MILD STEEL	SS400	1 set

KHM Horizontal, multi-stage, turbine pumps



Construction

Horizontal, radially split pump of stage-casing design radial impellers, single-flow, multi-stage, horizontal arrangement with axial inlet.

Application

- Boiler Feed Water pump
- Comp. Boiler Feed Water pump For pumping clean, cold or hot liquids
- In water plants
- In heating and boiler plants
- In booster plants of various industrial branches
- For condensate recovery
- Others

Principal Particulars

ITEM	MODEL	KHM-40	KHM-65	KHM-80
Rotation		Clockwise when viewed from driver end		
Suction bore (mm)		65	80	100
Discharge bore (mm)		40	65	80
Ball Bearing		NU 305	NU 306	NU 308
		7305 BDF	7306 BDF	7308 BDF
Stuffing box seal		Gland packing or Mechanical seal		
Pump Weight (kg)		Refer to the outline drawing		

※If you have inquiry in excess of above range of pumps, please contact to us.

Selection Chart - Performance curve of 50Hz or from the website, please refer

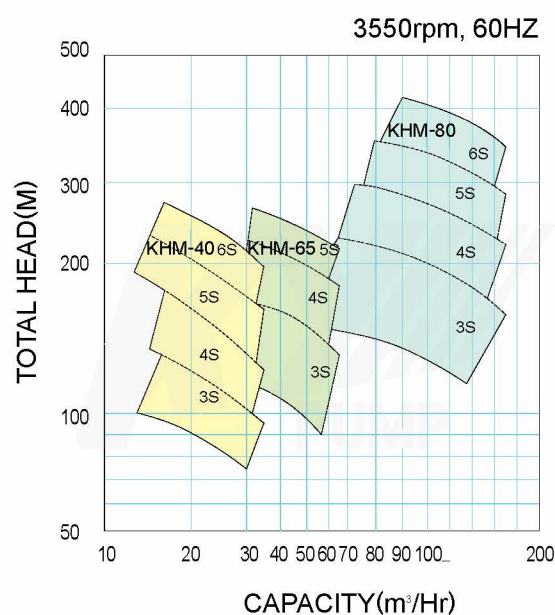

Outline Dimension

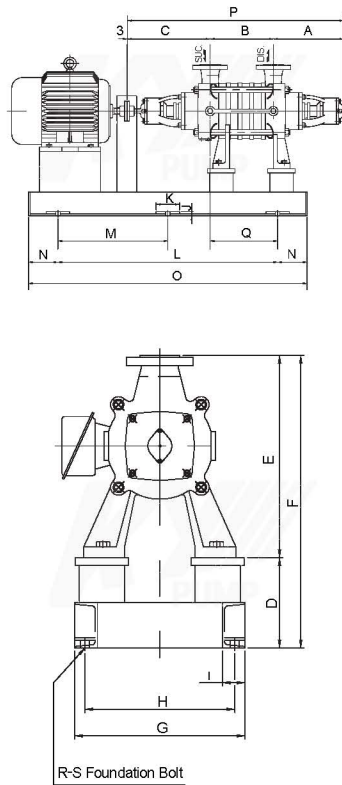

MODEL	BORE		DIMENSIONS(mm)																	MOTOR POWER (KW)	PUMP WEIGHT (KG)	
	SUC.	DIS.	A	B	C	D	E	F	G	H	I	J	K	L	M	N	O	P	Q			R
KHM 40x3S	65	40	243	150	270	140	340	480	335	290	50	28	100	560	170	900	663	60	4	M16	75	72
									375	330				630	-	185	1000		35		11	
																					15	
4S	65	40	243	195	270	140	340	480	375	330	50	28	100	710	-	205	1200	708	100	4	M16	81
						155		495	400	355	65	30	130						70		18.5	
						140		480	400	355	50	28	100	710	-	205	1200		120	4		22
5S	65	40	243	240	270	180	340	520	425	365	65	30	130	900	450	175	1250	733	190	6	M16	90
						205		545	475	415									170		30	
						160		500	400	340									220		15	
6S	65	40	243	285	270	180	340	520	425	365	65	30	130	900	450	175	1250	798	210	6	M16	104
						205		545	475	415									190		22	
																					18.5	
KHM 65x3S	80	65	278	195	295		405	560	425	365	65	30	130	900	450	175	1250	768	160	6	M16	111
						175		580	475	415									140		22	
																					30	
																					37	
4S	80	65	278	250	295	175	405	580	475	415	65	30	130	900	450	175	1250	823	170	6	M16	124
						200		605	530	470									160		37	
																					45	
																					55	
5S	80	65	278	305	295	200	405	605	530	470	65	30	130	1000	500	200	1400	878	240	6	M16	137
						255		635	560	500									210		45	
								620	530	470									170		75	
KHM 80x3S	100	80	308	225	340	200	450	650	560	500	65	30	130		1000	500	200	1400	873	6	M16	163
						255		705	630	560					1120	560	240	1600	140		90	
						225		675	560	490									220		110	
4S	100	80	308	290	340	255	450	705	630	560	65	30	130	1120	560	240	1600	938	200	6	M20	185
									670	600					1250	625	275	1800	170		132	
															1120	560	240	1600	240		150	
5S	100	80	308	355	340	255	450	705	630	560	65	30	130	1250	625	275	1800	1003	250	6	M20	207
									670	600									220		132	
																			310		150	
6S	100	80	308	420	340	255	450	705	630	560	65	30	130	1250	625	275	1800	1088	300	6	M20	229
									670	600									260		132	

* Outline dimensions are subject to change without notice.
Please ask the company for the latest drawings.

Standard sectional drawing

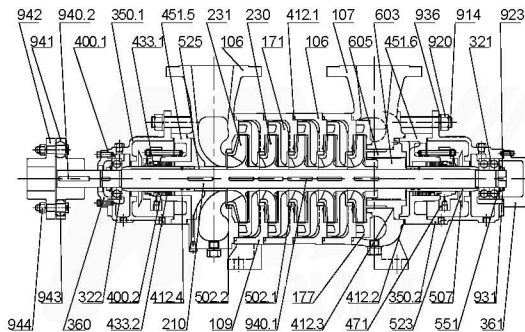

PART NO.	NAME OF PART	MATERIAL			REQ.NO FOR 1PUMP
		STANDARD		OPTION	
		NAME	KS	KS	
106	SUCTION CASING	CAST IRON	GC200	BC6, SSC13	1
107	DISCHARGE CASING	CAST IRON	GC200	BC6, SSC13	1
108	STAGE CASING	CAST IRON	GC200	BC6, SSC13	S-2
109	STAGECASING(WITHFOOT)	CAST IRON	GC200	BC6, SSC13	1
171	DIFFUSER	CAST IRON	GC200	BC6, SSC13	S-1
177	DIFFUSER(LAST STAGE)	CAST IRON	GC200	BC6, SSC13	1
210	SHAFT	STAINLESS STEEL	STS304		1
230	IMPELLER	STAINLESS STEEL	STS304	BC6, SSC14	S-1
231	SUCTION IMPELLER	STAINLESS STEEL	STS304	BC6, SSC14	1
321	BALL BEARING	BEARING STEEL			2
322	ROLLER BEARING	BEARING STEEL			1
350.1	BEARING HOUSING	CAST IRON	GC200		2
350.2	BEARING HOUSING	CAST IRON	GC200		1
360	BEARING COVER	CAST IRON	GC200		1
361	BEARING END COVER	CAST IRON	GC200		1
400.1	GASKET	NON ASBESTOS			2
400.2	GASKET	NON ASBESTOS			2
412.1	O-RING	RUBBER	NBR		S
412.2	O-RING	RUBBER	NBR		2
412.3	O-RING	RUBBER	NBR		1
412.4	O-RING	RUBBER	NBR		2
433.1	MECHANICAL SEAL (UNBALANCE)				1SET
433.2	MECHANICAL SEAL (BALANCE)				1SET
451.5	STUFFING BOX	CAST IRON	GC200		1
451.6	STUFFING BOX	CAST IRON	GC200		1
471	SEAL COVER	STAINLESS STEEL	STS304	BC6, SSC14	2
502.1	CASING WEAR RING	BRONZE	BC3		S-1
502.2	CASING WEAR RING	BRONZE	BC3		1
507	THROWER	RUBBER	NBR		2
523	SHAFT SLEEVE	STAINLESS STEEL	STS304		2
525	SPACER SLEEVE	STAINLESS STEEL	STS304		1
551	SPACER DISC	STEEL	SS400		2
603	BALANCE DRUM	STAINLESS STEEL	STS304		1
605	BALANCE DRUM LINER	BRONZE	BC3		1
914	TIE BOLT	CARBON STEEL	SM45C		4
920	HEX NUT	CARBON STEEL	SM45C		4
923	BEARING LOCK NUT	MILD STEEL	SS400		2
931	BEARING LOCK WASHER	MILD STEEL	SS400		2
936	PLAIN WASHER	MILD STEEL	SS400		8
940.1	KEY	CARBON STEEL	SM45C		S+2
940.2	COUPLING KEY	CARBON STEEL	SM45C		1
941	PUMP COUPLING	CAST IRON	GC200		1
942	MOTOR COUPLING	CAST IRON	GC200		1
943	COUPLING RING	RUBBER			1SET
944	COUPLING BOLT, NUT & WASHER	MILD STEEL	SS400		1SET

※ S: Stage Number

GV Vertical in-line gear pumps



Construction

This Gear Pump is constructed of one set of gears, a shaft supported by the metal bearing, casing, side cover, etc.

Metal bearings are inside of the casing and are lubricated by the pumping liquid.

A safety valve is fitted on the pump casing to protect the pump, motor, and piping line from an abnormal increase in the discharge pressure.

Application

- H.F.O Trans pump
- M/E Lub Oil pump
- Others

Principal Particulars

ITEM \ MODEL	GV-15	GV-20	GV-25	GV-30	GV-35	GV-40	GV-50
Rotation	Clockwise when viewed from driver end						
Suction bore (mm)	100	100	100	125	125	150	150
Discharge bore (mm)	80	80	80	100	100	125	125
Stuffing box seal	Gland packing or Mechanical seal						
Pump Weight (kg)	Refer to the outline drawing						

※If you have inquiry in excess of above range of pumps, please contact to us.

Selection Chart (GV-15~20) ; 60HZ

- Performance curve of 50Hz or from the website, please refer

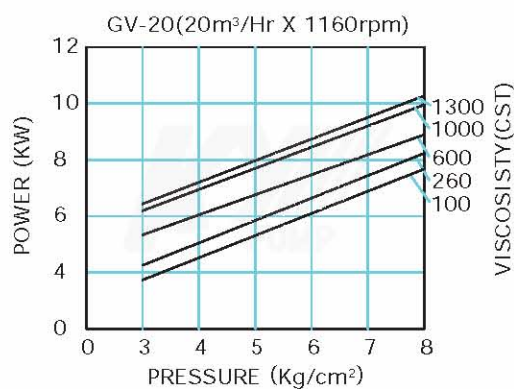
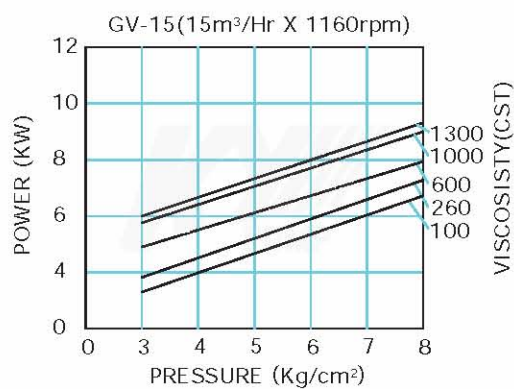

Selection Chart (GV-25~50) ; 60HZ

- Performance curve of 50Hz or from the website, please refer

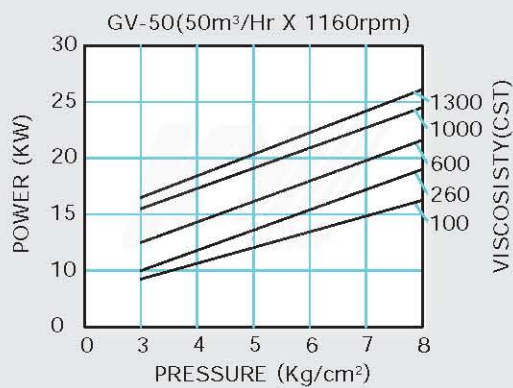
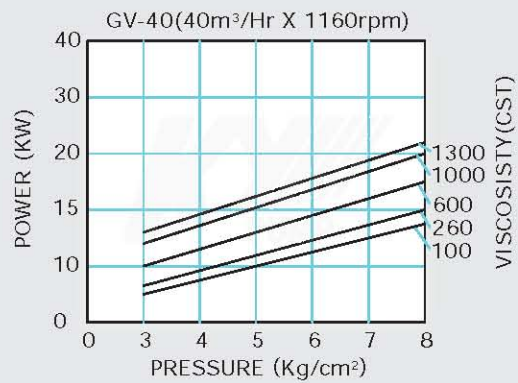
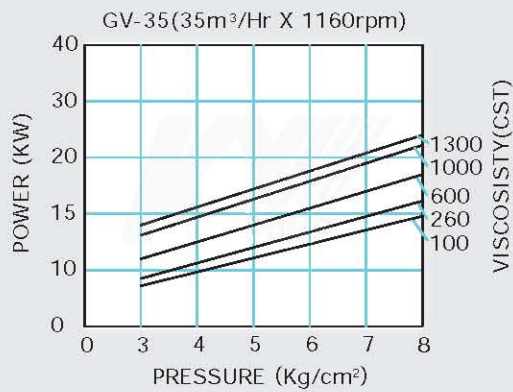
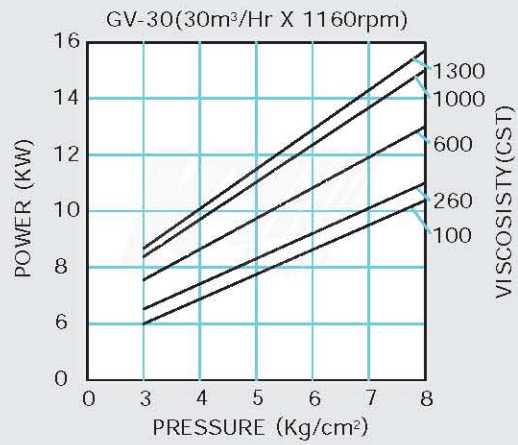
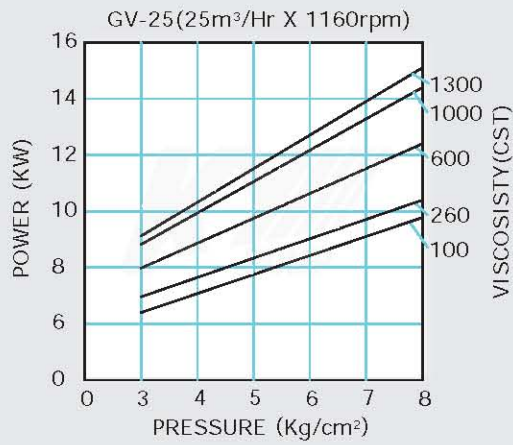

Outline Dimension

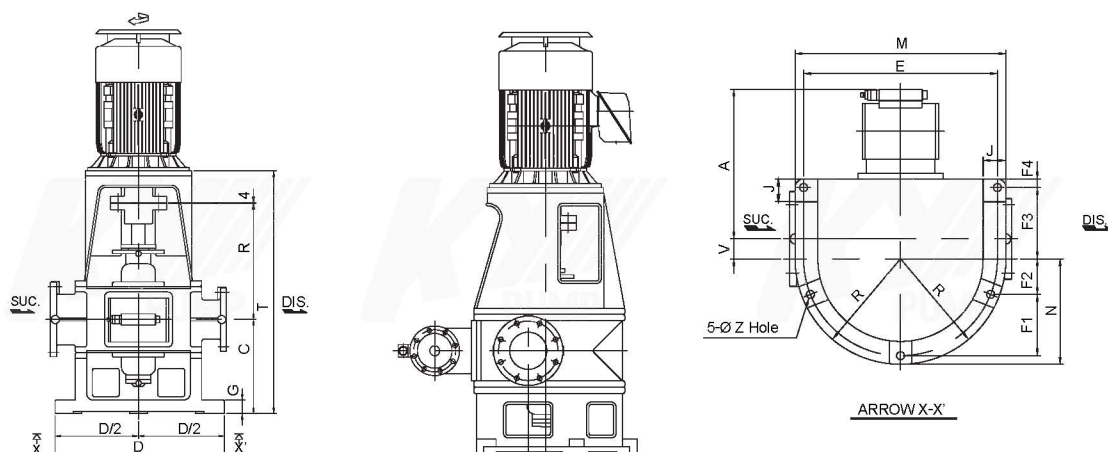

MODEL	BORE		DIMENSIONS(mm)																		MOTOR POWER (kW)	PUMP WEIGHT (KG)
	SUC.	DIS.	A	B	C	E	F1	F2	F3	F4	G	J	K	M	N	O	R	T	V	Z		
GV-15 20 25	100	80	320	253	500	400	125	75	150	25	40	50	225	450	400	200	345	1172	45	23	5.5	220
																		1240			7.5	
GV-30 35	125	100	320	265	500	400	125	75	150	25	40	50	225	450	400	200	345	1252	45	23	7.5	230
																		1292			11	
GV-40	150	125	400	300	620	510	160	95	200	25	50	70	280	560	505	255	390	1372	45	23	11	340
																		1426			15	
GV-50	150	125	400	290	620	510	160	95	200	25	50	70	280	560	505	255	390	1416	45	23	15	350
																		1454			18.5	

* Outline dimensions are subject to change without notice. Please ask the company for the latest drawings.

Standard sectional drawing

PART NO.	NAME OF PART	MATERIAL			REQ.NO FOR 1PUMP
		STANDARD		OPTION	
		NAME	KS	KS	
001	CASING	CAST IRON	GC200	BC6, SSC13	1
002	SIDE COVER	CAST IRON	GC200		1
003	SIDE COVER	CAST IRON	GC200		1
004	END COVER	CAST IRON	GC200		1
101	DRIVE SHAFT	CARBON STEEL	S45C		1
102	DRIVEN SHAFT	CARBON STEEL	S45C		1
103	DRIVE GEAR	CARBON STEEL	S45C		1
104	DRIVEN GEAR	CARBON STEEL	S45C		1
105	KEY	CARBON STEEL	S45C		1
106	KEY	CARBON STEEL	S45C		1
107	KEY	CARBON STEEL	S45C		1
110	GEAR SET RING	CARBON STEEL	S45C		2
201	BEARING METAL	CAST IRON	GC200		4
202	THRUST BALL BEARING	BEARING STEEL	SUJ2		1
301	COUPLING	CAST IRON	GC200		1
302	COUPLING	CAST IRON	GC200		1
304	COUPLING RING	RUBBER	NBR		8
305	COUPLING BOLT & NUT	MILD STEEL	SS400		8
402	PUMP BED	CAST IRON	GC200	SSC13	1
403	FRAME	CAST IRON	GC200		1
520	BEARING SEAL				1SET
521	MECH. SEAL COVER	BRONZE	BC6	SSC13	1
522	O-RING	RUBBER	NBR		1
523	SPACER	MILD STEEL	SS400		1
530	OIL SEAL	RUBBER	NBR		1
700	SAFETY VALVE COMPLETE				1
701	GLAND PACKING	SEMI METALLIC			1SET
703	GLAND	BRONZE	BC6	SSC13	1
900	GASKET	PAPER			2
902	GASKET	PAPER			1

V Vertical centrifugal screw pump



제품 특징

- 고용량, 저 양정에 적합.
- 상·하수도 및 각종 슬러지 이송용으로 사용되며, 양식장 순환수용으로 적합.
- 저용량 모터를 사용하며, 가격이 저렴하며 제품 수명이 긴 특징.

Application and Features

- This pump is suitable for high capacity and low lift.
- This pump is used to transfer water and sewage. Various sludge and it is appropriate for farm circulating water.
- This pump uses low-capacity motor. It features the cheap price and has a long life.

Principal Particulars

ITEM \ MODEL	V-300	V-500	V-800
Capacity (m ³ /hr)	300	500	800
Head (m)	1.5~3	1.5~3	1.5~3
Motor power (KW)	5.5	7.5	11
NO. OF REV.	1200 RPM		
Material	Stainless steel		

※ If you have inquiry in excess of above range of pumps, please contact to us.

Standard sectional drawing

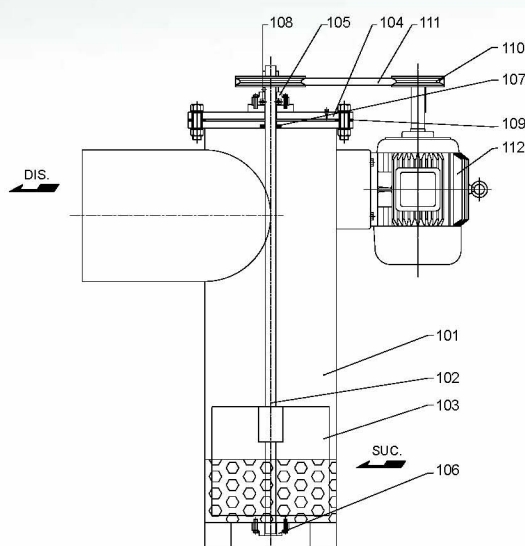

PART NO.	NAME OF PART	MATERIAL STANDARD		REQ. NO FOR 1PUMP
		NAME	KS	
101	CASING	STAINLESS STEEL	STS304	1
102	SHAFT	STAINLESS STEEL	STS304	1
103	SCREW	STAINLESS STEEL	STS304	1
104	TOP FLANGE	STAINLESS STEEL	STS304	1
105	TOP FLANGE COVER	STAINLESS STEEL	STS304	1
106	BOTTOM COVER	STAINLESS STEEL	STS304	1
107	OIL SEAL	RUBBER		1
108	BALL BEARING	BEARING STEEL		1
109	GASKET	NON-ASBESTOS		1
110	V-BELT PULLEY			1SET
111	BELT			1
112	MOTOR ASS'Y			1SET

Our Company Produces The Marine Pumps

K Y P U M P

ACQUISITION OF ISO9001 Approved by EQAICC

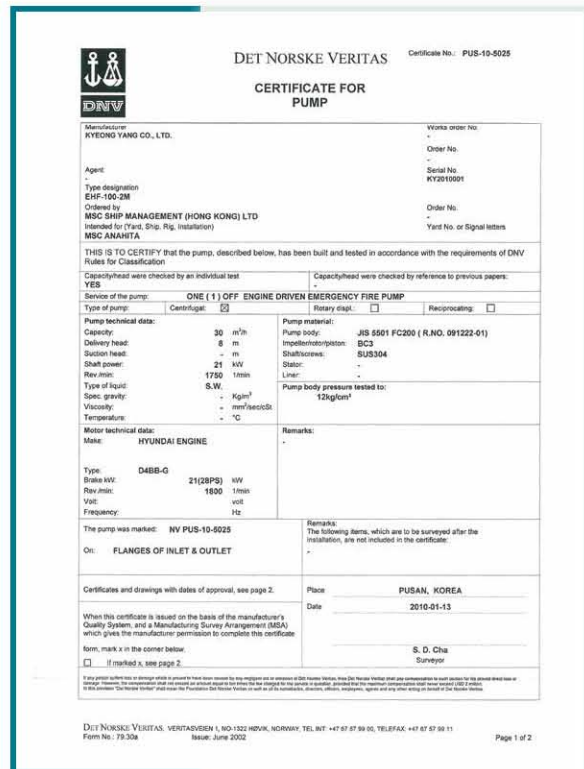
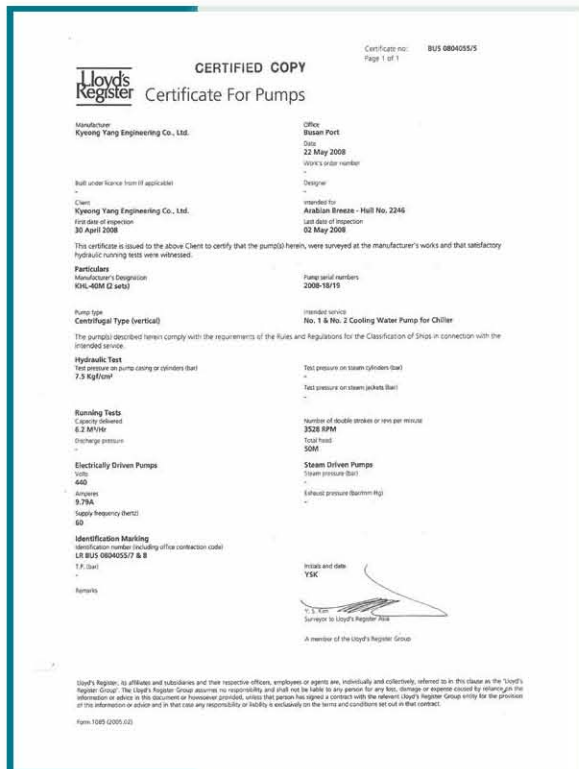
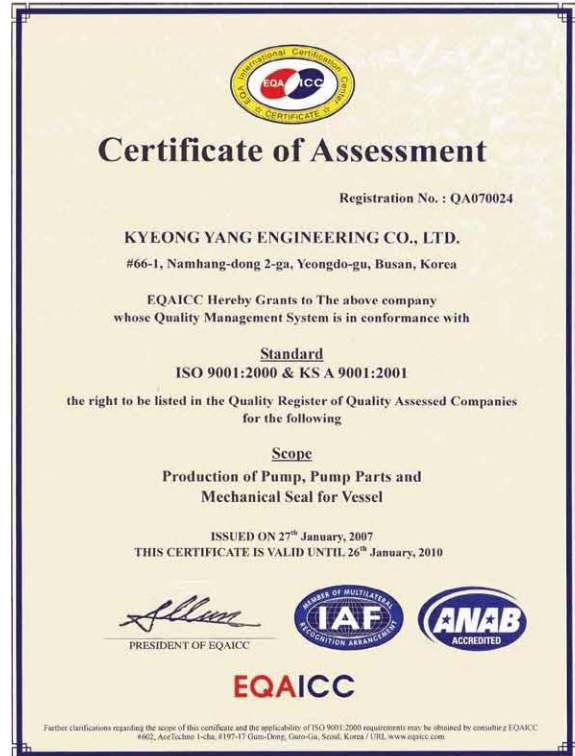
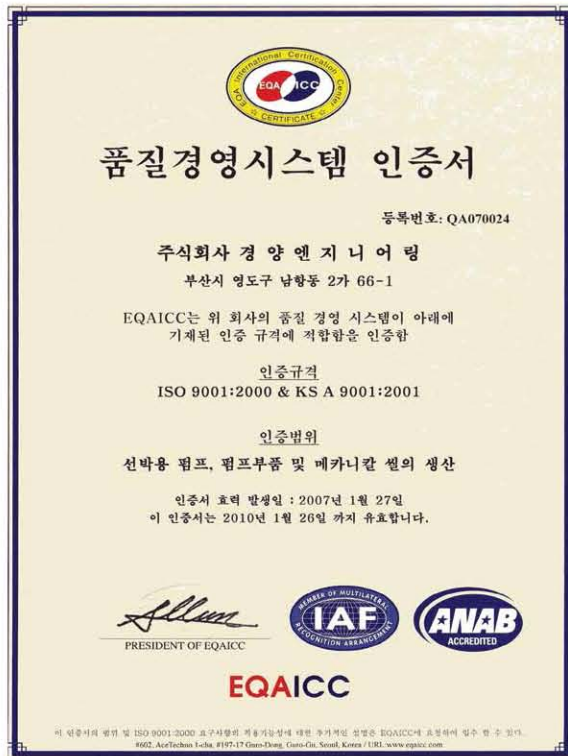

Our Company Produces The Marine Pumps

K Y P U M P

KY PUMP MECHANICAL SEAL





Our Company Produces The Marine Pumps

K Y P U M P

KY PUMP OTHER PUMPS



KY-01



KY-02



KY-03



KY-04



KY-05



KY-06



KY-07



KY-08



KY-09

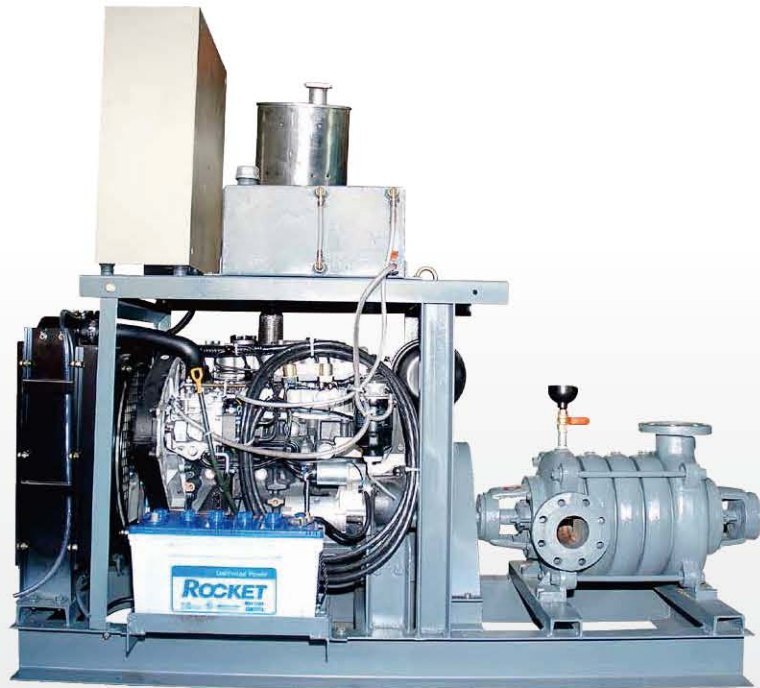

KY-10

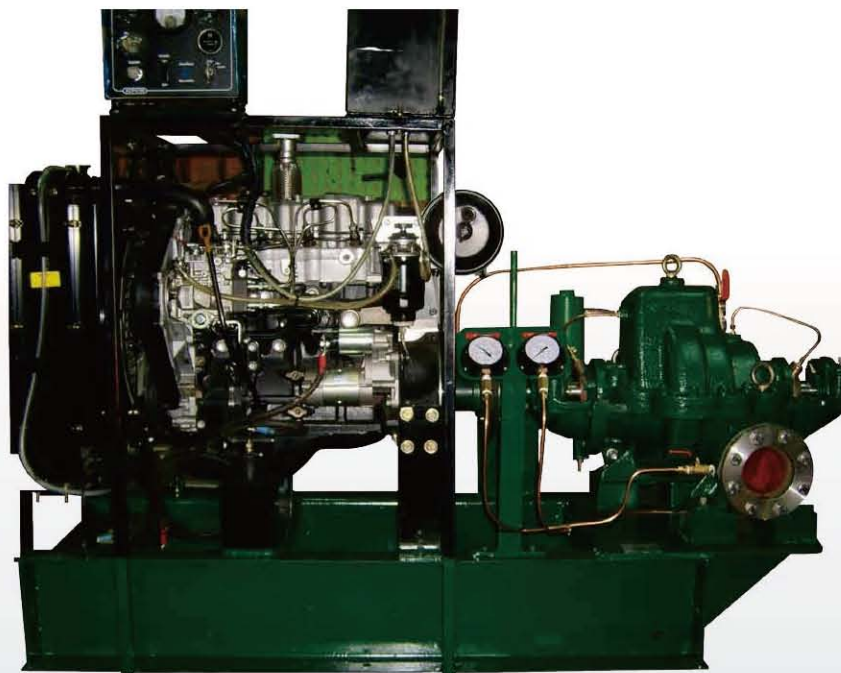

KY-11

WWW.KYPUMP.CO.KR
SINCE 1997



KYEONG YANG ENGINEERING CO.,LTD

#66-1, 2ga Namhang-dong, Youngdo-gu, Busan, Korea

T. +82-51-418-6628 F. +82-51-418-6630

E-mail. kypump@kypump.co.kr