



NK-250 Series

Turbine Flow meter Reliable
Measurement and Cost-effective

■ FEATURE

- Flange type or screw (male or female) type is selectively available.
- Relatively low cost
- DC / AC power type or battery type is selectively available
- Wide range of application to fluids at low temperature to high temperature
- Can be used with driving part and indicating part separated
- Capable of providing outputs of varied signals outward
- Can be freely installed horizontally and vertically
- Capable of measuring fluids with low flow rate and low flow speed
- Has high accuracy and excellent reproducibility.

■ APPLICATIONS

- ▶ General industry
 - Utility Use : Auxiliary and supply lines used in energy distribution
- ▶ Chemical and Other Process industry
 - Condensate and Coolant
 - Batching and mixing in the reactor
- ▶ Machinery and Equipment (OEM industry)
 - Coolant, Lubricant, Air supply
- ▶ Food and Beverage
 - Precise mixing, dosing and dispensing (Batching)
 - Beverages (soft drinks, beer, wine, fruit juice, etc.)
- ▶ Paper and Pulp industries

■ NK-250 General Specifications

Size	10A (3/8") - 25A (1")
Process Connection	PT (M or F)
Flow Ranges	Water - 1 L/min ~ 150 L/min
Accuracy	±0.5 % F.S
Fluid Temperature	-20 °C ~ 120 °C (Option -120 °C ~ 250 °C)
Ambient Temperature	-25 °C ~ 60 °C
Max. Pressure	Max. 50 kgf/cm ² .G (Option Max. 350 kgf/cm ² .G)
Viscosity	Under 30 cSt
Power Supply	AC 220 V / DC 24 V
Output	DC 4-20 mA, DC 0-5 V

■ MODEL CODE

N K - 2 5 0	-	□	Specification
		2	Output DC 0-5 V (With Signal Converter)
		4	Output DC 4-20 mA (With Signal Converter)

■ STRUCTURAL DRAWING

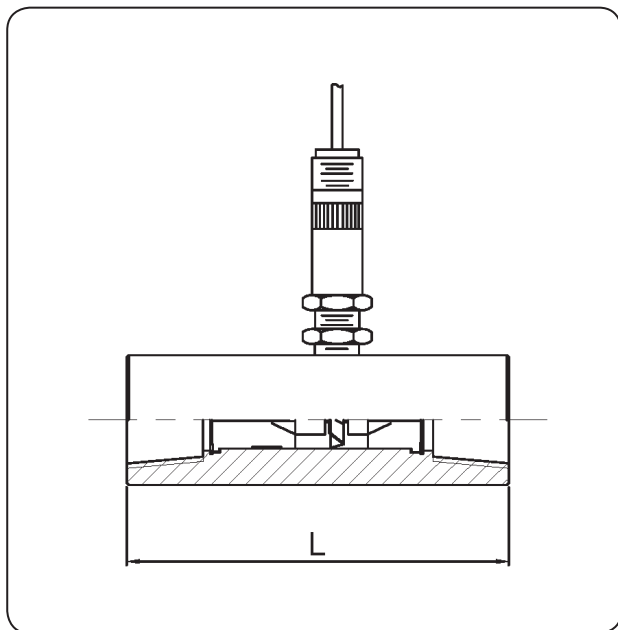

■ STANDARD MATERIAL

No.	Description	Material	
		Nomal	Option
1	Body	304SS	316SS
2	Rotor	CD4MCH	
3	Rotor shaft	Tungsten carbide	316LSS
4	Rotor supports	304SS	316SS
5	Bushing	Tungsten carbide	High density plastic
6	Thrust ball	Tungsten carbide	316SS
7	Retaining ring	304SS	316SS

■ FLOW RANGE & DIMENSIONS

Size		L (mm)	Flow ranges (m ³ /h)	Flow ranges (L/min)
Sensor	Connection			
6A	3/8B ~ 1/2B	80	0.06 ~ 0.6	1 ~ 10
10A			0.12 - 1.2	2 ~ 20
15A	1/2 B	130	0.4 - 4	6 ~ 60
	3/4 B	100		
20A	3/4 B	130	0.6 - 6	10 ~ 100
25A	1 B	140	1 - 10	15 ~ 150

■ FREQUENCY TO DC SIGNAL CONVERTER

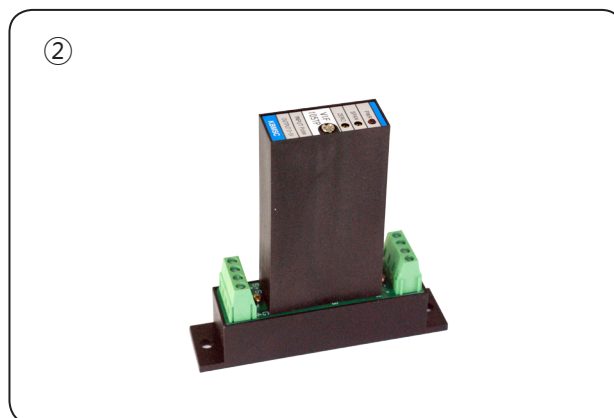

■ CONVERTER DRAWING

