

R4A Series 4Points

User's Guide

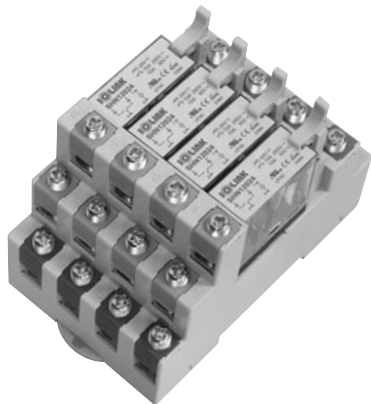

Thank you for purchasing product of SAMWON ACT.
Please check model of product that you purchase first, and read this manual prior to use it.

• Caution for Safety

Caution Case that results in serious damage in human body or equipment, and fire if user handles this equipment wrongly

Warning Case that results in slight damage in human body or equipment, and fire if user handles this equipment wrongly

Caution

- Do Not use other voltage except appointed voltage, (DC24V, AC110V, AC220V)
It may be the cause of fire or damage of equipment.
- Use it within nominal voltage and current which are marked on load.
It may be the cause of fire or damage of equipment.
- Check COMMON polarity of using controller (PLC, etc) first, and then select proper product.
It may be the cause of fire or damage of this equipment and user's.
- Please make sure to check the internal wiring diagram of the relay board and the arrangement of the controller PIN (terminal) when wiring the relay board between the controller (PLC etc.).
It may be the cause of malfunction or damage of this equipment and user's.

※ The connection cable for PLC of various makers is provided by us. Please refer to the catalogue or contact Head or branch office if you need more detail models and specifications.

Warning

- Plug or unplug power line and/or connector for signal after making sure to shut off power so as that it is prevented to be damaged or malfunctioned.
- Read this user's guide which is attached to product, and check product's performance, specification, operation pattern, signal, and how to handle prior to use. Keep user's guide please.
- When wiring the terminal block, please tighten it with the specified torque using the appropriate tool. If it is outside of this range torque, it may cause malfunction due to breakage or looseness of tightening surface terminal.

• Model Selection

Model	Installation Relay	IO Point(s)	Coil Rated voltage	Common		Interface		Dimensions (W×Dmm)	Mounting method
				Coil	Contact	Coil	Contact		
R4A-DC24VC	SAMWON ACT SHN12324	4Point (1c×4)	24V DC	Individual Power (4P Short bar built)	Individual Com. (4P Short bar built)	Screw Terminal 13.5mm Pitch		55,0×87,2	Screw mounting/ DIN Rail (Channel)
R4A-AC220VC	SAMWON ACT SHN111Y2		230V AC						
R4A-AC110VC	SAMWON ACT SHN111X1		115V AC						

• SHN Relay Specification

Item		SHN12324	SHN111Y2	SHN111X1
Contact	Arrangement	1 From C (1c)		
	Nominal switching capacity (resistive load)	10A 250V AC / 10A 30V DC		
	Max. switching voltage	250V AC / 30V DC		
	Max. switching power	3,000VA, 360W		
Coil	Nominal voltage	24V DC	230V AC	115V AC
	Pick-up voltage	75% max. of Rated voltage	80% max. of Rated voltage	
	Drop-out voltage	10% min. of Rated voltage	30% min. of Rated voltage	
	Coil resistance	1,100 Ω	23,000 Ω	6,300 Ω
	Nominal operating power	Approx. 0.53W	Approx. 1.0VA	
	Max. allowable voltage	110% max. of Rated voltage		
Initial breakdown voltage between contact and coil		5,000VAC/1mm		
Country of origin		CHINA		

• Material/Specification

Case		Modified PPO
P.C.B	Coil	Epoxy 1.6t
Pin header	Contact	C2680 t0.8 / C2100 t0.3
Applicable wire		AWG22~16 (MAX / 1.5mm ²)
Terminal Screw		M3.5 X 10L
Screw torque		7~8kgf・cm (0.68~0.78 N・m)
Ambient temperature		-10°C ~ +50°C (No condensation)

• How to use ring crimp terminal



• When the terminal is released, the bolt is coming up by tap of terminal cover. It's Self-up structure.

• Applicable crimp terminal

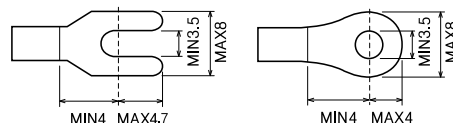

• Accessories

• 4Pole Short bar (2ea)

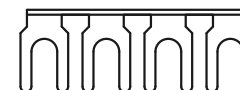

• How to replace relay

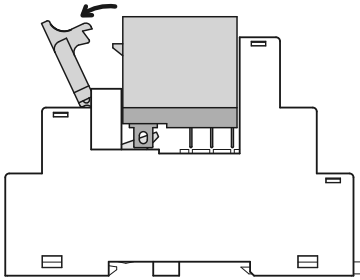

• The model of replacement relay

Model	Replacement relay
R4A-DC24VC	SHN12324
R4A-AC110VC	SHN111X1
R4A-AC220VC	SHN111Y2

• Dimension

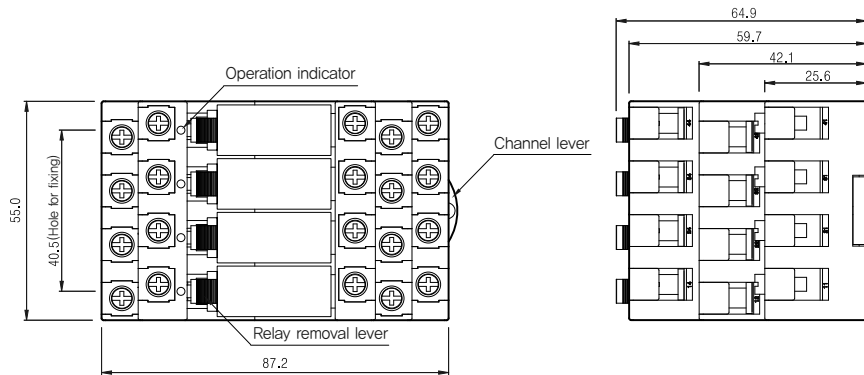
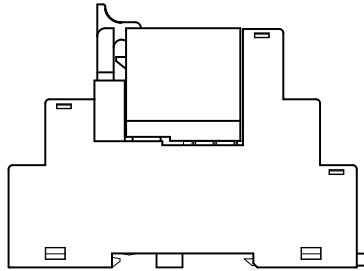

• Wiring Diagram

• R4A-DC24VC

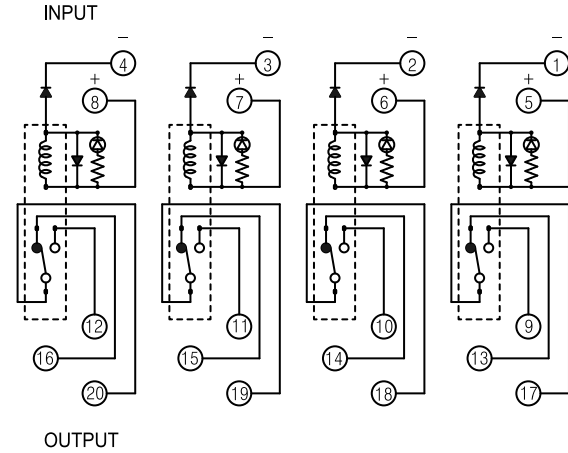

• R4A-AC110VC, R4A-AC220VC

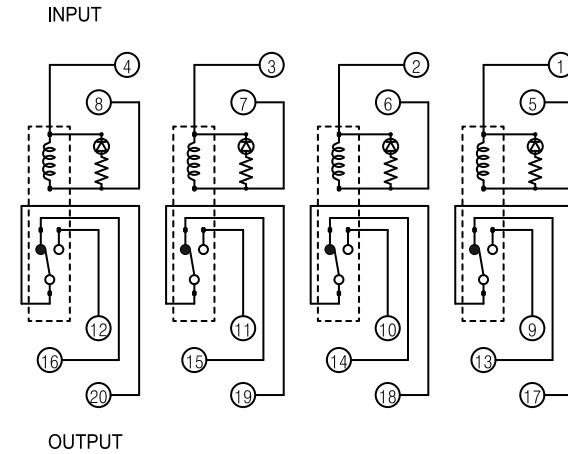

- ※ The above specifications are subject to change without notice.
- ※ Please contact HQ or branch office where you purchased product for A/S of this product or technique.

Major products

- Relay terminal 1, 2, 4, 6, 8, 16, 32point
- Interface terminal 20, 24, 26, 34, 40, 50, 57, 40 x 2pole
- PLC I/O Connecting cables MITSUBISHI, LSIS, CIMON, OMRON, FUJI, YOKOGAWA, HITACHI, SIEMENS, AB, etc.
- Servo Connecting cables Encoder cable, Power cable, Motion cable / MITSUBISHI, YASKAWA, OMRON, PANASONIC, LSIS, SAMSUNG, etc.
- Wiring harness / Special cable assembly



■ HQ : 47035, 28, Daedong-ro, Sasang-gu, Busan
 TEL : (051)320-7777 FAX : (051)312-2233
 ■ SEOUL Office: 14353, M Cluster-707, 17, Deogang-ro
 104beon-gil, Gwangmyeong-si, Gyeonggi-do
 TEL : (02)837-2230 FAX : (02)837-2226