

DESIGN DATA

CODE	N/A		
UNIT	mm		
KIND OF FLUID	-		
PRESS.	DESIGN	1(Max.)	Kg/Cm ²
	OPERATING	-	Kg/Cm ²
TEMP. (SENSOR)	DESIGN	-10 ~ 80	°C
	OPERATING	-	°C
TEMP. (ELECTRONICS)	DESIGN	-10 ~ 60	°C
	OPERATING	-	°C
CONTACT RATING	250V AC, 5A		
POWER SUPPLY	AC110V/220V ±10, 50/60Hz		
ENCLOSURE	WEATHER PROOF		
OUTPUT	1 DPDT		
VISCOSITY	1Pa.s/10P Less		
MOISTURE	Max 80%RH		

L	<input checked="" type="checkbox"/> 250 mm(STD)
	<input type="checkbox"/> OPTION (mm) Max. 1000mm

TAG NO.	-

NOTES

REVISION

5	HEAD	ADC12	1		
4	MOUNT NIPPLE	316SS	1		
3	EARTH ROD	316SS	1		
2	INSULATOR	PPS	1		
1	MEASURING ROD	316SS	1		
NO	DESCRIPTION	MATERIAL	Q'TY	SPECIFICATION	REMARK

BILL OF MATERIAL

CUSTOMER	-
PROJECT	-
TITLE	CAPACITANCE TYPE LEVEL SWITCH SCAP-1-B-1-A-1-A-1 ASSEMBLY DRAWING
MANUFACTURER	SeoJin Instech Co.,Ltd.

SCALE		ERP CODE	0000	Work Order No.	-	REV.	
N/S	DWG NO.	SJ-M024-DWG-AP002					

WIRING DIAGRAM

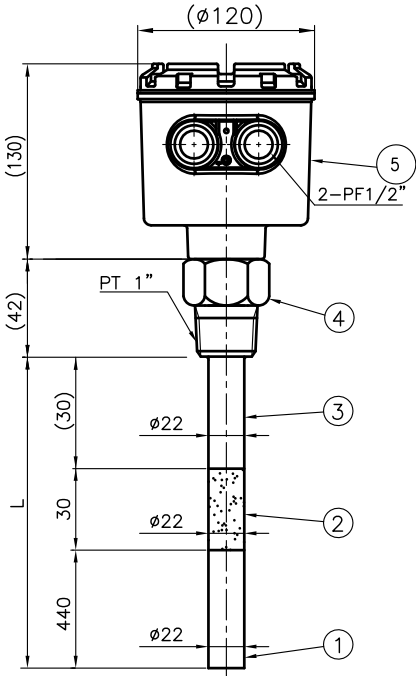
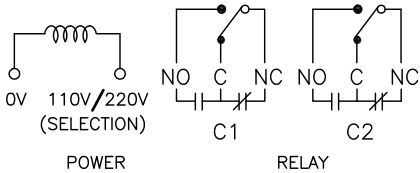

	FOR APPROVAL				
REV.	DESCRIPTION	DATE	DESIGNED	REVIEWED	APPROVED