

ACCESSORIES

series
**CCA
CPS**

Plates Series PC - Material: Tropicalized Steel

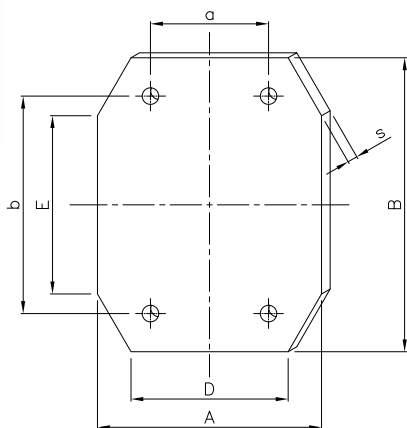

Order Code	Enclosure	Dimensions (mm)					Internal Fixing			Weight (g)
		A	B	D	E	S	a	b	ØC	
PC 0	CCA 0 CPS 0	105	105	42	92	2	40	90	M6	160
PC 1	CCA 1 CPS 1	120	120	48	100	2	48	100	M6	210
PC 2	CCA 2 CPS 2	140	140	70	124	2	58	120	M6	380
PC 3	CCA 3 CPS 3	160	190	75	150	2	70	147	M6	620
PC 4	CCA 4 CPS 4	200	230	88	182	2	85	182	M6	900
PC 5	CCA 5 CPS 5	215	265	100	207	2	100	207	M6	1170

INSTRUMENT MOUNTING KIT

series
**CCA
CPS**

Disk Series K - Material: tropicalized Steel, painted black (RAL 9005)

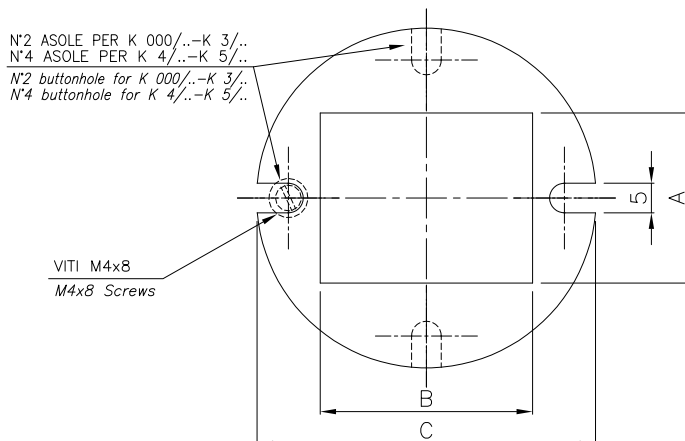

Order Code	Enclosure	Instrument Dimensions	Dimensions (mm)		
			A	B	C
K 0/00	CPS 0	48 x 48	45	45	111
K 0/01	CPS 0	48 x 72	45	68	111
K 0/11	CPS 0	72 x 72	68	68	111
K 1/11	CPS 1	72 x 72	68	68	126
K 1/02	CPS 1	48 x 96	45	92	126
K 1/12	CPS 1	72 x 96	68	92	126
K 2/02	CPS 2	48 x 96	45	92	146
K 2/12	CPS 2	72 x 96	68	92	146
K 2/22	CPS 2	96 x 96	92	92	146
K 3/12	CPS 3	72 x 96	68	92	175
K 3/22	CPS 3	96 x 96	92	92	175
K 3/03	CPS 3	48 x 144	45	137	175
K 3/13	CPS 3	72 x 144	68	137	175
K 4/03	CPS 4	48 x 144	45	137	214
K 4/13	CPS 4	68 x 144	68	137	214
K 4/23	CPS 4	96 x 144	92	137	214
K 4/33	CPS 4	144 x 144	137	137	214
K 5/23	CPS 5	96 x 144	92	137	244
K 5/33	CPS 5	144 x 144	137	137	244

NOTES

On request disks having instrument dimensions as specified by the customer are available; obviously they shall be consistent with the internal dimensions of the chosen enclosure.