

R16G-EF Series 16Points, Detachable Push-typed Screwless Terminal Block

User's Guide

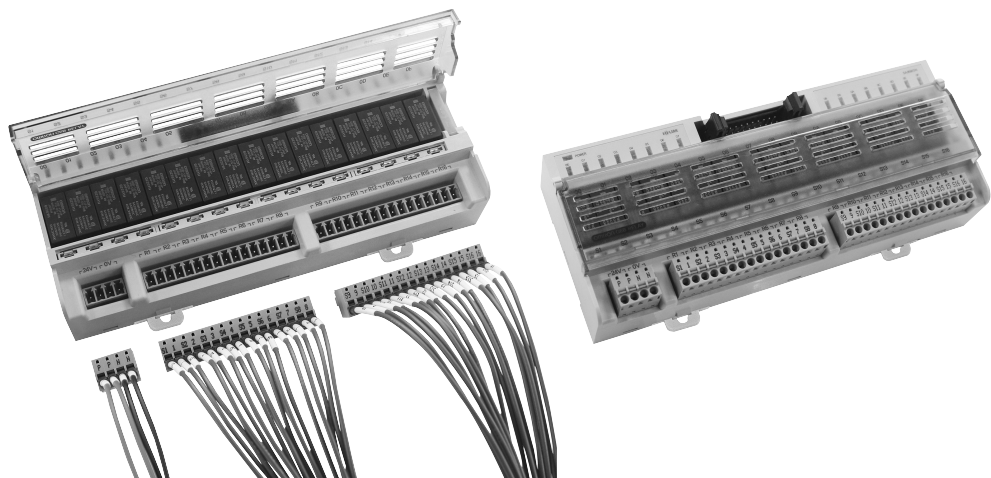

Thank you for purchasing product of SAMWON ACT.
Please check model of product that you purchase first, and read this manual prior to use it.

• Caution for Safety

Caution Case that results in serious damage in human body or equipment, and fire if user handles this equipment wrongly

Warning Case that results in slight damage in human body or equipment, and fire if user handles this equipment wrongly

Caution

- Do Not use other voltage except appointed voltage. It may be the cause of fire or damage of equipment.
- Use it within nominal voltage and current which are marked on load.
It may be the cause of fire or damage of equipment.
- Check COMMON polarity of using controller (PLC, etc) first, and then select proper product.
It may be the cause of fire or damage of this equipment and user's.
1) COMMON Polarity of controller is '+' (NPN TYPE) : R16G-NC-EF
2) COMMON Polarity of controller is '-' (PNP TYPE) : R16G-PC-EF
- Make controller and connection cable between relay boards after checking internal wiring of relay board and PIN (terminal or socket) array of controller if you want to make it for yourself.
It may be the cause of fire, and malfunction or damage of this equipment and user's.

※ The connection cable for PLC of various makers is provided by us. Please refer to the catalogue or contact Head or branch office if you need more detail models and specifications.

Warning

- Terminal wiring of power line and connector for signal after making sure to shut off power so as that it is prevented to be damaged or malfunctioned.
- Read this user's guide which is attached to product, and check product's performance, specification, operation pattern, signal, and how to handle prior to use. Keep user's guide please.
- When replacing a relay, check how to replace the relay on the back of the manual before using it.

• Model Configuration

Model	Installation Relay	IO Point(s)	Coil Rated voltage	Common		Interface		Dimen-sions	Mounting method
				Coil	Contact	Coil	Contact		
R16G-NC-EF	OMRON	16 Point (1a * 16)	24V DC	NPN	Individual Com. (4P Short bar built)	Connector MIL-C-83503 20Pin	Push type Terminal 3.81mm Pitch	173.5 * 70	DIN Rail (Channel)
R16G-PC-EF	G6B-1174P-FD-US DC24V			PNP					

• G6B Relay Specification

Item		G6B-1174P-FD-US DC24V
Contact	Arrangement	SPST-NO (1a)
	Nominal switching capacity (resistive load)	5A 250V AC / 5A 30V DC
	Max. switching current	5A
	Max. switching voltage	380V AC / 125V DC
Coil	Nominal voltage	24V DC
	Pick-up voltage	70% max. of Rated voltage
	Drop-out voltage	10% min. of Rated voltage
	Coil resistance	2,880 Ω
	Nominal operating power	Approx. 200mW
Surge voltage between contact and coil		6,000V
Initial breakdown voltage between contact and coil		AC 3,000V 50/60Hz 1min
Country of origin		JAPAN

• Material/Specification

Case		Modified PPO
Protective cover		Polycarbonate
P.C.B		Epoxy 1,6t
Terminal		PA66
Pin header		Phosphor bronze
Wire guard		Stainless steel
Applicable wire	Single wire	0.5~1.5mm ²
	Twisted wire	UL : 16~22AWG / IEC : 1.5mm ²
Ambient temperature		-10℃ ~ +50℃ (No condensation)

* Be sure to use a ferrule when using a stranded wire.
* It is recommended to use a round type terminal when using a stranded wire with 1.5mm².

• Method of removal wire

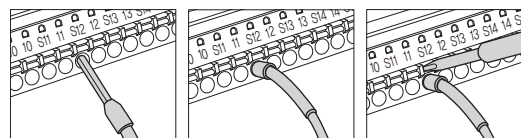

When using a stranded wire, use a ferrule or a round type terminal. In case of a solid wire, use it without crimping tool.
Insert into the terminal block without using a separate tool.
When disconnecting the wires, keep the disconnect button pressed with the driver (- type) and disconnect the wires.

• How to replace relay

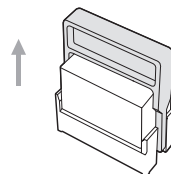

• Appropriate tool

- Driver

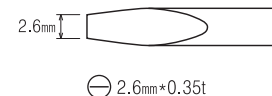

• Ferrule Selection

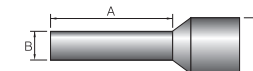

AWG/(mm ²)	DIN46228	Other	A(mm)	B(mm)	C(mm)
20/0.5	White	White/Orange	10.0	1.3	3.2
18/0.75	Gray	Blue/White	10.0	1.5	3.4
17/1.0	Red	Red/Yellow	10.0	1.7	3.6

• Accessories

- Short bar (4ea)



• Dimension

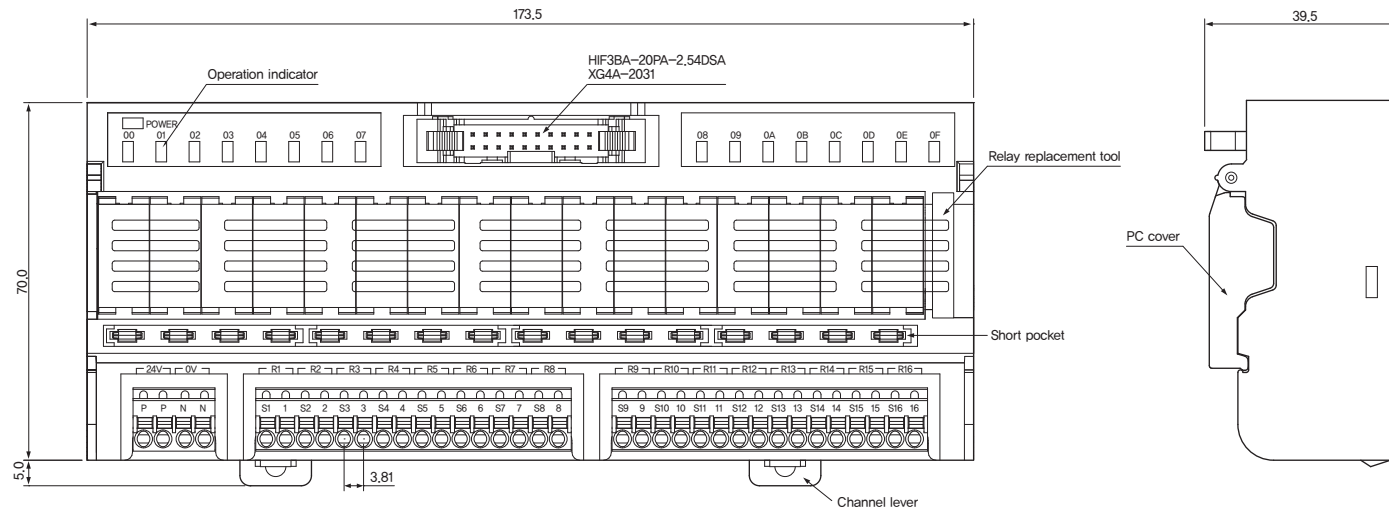

• Wiring Diagram

• R16G-NC-EF (+COM)

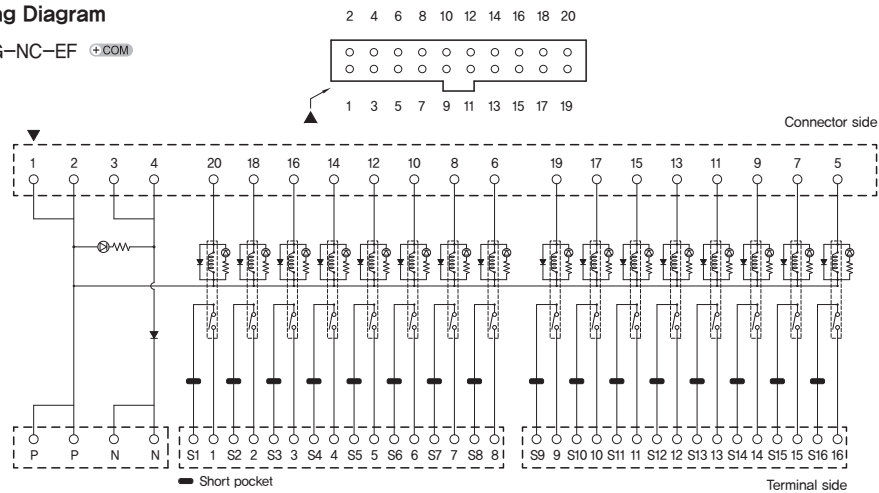

• Wiring Diagram

• R16G-PC-EF (-COM)

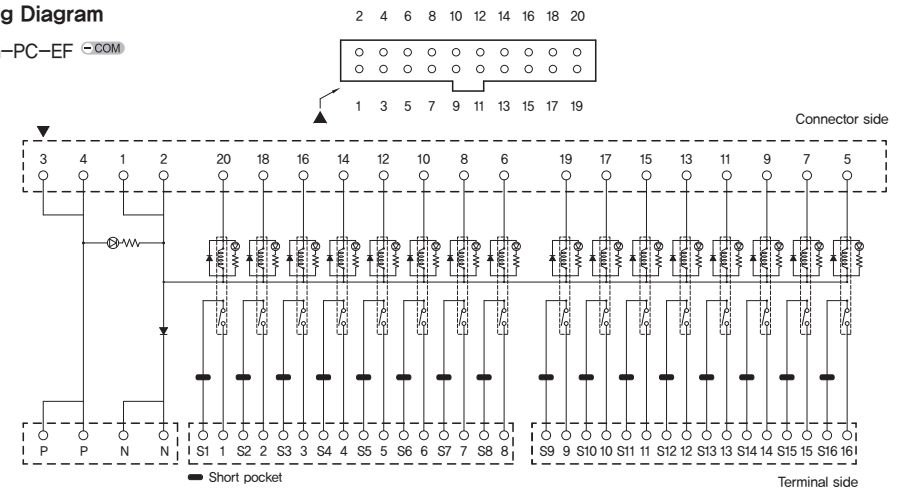

※ The above specifications are subject to change without notice.

※ Please contact HQ or branch office where you purchased product for A/S of this product or technique.

Major products

- Relay terminal 1, 2, 4, 6, 8, 16, 32point
- Interface terminal 20, 24, 26, 34, 40, 50, 57, 40 x 2pole
- PLC I/O Connecting cables MITSUBISHI, LSIS, CIMON, OMRON, FUJI, YOKOGAWA, HITACHI, SIEMENS, AB, etc.
- Servo Connecting cables Encoder cable, Power cable, Motion cable / MITSUBISHI, YASKAWA, OMRON, PANASONIC, , LSIS, SAMSUNG, etc.
- Wiring harness / Special cable assembly