

13-3

후리카 타이머
Flicker Timer

형식 구분도 | Type Classification Diagram |

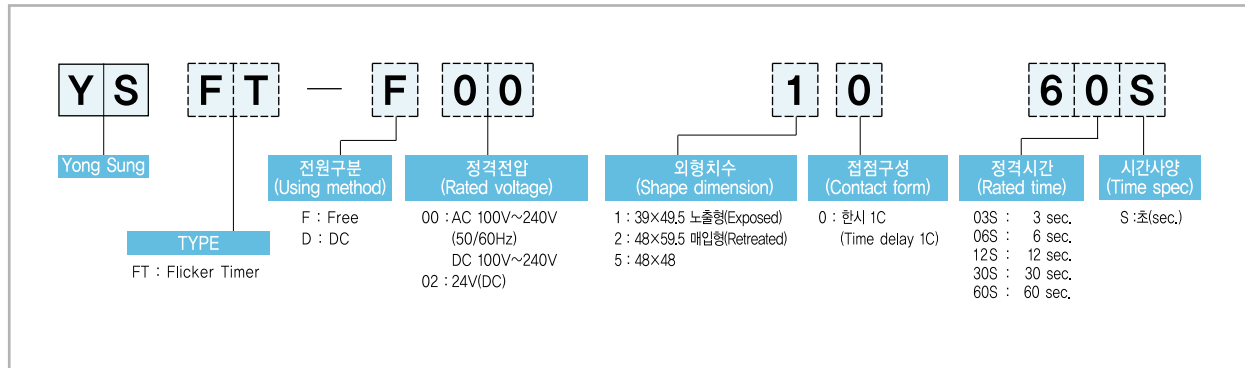

특징 | Features |

- IC를 사용하여 점멸되는 시간이 일정합니다.
- 소형이면서 고신뢰성입니다.
- 소형화로 소비전력이 적습니다.
- 동작 시간을 임의로 가변할 수 있습니다. (주-on, off duty 비 50% 고정)
- Switching time is constant by using IC.
- Compact size and high reliability.
- With small size, power consumption is economized.
- Operating time can be optionally changed. (Note-on/off duty rate is fixed at 50%.)

성능 개요 | Performance Summary |

정격전압 (Rated voltage)	AC 100V~240V (50/60Hz) DC 100V~240V DC 24V
설정오차 (Setting error)	정격시간의 ±5% (±5% in rated time)
허용전압변동범위 (Allowable voltage variation range)	정격전압의 ±10% (±10% in rated voltage)
시간가변범위 (Time variation range)	on/off duty 50% 고정 (on/off duty rate is constant as 50%.)
소비전력 (Power consumption)	기술자료 20-2 참조 (Refer to Technical Data 20-2)
동작시간정도 (Operating time degree)	정격전압시 약 ±0.5% (About ±0.5% in rated voltage)
출력 (Output)	RELAY 출력 1C (1a, 1b) (Relay output 1C (1a, 1b))
Relay접점정격 (Relay contact Rated)	AC 250V, 3A (저항부하) (AC 250V, 3A (Resistive load))
수명 (Life time)	Electrical : above 100,000 times, Mechanical : above 5 million times
절연저항 (Insulation resistance)	500V. Meg에서 100MΩ 이상 (About 100MΩ at 500V. Meg)
사용주위온도 (Ambient temperature)	-10℃ ~ +50℃
상대습도 (Relative humidity)	45 ~ 85%

외형 / 치수도 | Shape / Dimension Drawing |

(unit : mm)

YS FT-1

※ 적용 소켓 (Applied Socket) : YS SK08

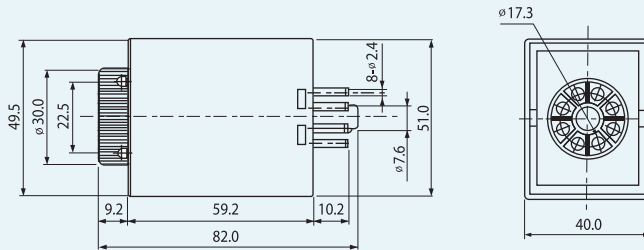

YS FT-2

※ 적용 소켓 (Applied Socket) : YS SK08

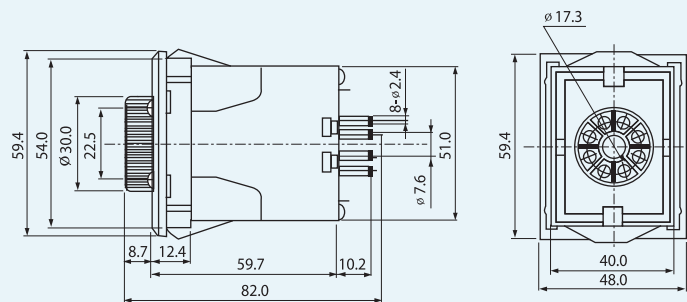

※ 노출형과 동일제품이니 매입형으로 사용시는 Bracket를 별도 구입 바랍니다.
(If you need the retreated type, purchase the bracket separately please.)

YS FT-5

※ 적용 소켓 (Applied Socket) : YS SK08-F

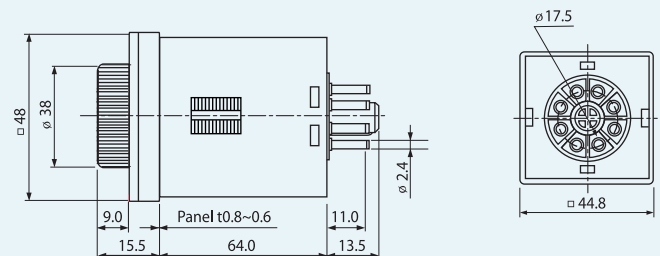

접속도 / 동작 Pattern | Connection Diagram / Operating Pattern |

형식 (Type)	접속도 (Connection Diagram)	동작 (Operating Pattern)
YS FT		<p>입력(input) (2-7) </p> <p>한시a점점(time delay a contact) (8-6) </p> <p>한시b점점(time delay b contact) (8-5) </p> <p>(t1=t2)</p>