

R4P Series 4points, 10A, 1C Contact

User's Guide

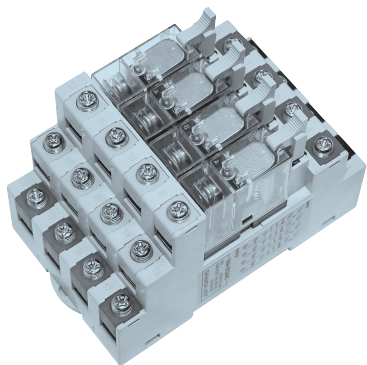

Thank you for purchasing product of SAMWON ACT.
Please check model of product that you purchase first, and read this manual prior to use it.

• Caution for Safety

⚠ Caution Case that results in serious damage in human body or equipment, and fire if user handles this equipment wrongly

⚠ Warning Case that results in slight damage in human body or equipment, and fire if user handles this equipment wrongly

⚠ Caution

1. Do Not use other voltage except appointed voltage. (DC24V, AC110V, AC220V)
It may be the cause of fire or damage of equipment.
2. Use it within nominal voltage and current which are marked on load.
It may be the cause of fire or damage of equipment.
3. Check COMMON polarity of using controller (PLC, etc) first, and then select proper product.
It may be the cause of fire or damage of this equipment and user's.
4. Please make sure to check the internal wiring diagram of the relay board and the arrangement of the controller PIN (terminal) when wiring the relay board between the controller (PLC etc.).

※ The connection cable for PLC of various makers is provided by us. Please refer to the catalogue or contact Head or branch office if you need more detail models and specifications.

⚠ Warning

1. Use within the specified temperature range. (−10℃ ~ +50℃) Damage to the outer case may occur.
2. Plug or unplug power line and/or connector for signal after making sure to shut off power so as that it is prevented to be damaged or malfunctioned.
3. Read this user's guide which is attached to product, and check product's performance, specification, operation pattern, signal, and how to handle prior to use. Keep user's guide please.
4. When wiring the terminal block, please tighten it with the 0.68~0.78N · m torque using the appropriate tool.
If it is outside of this range torque, it may cause malfunction due to breakage or looseness of tightening surface terminal.

• Model Selection

Model	Installation Relay	IO Point(s)	Coil Rated voltage	Common		Interface		Dimensions (W×Dmm)	Mounting method
				Coil	Contact	Coil	Contact		
R4P-DC24VC	OMRON G2R-1-S DC24V	4Point (1a×4)	24V DC	Individual Power (4P Short bar built)	Individual Com. (4P Short bar built)	Screw Terminal 13.5mm Pitch		55.0×87.2	Screw mounting/ DIN Rail (Channel)
R4P-AC220VC	OMRON G2R-1-S AC220V		200/220V AC						
R4P-AC110VC	OMRON G2R-1-S AC110V		100/110V AC						

• G2R Relay Specification

Item		G2R-1-S DC24V	G2R-1-S AC220V	G2R-1-S AC110V
Contact	Arrangement	1 From C (1c)		
	Nominal switching capacity (resistive load)	10A 250V AC / 10A 30V DC		
	Max. switching currentt	10A		
	Max. switching voltage	380V AC / 125V DC		
	Max. switching power	2,500VA, 300W		
Coil	Nominal voltage	24V DC	200/220V AC	100/110V AC
	Pick-up Voltage	70% max.	80% max. of rated voltage	
	Drop-out Voltage	15% min.	30% min. of rated voltage	
	Coil resistance	1,100 Ω	20,200 Ω	4,600 Ω
	Nominal operating power	Approx. 530mW	Approx. 0.9VA/0.7VA at 60Hz	
	Max. allowable voltage	170%	140% of rated voltage (at23℃)	
Initial breakdown voltage between contact and coil		5,000V AC 50/60Hz 1min		
Country of origin		MALAYSIA		

• Material/Specification

Case		Modified PPO
P.C.B	Coil	Epoxy 1.6
Pin header	Contact	C2680 ±0.8 / C2100 ±0.4
Applicable wire		AWG22~16 (MAX / 1.5mm ²)
Terminal Screw		M3.5 X 10L
Screw torque		7~8Kgf · cm (0.68~0.78 N · m)
Ambient temperature		−10℃ ~ +50℃ (No condensation)

• How to use ring crimp terminal

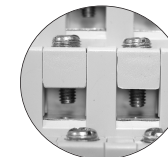

• When the terminal is released, the bolt is coming up by tap of terminal cover. It's Self-up structure.

• Applicable crimp terminal

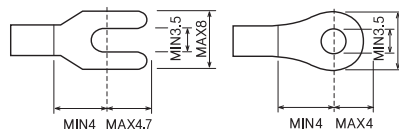

• Accessories

• 4Pole Short bar (2ea)

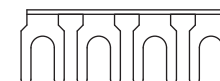

• How to replace relay

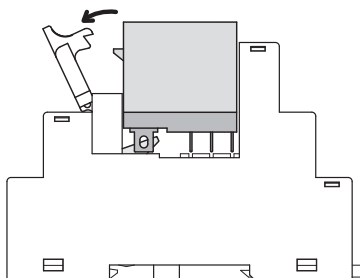

• The model of replacement relay

Model	Replacement relay
R4P-DC24VC	G2R-1-S, DC24V
R4P-AC110VC	G2R-1-S, AC110V
R4P-AC220VC	G2R-1-S, AC220V

• Dimension

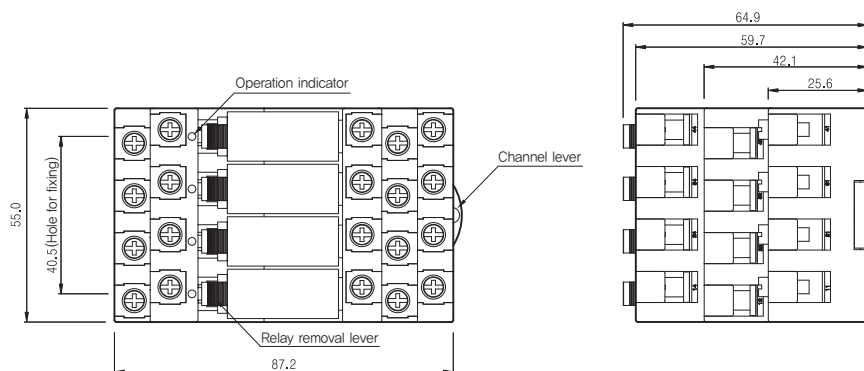
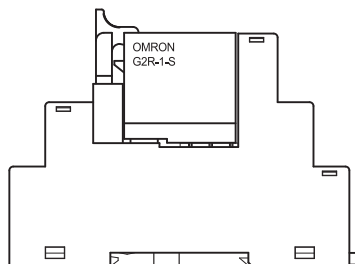

• Wiring Diagram

• R4P-DC24VC

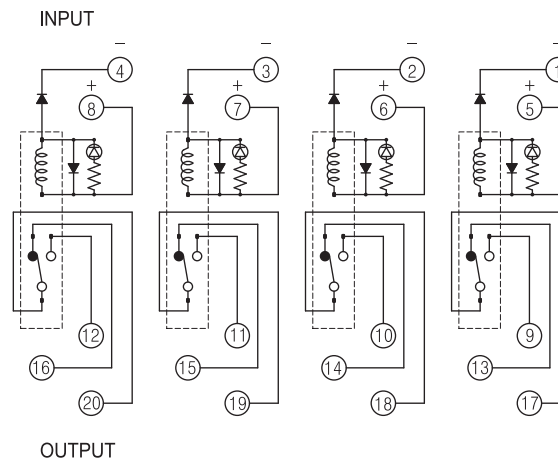

• R4P-AC110VC, R4P-AC220VC

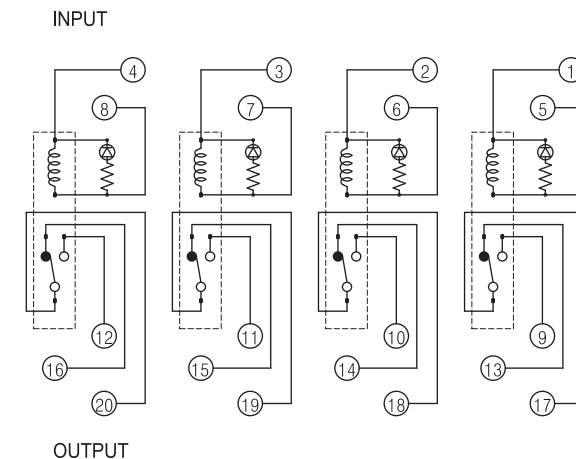

※ The above specifications are subject to change without notice.

※ Please contact HQ or branch office where you purchased product for A/S of this product or technique.

Major products

- Relay terminal 1, 2, 4, 6, 8, 16, 32point
- Interface terminal 20, 24, 26, 34, 40, 50, 57, 40 x 2pole
- PLC I/O Connecting cables MITSUBISHI, LSIS, CIMON, OMRON, FUJII, YOKOGAWA, HITACHI, SIEMENS, AB, etc.
- Servo Connecting cables Encoder cable, Power cable, Motion cable / MITSUBISHI, YASKAWA, OMRON, PANASONIC, LSIS, SAMSUNG, etc.
- Wiring harness / Special cable assembly

삼원ACT(주)
SAMWON ACT Co., Ltd.

■ HQ : 47035, 28, Daedong-ro, Sasang-gu, Busan, Korea
TEL : (051)320-7777 FAX : (051)312-2233
■ SEOUL Office: 501, Iljok-dong, Gwangmyeong-si, Gyeonggi-do
TEL : (02)837-2230 FAX : (02)837-2226