

WIRING DIAGRAM

P TYPE(STD.) [P : 127]

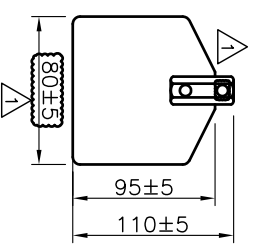

1 F TYPE [P : 100]

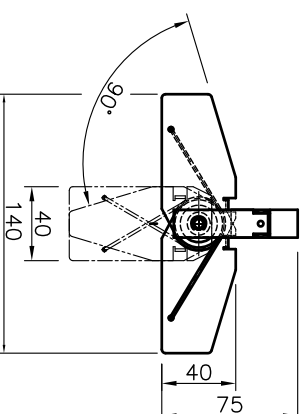

0 TYPE [P : 70]	G TYPE [P : 70]
-----------------	-----------------

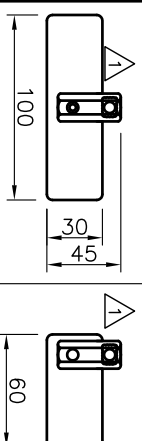

△				
△				
△				
△	FOR REVISION	2020.05.21	S.J.LIM	D.N.LEE
△	FOR APPROVAL	2019.03.21	H.I.JOUNG	S.H.LEE
REV.	DESCRIPTION	DATE	DESIGNED	REVIEWED
				APPROVED

DESIGN DATA			
CODE	N/A		
UNIT	mm		
KIND OF FLUID	-		
PRESS.	DESIGN OPERATING	Max. 10	Kg/Cm ²
TEMP. (SENSOR)	DESIGN OPERATING	-10 ~ 80	Kg/Cm ²
TEMP. (ELECTRONIC)	DESIGN OPERATING	-20 ~ 60	°C
CONTACT RATING	DESIGN OPERATING	-	°C
POWER SUPPLY	250V AC	5A	
ENCLOSURE	220V AC ±10%, 5/60Hz	WEATHER PROOF	
POWER CONSUMPTION	Max. 4.0W		

DESIGN DATA

NOTES

1. () Dimensions are reference dimensions.

REVISION

NO	DESCRIPTION	MATERIAL	QTY	SPECIFICATION
6	PADDE	304SS	1	
5	MAIN SHAFT	304SS	1	
4	FLANGE	304SS	1	ANSI 150# 3" FF
3	STEM	304SS	1	
2	HOUSING	ADC9	1	
1	COVER	ADC9	1	

BILL OF MATERIAL

CUSTOMER

1

PROJECT

1

TITLE	

FLOAT TYPE LEVEL TRANSMITTER
 SPS+-3-A-1-C-OP-O-1-A
 ASSEMBLY DRAWING

MANUFACTURER



Seojin Instech Co., Ltd.

SCALE			REV.
N/S	DWG NO.	ERP CODE 0000	Work Order No. -
Sj-M026-DWG-AP016			