

WATER INGRESS ALARM SYSTEM

(MODEL: WIDS-2000)



B-I INDUSTRIAL CO., LTD.

<http://www.b-i.co.kr>

WATER INGRESS ALARM SYSTEM (MODEL: WIDS-2000)

KEY FEATURES

- No Filtration for Most of Dry Cargoes
- Specially Designed Compact Filter for Wet Cargoes
- Exact Compliant with Regulation 12 OF SOLAS Chapter XII (MSC 77)
- Capacitance Sensor by Microchip Technology
- Intrinsically Safe System (Ex ia IIB T6)
- IS BARRIER for all Electric Circuit
- Complete Dustproof & Waterproof(Protection Grade: IP68)
- No Electrical Corrosion by Micro Current
- Easy Installation & Maintenance
- Overriding Function for Ballast Cargo Hold & Fore Peak Tank
- Each Distinguishable Sound for System Fault, High and High-High Level
- Data Logging to PC & DVR by PLC Logic
- Type Approval by KR, DNV, NK, ABS, and LR

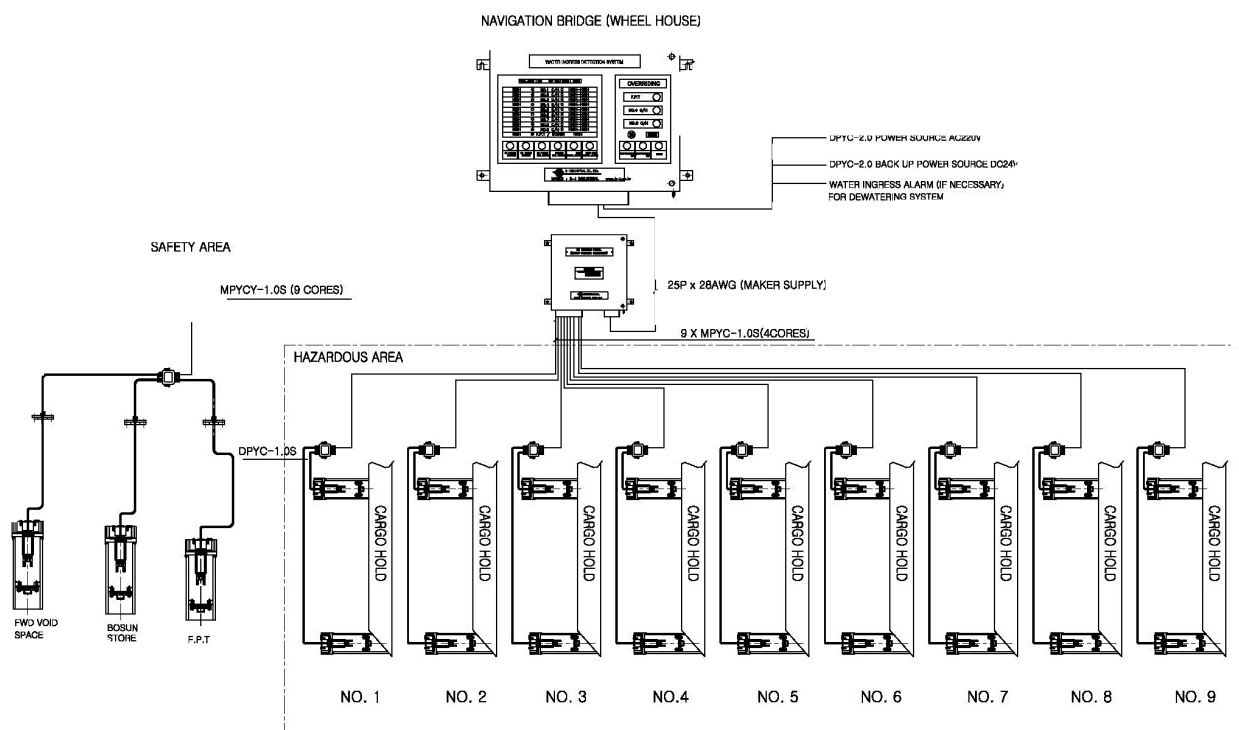

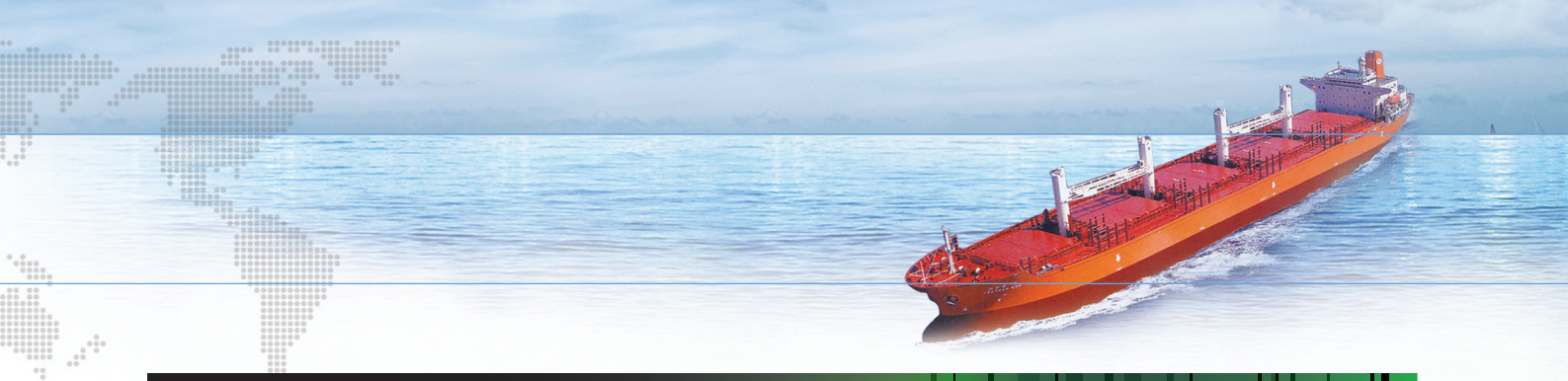

MAIN CONTROL PANEL(WHEEL HOUSE)

- Power Supply(Primary: AC220V, Back Up: DC24V)
- 20 Point Input/Output and the Extension up to 9 points if required
- Each distinguishable Visible & Audible Alarm for System Fault, High and High-High Level
- Overriding Function(Auto & Manual Reset)
- System fault alarm(Wire Break, Short Circuit)
- AC & DC Power Fail Alarm
- Emergency DC 24V Backup System when AC Power Break Down
- PLC Logic for VDR & Downloading to Personal Computer

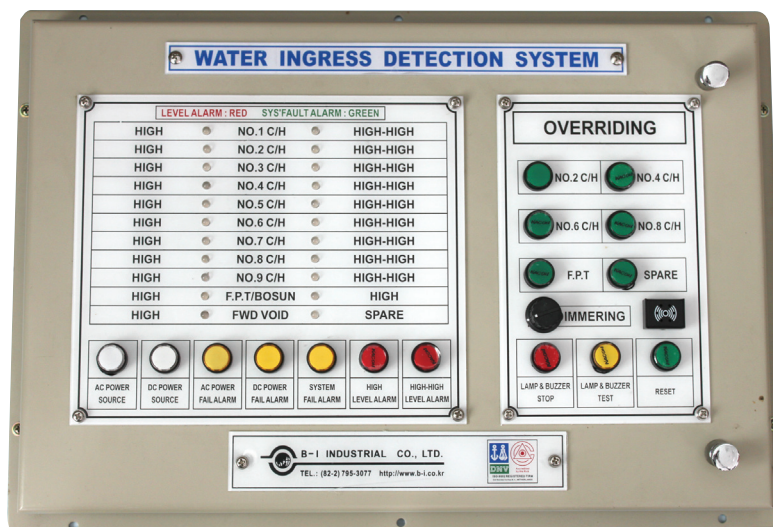

IS BARRIER PANEL(WHEEL HOUSE)

- DIN Rail Type of IS BARRIER
- Power Supply: DC24V
- Current Consumption: $\leq 1.3W$
- Operating Voltage to Sensor:
DC 8V Status Indication
- Fault Indication: Yellow/Red(2Color LED)
- Ambient Temperature: -25~60°C
- Explosion Proof Grade: Ex ia IIB T4



WATER INGRESS ALARM SYSTEM (MODEL: WIDS-2000)

WATER DETECTING SENSOR

Capacitance type level sensor

- Protection Grade: IP68
- Ambient Temperature: -25~70℃
- Storage Temperature: -30~80℃
- Power Supply Voltage Range: 10~30VDC
- Current Consumption: Max. 15mA
- Residual Voltage: Max. 1.5V
- Sensing Distance: 15mm \pm 10%
- Installation Method: Top or side Mounting
- Housing Material: SUS 304/316
- Explosion-proof Certification: Ex ia IIB T6
- Dimension: Flange(5K 40A)/Sensor(L=125mm, Dia.: 38)
- Weight: Approx. 2kg

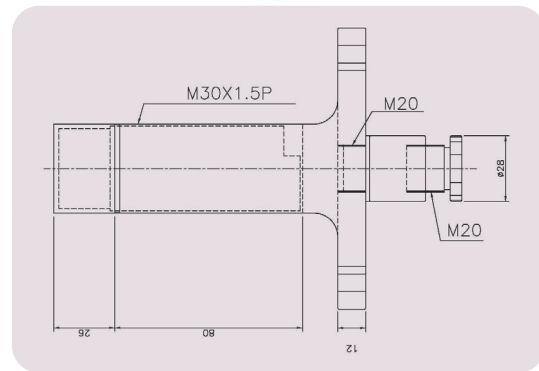
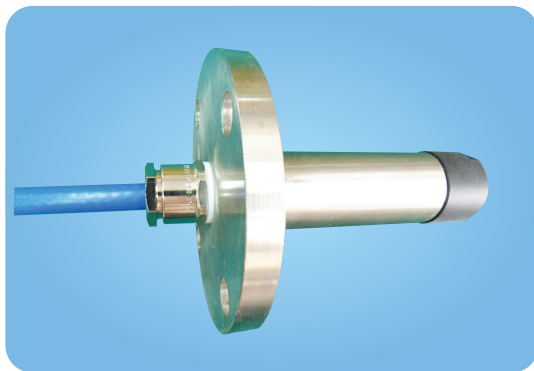

BUSAN FACTORY

2508-1 Daejeo-2 dong, Kangseo-gu, Busan, Korea 618-808 Tel. +82-51-441-5670(REP) Fax. +82-51-441-6225

SEOUL OFFICE

1-618 Ace Hightech City, 55-20 Munrae-dong, Youngdeungpo-gu, Seoul, Korea 150-835 Tel. +82-2-706-3077(REP) Fax. +82-2-702-3076

E-mail: international@b-i.co.kr http://www.b-i.co.kr