

Weigh Module

Model BMH Series

Specially Designed For
Hopper, Bin and Tank(1t ~ 10t)

- Self centering design for accurate weighing.
- Self checking and overlift protection structure for no check rods needed.
- Alloy steel, Stainless steel Load Cell.

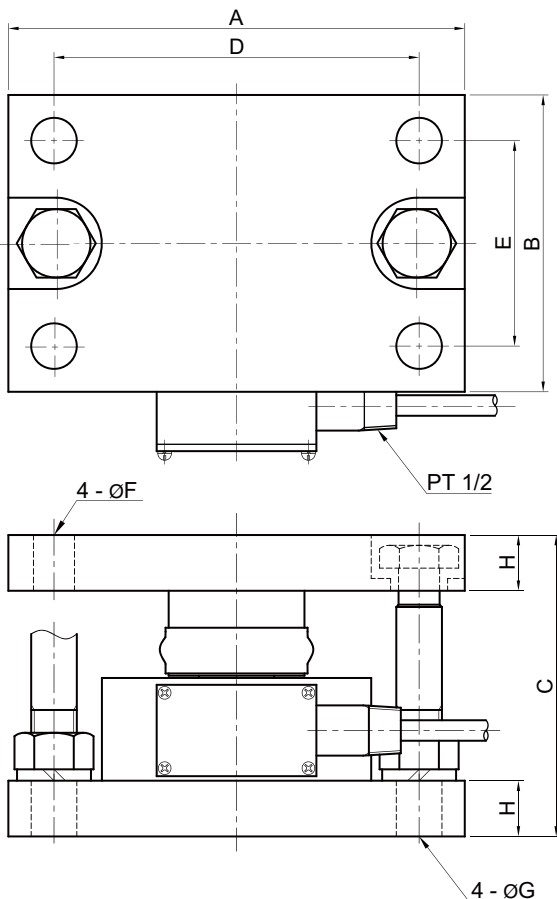
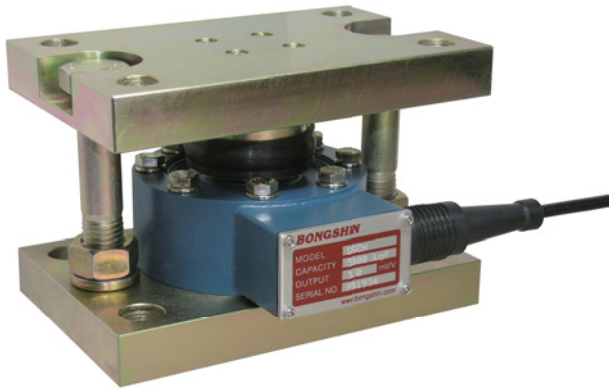

Dimension-mm

Rated Capacity	A	B	C	D	E	F	G	H	Weight (kg)
1, 2t (9.807 kN, 19.61 kN)	180	120	115	150	90	14	16	20	9.5
3, 5t (29.42kN, 49.03 kN)	200	130	132	160	90	18	20	25	14.0
10t (98.07 kN)	230	150	160	186	106	22	24	30	21

SPECIFICATIONS

MODEL	BMH11	BMH21, BMH22
Rated capacity (R.C.)	1, 2, 3, 5, 10t	
Rated output(R.O.)	3.0 ± 0.005 mV/V	
Non-linearity	≤0.03% R.O.	
Hysteresis	≤0.03% R.O.	
Non-repeatability	≤0.02% R.O.	
Creep error	≤0.03% in 20min.	
Zero balance	≤1% R.O.	
Compensated temperature range	-10 ~ 70°C	
Operating temperature range	-20 ~ 80°C	
Temp. effect on rated output	≤0.02% LOAD/10°C	
Temp. effect on zero balance	≤0.02% R.O./10°C	
Terminal input resistance	350 ± 3.5 Ohms	
Terminal output resistance	350 ± 3.5 Ohms	
Insulation resistance (Min.)	2000 MOhms at 50V DC	
Excitation voltage	10V(Recommended), 15V(Max.)	
Electrical connection	ø7mmx6m(22AWG x 4Core Shielded)	
Protection class	IP 67	IP 68
Safe overload	150% R.C	
Ultimate overload	300% R.C	
Load cell model	DSCH	DSCHS
Load cell material	Alloy steel	Stainless steel

ORDERING INFORMATION

BMH11 - 2T

MODEL CAPACITY : 1, 2, 3, 5, 10 ton

BMH11: DSCH Load Cell + Zinc Plated Steel Mtg Kit

BMH21: DSCHS Stainless Steel Load Cell + Zinc Plated Steel Mtg Kit

BMH22: DSCHS Stainless Steel Load Cell + Stainless Steel Mtg Kit

WIRING INFORMATION

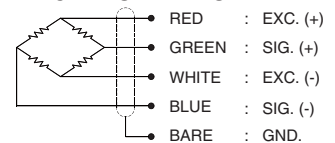

* Specifications are subject to change without notice

APR, 2018