



STEEL CABLE CHAIN

Usage

Applied for various types of machinery and facilities such as Iron, steel manufacture, machining center, conveying machinery, automatic production facilities, industrial plant, cold rolling, rolling facilities.

- Type : SK70
- P : Pitch (70mm)
- Ls : Stroke
- KR : Bending radius
- UB : Loop projection
- LB : Loop length
- Ha : Safe space

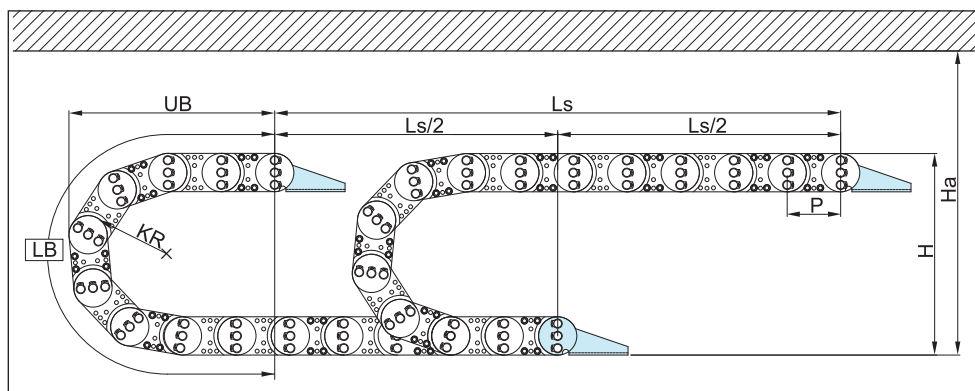

(Dimensions in mm)

Bending radius	KR	75	90	125	145	200
Safe space	H	200	230	300	340	450
Moving height	Ha	210	240	310	350	460
Loop length	LB	515	560	670	735	910

Calculation of the chain length : travel distance 1/2 + Loop length

Material : S400, S45C, SUS304

Aluminum bar type

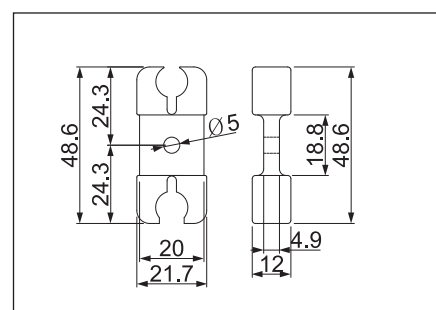
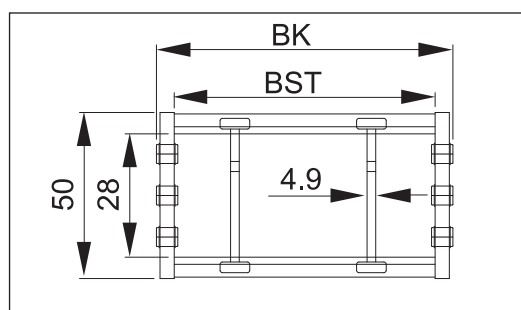
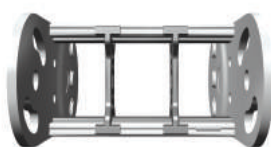

Standard type

Inner width of cable chain BK	100	125	150	175	200	250	300	350
Number of dividers	2	2	3	3	4	5	6	7
BST	86	111	136	161	186	236	286	336

Hole type

- Rounded type
- Slotted type
- Square type
- Customized type

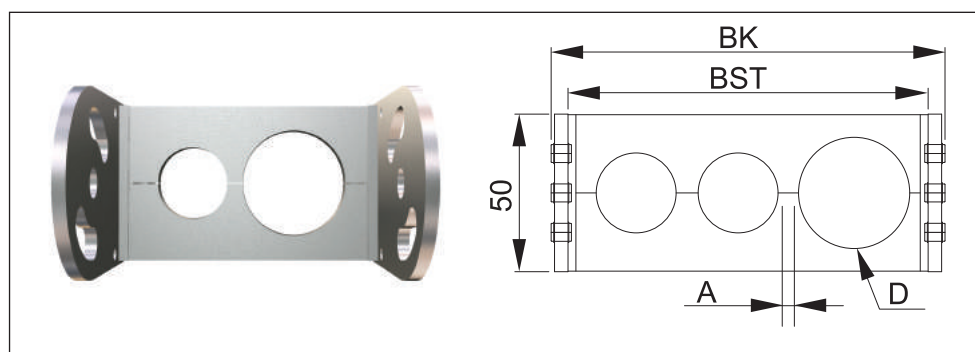

Dmax X 38mm

dmax X 35mm

Amin 5mm

BSTmax X 350mm

STEEL CABLE CHAIN

SK 70



► Feature

- It is durable and ensures long life span as composed of steel cable chain and aluminum stay.
- Small sized 'Link Plate' is safely designed.
- As holes of stay are machined by customized type, it strengthens supporting power of cable holes.
- It is standardized cable chain which can be applied for all kinds of machinery such as conveying machinery, machining center and steel facilities.

Chain coupling

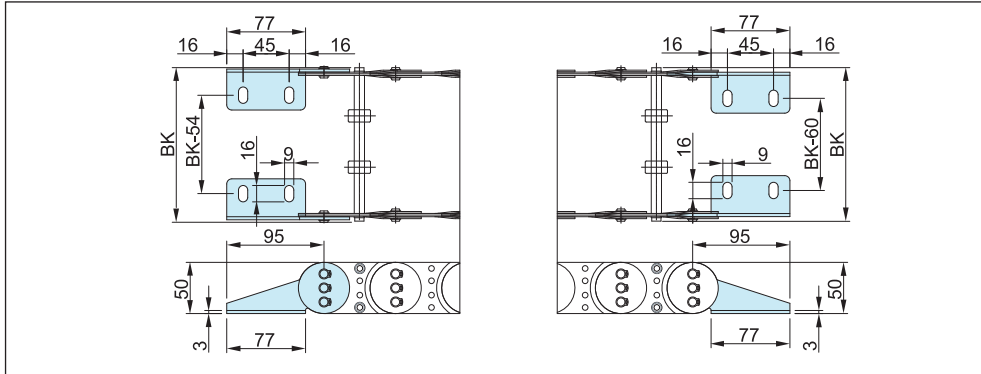

Cable chain guide channel

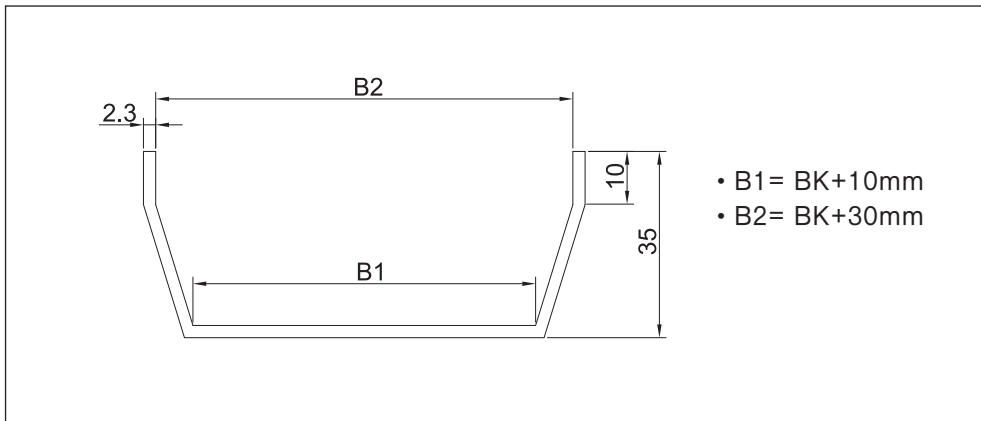

Load diagrams self-supporting length

Customers can select right model of cable chain by considering Load diagrams self-supporting length.

Weight per 1 meter (Kg/m)

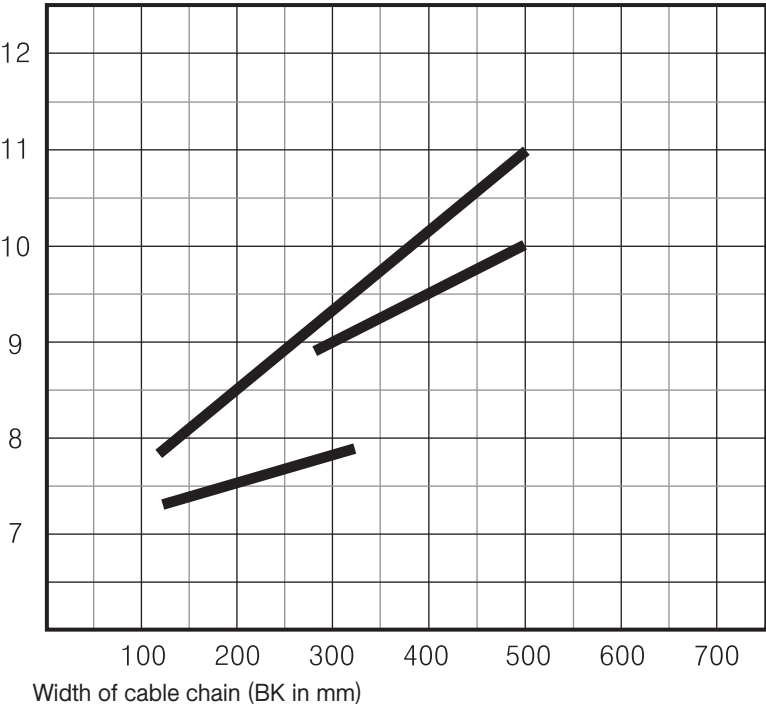



SK 95

STEEL CABLE CHAIN

Usage

Applied for various types of machinery and facilities such as Iron, steel manufacture, machining center, conveying machinery, automatic production facilities, industrial plant, cold rolling, rolling facilities.

- Type : SK95
- P : Pitch (95mm)
- Ls : Stroke
- KR : Bending radius
- UB : Loop projection
- LB : Loop length
- Ha : Safe space

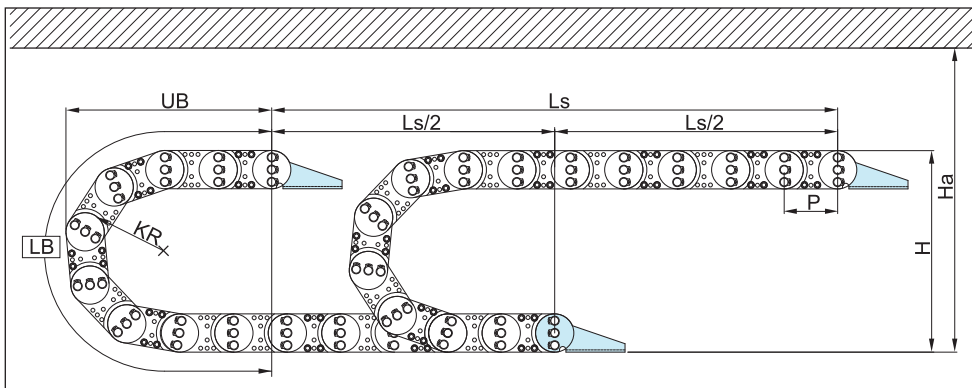

(Dimensions in mm)

Bending radius	KR	125	145	200	250	300
Safe space	H	318	358	468	568	668
Moving height	Ha	330	370	480	580	680
Loop length	LB	770	835	1000	1165	1320

Calculation of the chain length : travel distance 1/2 + Loop length

Material : S400, S45C, SUS304

Solid type

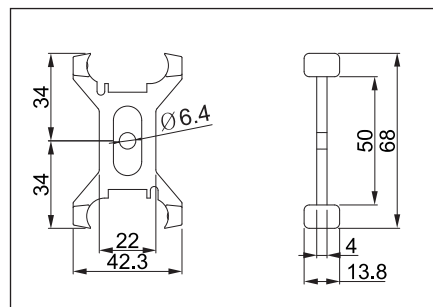
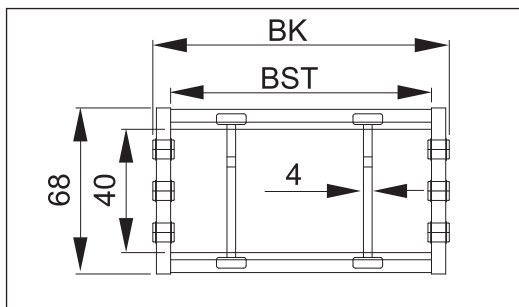

Standard type

Inner width of cable chain BK	100	125	150	175	200	250	300	350	400	450	500	550	600
Number of dividers	1	1	2	3	4	5	6	7	8	9	10	11	12
BST	82	107	132	157	182	232	282	332	382	432	482	532	582

Hole type

- Rounded type
- Slotted type
- Square type
- Customized type

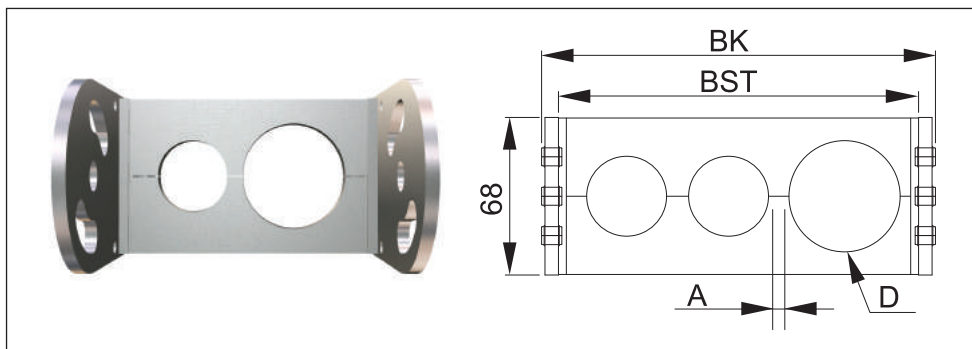

Dmax X 48mm

dmax X 44mm

Amin 5mm

BSTmax X 582mm

STEEL CABLE CHAIN

SK 95



► Feature

- It is durable and ensures long life span as composed of steel cable chain and aluminum stay.
- Small sized 'Link Plate' is safely designed.
- As holes of stay are machined by customized type, it strengthens supporting power of cable holes.
- It is standardized cable chain which can be applied for all kinds of machinery such as conveying machinery, machining center and steel facilities.

Chain coupling

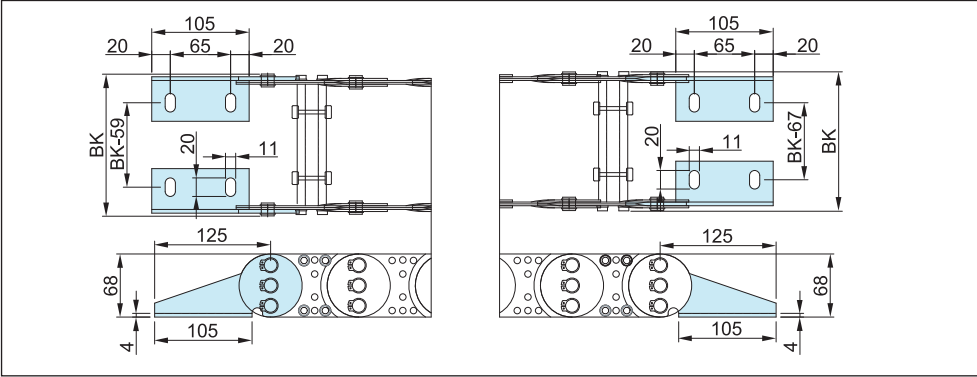

Cable chain guide channel

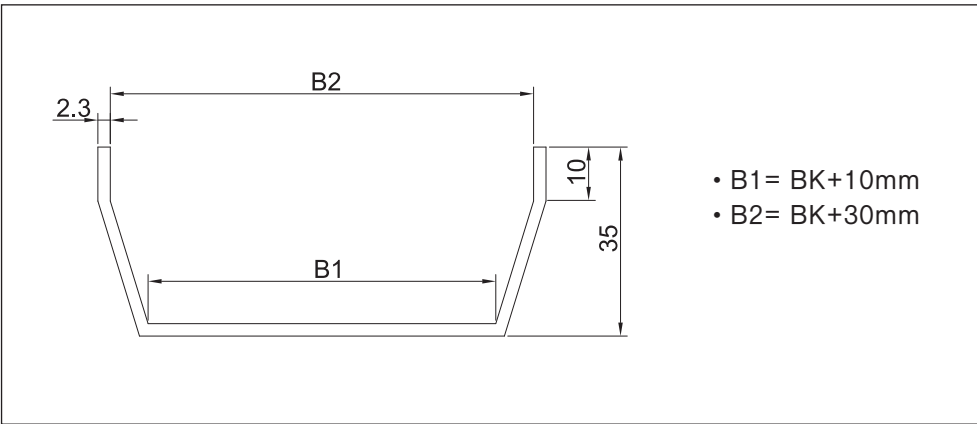

Customers can select right model of cable chain by considering Load diagrams self-supporting length.

Weight per 1 meter (Kg/m)

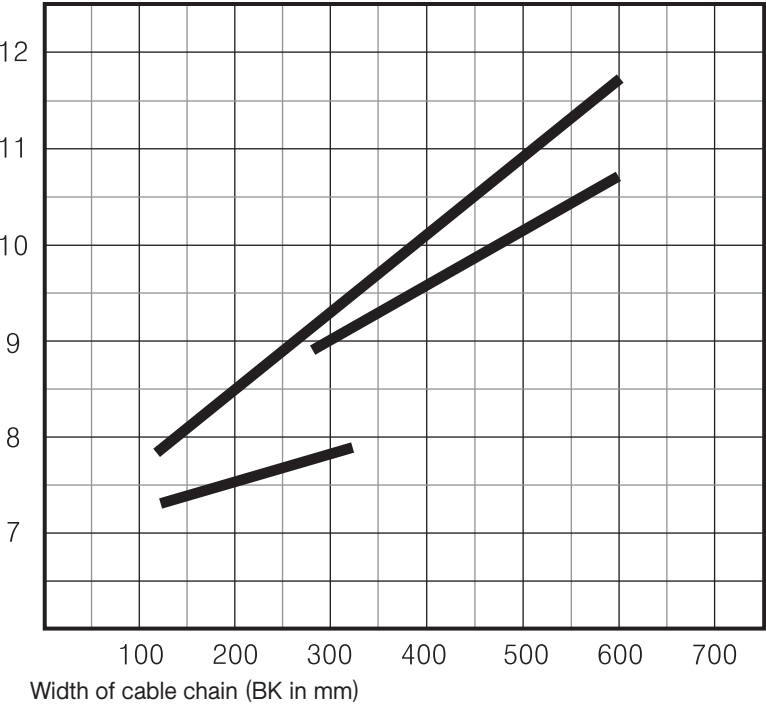



SK130

STEEL CABLE CHAIN

Usage

Applied for various types of machinery and facilities such as Iron, steel manufacture, machining center, conveying machinery, automatic production facilities, industrial plant, cold rolling, rolling facilities.

- Type : SK130
- P : Pitch (130mm)
- Ls : Stroke
- KR : Bending radius
- UB : Loop projection
- LB : Loop length
- Ha : Safe space

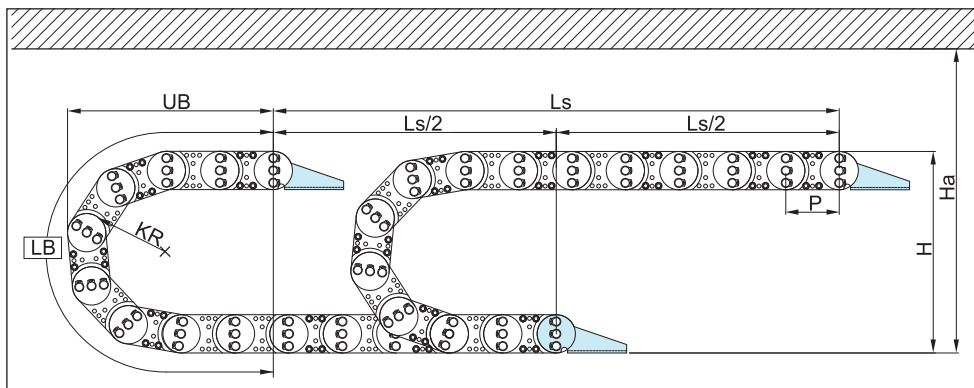

(Dimensions in mm)

Bending radius	KR	150	200	250	300	340	400
Safe space	H	394	494	594	694	774	894
Moving height	Ha	410	510	610	710	790	910
Loop length	LB	990	1140	1300	1460	1580	1770

Calculation of the chain length : travel distance 1/2 + Loop length

Material : S400, S45C, SUS304

< Cover type >



Solid type

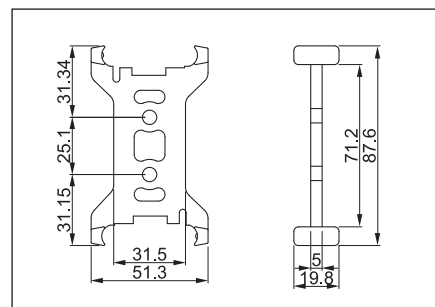
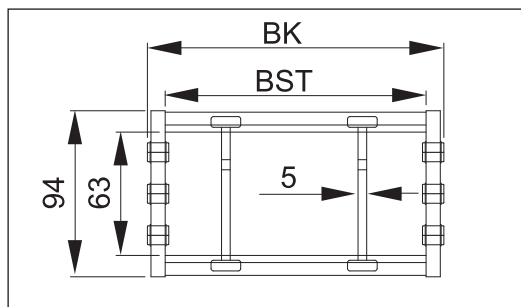
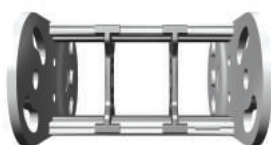

Standard type

Inner width of cable chain BK	200	250	300	350	400	450	500	550	600	650	700	750	800
Number of dividers	3	4	5	5	6	6	7	8	9	10	11	12	12
BST	176	226	276	326	376	426	476	526	576	626	676	726	776

Hole type

- Rounded type
- Slotted type
- Square type
- Customized type

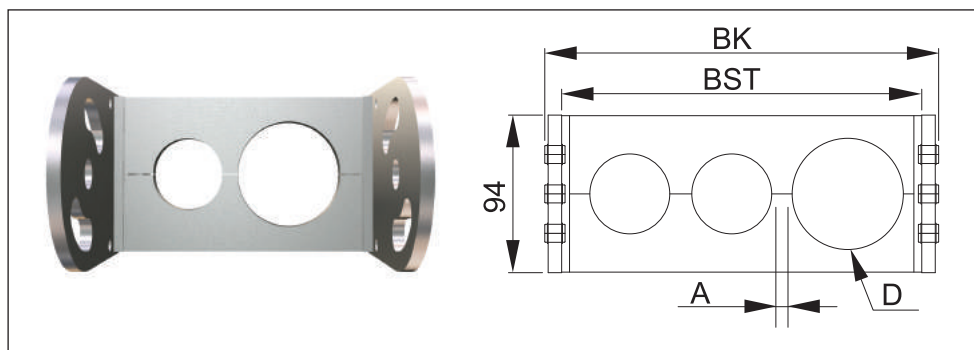

Dmax X 74mm

dmax X 70mm

Amin 5mm

BSTmax X 800mm

STEEL CABLE CHAIN

SK130



► Feature

- It is durable and ensures long life span as composed of steel cable chain and aluminum stay.
- Small sized 'Link Plate' is safely designed.
- As holes of stay are machined by customized type, it strengthens supporting power of cable holes.
- It is standardized cable chain which can be applied for all kinds of machinery such as conveying machinery, machining center and steel facilities.

Chain coupling

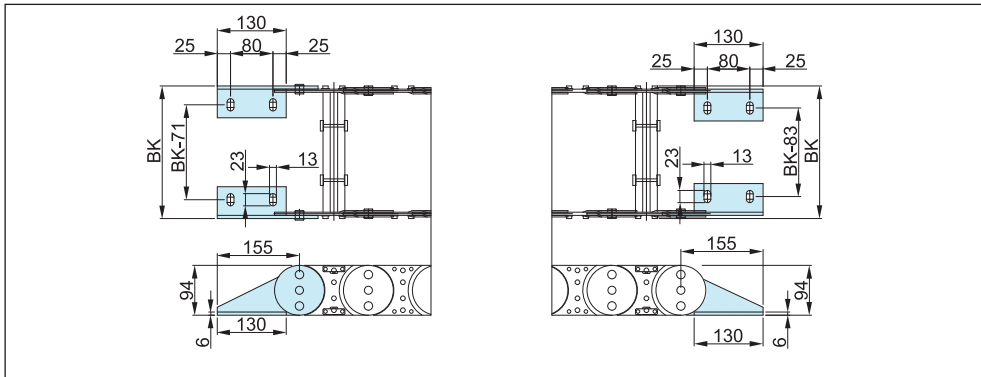

Cable chain guide channel

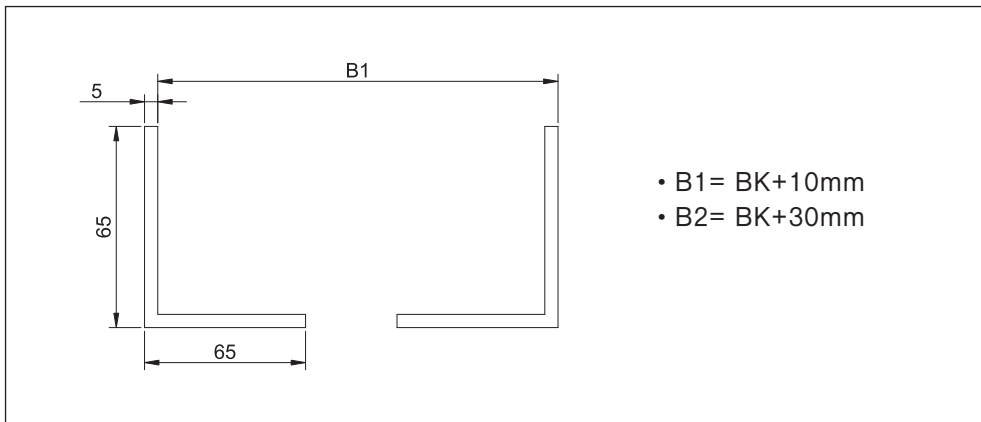

Load diagrams self-supporting length

Customers can select right model of cable chain by considering Load diagrams self-supporting length.

Weight per 1 meter (Kg/m)

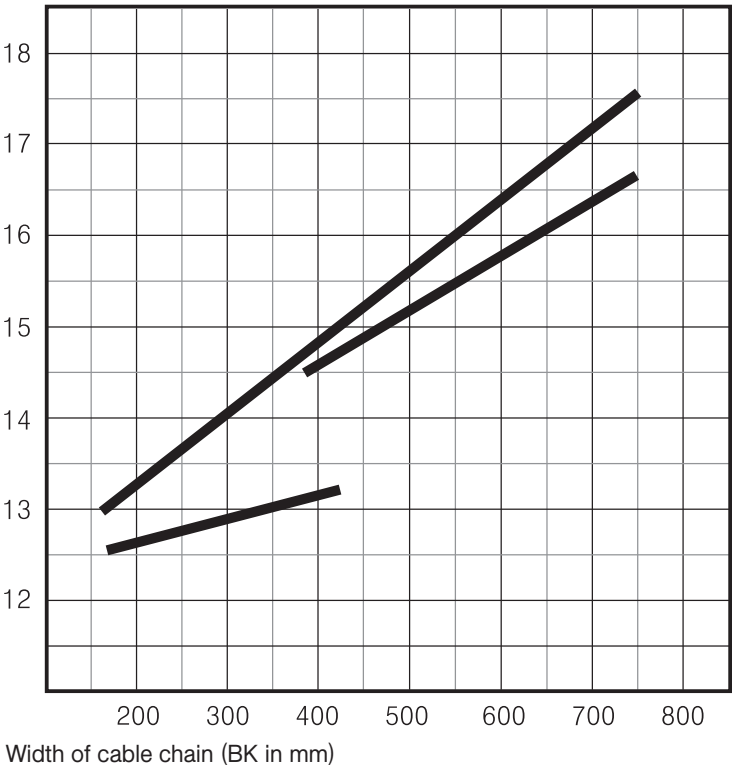

SK180 STEEL CABLE CHAIN



Usage

Applied for various types of machinery and facilities such as Iron, steel manufacture, machining center, conveying machinery, automatic production facilities, industrial plant, cold rolling, rolling facilities.

- Type : SK180
- P : Pitch (180mm)
- Ls : Stroke
- KR : Bending radius
- UB : Loop projection
- LB : Loop length
- Ha : Safe space

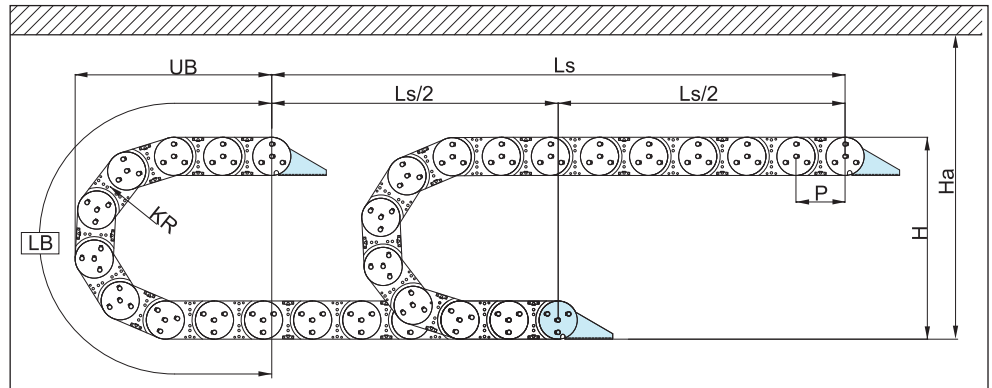

(Dimensions in mm)

Bending radius	KR	250	300	400	500	600	700
Safe space	H	640	740	940	1140	1340	1540
Moving height	Ha	650	750	950	1150	1350	1550
Loop length	LB	1500	1660	1980	2290	2600	2920

Calculation of the chain length : travel distance 1/2 + Loop length

Material : S400, S45C, SUS304

Solid type

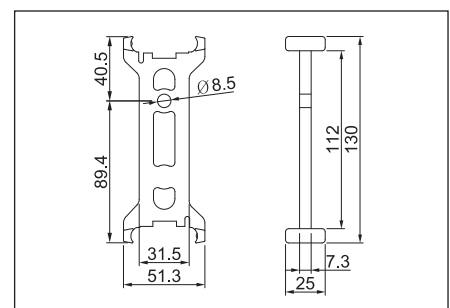
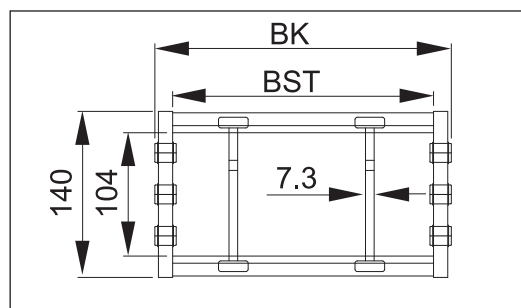
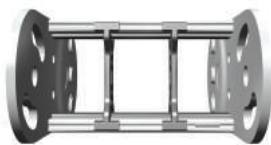

Standard type

Inner width of cable chain BK	200	250	300	350	400	450	500	600	700	800	900	1000	1100
Number of dividers	2	3	4	5	6	7	8	9	10	11	12	13	14
BST	171	221	271	321	371	421	471	571	671	771	871	971	1071

Hole type

- Rounded type
- Slotted type
- Square type
- Customized type

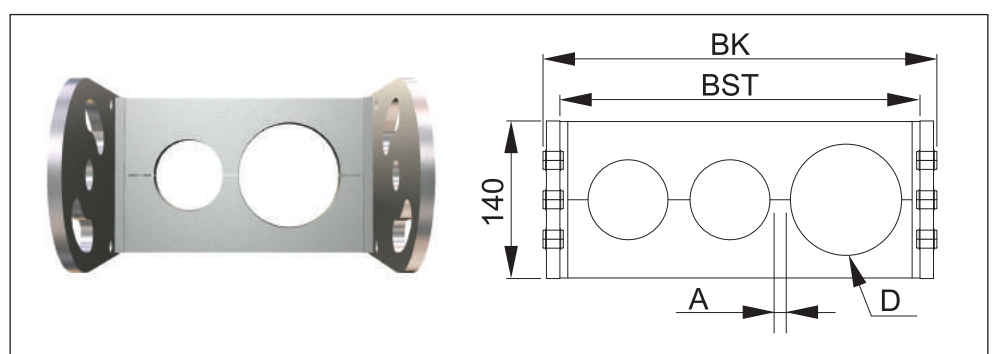

Dmax X 110mm

dmax X 100mm

Amin 6mm

BSTmax X 1071mm

STEEL CABLE CHAIN

SK180



► Feature

- It is durable and ensures long life span as composed of steel cable chain and aluminum stay.
- Small sized 'Link Plate' is safely designed.
- As holes of stay are machined by customized type, it strengthens supporting power of cable holes.
- It is standardized cable chain which can be applied for all kinds of machinery such as conveying machinery, machining center and steel facilities.

Chain coupling

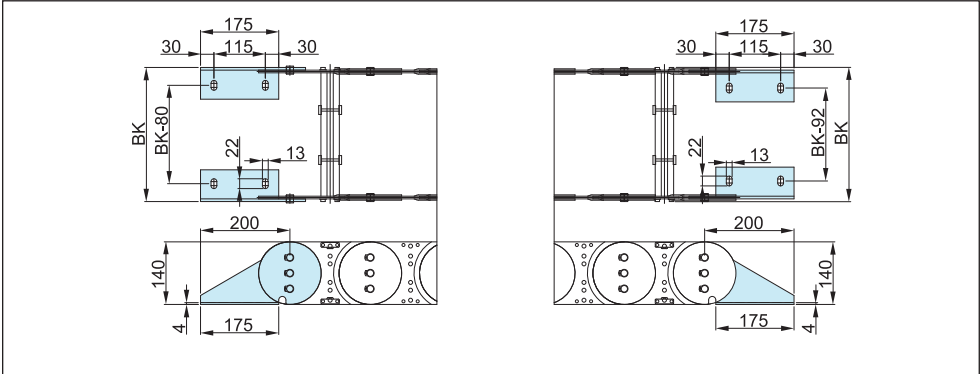

Cable chain guide channel

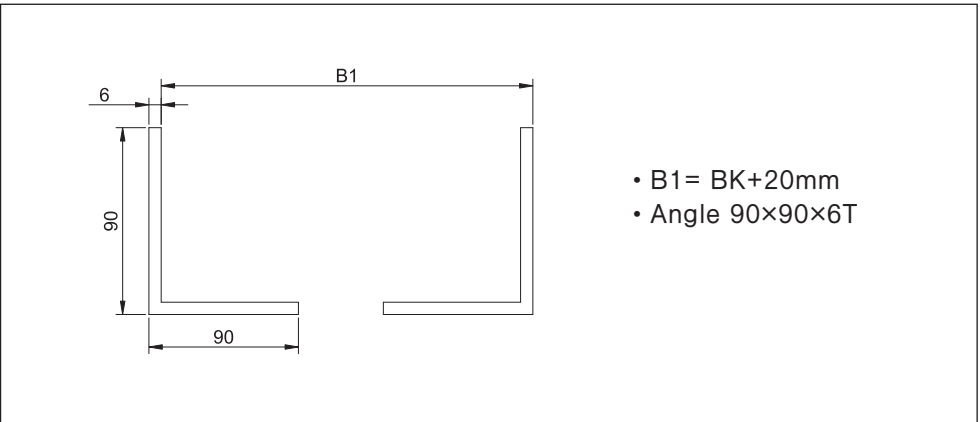

Load diagrams self-supporting length

Customers can select right model of cable chain by considering Load diagrams self-supporting length.

Weight per 1 meter (Kg/m)

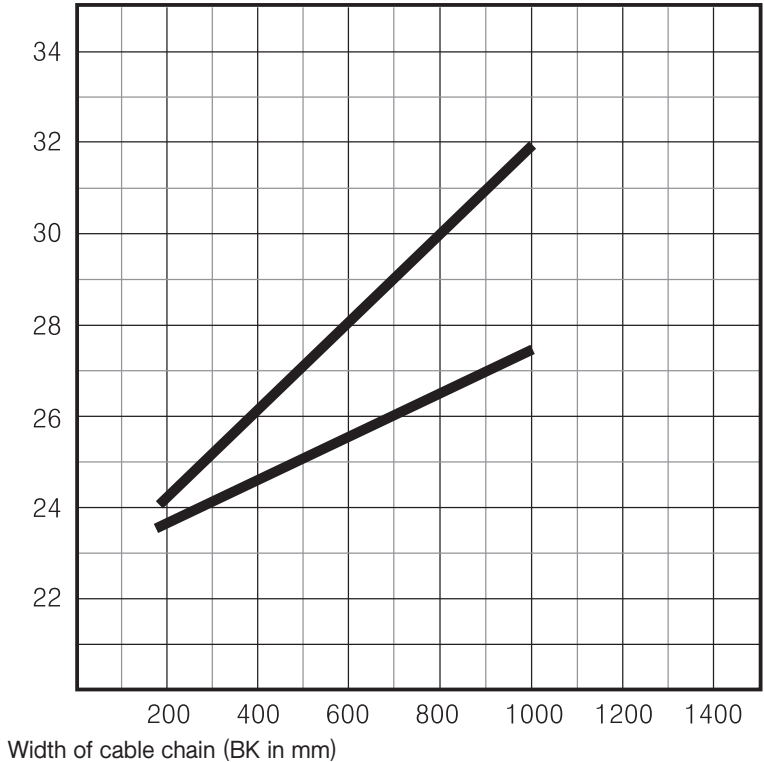

SK250 STEEL CABLE CHAIN



Usage

Applied for various types of machinery and facilities such as Iron, steel manufacture, machining center, conveying machinery, automatic production facilities, industrial plant, cold rolling, rolling facilities.

- Type : SK250
- P : Pitch (250mm)
- Ls : Stroke
- KR : Bending radius
- UB : Loop projection
- LB : Loop length
- Ha : Safe space

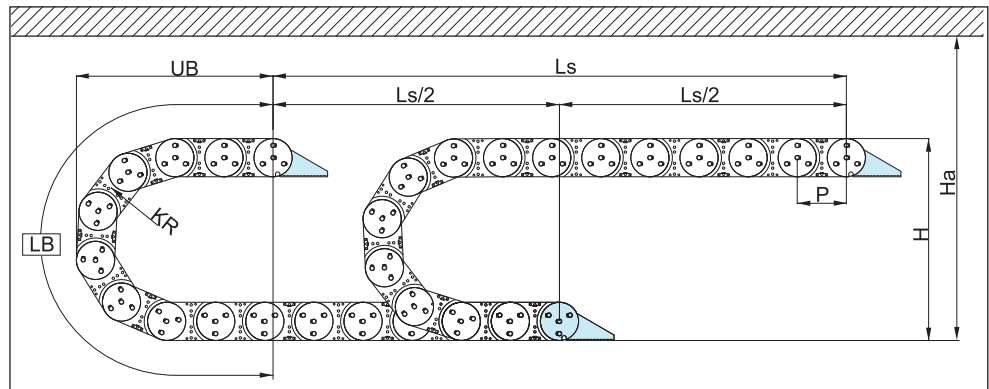

(Dimensions in mm)

Bending radius	KR	350	400	450	600	750
Safe space	H	920	1020	1120	1420	1720
Moving height	Ha	950	1050	1150	1450	1750
Loop length	LB	2100	2255	2410	2880	3350

Calculation of the chain length : travel distance 1/2 + Loop length

Material : S400, S45C, SUS304

Hole type

- Rounded type
- Slotted type
- Square type
- Customized type

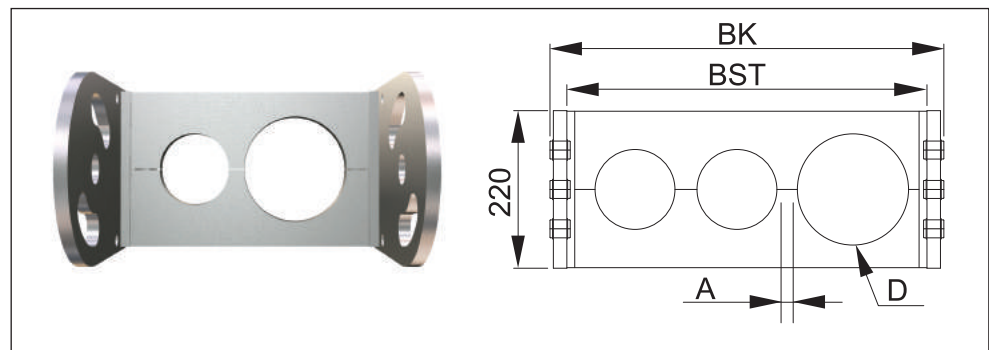

Dmax X 180mm

dmax X 165mm

Amin 6mm

BSTmax X 1200mm

Chain coupling

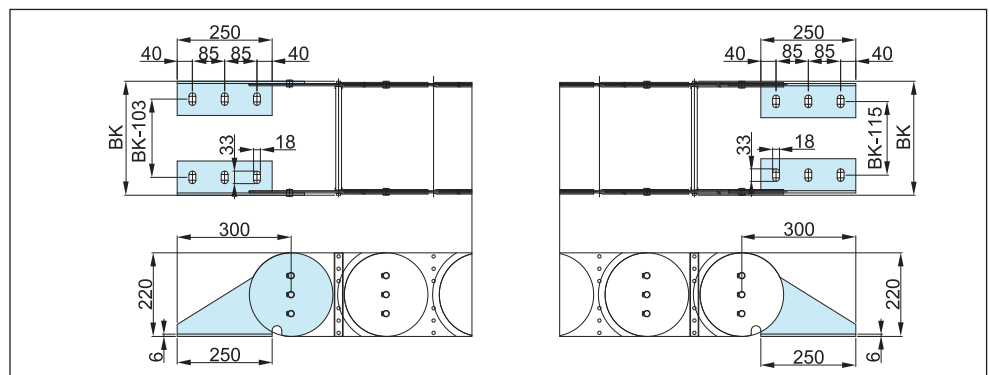

STEEL CABLE CHAIN

SK250



► Feature

- It is durable and ensures long life span as composed of steel cable chain and aluminum stay.
- Small sized 'Link Plate' is safely designed.
- As holes of stay are machined by customized type, it strengthens supporting power of cable holes.
- It is standardized cable chain which can be applied for all kinds of machinery such as conveying machinery, machining center and steel facilities.

Cable chain guide channel

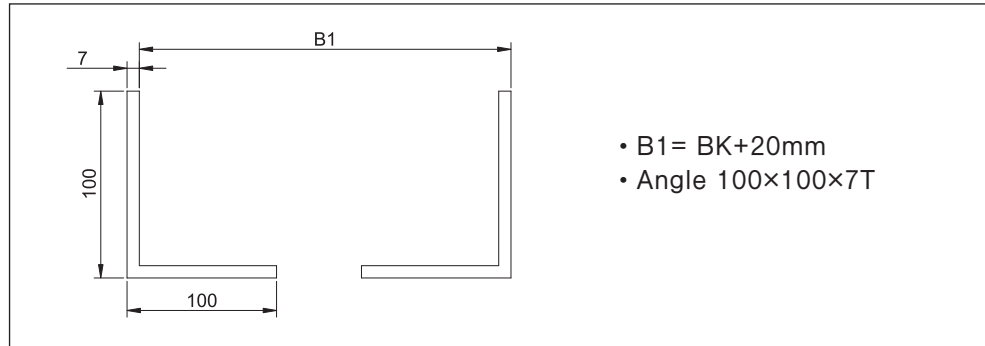

Load diagrams self-supporting length

Customers can select right model of cable chain by considering Load diagrams self-supporting length.

Weight per 1 meter (Kg/m)

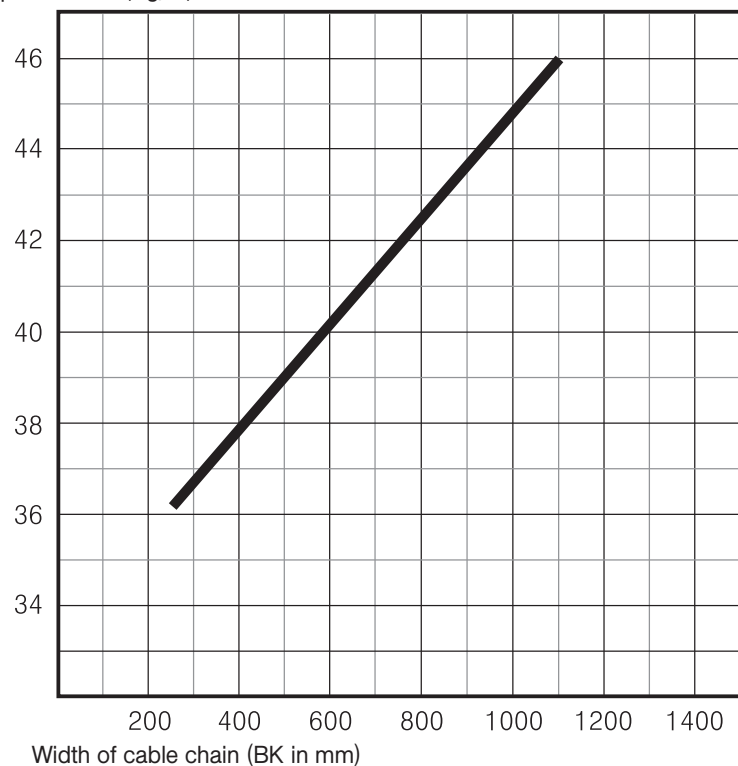

Application example of cable chain

