

## DIN 69893

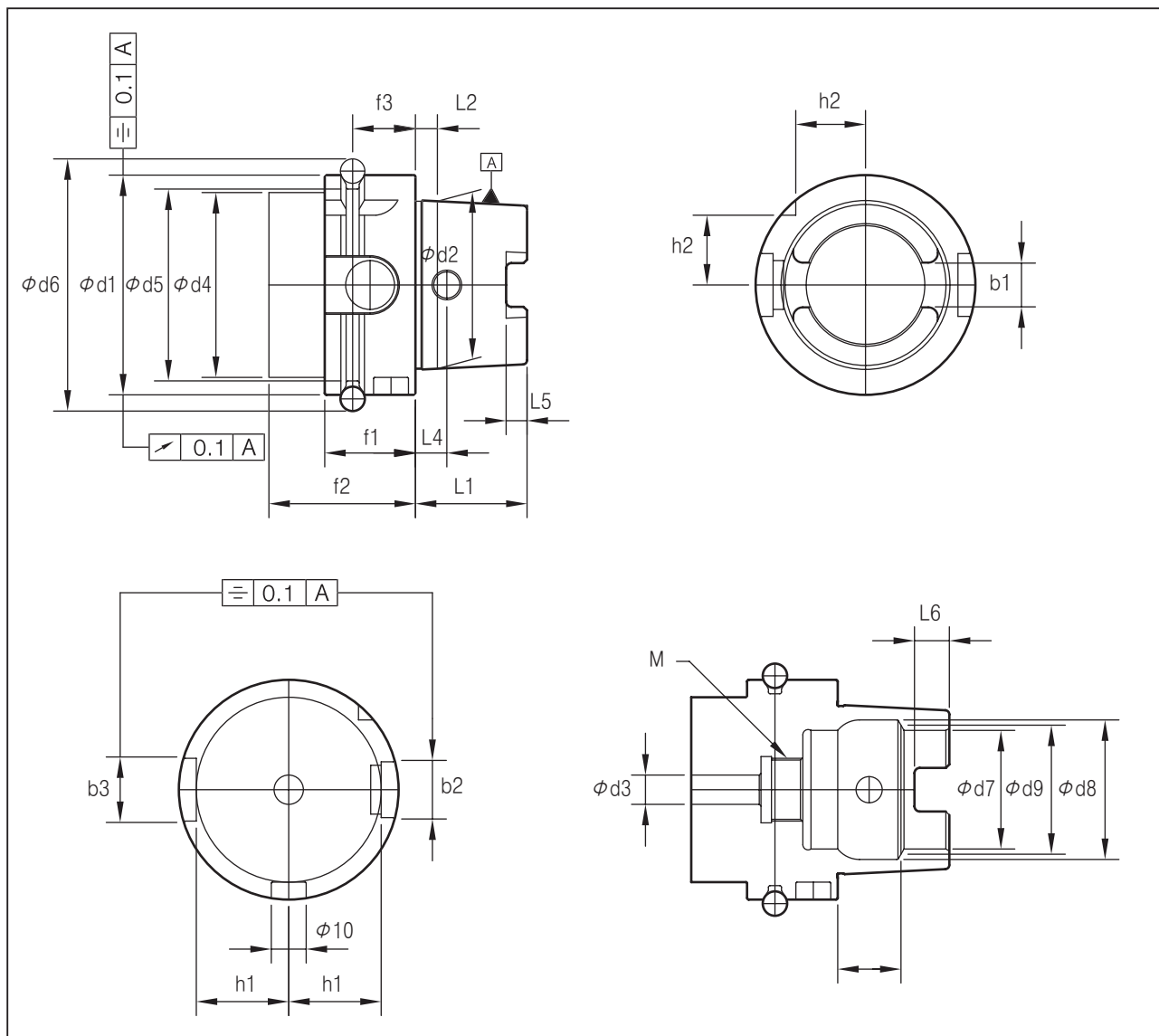

(mm)

Taper No.	$\phi d_1$	$\phi d_2$	$\phi d_3$	$\phi d_4$	$\phi d_5$	$\phi d_6$	$\phi d_7$	$\phi d_8$	$\phi d_9$	h1	h2	M
<b>HSK50</b>	50	38.009	6.8	42	43	59.3	26	32	29	21	15.5	M16×1.0
<b>HSK63</b>	63	48.010	8.4	53	55	72.3	34	40	37	26.5	20	M18×1.0
<b>HSK100</b>	100	75.013	12	88	92	109.75	53	53	58	44	31.5	M24×1.5

Taper No.	b1	b2	b3	L1	L2	L3	L4	L5	L6	f1	f2	f3
<b>HSK50</b>	10.54	12	14	25	5	14.13	7.5	4.5	7.5	26	42	18
<b>HSK63</b>	12.54	16	18	32	6.3	18.13	9	6	10	26	42	18
<b>HSK100</b>	20.02	20	22	50	10	28.56	15	10	15	29	45	20

# MILLING CHUCK



## Ordering Example

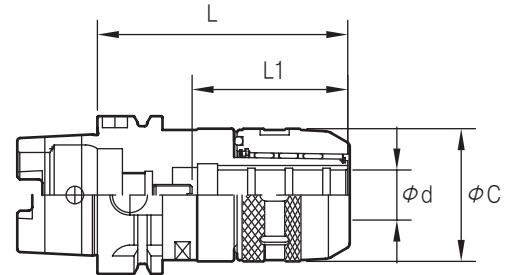
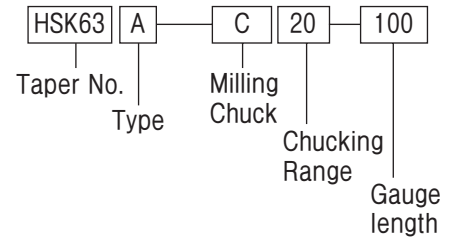

Taper No.	Code No.	$\phi d$	L	$\phi C$	L1		Collet	Weight (kg)	Stock
					Min	Max			
HSK63	HSK 63A -C20-100	20	100	53	45	70	MC20		<input type="checkbox"/>
	HSK 63A -C32-105	32	105	74	60	95	MC32		<input type="checkbox"/>
HSK100	HSK100A-C20-105	20	105	53	45	70	MC20		<input type="checkbox"/>
	HSK100A-C20-135	32	135	74	60	95	MC32		<input type="checkbox"/>
	HSK100A-C42-140	42	140	92	60	98	MC42		<input type="checkbox"/>

\*. Adjustable screw 와 spanners 별도 판매 합니다.  
 \*. Special size도 주문 제작 합니다.

# NC DRILL CHUCK

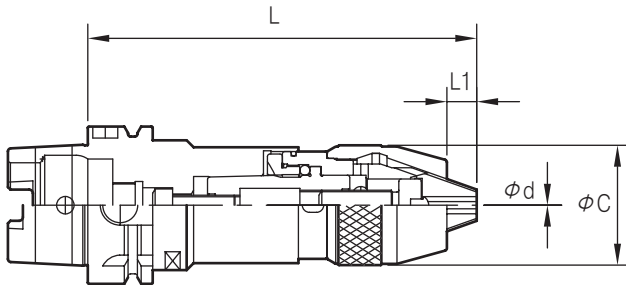

## Ordering Example

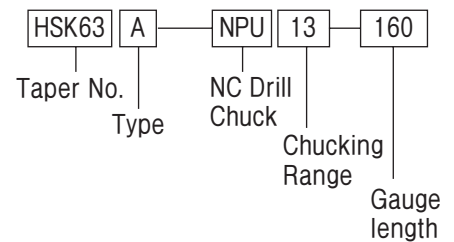

Taper No.	Code No.	$\phi d$	L	$\phi C$	L1	Weight (kg)	Stock
HSK63	HSK 63A-NPU8 -135	0.3~8.0	130	38	8.5		<input type="checkbox"/>
	HSK 63A-NPU13-150	1.0~13.0	160	50	11.5		<input type="checkbox"/>
HSK100	HSK100A-NPU8 -135	0.3~8.0	95	38	8.5		<input type="checkbox"/>
	HSK100A-NPU13-135	1.0~13.0	185	50	11.5		<input type="checkbox"/>

# SX COLLET CHUCK



## Ordering Example

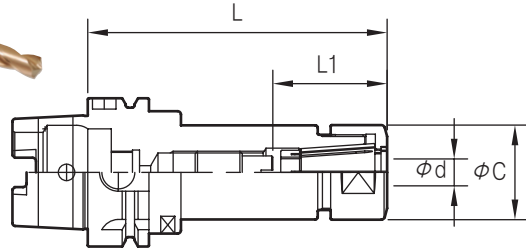
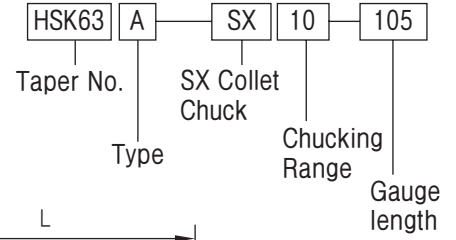

Taper No.	Code No.	$\phi d$	L	$\phi C$	L1		Collet	Weight (kg)	Stock
					Min	Max			
HSK63	HSK 63A -SX 6 -100	0.7~6.0	100	19.5	21	35	SX6		<input type="checkbox"/>
	HSK 63A -SX10-105	1.75~10.0	105	27.5	30	50	SX10		<input type="checkbox"/>
	HSK 63A -SX16-120	2.75~16.0	120	40	45	60	SX16		<input type="checkbox"/>
	HSK 63A -SX25-145	16.0~25.0	145	55	55	75	SX25		<input type="checkbox"/>
HSK100	HSK100A -SX 6 -120	0.7~6.0	120	19.5	21	35	SX6		<input type="checkbox"/>
	HSK100A -SX10-125	1.75~10.0	125	27.5	30	50	SX10		<input type="checkbox"/>
	HSK100A -SX16-140	2.75~16.0	140	40	45	60	SX16		<input type="checkbox"/>
	HSK100A -SX25-155	16.0~25.4	155	55	55	75	SX25		<input type="checkbox"/>

# MORES TAPER HOLDER



## Ordering Example

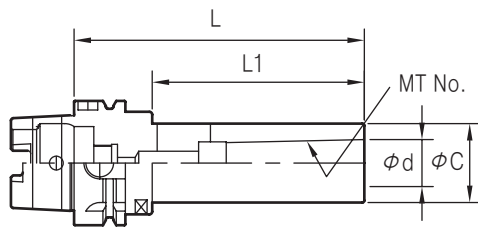
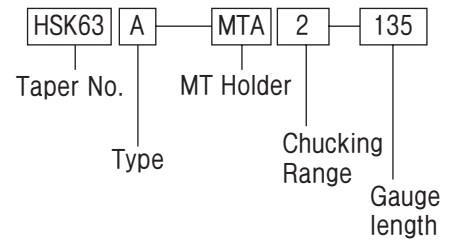

Taper No.	Code No.	$\phi d$	MT No	L	$\phi C$	L1	Weight (kg)	Stock
HSK 63A -MTA2-135	17.780	2	135	32	93		<input type="checkbox"/>	
HSK 63A -MTA3-150	23.825	3	150	40	108		<input type="checkbox"/>	
HSK 63A -MTA4-165	31.267	4	165	50	123		<input type="checkbox"/>	
HSK100	HSK100A -MTA1-120	12.065	1	120	25	75		<input type="checkbox"/>
	HSK100A -MTA2-135	17.780	2	135	32	90		<input type="checkbox"/>
	HSK100A -MTA3-155	23.825	3	155	40	110		<input type="checkbox"/>
	HSK100A -MTA4-180	31.267	4	180	50	135		<input type="checkbox"/>
	HSK100A -MTA5-220	44.399	5	220	65	175		<input type="checkbox"/>

# ER COLLET CHUCK



## Ordering Example

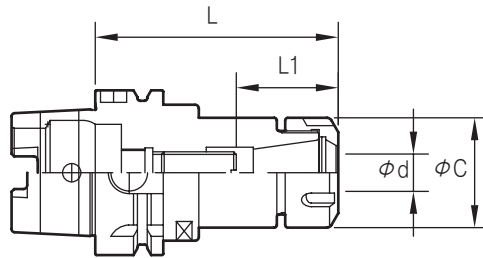
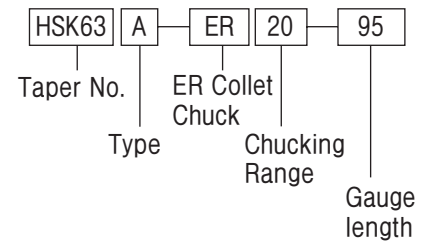

Taper No.	Code No.	$\phi d$	L	$\phi C$	L1		Collet	Weight (kg)	Stock
					Min	Max			
HSK63	HSK63A -ER11- 75	0.5~7.0	75	19	19	34	ER11		<input type="checkbox"/>
	HSK63A -ER16- 95	0.5~10.0	95	32	23	43	ER16		<input type="checkbox"/>
	HSK63A -ER20- 95	0.5~13.0	95	35	25	48	ER20		<input type="checkbox"/>
	HSK63A -ER25- 95	0.5~16.0	95	42	34	54	ER25		<input type="checkbox"/>
	HSK63A -ER32-110	1.0~20.0	110	50	40	60	ER32		<input type="checkbox"/>
HSK100	HSK100A-ER11- 85	0.5~7.0	85	19	19	34	ER11		<input type="checkbox"/>
	HSK100A-ER16- 95	0.5~10.0	95	32	23	43	ER16		<input type="checkbox"/>
	HSK100A-ER20-105	0.5~13.0	105	35	25	48	ER20		<input type="checkbox"/>
	HSK100A-ER25-110	0.5~16.0	110	42	34	54	ER25		<input type="checkbox"/>
	HSK100A-ER32-120	1.0~20.0	120	50	40	60	ER32		<input type="checkbox"/>
	HSK100A-ER40-130	2.0~26.0	130	63	50	80	ER40		<input type="checkbox"/>

# MX COLLET CHUCK



## Ordering Example

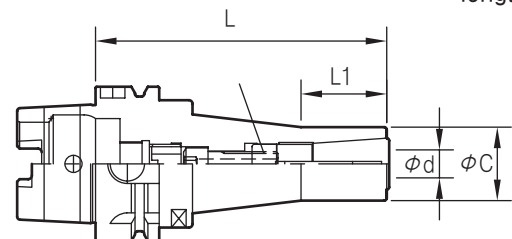
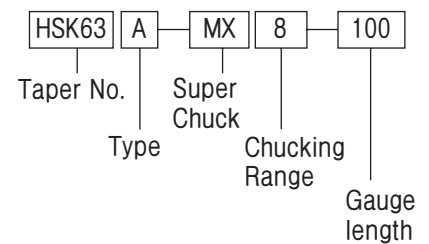

Taper No.	Code No.	$\phi d$	L	$\phi C$	L1	M	Weight (kg)	Stock
	HSK 63A-MX12-110	3.0~12.0	110	30	35	M10		<input type="checkbox"/>
HSK100	HSK100A-MX 8-115	3.0~10.0	115	22	36	M8		<input type="checkbox"/>
	HSK100A-MX12-120	3.0~12.0	120	30	35	M10		<input type="checkbox"/>

# SLIM COLLET CHUCK



## Ordering Example

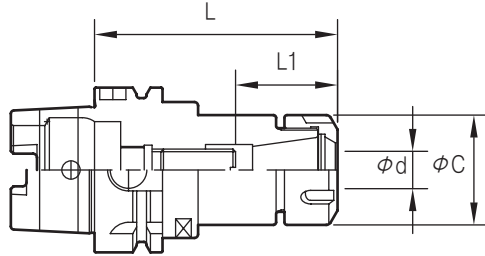
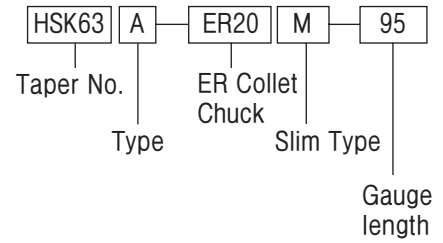

Taper No.	Code No.	$\phi d$	L	$\phi C$	L1		Collet	Weight (kg)	Stock
					Min	Max			
HSK63	HSK 63A -ER11M- 75	1.0~7.0	75	16	20	35	ER11		<input type="checkbox"/>
	HSK 63A -ER16M- 85	1.0~10.0	85	22	30	45	ER16		<input type="checkbox"/>
	HSK 63A -ER20M- 95	1.0~13.0	95	28	35	50	ER20		<input type="checkbox"/>
	HSK 63A -ER25M-105	1.0~16.0	105	35	40	55	ER25		<input type="checkbox"/>
HSK100	HSK100A-ER11M- 85	1.0~7.0	85	16	20	35	ER11		<input type="checkbox"/>
	HSK100A-ER16M- 95	1.0~10.0	95	22	30	45	ER16		<input type="checkbox"/>
	HSK100A-ER20M-105	1.0~13.0	105	28	35	50	ER20		<input type="checkbox"/>
	HSK100A-ER25M-120	1.0~16.0	120	35	40	55	ER25		<input type="checkbox"/>

# SYNCHRO TAPPING CHUCK



## Ordering Example

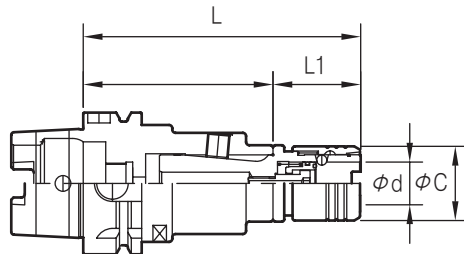
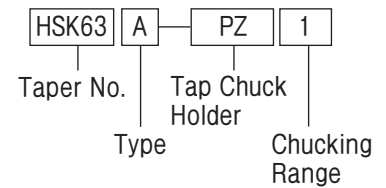

Taper No.	Code No.	$\phi d$	L	$\phi C$	L1	L2	Weight (kg)	Stock
HSK 63A -PZ2	31	135	50	80	55		<input type="checkbox"/>	
HSK100	HSK100A-PZ1	19	135	33	96	39		<input type="checkbox"/>
	HSK100A-PZ2	31	150	50	95	55		<input type="checkbox"/>

# SIDE LOCK HOLDER



## Ordering Example

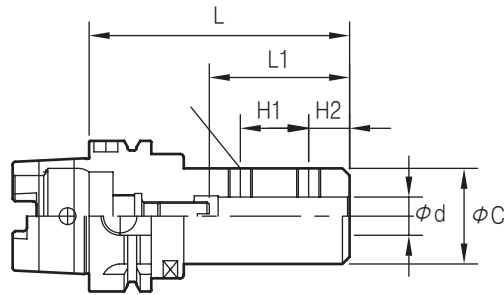
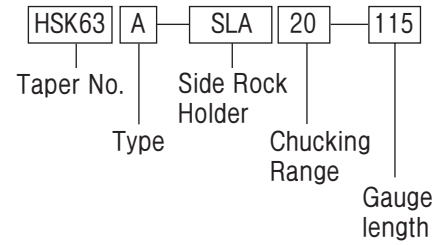

Taper No.	Code No.	$\phi d$	L	$\phi C$	L1		H1	H2	M	Weight (kg)	Stock
					Min	Max					
HSK63	HSK 63A -SLA 6 - 75	6	75	25	20	35	18	-	M5		<input type="checkbox"/>
	HSK 63A -SLA 8 - 80	8	80	28	25	40	187	-	M6		<input type="checkbox"/>
	HSK 63A -SLA 10- 90	10	90	35	35	50	14	13	M8		<input type="checkbox"/>
	HSK 63A -SLA 12- 90	12	90	40	35	50	14	16	M10		<input type="checkbox"/>
	HSK 63A -SLA 14-105	14	105	42	50	65	20	20	M12		<input type="checkbox"/>
	HSK 63A -SLA 16-105	16	105	44	50	65	20	20	M12		<input type="checkbox"/>
	HSK 63A -SLA 20-115	20	115	50	55	70	25	20	M14		<input type="checkbox"/>
	HSK 63A -SLA 25-115	25	115	50	55	70	25	20	M14		<input type="checkbox"/>
	HSK 63A -SLA 32-120	32	120	60	65	80	25	25	M16		<input type="checkbox"/>
	HSK 63A -SLA 40-120	40	120	63	65	80	25	25	M16		<input type="checkbox"/>
	HSK 63A -SLA 42-120	42	120	63	65	80	25	25	M16		<input type="checkbox"/>
HSK100	HSK 100A-SLA 6 - 80	6	80	25	20	35	18	-	M5		<input type="checkbox"/>
	HSK 100A-SLA 8 - 85	8	85	28	25	40	18	-	M6		<input type="checkbox"/>
	HSK 100A-SLA10- 95	10	95	35	35	50	14	13	M8		<input type="checkbox"/>
	HSK 100A-SLA12- 95	12	95	40	35	50	14	16	M10		<input type="checkbox"/>
	HSK 100A-SLA14-110	14	110	42	50	65	20	20	M12		<input type="checkbox"/>
	HSK 100A-SLA16-110	16	110	44	50	65	20	20	M12		<input type="checkbox"/>
	HSK 100A-SLA20-120	20	120	50	60	75	25	20	M14		<input type="checkbox"/>
	HSK 100A-SLA25-120	25	120	50	60	75	25	20	M14		<input type="checkbox"/>
	HSK 100A-SLA32-125	32	125	60	65	80	25	25	M16		<input type="checkbox"/>
	HSK 100A-SLA40-135	40	135	75	65	80	25	25	M16		<input type="checkbox"/>
	HSK 100A-SLA42-135	42	135	75	65	80	25	25	M16		<input type="checkbox"/>

\*. Drill, endmill, 기타 (small chuck, special tool)등을 사용할 수 있습니다.

# FACE MILL ARBOR

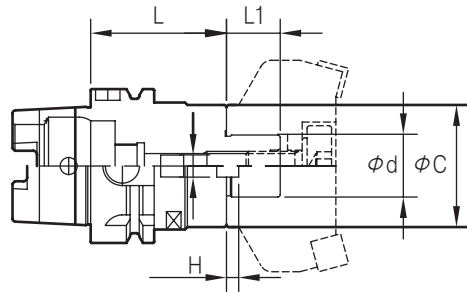

## Ordering Example

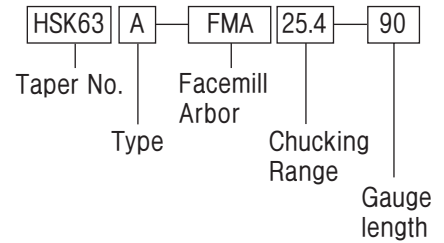

Taper No.	Code No.	$\phi d$	Cutter Dia	L	$\phi C$	L1	W	K	Weight (kg)	Stock
HSK63	HSK 63A -FMA25.4 - 60	25.4	80	60	50	22	9.5	5		<input type="checkbox"/>
	HSK 63A -FMA31.75 - 65	31.75	100	65	60	30	12.7	7		<input type="checkbox"/>
	HSK 63A -FMA38.1 - 75	38.1	125	75	80	34	15.87	9		<input type="checkbox"/>
HSK100	HSK100A-FMA25.4 - 60	25.4	80	60	50	22	9.5	5		<input type="checkbox"/>
	HSK100A-FMA31.75 - 65	31.75	100	65	60	30	12.7	7		<input type="checkbox"/>
	HSK100A-FMA38.1 - 75	38.1	125	75	80	34	15.87	9		<input type="checkbox"/>
	HSK100A-FMA50.8 - 80	50.8	160	80	100	36	19.05	10		<input type="checkbox"/>
	HSK100A-FMA47.625-95	47.625	200	95	128	38	25.4	12.5		<input type="checkbox"/>

\*. JIS B4113 Face Milling 용 입니다.

# FACE MILL ARBOR

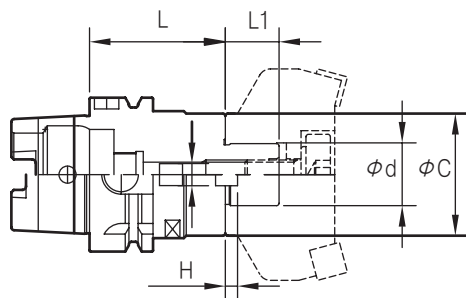

## Ordering Example

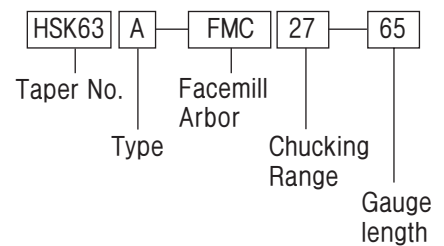

Taper	Code No.	$\phi d$	Cutter Dia	L	$\phi C$	L1	W	K	Weight (kg)	Stock
HSK63	HSK 63A -FMC22-60	22	50,63	60	45	18	10	5.5		<input type="checkbox"/>
	HSK 63A -FMC27-65	27	63,80	65	60	20	12	6		<input type="checkbox"/>
	HSK 63A -FMC32-75	32	100	75	85	22	14	7		<input type="checkbox"/>
HSK100	HSK100A-FMC22-60	22	50,63	60	45	18	10	5.5		<input type="checkbox"/>
	HSK100A-FMC27-65	27	63,80	65	60	20	12	6		<input type="checkbox"/>
	HSK100A-FMC32-75	32	100	75	85	22	14	7		<input type="checkbox"/>

\*. Sandvik T-MAX face shoulder arbor 입니다.