

FW7901-PVM

5MP Motorized Bullet



FW7901-PVM
5MP Motorized Bullet

FW7901-PVM is a high quality Bullet type IP camera which is equipped with 6.82MP(effective pixel) Progressive Scan CMOS image Sensor. With the highest sensitivity Starvis sensor, It is especially superior in low light condition. As it supports simultaneous H.265, H.264 and MJPEG Video Compression, less network bandwidth and storage space required. It also delivers high quality video image at 15fps@5M(2592x1944) or 30fps@4M(2688x1520) in progressive mode.

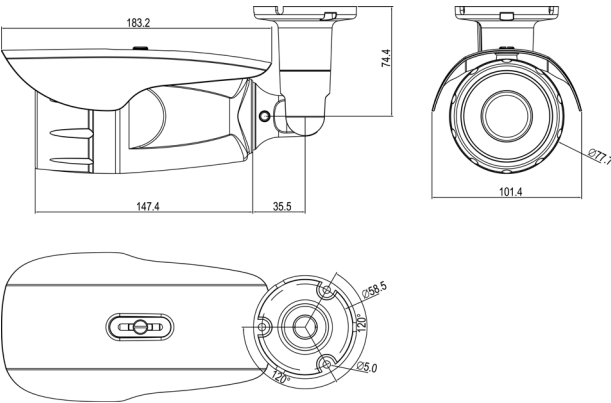

FW7901-PVM
5MP Motorized Bullet

• Key Features

- Ambarella platform - Backdoor Issue free
- Sony Starvis (1/2.9") 6.82MP PS CMOS Sensor
- Night Color with super high sensitive sensor
- 2.8~12.0mm Motorized Auto Focus Lens
- Quadruple Stream (H.265, H.264, M-JPEG, JPEG)
- Max. 15fps@5MP(2592x1944) or 30fps@4MP(2688x1520)
- DOL WDR (>120dB)
- Night Color level adjustment (B/W, 10, 20, 30, 40, 50)
- Shutter limit (Min./Max.) setting
 - Good for the better night time moving object image
 - To avoid saturation under strong back light or IR reflection
- OnVIF (Profile S) standard

• Tech Notes

Zero-configuration networking (zeroconf) is a set of technologies that automatically creates a usable IP camera network based on the Internet Protocol Suite (TCP/IP) when IP cameras are interconnected with other device or server. It does not require manual operator intervention or special configuration servers. Without zeroconf, a network administrator must set up network services, such as Dynamic Host Configuration Protocol (DHCP) and Domain Name System (DNS), or configure each computer's network settings manually.

IP filtering

The IP filtering enables you to control what IP traffic you want to allow into and out of your IP camera. Use IP filtering to help protect your IP camera by filtering access from other IP address set for filtering.

FW7901-PVM

► Technical Specifications

Camera

Imaging Sensor	1/2.9" 6.82MP Sony Starvis PS CMOS Sensor
Lens	2.8~12.0mm Motorized Auto Focus
Day & Night	True Day & Night (ICR)
Min. Illumination	Color : 0.06 lux B/W : 0 lux (IR On)

Video Stream

System	Ambarella 32bit Embedded Linux 256Mbyte SDRAM, 128Mbyte NAND Flash
Compression	H.265, H.264, M-JPEG, JPEG
Resolution	2048x1536, 1920x1080, 1280x720, 704x480, 640x352, 320x176, 160x96
Frame rate	30fps, 25fps, 15fps@5M(2592x1944)
Video Stream	Quadruple Streaming, selectable : H.265/H.264/MJPEG, Frame rate, Bitrate, VBR/AVBR/CBR/ACBR, GOP

Video Setting

Motion Detection	4 Areas
Audio Detection	Enable (sensitivity setting) / Disable
Privacy Masking	8 Areas
Video Analytics	Optional (Face Detection, Tampering, Tripwire etc.)
Smart Video	ROI
Exposure Mode	Indoor / Outdoor
AE Metering Mode	Spot / Center / Average / Venter Flip
Shutter Control	Manual (Min./Max. Setting) / Auto
Max AGC Gain	0~72
Sense Up Level	Off / 1 / 2
Back Light Compensation	Enable / Disable
Auto Exposure Weight	25% ~ 400%
WDR	DOL WDR (Enable / Disable), D-WDR 0~128
Image Adjustment	Brightness / Contrast / Hue / Saturation / Sharpness
White Balance	Auto / Manual / 9 Special Condition / Custom
3DNR	0~11
Day & Night Control	Color / Black&White / AutoNight Color (B/W, 10, 20, 30, 40, 50)
Image Direction	Vertical Flip / Horizontal Flip / Corridor Mode

Network

Security	IP Filtering, HTTPS, Encrypted & Basic Authentication, Management White List
Supported protocols	HTTP, RTP/RTSP(Uni/Multicast), TCP/IP(v4/v6), UDP, FTP, Telnet, HTTPS, RARP, SNMP, DHCP, NTP, SMTP client, uPnP&etc
DDNS	www.ipcctvdns.com
Interface	RJ45 Ethernet 10/100Mbps

System Intergration

Programing Interface	SDK, OnVIF Profile S
Video Analytic	Motion detection, Optional: ROI, Tripwire, Tampering, Face Detection
Triggering Event	Motion detection, triggering DI, triggering serial input, connected/disconnected, boot finished
Action on Event	Pre-alarm & Post-alarm buffer, Upload FTP, Email notification, FCM Google notification

Connection

Onboard storage

Type	1 MicroSD Slot
Recording	Always, Schedule, Event, Schedule & Event
Playback	Internet Explorer, FlexWATCH NVR/CMS/ Mobile App

Illuminator

Type	30 IR LEDs
Distance	Max. 30Meter

Video/Audio

Video Out	1 CVBS
Audio Compression	-
Audio stream	-
Connection	-

General

Case	Metal
Power Supply	SMPS, DC12V / 1A PoE : IEEE 802.3af
Power Consumption	Max. 7.5W
Operating Environment	-20℃ ~ +60℃, 10% ~ 90% RH
Dimension	58 x 258(L) x 85(H) mm
Weight	About 669g without Power Supply
Approval	KC, CE, FCC, RoHS, IP66
Accessories	-
Bundle Software	IP Installer, SMVP, Smart NVR Lite