

Flame Proof Type Sampling Infrared Gas Detector

GTD-5000F IR

Feature

- ▷ Continuous detection of flammable, CO₂, CO and N₂O gas in explosion hazardous area with flame proof structure
- ▷ State-of-the art infrared detection principle
- ▷ Operation in non oxygen environment
- ▷ Digital flow sensor to maintain regular flow rate
- ▷ Fast response detection of gas leakage with a high efficient pump inside
- ▷ Self diagnosis function with built-in Microprocessor
- ▷ Fast response time (<3 sec)
- ▷ Stable quality and proved detection principle for service life
- ▷ Auto calibration and program setting with a magnet bar
- ▷ 4-digit digital gas concentration display
- ▷ 4-20mA DC output signal
- ▷ Easy configuration of monitoring system by RS-485 Modbus isolated serial data communication (Option)
- ▷ 3-Wire Type
- ▷ 2-stage alarm, 1-trouble display and relay contact output
- ▷ Calibration and maintenance by one-man



General

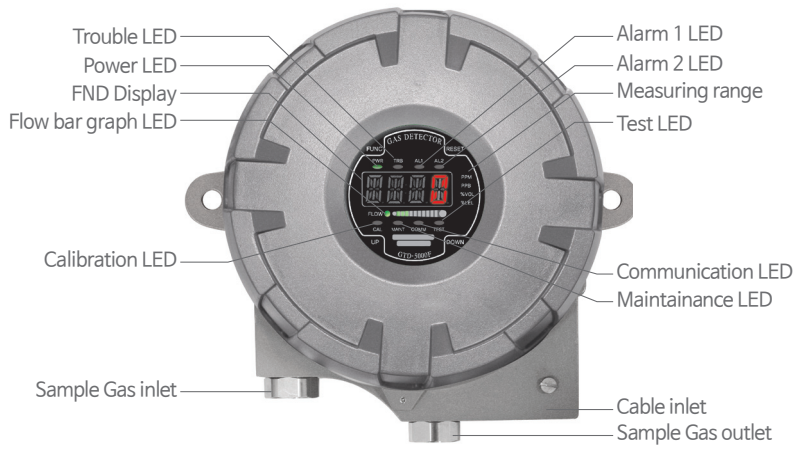

Dimension (Unit:mm)

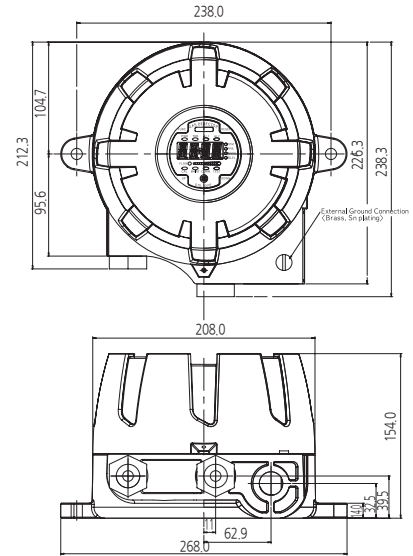

Accessories



Specification

※Specifications are subject to be changed without prior notice.

EXPLOSION PROOF & SAMPLING TYPE INFRARED GAS DETECTOR	
Model	GTD-5000F IR
Measuring gas	Hydrocarbon gases (LNG, LPG, Methane, Butane & etc) CO ₂ CO, N ₂ O
Measuring type	Auto Sampling type
Measuring method	Infrared type
Measuring range	0~100% LEL 0~5000ppm 0~100% Vol 0-2.0% Vol 0-5.0% Vol, 0~4000ppm
Sensor life time	Over 5 years
Response time	< 6sec / 90% scale, < 3sec / 50% scale
Accuracy	±3% / Full Scale
Parameter control	Non intrusive control with a Magnet bar (calibration, maintenance, alarm setting)
Operation mode display	Alarm / Trouble LED , Flow rate
Measuring value display	FND Display(4-Digit)
Alarm signal output	250V 1A / 3-SPST relay contact (2-stage alarm, 1-trouble)
Output signal	Analog output : 4-20mA DC Digital output : RS-485 Modbus(Optional)
Sampling method	Diaphragm Pump
Sampling line	OD 1/4" (Standard)
Flow rate	0 ~ 1000 ml/min Max
Cable/Distance	Power + Signal cable : 3-wire > 1.5sq(AWG16) 4 - 20mA DC Signal : 500m RS-485 Modbus Signal : 1000m
Conduit connection	M20 x 1.5P, M25x1.5P, NPT ½", NPT ¾"
Mounting type	Wall mount
Operating temperature	-40°C ~ + 60°C
Operating humidity	5 to 99% RH (Non-condensing)
Operating power	Standard : 18 ~31V DC (24V DC normal) / 600mA max
Material	ALDC
Dimensions	226.3(W) × 154(H) × 238(D) mm
Weight	5kg
Approval	Explosion proof type (Ex d IIC T6, IP65) KCs Explosion proof type (EX d IIB + H2 T6, T5) ATEX, IECEx, NEPSI, CE, KFI, KC