

MULTIS HYDRO-SWIVEL JOINT

MS202A-XKQ

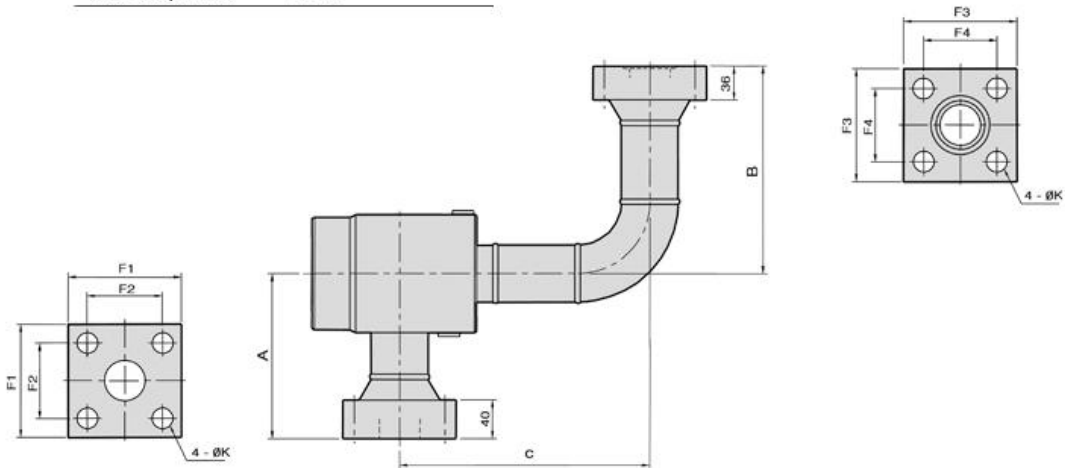

* Material	Swivel joint: Carbon Steel Pipe: Stainless Steel Flange: Stainless Steel
* Fluid	Industrial Water
* Max. Pressure	420 kg/cm ²
* Max. Temperature	100 °C



MODEL NAME	A	B	C	F1	F2	F3	F4	K
MS202A - XKQ - A	175	220	165	120	80	120	77.8	22
MS202A - XKQ - B	175	220	250	120	80	120	77.8	22
MS202A - XKQ - C	175	220	265	120	80	120	77.8	22
MS202A - XKQ - D	175	220	635	120	80	120	77.8	22
MS202A - XKQ - E	175	220	765	120	80	120	77.8	22