

# SRM Spring Rubber Mount (Deflection: 5.5mm)

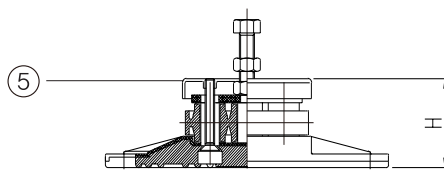
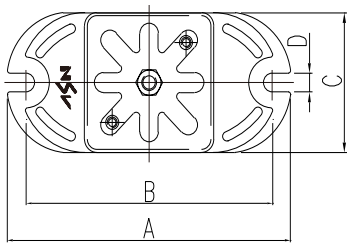
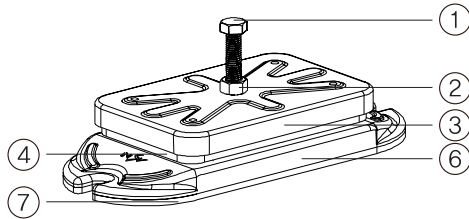

## ■ Features

It is an improved, mount version of SRP type spring rubber pad taking advantage of anti-vibration rubber and metal spring. SRM type enables control of the level to reduce horizontal deflection. Moreover, its external housing is made of stainless steel to prevent corrosion when installed outside.

## ■ Usage

- ◆ For facilities and equipment (for example, PUMP, AHU and FAN)
- ◆ For industrial equipment (including Press, Shearing Machine and Lathe)
- ◆ For all kinds of equipment installed on a solid base
- ◆ For vertical and horizontal pipes

## ■ Specification

No.	Name of Components	Material	Standard
1	Level Bolt	SS400	KS B 1002
2	Nut	SS400	KS B 1012
3	Upper Housing	STS304	KS D 3698
4	SRP PAD	SUP9	KS B 2402
		CR	KS M 6617
5	Middle Plate	SS400	KS D 3503
6	Lower Housing	STS304	KS D 3698
7	Lower Non Skid Pad	CR	KS M 6617

## ■ Dimension & Selection Guide

Type	Capacity (kgf)	Deflection (mm)	Weight (kg)	Dimension(mm)					
				A	B	C	D	H	Level Bolt
SRM-100	100	5.5	0.8	147	116	80	12	65	M10X60
SRM-200	200		0.81						
SRM-400	400		1.71						
SRM-600	600		1.71	226	200	104	12	70	M12X65
SRM-800	800		1.76						
SRM-1000	1000		3.7						
SRM-1200	1200		3.74						
SRM-1500	1500		3.7	309	279	130	12	70	M12X65
SRM-2000	2000		3.74						

(NOTE) The mentioned size and scale can be altered to improve the quality performance and capacity of the product without any notice.

## ■ Installation Features

