

# 17,20,25,32SP-A

Tail Spindle (Air Clamp Type)

테일 스피들 (에어 클램프 타입)

## 제품 특징

공작물 & 지그를 장착하여 무게를 지탱하며 회전, Air Clamp 방식

## Application / Customer's Benefit

Rotation of Work & Jig with Weight Support, Air Clamp type

## Model No.

17 SP-A

Clamp / Air  
타입/ TYPE : SP-A Series / Tail Spindle  
Apply Model / S-170



17SP-A

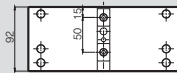
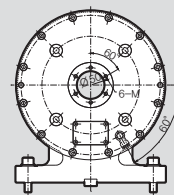
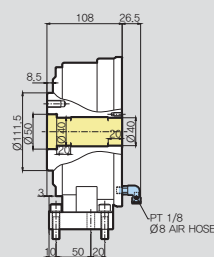
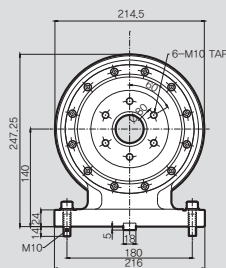

Net Weight(kg) : 26

20SP-A

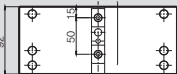
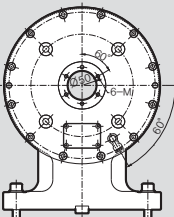
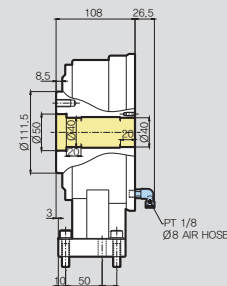
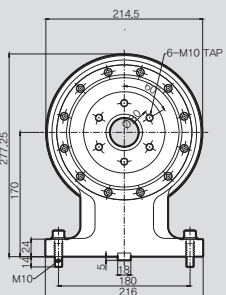

Net Weight(kg) : 33

25SP-A

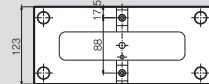
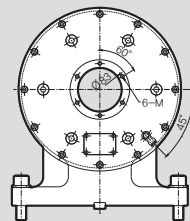
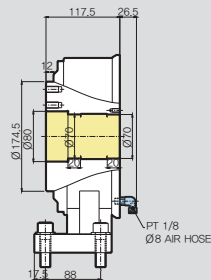
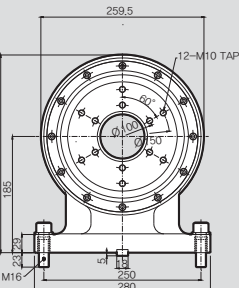

Net Weight(kg) : 60

32SP-A

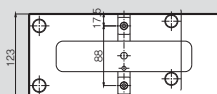
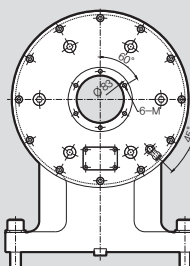
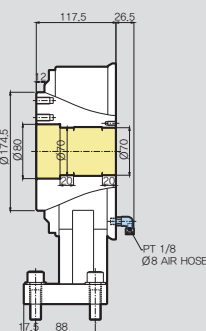
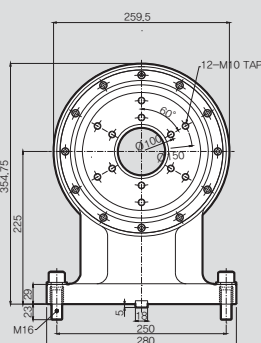

Net Weight(kg) : 64