

TENSION LOAD CELLS

MODEL

STS

Feature

인장형 로드셀로서 중고중량의 인장시험에 적합
Crane weighing, Tower testing에 사용됩니다.

Dimension

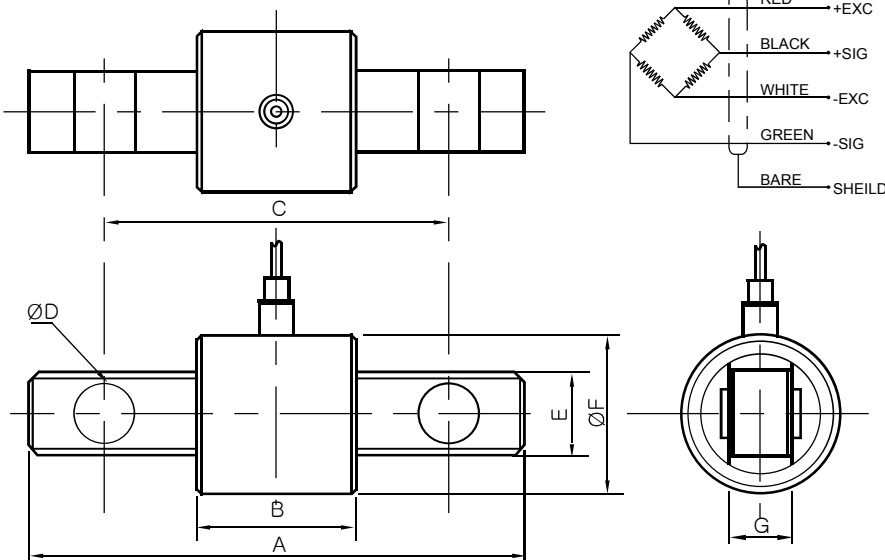

Dimension (unit:mm)

Capacity	A	B	C	ØD	ØE	ØF	G	Weight (kg)
1tf	140	70	110	18	32	50	20	2
2tf	163	70	120	22	39	50	25	2
3tf	180	63	128	27	49	60	30	2
5tf	234	80	168	37	59	70	40	3.5
10tf	310	100	210	37	89	100	40	9
20tf	400	120	285	62	120	135	70	23
30tf	428	128	288	64	120	135	75	26
50tf	508	148	342	75	145	160	98	43
70tf	620	149	410	100	170	210	100	68
100tf	600	166	380	110	180	131	100	75
200tf	820	145	520	140	290	177	120	210

Specification

Specification	Accuracy
Rated capacity (R.C)	1, 2, 3, 5, 10, 20, 30, 50, 70, 100, 200tf
Rated output (R.O)	1mV/V ± 0.5%
Nonlinearity	0.5% of R.O.
Repeatability	0.1% of R.O.
Zero balance	0.2% of R.O.
Terminal resistance input	350 ± 10Ω
Terminal resistance output	350 ± 5Ω
Insulation resistance	2000MΩ
Temperature range, compensated	-10 ~ 60°C
Temperature range, safe	-20 ~ 80°C
Temperature effect, on zero balance	0.1% R.O./10°C
Temperature effect, on rated output	0.05% LOAD/10°C
Excitation recommended	10V
Safe overload	150% R.C
Cable length	Φ7, 4core, 10m