

Model SBU

High Precision Portable Digital Pressure Gauge

Description

The SBU is a portable digital pressure gauge featuring accuracy 0.1%FS in condition of $-10^{\circ}\text{C} \sim 50^{\circ}\text{C}$, multiple measurement units, Min./Max. readings, auto zero and automatic power off to conserve battery(AAA size) power. The SBU will operate with any liquid and gas that is compatible with 316L stainless steel. With Aluminum Die casting housing and Protection Rate IP65 are ideal in poor surroundings.

Features

- ▶ Die casting housing
- ▶ Measuring range 0~70MPa
- ▶ $\pm 0.1\%$ FS Accuracy, -10 to 50°C
- ▶ Large, easy to read display & Backlight Unit
- ▶ 10 selectable pressure units (MPa, mbar, bar, inH_2O , inHg , mmHg , kgf/cm^2 , atm, psi, kPa)
- ▶ Peak, Alarm, Auto power off, Zero/Span Calibration, Auto Zero
- ▶ Option : RS232C communication, 1~5VDC Analog Output, Data logging

Applications

- ▶ Portable Field Calibration & Calibration Labs.
- ▶ Process monitoring & Control
- ▶ Valve & Regulator Test
- ▶ Chart Recorder Replacement
- ▶ Leak Test

Specifications



Range

0~100, 200, 350, 700kPa, 2, 3.5, 7, 20, 35, 70MPa(Gauge)
-100kPa~100, 200, 350, 700kPa, 2, 3.5MPa(Gauge)
0~100, 200, 350, 700kPa, 2, 3.5, 7, 20, 35, 70MPa(Absolute)

Performance

Accuracy $\pm 0.1\%$ FS ± 1 digit
(Include Linearity, Hysteresis, Repeatability, Thermal Error)
Compensated Temperature Range $-10 \sim 50^{\circ}\text{C}$
Operating Temperature Range $-20 \sim 70^{\circ}\text{C}$

Electrical

Display ± 19999 Backlight LCD
Excitation 1.5V(AAA Size) Alkaline Battery $\times 3$ / External Power : 12~28VDC
Output
Analog Option : 1~5VDC (Only External Power)
Digital Option :RS232 (Only External Power)
Display Time 1, 2, 5, 7, 10 time/sec (on Peak function,10 time/sec)
Function Unit Conversion, Peak, Alarm, Auto Power Off, Zero/Span Calibration, Auto Zero, Data Logging(Only RS232)

Physical

Proof Pressure X1.5
Burst Pressure X2
Vibration $49.1\text{m/s}^2\{5G\}$, 10~500Hz
Shock $490\text{m/s}^2\{50G\}$
Pressure Port G(PF)1/4", NPT1/4"
Media-Wetted Materials SS316L
Protection IP65
Weight Approx. 350g

Dimension

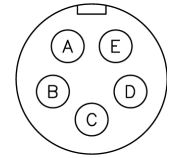
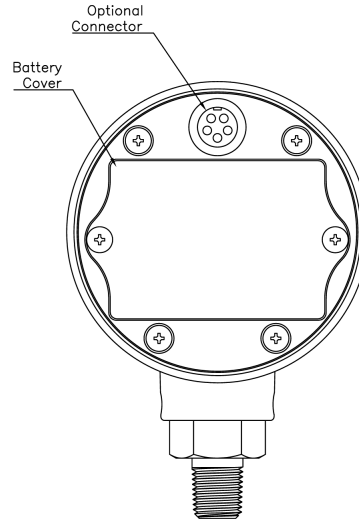
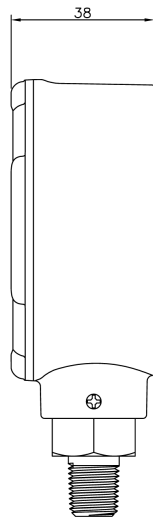
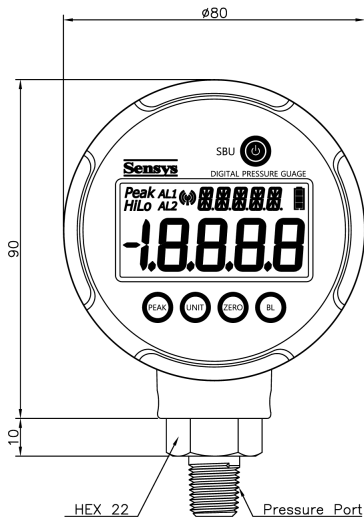

Connector
(1~5V, RS232 Output Only)

Pin No.	Wire Color	Connections
A	Red	Ext. Power+ (12~28VDC)
B	Shield	COM
C	White	RS232 Rx
D	Black	RS232 Tx
E	Green	Analog Out+

Ordering Information

