

Water Flow Sensor

(SWF – A50/A60)

PRODUCT SPECIFICATION SHEET



FEATURES

- This sensor has excellent character in low pressure.
- The out put pulse frequency has linear character in flux change.
- This sensor has a half-permanent life by high sensitivity semiconductor sensor.

CONTENTS

| | |
|----------------------|-----|
| Application | 1 |
| Features | 1 |
| Specifications | 1~2 |
| Dimensions | 2 |

APPLICATION

This sensor is used in water flow sensing.

This sensor has application to Wall gas boiler and instantaneous warm-water appliance, and water filtering appliance.

SPECIFICATIONS

| | | |
|--|--------------------------------------|---------------|
| Type | : Turbine type with Hall sensor | |
| Installation | : Vertical with upward flow | |
| Working pressure | : less than 10 kgf / cm ² | |
| Permissible fluid temperature (According to any situations, it is possible to change a little bit.) | : 0 ~ 60℃ (It shall not be frozen) | |
| Material | Body | NY66(G/F 30%) |
| | Rotor | POM |
| | Magnet | Ba – Ferrite |
| | Stop ring | SUS304 |

SPECIFICATIONS

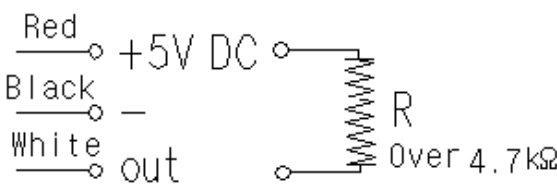
| | | | |
|--|-----------------|--|-------------------|
| Efficiency | Fluid | : Water | |
| | Measuring range | : 2.0 ~ 30 ℓ / min | |
| Flow rate – pulse  | | Flow rate Q (ℓ /min) | Pulse signal (Hz) |
| | | 2 | 11 |
| | | 3 | 17 |
| | | 5 | 28 |
| | | 10 | 57 |
| | | 20 | 113 |
| | | 30 | 171 |
| | | Accuracy F.S ± 5% | |
| Withstand pressure | | : 10.0 kgf/cm ² | |
| Electrical rating | | : DC 4.5V ~ 24V, 10 mA, Max. (Option : 2.7V ~24V , 5mA) | |
| Duty cycle | | : 30 ~ 70% | |
| Insulation resistance | | : Not less than 100 MΩ (Between the connector and body) | |
| Dielectric strength | | : When AC 600V(50/60 Hz) is added between the connector and body, detecting current is under 3 mA. | |
| Pipe Connection | | : PF 1/2"(15A) | |
| Weight | | 50A : 49.7g 60A : 52.3g | |

DIMENSIONS

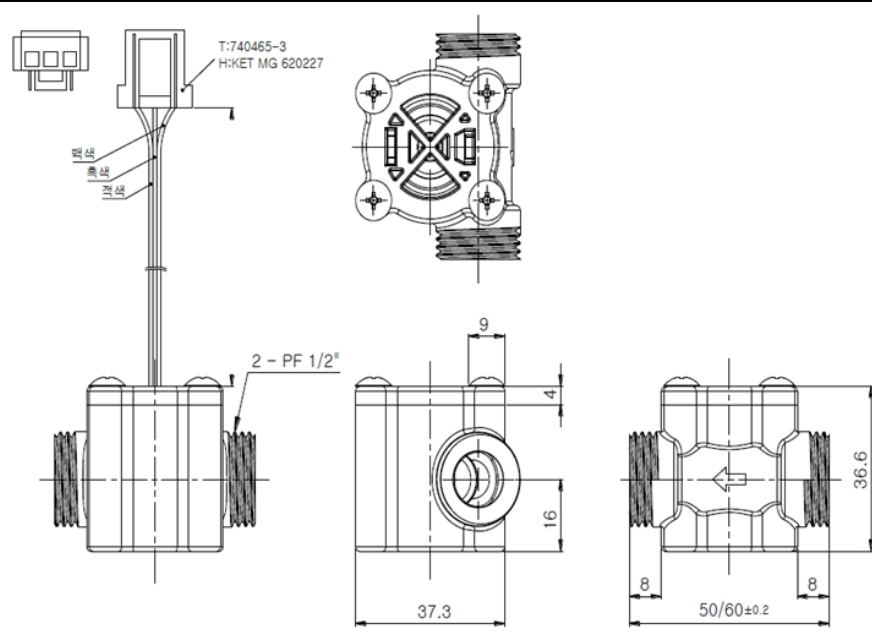

Fig 1. Water flow sensor

The specifications and dimensions can be changed without warning