

Flow Switch

(SFS-32A)

PRODUCT SPECIFICATION SHEET



FEATURES

- This switch has excellent character in low pressure.
- This switch cannot exert harmful influence by scrap.
- This switch has multi function and can modify various structure for customer.

CONTENTS

Application	1
Features	1
Specifications	1~2
Dimensions	2

APPLICATION

This switch is used in water flow sensing.

This switch has application to gas boiler and instantaneous warm water appliance, and water filtering appliance

SPECIFICATIONS

Operating flow quantity(ℓ /min) (According to any situations, it is possible to change a little bit)	ON	37 ± 3	22 ± 3
	OFF	35 ± 3	19 ± 3
Installation	: Vertical and Horizontal		
Ambient temperature (According to any situations, it is possible to change a little bit)	: 0 ~ 60℃		
Permissible fluid temperature (According to any situations, it is possible to change a little bit)	: 0 ~ 60℃ (It shall not be frozen)		
Material	: Body	: Brass	
	: Magnet	: Sr – Fe	
	: O-ring	: Silicone	
	: MG Plate	: SUS316	

SPECIFICATIONS

Common use pressure		: 0.2 ~ 10 kgf/cm ²
Electrical rating	: Switching voltage	: DC300V, AC350V
	Switching current	: AC, DC 1.0A
	Ratings	: 10VA(W)
	Contact resistance	: less than 100 mΩ (included resistance)
Withstand pressure		: When water pressure = 17.5 kgf/cm ² is added for one minute, no external leakage shall be measured and it must be no damaged on the body.
Dielectric strength		: When AC1800V(50/60Hz) is added between the connector and body for one second, it shall be no unusual, detecting current is under 3mA.
Insulation resistance		: Between terminal and outer exposed metal parts shall be 100 MΩ ever by DC 500V meggar.

DIMENSIONS

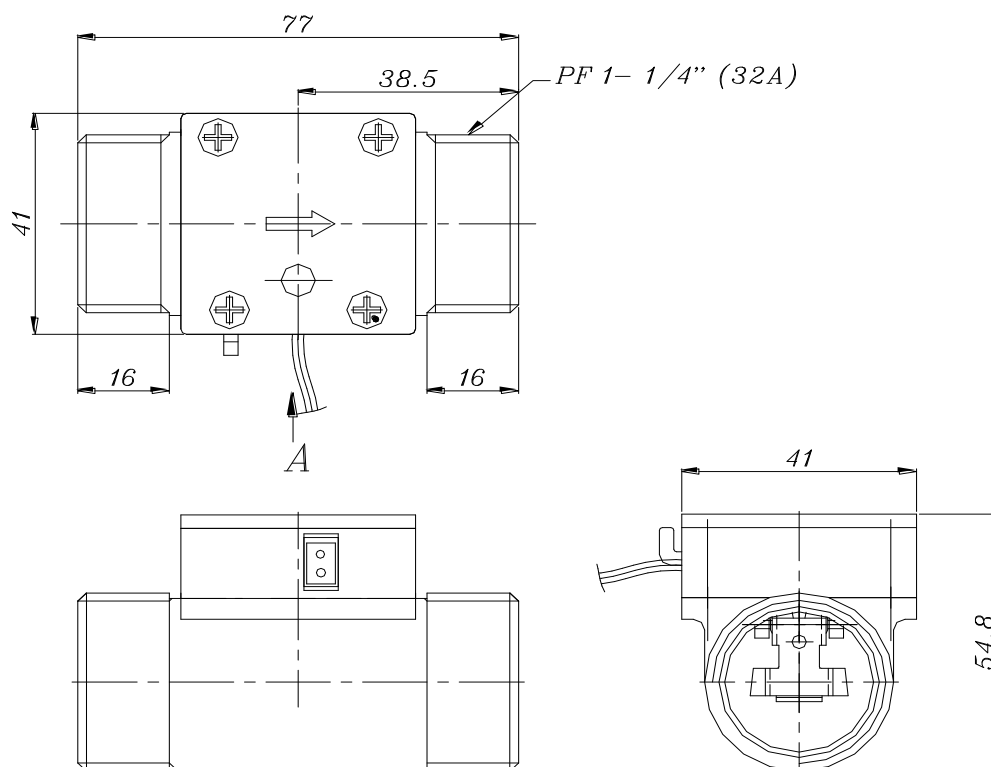

Fig 1. Flow switch

The specifications and dimensions can be changed without warning