

# REDUCING PRESSURE & FLOW SWITCH (SRPF - L)

## PRODUCTION SPECIFICATION



## FEATURE

- This has multi functions like Reducing, water flow sensing, auto water-supply by pressure.
- This has structure that is not influenced by other scraps etc.
- This can supply water to need in appliance by hand operation.

## CONTENTS

- APPLICATION ..... 1
- FEATURE ..... 1
- SPECIFICATION ..... 1~2
- DIMENSION ..... 2

## APPLICATION

This is used in Gas boiler, Hot water, etc.

This can reduce high pressure and protect applications, and be sensing water-flow.

## SPECIFICATION

Type	: Differential pressure & Magnet sensor	
Material	Body	NY66(G/F30%)
	Diaphragm	NBR, EPDM
	Magnet	Sr - Fe
	Shaft	Brass
Ambient temperature	: 0 ~ 60℃	
Permissible temperature	: 0 ~ 60℃ (It will not be frozen)	
Working pressure	: 0.2 ~ 10.0 kgf/cm <sup>2</sup>	
Withstand pressure	: 17.5 kgf/cm <sup>2</sup>	
Setting pressure	: P1(Inlet pressure)	: P2(Outlet pressure)
	10.0 kgf/cm <sup>2</sup>	2.0 kgf/cm <sup>2</sup>

SPECIFICATION

Electrical characteristic	Switching voltage	: DC100V, AC150V	
	Switching current	: AC, DC 1.0A	
	Rating	: 10VA(W) or 50VA(W)	
	Contact resistance	: less than 100 mΩ (resistance load)	
Withstand pressure		: When water pressure = 17.5 kgf/cm <sup>2</sup> is added for one minute, no external leakage shall be measured and it must be no damaged on the body.	
Dielectric strength		: When AC1800V(50/60Hz) is added between the connector and body for one second, it shall be no unusual, detecting current is under 3mA.	
Insulation resistance		: Between terminal and outer exposed metal parts shall be 100 MΩ ever by DC 500V meggar.	
Operating point(ℓ /min)		ON	2.5 ± 0.5
(This can be changed by customer)		OFF	2.0 ± 0.5

DIMENSION

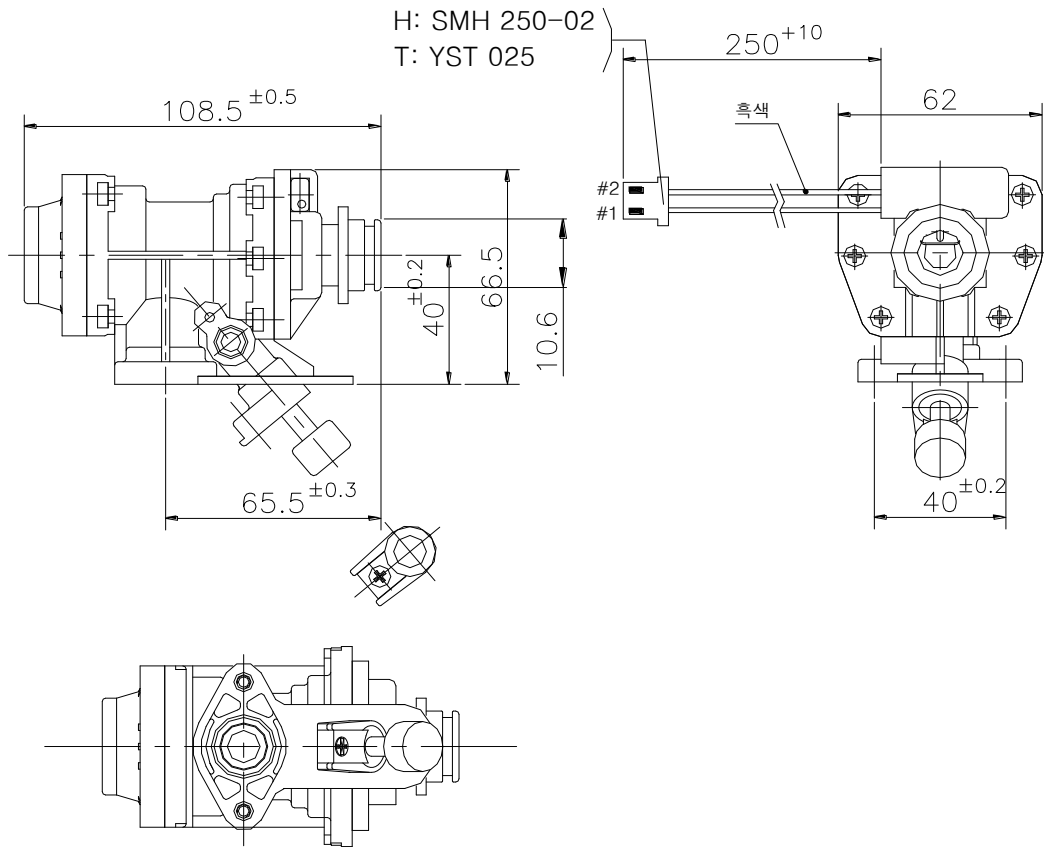

3H

The specifications and dimensions can be changed without warning