

# Water Pressure Sensor (SWPSS 04B)

## PRODUCT SPECIFICATION SHEET

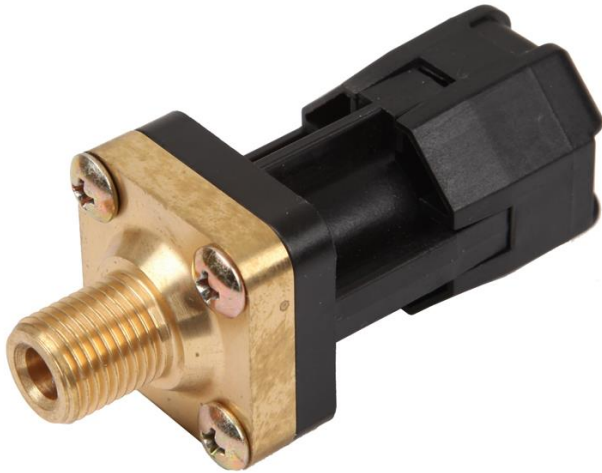

### FEATURES

- Linearity out put(V)
- No-contact
- Excellent durability
- Reasonable price, etc..

### CONTENTS

Features .....	1
Application .....	1
Specifications .....	1~2
Dimensions .....	3

### APPLICATION

This sensor is usually used in Home-Gas Boiler, piping devices and so on.

### SPECIFICATION

Medium	Water
Pressure range	0 ~ 4 bar(This can be changed by an orderer)
Rupture pressure	10 bar
Materials	- Body : Brass - Cover : PA66(GF 30%) - Diaphragm : EPDM
Temperature	- Medium and ambient : 0 °C ~ 85 °C (It shall not be frozen) - Storage : -30 °C ~ 80 °C - Rupture : 95 °C
Power supply/Output	- Power supply : DC 5V - Output : 0.5V ~ 4.5V
Current consumption	Less than 15mA

Pressure connection	PF 1/4" or Plug connector (Refer to Dimension)
Electrical connection	YEONHO, SMH250-03
Installation Direction	Free
Protection standard	IP54
Accuracy	±3.0(% F.S) (Included hysteresis value)
Life Cycle	On / Off : 5 Sec – 100,000 Cycle
Weight	: 91g

## OUTPUT

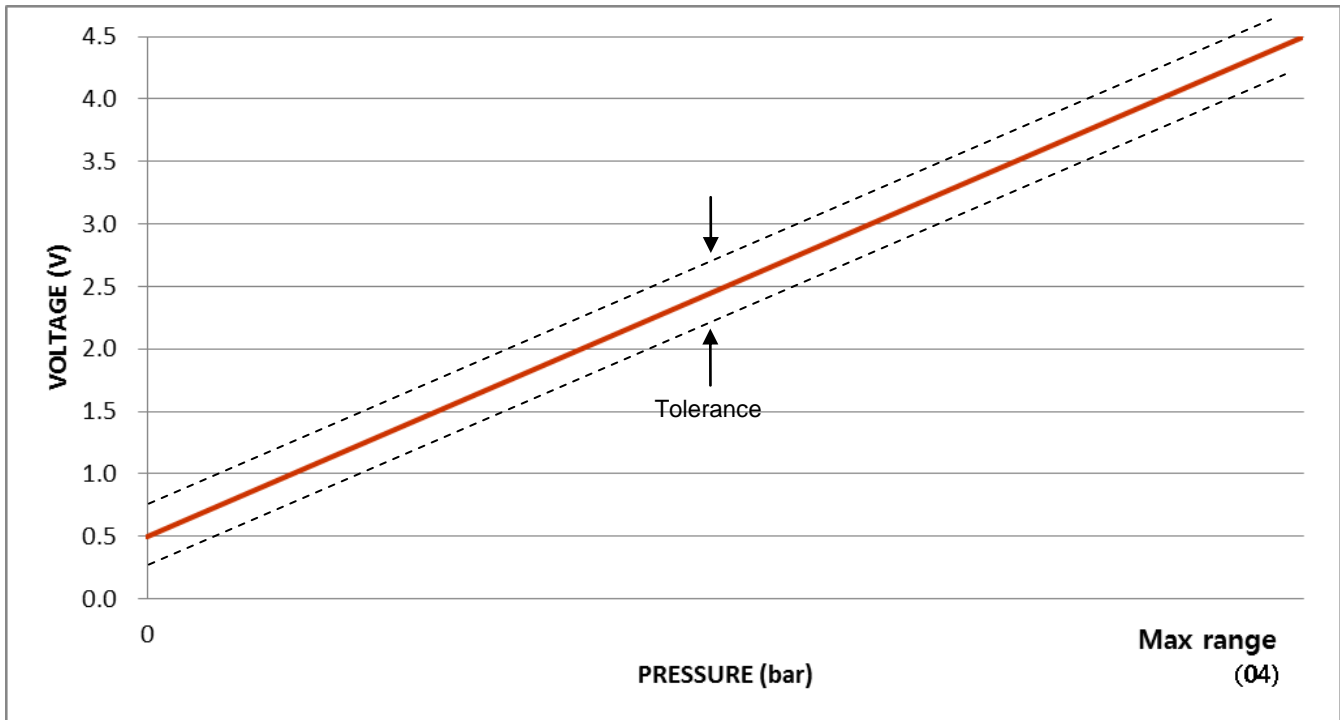

# DIMENSION

WIRE : UL1007 TYPE, 26AWG  
HOUSING : SMH-250-03, YEDNHD  
TERMINAL : YST025 YEDNHD

Pin NO.1 WHITE  
Pin NO.2 BLACK  
Pin NO.3 RED



WHITE → OUT  
BLACK → GND  
RED → VCC

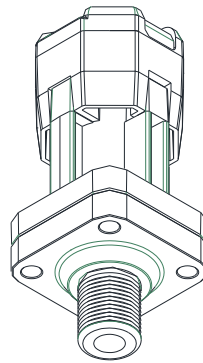
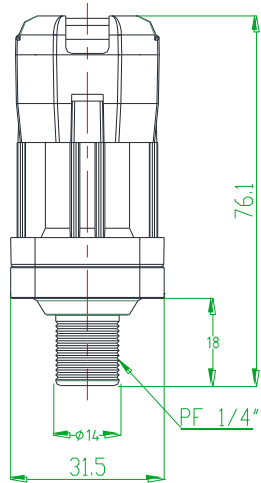
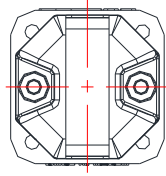

<NORMAL TYPE>

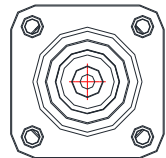

**The specifications and dimensions can be changed without warning.**

**Electrical pressure sensor**

**Before using the air pressure sensor read the instruction manual. The control unit must be installed in accordance with applicable regulations**