

# Gas Pressure Switch(Fix)

## (SGPS 41F)

### PRODUCT SPECIFICATION SHEET



### FEATURES

- The gas pressure switch is used detect the gas. When the gas pressure changes, the diaphragm of the pressure receiving part detect it and operate the switch on/off control.
- This switch is widely used detect the upper limit of lower limit pressure of gas to be supplied to a gas burner.

### CONTENTS

Application .....	1
Features .....	1
Specifications .....	1~2
Dimensions .....	2

### APPLICATION

This gas pressure switch is designed to monitor gas pressure and activate switch contacts accordingly.  
This pressure switch can be used autonomously or integrated into a multifunctional gas control.

### SPECIFICATIONS

Type	: Pressure setting type	
Material	: Body	BRASS
	Diaphragm	NBR
	Switch part	PC (Naturally white)
	Contact point	Agcdo
	Cover	PS
Ambient temperature	: -15 ~ 60℃	
Electrical rating	: 250VAC 5A(Resistive load)	
Control fluid	: LNG, LPG	

## SPECIFICATIONS

Max. Operating pressure		500 mmH <sub>2</sub> O
Max. Sustained pressure		1000 mmH <sub>2</sub> O
Stand pressure setting range	Factory set point	50 ~ 200 mmH <sub>2</sub> O
	Adjustable tolerance	± 10%
	Differential	30 ±5 mmH <sub>2</sub> O
Electrical connection		Male fast-on 6.3 X 0.8mm
Pressure connection		PF 1/4"

## DIMENSIONS

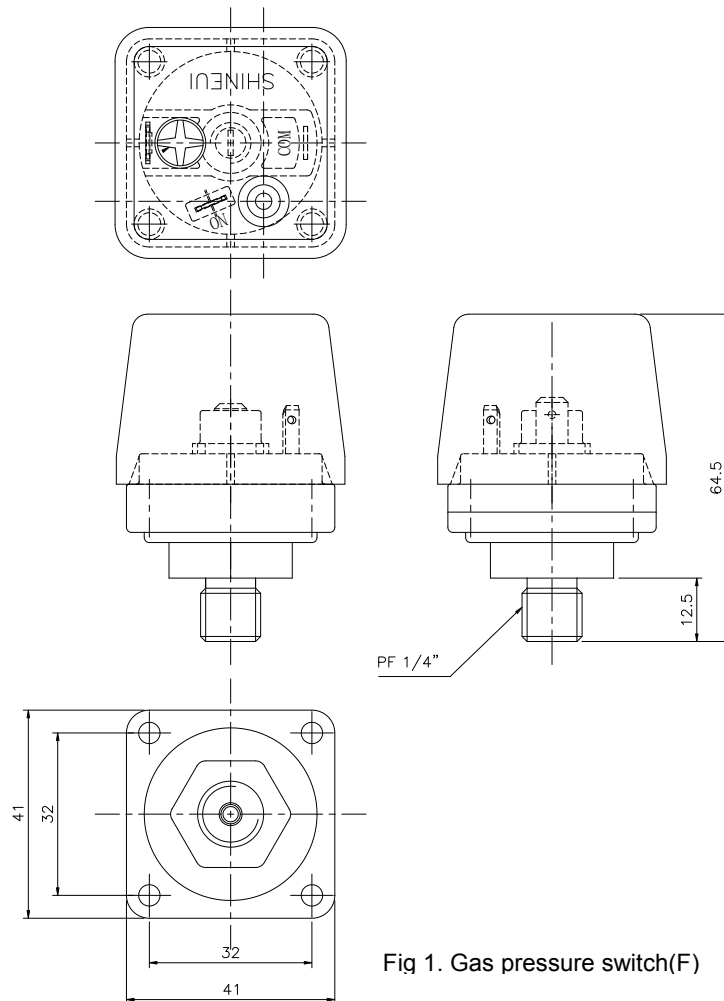

Fig 1. Gas pressure switch(F)

The specifications and dimensions can be changed without warning