

MOTORIZED VALVE

(SMV-2W)

PRODUCT SPECIFICATION SHEET



FEATURES

- This valve use DC(V) and has manual function.
- This has high torque and excellent durable characteristic.

CONTENTS

Application	1
Features	1
Specifications	1~2
Dimensions	2

APPLICATION

This valve is used to open and close a waterway in fire fighting equipments and pippings of industrial equipments.

SPECIFICATIONS

Medium	: Water
Working pressure	: 1.5 ~ 10kgf/cm ²
Voltage	: DC 24 V
Current	: 850 mA
Electrical connection	: Free (Even if plus pole and minus pole are reversed each other, it's no problem.)
Test pressure	: 32kgf/cm ² (for 1 min)
Operating time	: 4 ±2sec (B → A), (A →B) is manual operation.
Fluid temperature	: 0 ~ 60 °C (It shall not be frozen)

SPECIFICATIONS

Operating temperature	: -20 ~ 60℃
Protection class	: IP 54 with cover
Insulation resistance	: Between terminal and outer exposed metal parts shall be 100 MΩ ever by DC 500V meggar.
Dielectric strength	: When AC 600V(50/60 Hz) is added between the connector and body, detecting current is under 3 mA.
Connection	: 15A, 20A
Lead wire - tensile strength	: 2.5 kg / mm ² – 1 min
Life cycle	: not less than 10,000 cycle

PRODUCT CONNECTION DIAGRAM

FORM SECTION	MODEL	VOLTAGE	CONNECTION DIAGRAM
DOUBLE WIRE SIGNAL	SMV12-2P	DC 12V	
	SMV24-2P	DC 24V	
THREE WIRE SIGNAL-TR (- COMMON)	SMV12TG-3P	DC 12V	
	SMV24TG-3P	DC 24V	
THREE WIRE SIGNAL-TR (+ COMMON)	SMV12TP-3P	DC 12V	
	SMV24TP-3P	DC 24V	
THREE WIRE SIGNAL-RELAY (BRASS BALL VALVE)	SMV12RB-3P	DC 12V	
	SMV24RB-3P	DC 24V	
THREE WIRE SIGNAL-RELAY (INJECTION BALL VALVE)	SMV12RR-3P	DC 12V	
	SMV24RR-3P	DC 24V	

※ MODEL SECTION

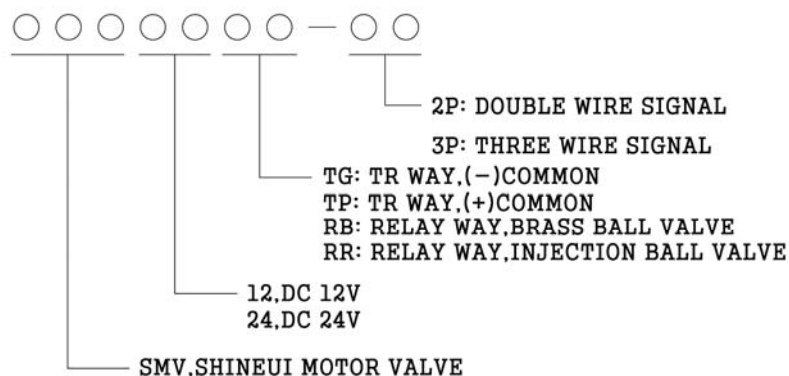

DIMENSIONS

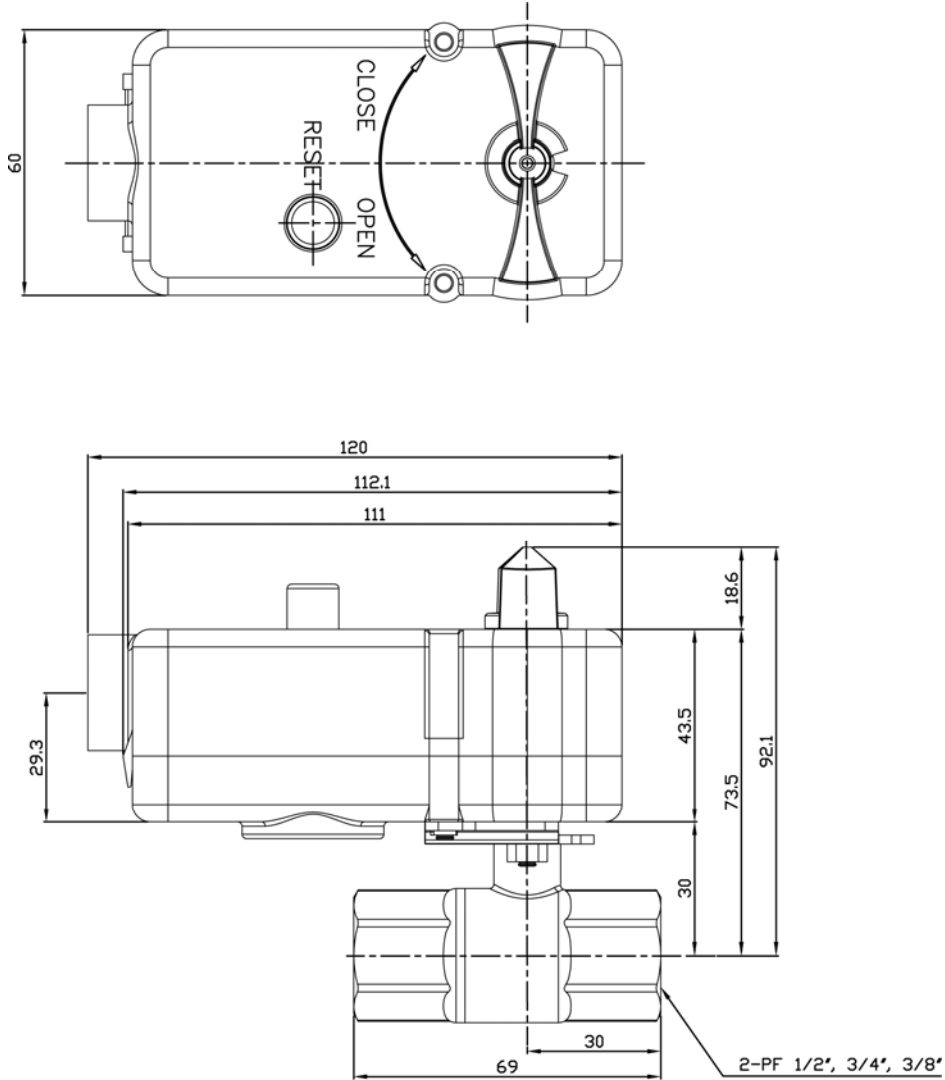

Fig 1. MOTORIZING VALVE

The specifications and dimensions can be changed without warning