

SHRINK FIT HOLDER

MAS - BT 403 FORM AD/B

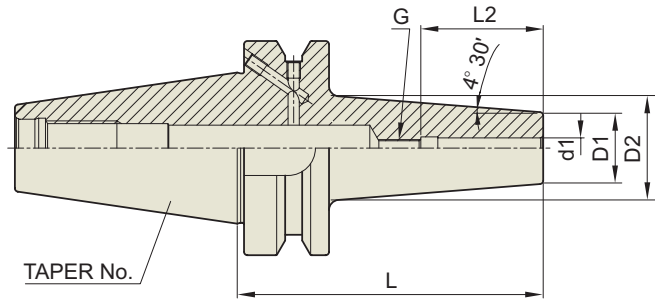

MAS - BT 403	Taper Accuracy AT3	G Value 2.5	RPM 20,000	Coolant System AD/B
-----------------	--------------------------	----------------	---------------	---------------------------

TAPER No.	CODE No.	d1	D1	D2	L	L 2	G	중량(KG)	재고
30	BT30AD/B-SFH3-60	3	11	17	60	19	-	0.40	
	BT30AD/B-SFH4-60	4	11	17	60	22	-	0.40	
	BT30AD/B-SFH5-60	5	13	19	60	28	-	0.40	
	BT30AD/B-SFH6-60	6	21	27	60	36	M5×0.8	0.40	
	BT30AD/B-SFH8-60	8	21	27	60	36	M6×1.0	0.40	
	BT30AD/B-SFH10-80	10	24	33	80	42	M8×1.0	0.40	
	BT30AD/B-SFH12-80	12	24	33	80	47	M10×1.0	0.42	
	BT30AD/B-SFH16-80	16	27	36	80	50	M12×1.0	0.42	
	BT30AD/B-SFH20-90	20	33	44	90	52	M16×1.0	0.44	
40	BT40AD/B-SFH3-90	3	11	21	90	19	-	1.00	●
	BT40AD/B-SFH4-90	4	11	21	90	22	-	1.00	●
	BT40AD/B-SFH5-90	5	13	23	90	28	-	1.00	●
	BT40AD/B-SFH6-90	6	21	31	90	36	M5×0.8	1.10	●
	BT40AD/B-SFH6-160	6	21	31	160	36	M5×0.8	1.15	
	BT40AD/B-SFH8-90	8	21	31	90	36	M6×1.0	1.11	●
	BT40AD/B-SFH8-160	8	21	31	160	36	M6×1.0	1.15	
	BT40AD/B-SFH10-90	10	24	34	90	42	M8×1.0	1.10	●
	BT40AD/B-SFH10-160	10	24	34	160	42	M8×1.0	1.15	
	BT40AD/B-SFH12-90	12	24	34	90	47	M10×1.0	1.10	●
	BT40AD/B-SFH12-160	12	24	34	160	47	M10×1.0	1.15	
	BT40AD/B-SFH14-90	14	27	37	90	47	M10×1.0	1.20	
	BT40AD/B-SFH14-160	14	27	37	160	47	M10×1.0	1.50	
	BT40AD/B-SFH16-90	16	27	37	90	50	M12×1.0	1.20	●
	BT40AD/B-SFH16-160	16	27	37	160	50	M12×1.0	1.50	
	BT40AD/B-SFH18-90	18	33	43	90	50	M12×1.0	1.30	
	BT40AD/B-SFH18-160	18	33	43	160	50	M12×1.0	1.60	
	BT40AD/B-SFH20-90	20	33	43	90	52	M16×1.0	1.40	●
BT40AD/B-SFH20-160	20	33	43	160	52	M16×1.0	1.70		
BT40AD/B-SFH25-100	25	44	55	100	58	M16×1.0	1.70	●	
BT40AD/B-SFH25-160	25	44	57	160	58	M16×1.0	2.00		

▶ 고발란싱급은 고객의 요청에 따라 G2.5/40,000rpm (G6.3/100,000rpm)으로도 제작 공급 가능합니다.

SHRINK FIT HOLDER

MAS - BT 403 FORM AD/B

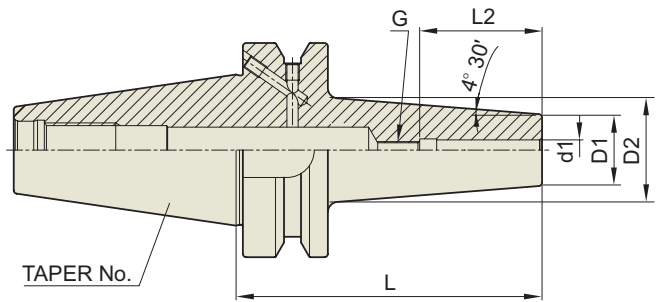

MAS - BT 403	Taper Accuracy AT3	G Value 2.5	RPM 20,000	Coolant System AD/B
-----------------	--------------------------	----------------	---------------	---------------------------

TAPER No.	CODE No.	d1	D1	D2	L	L 2	G	중량 (KG)	재고
50	BT50AD/B-SFH3-100	3	11	21	100	19	-	1.50	
	BT50AD/B-SFH4-100	4	11	21	100	22	-	1.50	
	BT50AD/B-SFH5-100	5	13	23	100	28	-	1.50	
	BT50AD/B-SFH6-100	6	21	31	100	36	M5×0.8	1.50	
	BT50AD/B-SFH6-160	6	21	31	160	36	M5×0.8	2.00	
	BT50AD/B-SFH8-100	8	21	31	100	36	M6×1.0	1.50	
	BT50AD/B-SFH8-160	8	21	31	160	36	M6×1.0	2.00	
	BT50AD/B-SFH10-100	10	24	34	100	42	M8×1.0	1.50	
	BT50AD/B-SFH10-160	10	24	34	160	42	M8×1.0	2.00	
	BT50AD/B-SFH12-100	12	24	34	100	47	M10×1.0	1.50	
	BT50AD/B-SFH12-160	12	24	34	160	47	M10×1.0	2.00	
	BT50AD/B-SFH14-100	14	27	37	100	47	M10×1.0	1.60	
	BT50AD/B-SFH14-160	14	27	37	160	47	M10×1.0	2.10	
	BT50AD/B-SFH16-100	16	27	37	100	50	M12×1.0	1.60	
	BT50AD/B-SFH16-160	16	27	37	160	50	M12×1.0	2.10	
	BT50AD/B-SFH18-100	18	33	43	100	50	M12×1.0	1.60	
	BT50AD/B-SFH18-160	18	33	43	160	50	M12×1.0	2.00	
	BT50AD/B-SFH20-100	20	33	43	100	52	M16×1.0	1.80	
	BT50AD/B-SFH20-160	20	33	43	160	52	M16×1.0	2.20	
	BT50AD/B-SFH25-100	25	44	54	100	58	M16×1.0	2.00	
BT50AD/B-SFH25-160	25	44	57	160	58	M16×1.0	2.40		

▶ 고발란싱급은 고객의 요청에 따라 G2.5/40,000rpm (G6.3/100,000rpm)으로도 제작 공급 가능합니다.

SHRINK FIT HOLDER

DIN69893-HSK FORM A

SHRINK FIT HOLDER

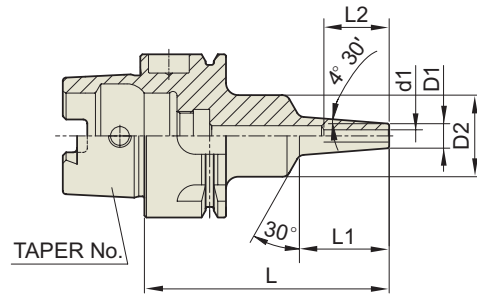

DIN69893 - HSK	Taper Accuracy AT3	G Value 2.5	RPM 20,000	Coolant System
-------------------	-----------------------	----------------	---------------	----------------

TAPER No.	CODE No.	d1	D1	D2	L	L 1	L 2	중량(KG)	재고
40A	HSK40A-SFH3-60	3	11	17	60	22	16	0.30	●
	HSK40A-SFH3-80	3	11	17	80	42	16	0.40	
	HSK40A-SFH4-60	4	11	17	60	22	16.5	0.30	●
	HSK40A-SFH4-80	4	11	17	80	42	16.5	0.40	
	HSK40A-SFH5-60	5	13	19	60	22	17	0.30	●
	HSK40A-SFH5-80	5	13	19	80	42	17	0.40	
	HSK40A-SFH6-60	6	21	27	60	22	24	0.40	●
	HSK40A-SFH6-80	6	21	27	80	42	24	0.50	
	HSK40A-SFH8-70	8	21	27	70	22	25	0.40	●
	HSK40A-SFH8-90	8	21	27	90	42	25	0.50	
	HSK40A-SFH10-70	10	24	33	70	22	32	0.50	●
HSK40A-SFH10-90	10	24	33	90	42	32	0.60		

▶ 고발란싱급은 고객의 요청에 따라 G2.5/40,000rpm (G6.3/100,000rpm)으로도 제작 공급 가능합니다.

DIN69893-HSK FORM E

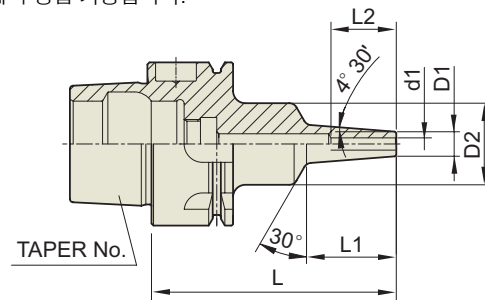

TAPER No.	CODE No.	d1	D1	D2	L	L 1	L 2	중량(KG)	재고
40E	HSK40E-SFH3-50	3	11	17	50	22	16	0.30	●
	HSK40E-SFH3-70	3	11	17	70	42	16	0.40	
	HSK40E-SFH4-50	4	11	17	50	22	16.5	0.30	●
	HSK40E-SFH4-70	4	11	17	70	42	16.5	0.40	
	HSK40E-SFH5-50	5	13	19	50	22	17	0.30	●
	HSK40E-SFH5-70	5	13	19	70	42	17	0.40	
	HSK40E-SFH6-50	6	21	27	50	22	24	0.40	●
	HSK40E-SFH6-70	6	21	27	70	42	24	0.50	
	HSK40E-SFH8-60	8	21	27	60	22	25	0.40	●
	HSK40E-SFH8-80	8	21	27	80	42	25	0.50	
	HSK40E-SFH10-60	10	24	33	60	22	32	0.50	●
	HSK40E-SFH10-80	10	24	33	80	42	32	0.60	

▶ 고발란싱급은 고객의 요청에 따라 G2.5/40,000rpm (G6.3/100,000rpm)으로도 제작 공급 가능합니다.

SHRINK FIT HOLDER



SHRINK FIT HOLDER

DIN69893-HSK FORM A

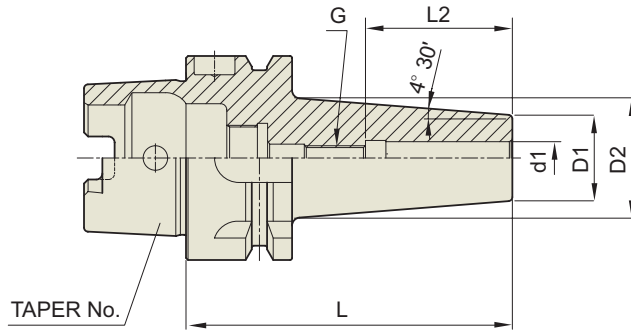

DIN69893 - HSK	Taper Accuracy AT3	G Value 2.5	RPM 20,000	Coolant System
-------------------	-----------------------	----------------	---------------	----------------

TAPER No.	CODE No.	d1	D1	D2	L	L 2	G	중량 (KG)	재고
50A	HSK50A-SFH3-80	3	11	19.5	80	19	-	0.54	
	HSK50A-SFH4-80	4	11	19.5	80	22	-	0.55	
	HSK50A-SFH5-80	5	13	21.5	80	28	-	0.56	
	HSK50A-SFH6-80	6	21	29.5	80	36	M5×0.8	0.57	
	HSK50A-SFH8-80	8	21	29.5	80	36	M6×1.0	0.58	
	HSK50A-SFH10-85	10	24	33	85	42	M8×1.0	0.65	
	HSK50A-SFH12-90	12	24	34	90	47	M10×1.0	0.67	
	HSK50A-SFH14-90	14	27	37	90	47	M10×1.0	0.72	
	HSK50A-SFH16-95	16	27	38	95	50	M12×1.0	0.73	
	HSK50A-SFH18-95	18	33	44	95	50	M12×1.0	0.90	
	HSK50A-SFH20-100	20	33	45	100	52	M16×1.0	0.92	
63A	HSK63A-SFH3-80	3	11	19.5	80	19	-	0.70	●
	HSK63A-SFH4-80	4	11	19.5	80	22	-	0.70	●
	HSK63A-SFH5-80	5	13	21.5	80	28	-	0.70	●
	HSK63A-SFH6-80	6	21	29.5	80	36	M5×0.8	0.83	●
	HSK63A-SFH6-160	6	21	32	160	36	M5×0.8	1.00	
	HSK63A-SFH8-80	8	21	29.5	80	36	M6×1.0	0.83	●
	HSK63A-SFH8-160	8	21	32	160	36	M6×1.0	0.00	
	HSK63A-SFH10-85	10	24	33	85	42	M8×1.0	0.83	●
	HSK63A-SFH10-160	10	24	34	160	42	M8×1.0	0.00	
	HSK63A-SFH12-90	12	24	34	90	47	M10×1.0	0.83	●
	HSK63A-SFH12-160	12	24	34	160	47	M10×1.0	0.00	
	HSK63A-SFH14-90	14	27	37	90	47	M10×1.0	0.91	
	HSK63A-SFH14-160	14	27	38	160	47	M10×1.0	1.30	
	HSK63A-SFH16-95	16	27	38	95	50	M12×1.0	0.98	●
	HSK63A-SFH16-160	16	27	38	160	50	M12×1.0	1.40	
	HSK63A-SFH18-95	18	33	44	95	50	M12×1.0	0.98	
	HSK63A-SFH18-160	18	33	45	160	50	M12×1.0	1.40	
	HSK63A-SFH20-100	20	33	45	100	52	M16×1.0	1.00	
HSK63A-SFH20-160	20	33	45	160	52	M16×1.0	1.40		
HSK63A-SFH25-115	25	44	58	115	58	M16×1.0	1.40		
HSK63A-SFH25-160	25	44	58	160	58	M16×1.0	1.80		

▶ 고발란싱급은 고객의 요청에 따라 G2.5/40,000rpm (G6.3/100,000rpm)으로도 제작 공급 가능합니다.

SHRINK FIT HOLDER

DIN69893-HSK FORM A

SHRINK FIT
HOLDER

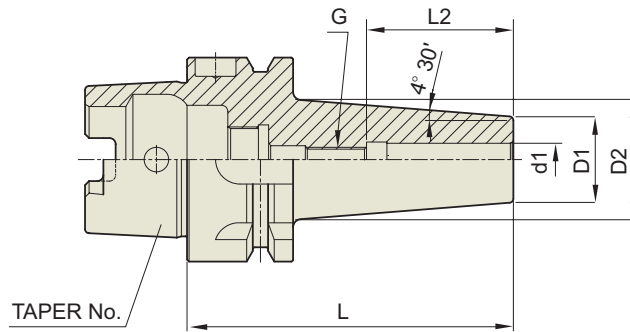

DIN69893 - HSK	Taper Accuracy AT3	G Value 2.5	RPM 20,000	Coolant System
-------------------	--------------------------	----------------	---------------	-------------------

TAPER No.	CODE No.	d1	D1	D2	L	L 2	G	중량 (KG)	재고
100A	HSK100A-SFH3-85	3	11	20	85	19	-	1.30	
	HSK100A-SFH4-85	4	11	20	85	22	-	1.30	
	HSK100A-SFH5-85	5	13	22	85	28	-	1.30	
	HSK100A-SFH6-85	6	21	30	85	36	M5×0.8	1.30	
	HSK100A-SFH6-160	6	21	32	160	36	M5×0.8	1.80	
	HSK100A-SFH8-85	8	21	30	85	36	M6×1.0	1.30	
	HSK100A-SFH8-160	8	21	32	160	36	M6×1.0	1.80	
	HSK100A-SFH10-90	10	24	34	90	42	M8×1.0	1.30	
	HSK100A-SFH10-160	10	24	35	160	42	M8×1.0	1.80	
	HSK100A-SFH12-95	12	24	34	95	47	M10×1.0	1.30	
	HSK100A-SFH12-160	12	24	35	160	47	M10×1.0	1.80	
	HSK100A-SFH14-95	14	27	37	95	47	M10×1.0	1.40	
	HSK100A-SFH14-160	14	27	39	160	47	M10×1.0	1.90	
	HSK100A-SFH16-100	16	27	38	100	50	M12×1.0	1.40	
	HSK100A-SFH16-160	16	27	39	160	50	M12×1.0	1.90	
	HSK100A-SFH18-100	18	33	44	100	50	M12×1.0	1.50	
	HSK100A-SFH18-160	18	33	45	160	50	M12×1.0	2.00	
	HSK100A-SFH20-100	20	33	44	100	52	M16×1.0	1.50	
	HSK100A-SFH20-160	20	33	45	160	52	M16×1.0	2.00	
HSK100A-SFH25-115	25	44	53	115	58	M16×1.0	1.80		
HSK100A-SFH25-160	25	44	53	160	58	M16×1.0	2.30		

▶ 고발란스급은 고객의 요청에 따라 G2.5/40,000rpm (G6.3/100,000rpm)으로도 제작 공급 가능합니다.

SHRINK FIT HOLDER

DIN69871 - SK FORM AD/B

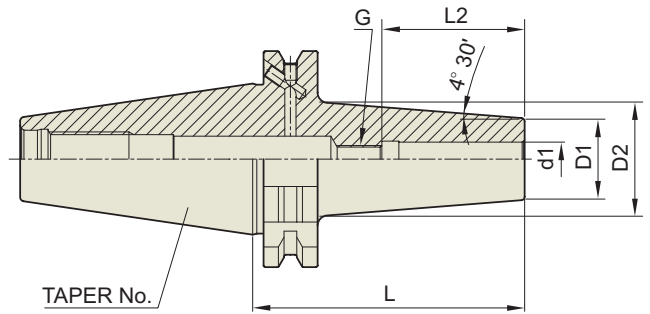

DIN69871 - SK	Taper Accuracy AT3	G Value 2.5	RPM 20,000	Coolant System AD/B
------------------	-----------------------	----------------	---------------	------------------------

TAPER No.	CODE No.	d1	D1	D2	L	L 2	G	중량 (KG)	재고
30	SK30AD/B-SFH3-60	3	11	17	60	19	-	0.40	
	SK30AD/B-SFH4-60	4	11	17	60	22	-	0.40	
	SK30AD/B-SFH5-60	5	13	19	60	28	-	0.40	
	SK30AD/B-SFH6-60	6	21	27	60	36	M5×0.8	0.40	
	SK30AD/B-SFH8-60	8	21	27	60	36	M6×1.0	0.40	
	SK30AD/B-SFH10-80	10	24	34	80	42	M8×1.0	0.40	
	SK30AD/B-SFH12-80	12	24	34	80	47	M10×1.0	0.42	
	SK30AD/B-SFH16-80	16	27	37	80	50	M12×1.0	0.42	
	SK30AD/B-SFH20-90	20	33	44	90	52	M16×1.0	0.44	
40	SK40AD/B-SFH3-80	3	11	21	80	19	-	1.00	
	SK40AD/B-SFH4-80	4	11	21	80	22	-	1.00	
	SK40AD/B-SFH5-80	5	13	23	80	28	-	1.00	
	SK40AD/B-SFH6-80	6	21	31	80	36	M5×0.8	1.10	
	SK40AD/B-SFH6-160	6	21	32	160	36	M5×0.8	1.15	
	SK40AD/B-SFH8-80	8	21	31	80	36	M6×1.0	1.11	
	SK40AD/B-SFH8-160	8	21	32	160	36	M6×1.0	1.15	
	SK40AD/B-SFH10-80	10	24	34	80	42	M8×1.0	1.10	
	SK40AD/B-SFH10-160	10	24	34	160	42	M8×1.0	1.15	
	SK40AD/B-SFH12-80	12	24	34	80	47	M10×1.0	1.10	
	SK40AD/B-SFH12-160	12	24	34	160	47	M10×1.0	1.15	
	SK40AD/B-SFH14-80	14	27	37	80	47	M10×1.0	1.20	
	SK40AD/B-SFH14-160	14	27	36	160	47	M10×1.0	1.50	
	SK40AD/B-SFH16-80	16	27	37	80	50	M12×1.0	1.20	
	SK40AD/B-SFH16-160	16	27	36	160	50	M12×1.0	1.50	
	SK40AD/B-SFH18-80	18	33	43	80	50	M12×1.0	1.30	
	SK40AD/B-SFH18-160	18	33	44	160	50	M12×1.0	1.60	
	SK40AD/B-SFH20-80	20	33	43	80	52	M16×1.0	1.40	
	SK40AD/B-SFH20-160	20	33	44	160	52	M16×1.0	1.70	
SK40AD/B-SFH25-90	25	44	55	90	58	M16×1.0	1.70		
SK40AD/B-SFH25-160	25	44	53	160	58	M16×1.0	2.00		

▶ 고발란싱급은 고객의 요청에 따라 G2.5/40,000rpm (G6.3/100,000rpm)으로도 제작 공급 가능합니다.

SHRINK FIT HOLDER

DIN69871 - SK FORM AD/B

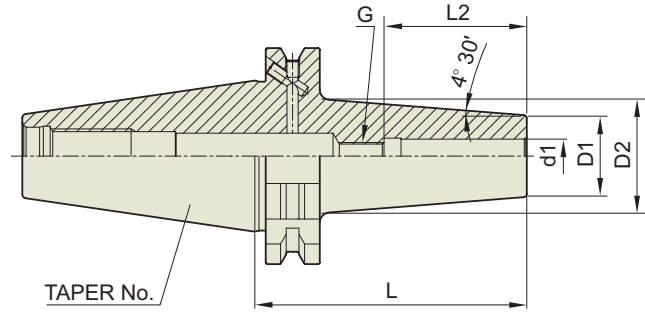

DIN69871 -SK	Taper Accuracy AT3	G Value 6.3	RPM 15,000	Coolant System AD/B
-----------------	--------------------------	----------------	---------------	---------------------------

TAPER No.	CODE No.	d1	D1	D2	L	L 2	G	중량 (KG)	재고
50	SK50AD/B-SFH3-80	3	11	21	80	19	-	1.50	
	SK50AD/B-SFH4-80	4	11	21	80	22	-	1.50	
	SK50AD/B-SFH5-80	5	13	23	80	28	-	1.50	
	SK50AD/B-SFH6-80	6	21	31	80	36	M5×0.8	1.50	
	SK50AD/B-SFH6-160	6	21	32	160	36	M5×0.8	2.00	
	SK50AD/B-SFH8-80	8	21	31	80	36	M6×1.0	1.50	
	SK50AD/B-SFH8-160	8	21	32	160	36	M6×1.0	2.00	
	SK50AD/B-SFH10-80	10	24	34	80	42	M8×1.0	1.50	
	SK50AD/B-SFH10-160	10	24	34	160	42	M8×1.0	2.00	
	SK50AD/B-SFH12-80	12	24	34	80	47	M10×1.0	1.50	
	SK50AD/B-SFH12-160	12	24	34	160	47	M10×1.0	2.00	
	SK50AD/B-SFH14-80	14	27	37	80	47	M10×1.0	1.60	
	SK50AD/B-SFH14-160	14	27	36	160	47	M10×1.0	2.10	
	SK50AD/B-SFH16-80	16	27	37	80	50	M12×1.0	1.60	
	SK50AD/B-SFH16-160	16	27	36	160	50	M12×1.0	2.10	
	SK50AD/B-SFH18-80	18	33	43	80	50	M12×1.0	1.60	
	SK50AD/B-SFH18-160	18	33	44	160	50	M12×1.0	2.00	
	SK50AD/B-SFH20-80	20	33	43	80	52	M16×1.0	1.80	
	SK50AD/B-SFH20-160	20	33	44	160	52	M16×1.0	2.20	
	SK50AD/B-SFH25-90	25	44	53	90	58	M16×1.0	2.00	
SK50AD/B-SFH25-160	25	44	53	160	58	M16×1.0	2.40		

▶ 고발란스급은 고객의 요청에 따라 G2.5/40,000rpm (G6.3/100,000rpm)으로도 제작 공급 가능합니다.