

FACE MILL ARBOR



FIG.1

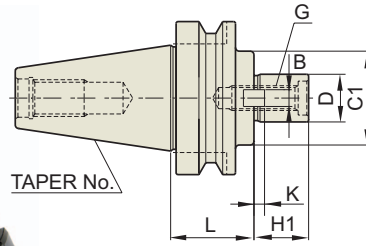
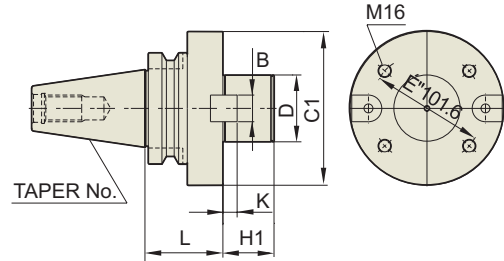

FIG.2



MAS - BT 403	Taper Accuracy AT3	G Value	RPM	Coolant System
-----------------	--------------------------	---------	-----	-------------------

TAPER No.	CODE No.	D	L1	C1	H1	B	K	G	FIG.	중량 (KG)	재고
30	BT30-FMA25.4 -45	25.4	45	50	22	9.5	5	M12	1	1.1	●
	BT30-FMA31.75-45	31.75	45	60	30	12.7	7	M16	1	1.2	●
40	BT40-FMA25.4 -45	25.4	45	50	22	9.5	5	M12	1	1.5	●
	BT40-FMA25.4 -90	25.4	90	50	22	9.5	5	M12	1	3.1	
	BT40-FMA31.75-45	31.75	45	60	30	12.7	7	M16	1	1.9	●
	BT40-FMA31.75-75	31.75	75	60	30	12.7	7	M16	1	2.7	
	BT40-FMA38.1 -60	38.1	60	80	34	15.9	9	M20	1	2.9	●
50	BT50-FMA25.4 -45	25.4	45	50	22	9.5	5	M12	1	3.7	●
	BT50-FMA25.4 -90	25.4	90	50	22	9.5	5	M12	1	4.6	●
	BT50-FMA25.4 -150	25.4	150	50	22	9.5	5	M12	1	5.5	●
	BT50-FMA31.75-45	31.75	45	60	30	12.7	7	M16	1	4.5	●
	BT50-FMA31.75-75	31.75	75	60	30	12.7	7	M16	1	5.3	●
	BT50-FMA31.75-105	31.75	105	60	30	12.7	7	M16	1	5.8	●
	BT50-FMA31.75-150	31.75	150	60	30	12.7	7	M16	1	6.3	●
	BT50-FMA38.1 -45	38.1	45	80	34	15.9	9	M20	1	4.3	●
	BT50-FMA38.1 -75	38.1	75	80	34	15.9	9	M20	1	5.6	●
	BT50-FMA38.1 -105	38.1	105	80	34	15.9	9	M20	1	6.0	●
	BT50-FMA38.1 -150	38.1	150	80	34	15.9	9	M20	1	6.5	●
	BT50-FMA50.8 -45	50.8	45	100	36	19.05	10	M24	1	4.9	●
	BT50-FMA50.8 -75	50.8	75	100	36	19.05	10	M24	1	6.8	●
BT50-FMA47.625-75	47.625	75	128.57	38	25.4	12.5	-	2	7.7	●	

SPARE PARTS	TYPE	KEY		KEY BOLT		MOUNTING BOLT	
	3R(FMA 25.4)		W9.52		M4 × 10		MB12
	4R(FMA 31.75)		W12.7		M5 × 12		MB16
	5R(FMA 38.1)		W15.87		M6 × 16		MB20
	6R(FMA 50.8)		W19		M6 × 18		MB24
	8R(FMA 47.625)		-		-		-

FACE MILL SYSTEM

FACE MILL ARBOR

NT

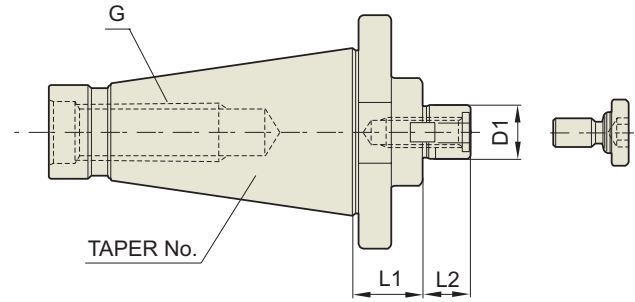

DIN2080 -NT	Taper Accuracy AT3	G Value	RPM	Coolant System
----------------	-----------------------	---------	-----	----------------

TAPER No.	CODE No.	CUTTER Ø	D1	L1	L2	DRAW THREAD	구형 CODE No.	중량 (KG)	재고
40	NT40-FMA25.4	3"(75Ø)	25.4	30	22	U5/8-11(M16×2)	NT40-3R	1.45	
	NT40-FMA31.75	4"(100Ø)	31.75	30	30	U5/8-11(M16×2)	NT40-4R	1.75	●
	NT40-FMA38.1	5"(125Ø)	38.1	30	34	U5/8-11(M16×2)	NT40-5R	1.93	●
	NT40-FMA50.8	6"(150Ø)	50.8	30	36	U5/8-11(M16×2)	NT40-6R	2.55	
50	NT50-FMA25.4	3"(75Ø)	25.4	30	22	U1-8(M24×3)	NT50-3R	3.30	
	NT50-FMA31.75	4"(100Ø)	31.75	30	30	U1-8(M24×3)	NT50-4R	3.40	●
	NT50-FMA38.1	5"(125Ø)	38.1	30	34	U1-8(M24×3)	NT50-5R	3.60	●
	NT50-FMA50.8	6"(150Ø)	50.8	30	36	U1-8(M24×3)	NT50-6R	3.90	●
	NT50-FMA47.625	8"(200Ø)	47.625	45	38	U1-8(M24×3)	NT50-8R	4.90	●

MT

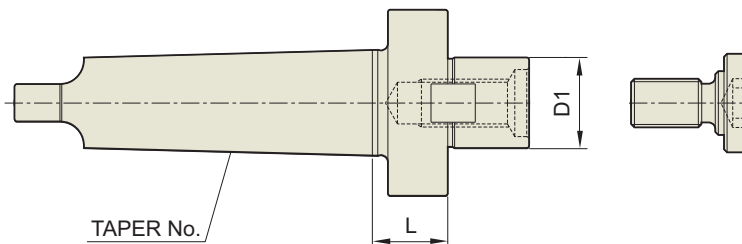

DIN228 -MTA	Taper Accuracy AT3	G Value	RPM	Coolant System
----------------	-----------------------	---------	-----	----------------

TAPER No.	CODE No.	CUTTER Ø	D1	L	중량 (KG)	재고
5	MT5-FMA25.4	3"(75Ø)	40	22	1.60	
	MT5-FMA31.75	4"(100Ø)	41.5	30	1.90	
	MT5-FMA38.1	5"(125Ø)	45	34	2.20	
6	MT6-FMA25.4	3"(75Ø)	45	22	3.50	
	MT6-FMA31.75	4"(100Ø)	45	30	3.80	
	MT6-FMA38.1	5"(125Ø)	45	34	4.10	
	MT6-FMA50.8	6"(150Ø)	45	36	4.60	
	MT6-FMA47.625	8"(200Ø)	48	38	5.40	

FACE MILL ARBOR

MAS 403 BT

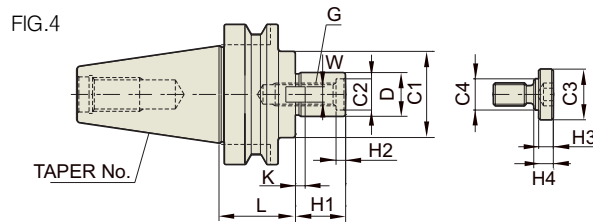
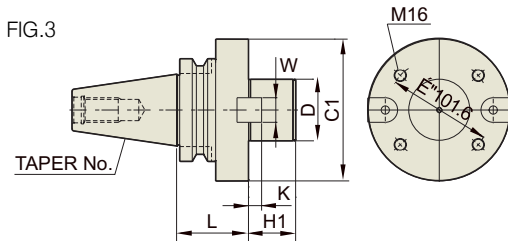
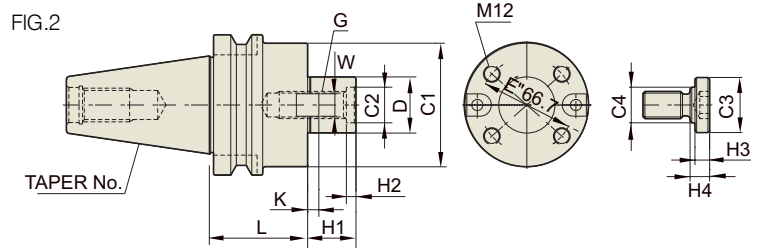
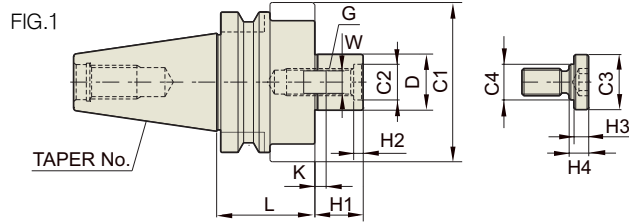

MAS - BT 403	Taper Accuracy AT3	G Value	RPM	Coolant System
-----------------	--------------------------	---------	-----	-------------------

■ METRIC TYPE

TAPER No.	CODE No.	FIG.	D	L	C1	C2	H1	H2	W	K	G	C3	C4	H3	H4	중량 (KG)	재고
30	BT30-FMB27- 40	4	27	40	80	-	26	-	12	6	M12	33	23	10	10	2.1	
40	BT40-FMB27- 60	4	27	60	80	-	26	-	12	6	M12	33	23	10	10	2.5	
	BT40-FMB27- 90	4	27	90	80	-	26	-	12	6	M12	33	23	10	10	4.7	
	BT40-FMB40- 60	4	40	60	85	28	26	6	16	8.5	M20	50	27	14	20	7.4	
	BT50-FMB27- 45	1	27	45	80	-	26	-	12	6	M12	33	23	10	12	4.0	
50	BT50-FMB27- 90	1	27	90	80	-	26	-	12	6	M12	33	23	10	12	5.8	
	BT50-FMB27-150	1	27	150	80	-	26	-	12	6	M12	33	23	10	12	8.2	
	BT50-FMB40- 45	1	40	45	85	28	26	6	16	8.5	M20	50	27	14	20	4.7	●
	BT50-FMB40- 75	1	40	75	85	28	26	6	16	8.5	M20	50	27	14	20	6.1	●
	BT50-FMB40-105	1	40	105	85	28	26	6	16	8.5	M20	50	27	14	20	8.1	
	BT50-FMB40F-75	2	40	75	110	28	26	6	16	8.5	M20	50	27	14	20	6.6	●
	BT50-FMB60- 75	3	60	75	140	-	25	-	25.4	12.5	-	-	-	-	-	7.9	●

■ INCH TYPE

TAPER No.	CODE No.	FIG.	D	L	C1	C2	H1	H2	W	K	G	C3	C4	H3	H4	중량 (KG)	재고
30	BT30-FMB25.4-40	4	25.4	40	80	-	26	-	9.5	5	M12	33	23	10	12	2.1	
40	BT40-FMB25.4-60	4	25.4	60	80	-	26	-	9.5	5	M12	33	23	10	12	2.5	
	BT40-FMB25.4-90	4	25.4	90	80	-	26	-	9.5	5	M12	33	23	10	12	4.7	
	BT40-FMB38.1-60	4	38.1	60	85	28	26	6	15.9	9	M20	60	27	14	20	7.4	
	BT50-FMB25.4-45	1	25.4	45	80	-	26	-	9.5	5	M12	33	23	10	12	4.0	
50	BT50-FMB25.4-90	1	25.4	90	80	-	26	-	9.5	5	M12	33	23	10	12	5.8	
	BT50-FMB25.4-150	1	25.4	150	80	-	26	-	9.5	5	M12	33	23	10	12	8.2	
	BT50-FMB38.1-45	1	38.1	45	85	28	26	6	15.9	9	M20	50	27	14	20	4.7	
	BT50-FMB38.1-75	1	38.1	75	85	28	26	6	15.9	9	M20	50	27	14	20	6.1	
	BT50-FMB38.1-105	1	38.1	105	85	28	26	6	15.9	9	M20	50	27	14	20	8.7	
	BT50-FMB38.1F-75	2	38.1	75	110	28	26	6	15.9	9	M20	50	27	14	20	6.6	

FACE MILL SYSTEM

FACE MILL ARBOR



FIG.1

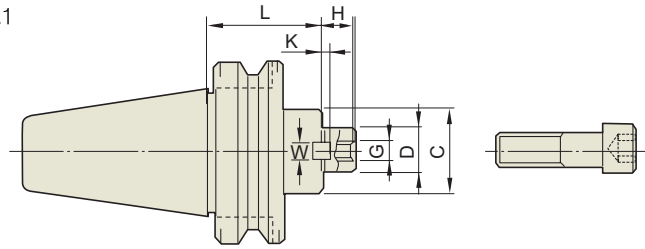
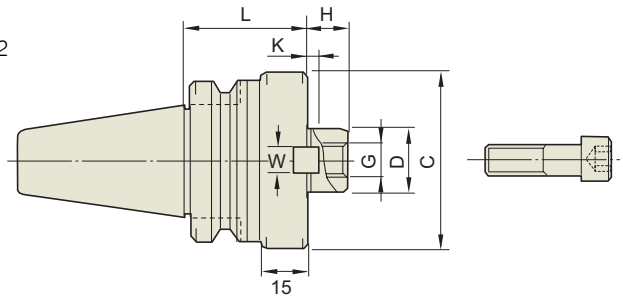

FIG.2



MAS - BT 403	Taper Accuracy AT3	G Value	RPM	Coolant System
-----------------	--------------------------	---------	-----	-------------------

■ METRIC TYPE

TAPER No.	CODE No.	D	L	C	H	W	K	G	FIG.	중량 (KG)	재고
30	BT30-FMC22- 45	22	45	45	18	10	5	M10	3	0.8	●
40	BT40-FMC22- 45	22	45	45	15	10	5	M10	1	1.3	●
	BT40-FMC27- 60	27	60	70	20	12	6	M12	3	1.5	●
	BT40-FMC32- 60	32	60	85	22	14	7	M16	3	2.3	●
50	BT50-FMC22- 60	22	60	45	18	10	5	M10	1	4.2	
	BT50-FMC22-105	22	105	45	18	10	5	M10	1	4.7	●
	BT50-FMC22-150	22	150	45	18	10	5	M10	1	5.3	●
	BT50-FMC27- 45	27	45	70	20	12	6	M12	1	4.1	
	BT50-FMC27- 90	27	90	70	20	12	6	M12	1	5.5	●
	BT50-FMC27-150	27	150	70	20	12	6	M12	1	7.3	
	BT50-FMC32- 60	32	60	85	22	14	7	M16	1	4.2	
BT50-FMC32-105	32	105	85	22	14	7	M16	1	5.5	●	
BT50-FMC32-150	32	150	85	22	14	7	M16	1	7.0		

■ INCH TYPE

TAPER No.	CODE No.	D	L	C	H	W	K	G	FIG.	중량 (KG)	재고
30	BT30-FMC25.4- 45	25.4	45	70	20	9.5	6	M12	3	1.1	
40	BT40-FMC25.4- 60	25.4	60	70	20	9.5	6	M12	3	1.5	
	BT40-FMC25.4- 90	25.4	90	70	20	9.5	6	M12	3	2.2	
	BT40-FMC38.1- 60	38.1	60	85	22	15.9	7	M16	3	2.3	
BT40-FMC38.1- 75	38.1	75	85	22	15.9	7	M16	3	2.6		
50	BT50-FMC25.4- 45	25.4	45	70	20	9.5	6	M12	1	4.1	
	BT50-FMC25.4- 90	25.4	90	70	20	9.5	6	M12	1	5.5	
	BT50-FMC25.4-150	25.4	150	70	20	9.5	6	M12	1	7.3	
	BT50-FMC38.1- 45	38.1	45	85	22	15.9	7	M16	1	4.2	
	BT50-FMC38.1- 75	38.1	75	85	22	15.9	7	M16	1	5.5	
BT50-FMC38.1-105	38.1	105	85	22	15.9	7	M16	1	7.0		

SPARE PARTS	TYPE	KEY		KEY BOLT		CLAMP BOLT	
	FMC 22		W10		M4×10		M10
	FMC 27		W12		M5×12		M12
	FMC 32		W14		M6×16		M16

FACE MILL ARBOR

DIN69893-HSK FORM A

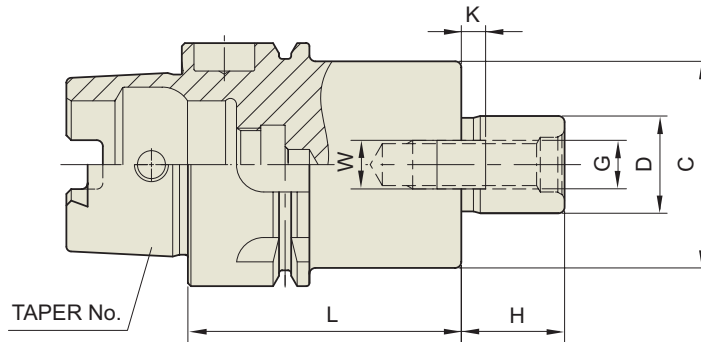

DIN69893
- HSK

Taper
Accuracy
AT3

G Value

RPM

Coolant
System

TAPER No.	CODE No.	D	C	L	H	W	K	G	중량 (KG)	재고
40A	HSK40A-FMC16-45	16	34	45	17	8	4	M8	0.40	
	HSK40A-FMC22-50	22	45	50	18	10	5	M10	0.50	●
	HSK40A-FMC27-60	27	68	60	20	12	7	M12	0.70	