

# ELC

ELEVATED OMNIDIRECTIONAL LOW INTENSITY LIGHT

ELC-TEDL : TAXIWAY EDGE LIGHT

Compliance with standards

ICAO : Annex14 Para 5.3.16

IEC : 61827

FAA : AC 150/5345-46, L-861T

KS : KS W 5021(Korean Standard)

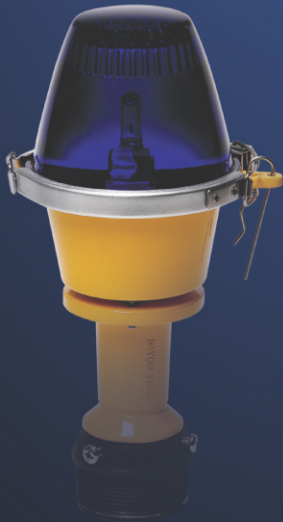

The ELC consist of a frangible stem in aluminium casting mounted on a 2 inch 11 TPI threaded coupling, an upper body in die casting aluminium housing the GY-9.5 lamp holder. All the hardware is made of stainless steel. The optical assembly consists of an outer glass dome having an external smooth surface to prevent accumulation of dirt. The light fitting is supplied with a 2-pole plug FAA L-823 with heat resistant wires.

## Features

- Body casting made of aluminium alloy for lightness, mechanical strength and durability
- Environmental friendly materials
- Easy lamp replacement without any tools
- Contained dimensions to withstand jet blast
- Smooth outer dome eliminating the risk of build up of dirt, easy to clean
- Choice of 30W or 45W 6.6A GY-9.5 lamp
- Long lamp life 1000 hours at full brilliancy



# ELC

## ELEVATED OMNIDIRECTIONAL LOW INTENSITY LIGHT



ELC-TEDL(B)



ELC-TEDL(Y)

1. Dome lens
2. Halogen lamp
3. Bolt
4. Socket Assembly
5. Bolt
6. Socket support
7. Nut
8. Cord bush
9. Two-pole cable with plug
10. Gasket
11. Locking pin
12. Ring Brand Assembly
13. Bolt Spring washer
14. Upper body
15. Lower body
16. Coupling(2")
17. Bolt

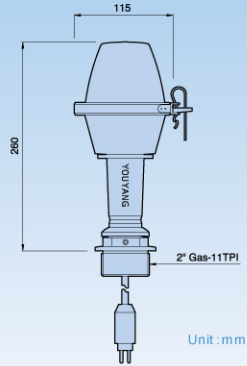

### Components

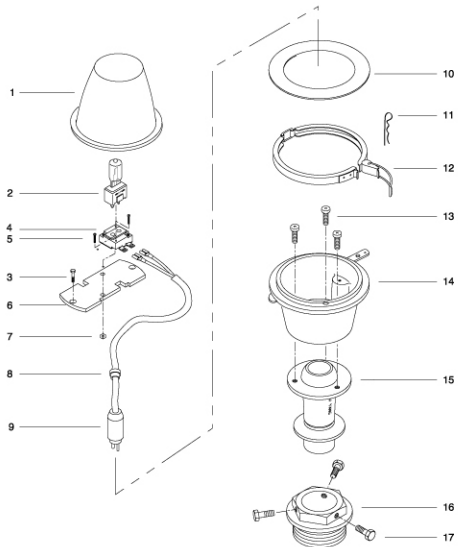

### Typical Mounting System

Unit : mm

2" Conduit Elbow

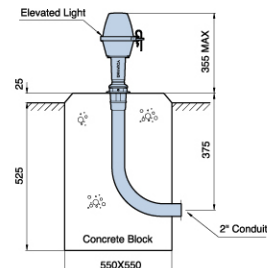

12" Deep Base

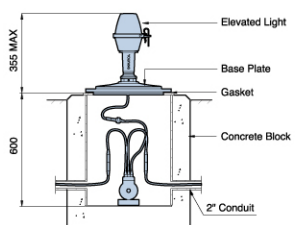

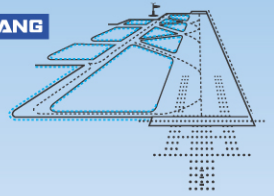

## Photometric Performance

### ► Taxiway Edge Light

Application	Angle		Lamp	FAA Intensity	Minimum Intensity
	V	H			
Blue	2-10°	360°	45Wx1	2	2.6cd
Yellow	2-10°	360°	45Wx1	67	69cd

- Chromaticity
- Blue X:0.1536, Y:0.0983
- Yellow X:0.6026, Y:0.3969

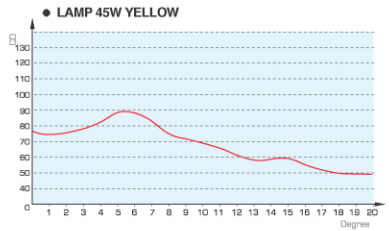
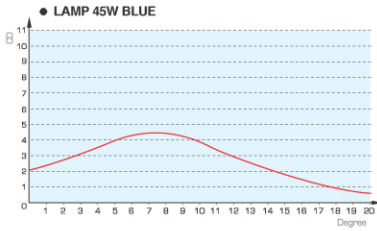

## Lighting Layout Information

Unit : m

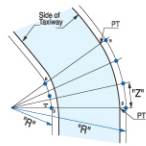
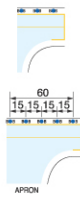
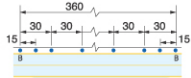
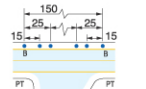
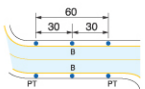
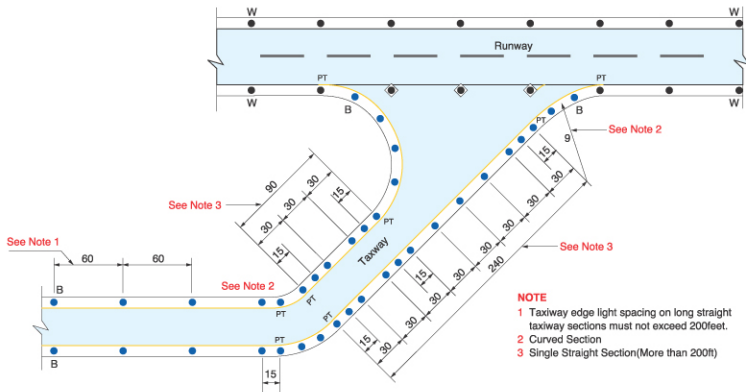

Radius "R" (m)	Offset from Edge (m)	Radius "R" (m)	Offset from Edge (m)
4.5	6	90	24
7.5	8	120	28.5
15	10	150	33
22.5	12	180	38
30	15	210	43
45	18.5	240	50
60	18	270	56
75	21	300	60

## Ordering Code

**E L C - T E D L - 0 4 5 - 0 1**

Model Name ELC-TEDL

Lamp Wattage 045-6.6A 45W(GY-9.5) 030-6.6A 30W(GY-9.5)

Light Color 01: Blue 02: Yellow

## Description

Model Name	Item	Specification
ELC - TEDL	Taxiway Edge Light	6.6A 45W * 1 Blue
		6.6A 45W * 1 Yellow
		6.6A 30W * 1 Blue
		6.6A 30W * 1 Yellow

## Spare Parts

Description	Specification	Ordering code
Light Body	Taxiway Edge Light	B311210
Lens(Dome)	Blue	142-036A
	Yellow	142-020A
Lamp	6.6A 45W, GY-9.5	111-222A
	6.6A 30W, GY-9.5	111-221A



**YOUYANG**  
AIRPORT LIGHTING EQUIPMENT INC.

### Head Office

738-2, Kwanyang-Dong, Dongan-Ku,  
Anyang City, Kyunggi-Do, Korea

Tel : 82-31-422-0021 Fax : 82-31-424-6044

http://www.youyang.co.kr E-mail: youyang@youyang.co.kr